



33.

Chambers County

Sketch Files

GENERAL LAND OFFICE  
AUSTIN, TEXAS

X 3

Calculations  
for  
Area

615.6 sq. Mi.

✓  
1935

✓

Counter 51259



700  
No. 2480---

In the Matter of the Surveyors

§  
§  
§

June 15th----1909.

Report of the County line survey

In this matter it is ordered by the Court that the Map and field notes of the boundary line survey as made and filed in this court be and the same are fully approved and Clerk will record the Map and field notes in the Minutes of this Court.

The Hon. County Judge and County Commissioners Jefferson and Chambers Counties, Texas.

Gentlemen:

In submitting for your approval, the field notes and accompanying map of the boundary line between Jefferson and Chambers County from the Gulf of Mexico to the West South West corner of Jefferson County, we respectfully make the following report.

By order of your Hon. Court, we were to begin this survey on Monday the 26th day of April A.D. 1909, but owing to the delay in securing from the General Land Office a working sketch of the surveys adjoining this line we did not actually begin this survey until Monday May 3rd 1909.

Mr. Geo. W. White, county surveyor of Jefferson County, having sworn in Fred Hyland and Jim Goodhue chainmen, met Mr. H. J. Walger, County Surveyor of Chambers County at High Island, where he was accompanied by his sworn chainmen, Mr. J. J. Wright and Isadore Schnapps.

It was agreed that the South West corner of Jefferson County and the South East corner of Chambers County should first be located and established on the beach of the Gulf of Mexico, before attempting to locate any other point on this boundary line.

This was done in the following manner: In the original survey of this line by District Surveyor D. B. Wallis in December 1881, the aforesaid point was established 185 varas N. 67° E. of the S. W. cor. of the James Earl survey and from the S. E. corner of the Martin Dunman survey, which is the S. E. corner of Galveston County, the following courses were run, N. 70° E. 820 varas N. 68° E. 1381 varas, this point was also verified from the S. E. corner of the James Earl survey which is marked by an iron rail in the Gulf of Mexico having satisfied ourselves regarding the correctness of this point from the adjoining surveys, we marked same with a strong wooden stake on the top of the "Levee" which is ordinarily about 30 varas from the waters edge, from this point we ran a preliminary line North 42592 varas to a point 229.6 varas East of a Cedar Post 10 inches square marked N. E. Chambers Co. this Cedar post corresponds with the description given by D. B. Wallis for the North East corner of Chambers County, to wit: A cedar post on which said corner is described. The most elevated tree top in Turkey Island brs. N. 15° W. and the left hand extreme of Brushey Island brs. S. 14-3/4° E..

Having thoroughly satisfied ourselves that this Cedar post was the one set by D. B. Wallis and is the original N. E. corner of Chambers County, we corrected the line from the Gulf of Mexico to run to this cedar post, making as nearly a perfect straight line between the two points as possible to be made with an Engineers Transit using tack centers in substantial wooden stakes at all points along the line. Two transits were used on this work, one ~~is~~ an A. S. Aloe, the other a Buff and Berger, on this corrected line, which will be described in detail below the variations of the magnetic needle on the A. S. Aloe transit, is 7° 18' to the East, while the variation on the Buff & Berger needle, was 8° 08' to the East, making a difference of 0° 50' showing that all needles do not vary the same in declination. It was also noted that the needle decreased in declination an amount of 0° 15' in the first two miles inland from the Gulf shore. and  
From the North East corner of Chambers County, a line was projected West at right angles to the corrected East line of Chambers County



Report of County Line Survey  
Jefferson & Chambers Cos.

June 15, 1909

Sheet 1 of 3

... in the matter of the survey...  
... Report of the County Line Survey...  
... This matter is ordered by the Court...  
... The Hon. County Judge and County Commissioners Jefferson and Chambers, Texas.

... Filed 10-21 1909  
By GARRY MAURO, Com'r  
(Douglas Howard)  
... Mr. Geo. W. White, Com'r of Chambers County

... see also Chambers Co. R.Sk. "CL"  
... the survey was made...  
... the line between the two...  
... the survey was made...  
... the line between the two...  
... the survey was made...  
... the line between the two...  
... the survey was made...  
... the line between the two...  
... the survey was made...  
... the line between the two...

Counted 51261



~~to the corrected East line of Chambers County,~~ a distance of 9614 varas to a point 41 varas South of a Cedar Post 10 inches square marked L. Co. S.E. Cor: J. Co. S.W. Cor. C. Co. this post is in general appearance the same age, dimensions and etc, as the one at the N.E. cor of Chambers County, and is undoubtedly the same one set by D.B. Wallis in the original survey in 1881.

We returned to the North East corner of Chambers County and corrected the foregoing preliminary line so as to place a perfect straight line between the cedar posts heretofore described as the N.E. corner of Chambers County and the S.W. corner of Jefferson County, on the North line of Chambers County,.

Having satisfied ourselves with the correctness of the foregoing points, from our survey, the notes and description given by D.B. Wallis and the working sketch furnished by the General Land Office, we proceeded to mark the boundary line by setting up a steel reinforced concrete monuments 10" inches square and 5 feet in length at each mile North from the Gulf beach, and West from the N.E. corner of Chambers County, said monuments were set exactly on the boundary line and extending 3 feet into the ground, as all these monuments are similar further description will not be given of them separately.

The cypress post mentioned in the field notes of our survey were undoubtedly set in a survey of the boundary line between Liberty and Chambers County in 1892 about 11 years subsequent to the original survey by D.B. Wallis. The corner adopted and verified by us as the S.W. corner of Jefferson County is mentioned in their description of their survey as being 443 varas south of their line, and the corner adopted and verified by us as being the Original N.E. corner of Chambers County is also described as being 494 varas South of their corner for the N.E. corner of Chambers County.

With the exception of our land boundary corrections which in many cases were obliterated and could not be located without extensive surveying, we feel assured that we have retraced and marked with permanent monuments the boundary line between Jefferson and Chambers Counties, as originally surveyed by D.B. Wallis, District Surveyor. All of which is hereby submitted for your approval.

Geo. W. White.

Surveyor Jefferson County, Texas.

H. J. Walger,

Surveyor Chambers County, Texas.

### Field Notes of a survey of the Boundary line between Jefferson and Chambers County's, Tex.

Beginning at a point on the Gulf Beach, N. 67° E. 185 varas from the S.W. cor. of James Earl survey set cement monument, marked S.E. Chambers and S.W. Jefferson: Thence North through salt grass marsh, at 1221 varas crossed old fence line on the east line of James Earl Survey at 1900.8 varas set monument No. 1. at 3801.6 varas set monument No. 2. at 4507. varas the South bank of Mud Bayou, 20 varas wide at 4826 varas crossed small bayou, 3 varas wide, and 20 varas East of a bend in Mud Bayou, at 5702.4 varas set monument No. 3, at 7603.2 varas set monument No. 5. at 11404.8 varas set monument No. 6 at 13305 6 varas set monument No. 7. at 14458 varas the charred stump of a cedar post brs. West 415 varas (the N.W. corner of T & N.O. Survey No. 297) at 15131 varas the N.E. corner of John White survey brs West 1290 varas at 15206.4 varas set monument No. 8. at 17107.2 varas set monument No. 9: at 19008 varas set monument No. 10. at 20016 varas center of marsh: at 20908.8 varas set monument No. 11. at 21809.6 varas set monument No. 12 at 23998 varas an old cedar post 8 inches square marked X brs West 25.5 varas: at 23630 varas South side Spindle Top Gully 10 varas wide at 23710 varas set monument No. 13. at 25860 varas crossed a fence on south line of T & N.O. Section No. 179, 647.5 varas from the S.W. corner of same, at 26611 varas set monument No. 14 at 27090 varas South Bank of Irrigation Reservoir: at 27450 varas North bank of Reservoir: at 27875 crossed fence on North line of T & N.O. R.R. Co. Survey No. 179 in center of Marsh, 642 varas from N.W. corner of same; at 28118 varas crossed fence bearing East and West at 28512 varas set monument No. 15. at 29160 varas South side of Irrigation reservoir at 29731 varas the center of graded road on the North boundary line of T & N.O. R.R. Co. Survey No. 160, 635.4 varas East of the N.W. corner of same; at 30412.8 varas set monument No. 16



Report of County Line Survey of

Jefferson & Chambers Cos.

June 15, 1909

Sheet 2 of 3

Field Notes of a survey of the boundary line between Jefferson and Chambers Counties, Texas.

Beginning at a point on the Golf Beach, N. 87° E. 185' varies from the S.W. cor. of James Earl survey set cement monument marked S.E. 1/4 Sec. 20 T. 23 N. R. 10 E. Thence North through salt grass marsh 1231' varies crossed old fence line on the east line of James Earl Survey at 1900.8' varies set monument No. 1. at 2301.6' varies set monument No. 2. at 4507' varies the South bank of Mud Bayou, 20' varies wide at 4826' varies crossed small bayou, 3' varies wide, and 20' varies West a bend in Mud Bayou, at 5702.4' varies set monument No. 3. at 7800' varies set monument No. 4. at 1404.8' varies set monument No. 5. at 11' varies set monument No. 6. at 1448' varies the corner of T. 23 N. R. 10 E. Survey set monument No. 7. at 1448' varies the corner of T. 23 N. R. 10 E. Survey set monument No. 8. at 17107.2' varies the S.E. corner of John White survey plat No. 227) at 18181' varies the S.E. corner of T. 23 N. R. 10 E. Survey set monument No. 9. at 18208.4' varies set monument No. 10. at 20015' varies set monument No. 11. at 20908.8' varies set monument No. 12. at 21803.2' varies set monument No. 13. at 23298' varies an old cedar post 8 inches square marked X plus West 28.5' varies: at 23830' varies South side Spindle Grove 10' varies wide at 23710' varies set monument No. 13. at 238' varies crossed a fence on south line of T. 23 N. R. 10 E. Section No. 17, 2' varies from the S.W. corner of same, 23811' varies set monument No. 14. at 27090' varies South bank of Roubidoux River, 23811' varies set monument No. 15. at 27090' varies crossed fence on south line of Roubidoux River, 23811' varies set monument No. 16. at 27090' varies crossed fence bearing East and West corner of same; at 28118' varies crossed fence bearing East and West corner of same; at 28118' varies set monument No. 17. at 28118' varies South side of section road, at 28118' varies the center of graded road on North boundary line of T. 23 N. R. 10 E. Survey No. 160, 23811' varies set monument No. 18. at 30412.8' varies set monument No. 19.

Surveyor Jefferson County, Texas.  
 H. J. Walger,  
 Surveyor Chambers County, Texas.

All of which is hereby admitted for your approval.  
 Geo. W. White,  
 Surveyor Jefferson County, Texas.  
 H. J. Walger,  
 Surveyor Chambers County, Texas.

With the exception of our land boundary corrections which in many cases were obliterated and could not be located without extensive surveying, we feel assured that we have retraced and marked with permanent monuments the boundary line between Jefferson and Chambers Counties, as originally surveyed by D.B. Wallis, District Surveyor. All of which is hereby admitted for your approval.

The express post mentioned in the field notes of our survey were doubtfully set in a survey of the boundary line between Liberty and Chambers County in 1888 about 11 years subsequent to the original survey by D.B. Wallis. The corner adopted and verified by us as their survey as being 443' varies south of their line, and the corner adopted and verified by us as being the Original N.E. corner of Chambers County is also described as being 494' varies South of the corner for the N.E. corner of Chambers County.

Chambers County is also described as being 494' varies South of the adopted and verified by us as being the Original N.E. corner of their survey as being 443' varies south of their line, and the corner adopted and verified by us as being the Original N.E. corner of Chambers County is also described as being 494' varies South of the corner for the N.E. corner of Chambers County.

Chambers County, said monuments were set exactly on the boundary line and extending 3 feet into the ground, as all these monuments are a clear further description will not be given of them separately.

Chambers County, said monuments were set exactly on the boundary line and extending 3 feet into the ground, as all these monuments are a clear further description will not be given of them separately.

Chambers County, said monuments were set exactly on the boundary line and extending 3 feet into the ground, as all these monuments are a clear further description will not be given of them separately.

counted 51263



at 30835 varas, South bank of Irrigation reservoir; at 31659 varas, North Bank of reservoir, on line between T & N.O.R.R. Survey No.159 and Lopez League, (2103 varas East of Lopez S.W. corner, and 629 varas East of N.W. corner of T & N.O. Survey No.159 ) ; at 32313.6 varas set monument No.17; at 33851 varas, passed 9 varas West of a depression where a cedar monument once stood; at 34214.4 varas set monument No.18; at 36115.2 varas set monument No.19; at 36690 crossed the line between the Lopez and Valmore Leagues, 2088 varas East of the N.W. corner of said Lopez League; at 37074 varas, center of Gulf and Interstate Ry. at 38016 varas set monument No.20; at 39916.8 varas set monument No.21. about 600 varas West of South end of Brushy Island; at 41713 varas the North line of Valmore League, 2072 varas East of its N.W. corner and the South line of T & N.O. Ry.Co. Section No.83, 18 varas West of its S.E. Corner; at 41817.6 varas set monument No.22, 20 varas South of Marsh; at 42952 varas set monument, marked N.E. corner Chambers & 22 varas West of a fence on the East line of T & N.O. Survey No.83, . Thence West <sup>making</sup> an angle of 90° 15' between the North & East line of Chambers County; at 551 vars the East bank of a pond 60 varas in diameter; at 828 varas crossed gully; at 1440 varas, crossed same gully; at 1900.8 set monument No.1 at 2565 varas crossed same gully; at 3586 varas, recrossed same gully at 3801.6 varas set monument No.2; at 4451 varas, a cypress post 8 inches square, brs.N.489.5 varas, marked 35 M.C.C.L. and L.C.L ; at 4637 varas crossed fence on line between T & N.O. Ry . Survey No. 82 and 81, 1257 varas North of their S.E. and S.W. corners respectively; at 5702.4 varas set monument No.3 in old Orchard at East edge of Little Pine Island Timber; at 6282 varas passed through the S.W. corner of an old branding pen; at 6408 varas the West side of Little Pine Island Timber; at 6696 varas center of marsh; at 7603.2 varas set monument No.4, on East side of large marsh; at 8072 varas, center of marsh; at 8515 varas an old levee on line between T & N.O. Ry.Survey 78-1/2 and 78-3/4 779 varas North of their S.E. & S.W. corners respectively; at 9288 varas crossed and old levee on E.line of T & N.O Ry. Survey No.30, 293 varas South of its N.E. corner; at 9504 varas set monument No.5, and at 9614 varas set monument for S.W. corner of Jefferson County and S.E. Corner of Liberty County, <sup>and</sup> the North boundary line of Chambers County 60 varas North of the channel <sup>of</sup> the marsh, . From this point an old cypress post 8 inches square, marked C.L.C. 32 on South side and L.C.L. on North side, bears N.51° 41' W. 704.5 varas distant.

We Geo. W. White and H. J. Walger, County Surveyors of Jefferson and Chambers Counties, respectively, do hereby certify that the foregoing survey was made according to law, and that the initial point, mile post and County Corners, with the marks, natural and artificial, are hereby described in the accompanying sketch and field notes, just as we established same on the ground.

Geo. W. White.  
County Surveyor, Jefferson Co. Tex

H. J. Walger  
County Surveyor Chambers Co. Texas

The State of Texas)  
County of Chambers) I, John Wooten Clerk of the County Court of said County, do hereby certify that the above and foregoing is a true and correct copy of the field notes and map of the East boundary line of Chambers County, as surveyed by H. J. Walger, County Surveyor of Chambers County and Geo. W. White, County Surveyor of Jefferson County, Texas, as the same appears from the Minutes of the Commissioners' Court of said Chambers County, and from the original papers now on file in my office.

Witness my hand and seal of office, this 4th, day of March, A.D.1910.

John Wooten Clerk,  
County Court Chambers County, Texas.



Report of County Line Survey  
Jefferson & Chambers Cos.

June 15, 1909

Sheet 3 of 3

at 30875 varas, south bank of reservoir, on line between  
North Bank of reservoir, on line between (2103 varas East of Lopez League, and 028  
varas East of N.W. corner of T & N.O. Survey No. 128) ; at 32313  
varas set monument No. 17, at 33851 varas, passed 9 varas west of  
depression where a cedar monument once stood; at 34214.4 varas a  
monument No. 18; at 35112.2 varas set monument No. 19; at 35690.0  
of the line between the Lopez and Valmore Leagues, 2038 varas East  
the N.W. corner of said Lopez League; at 37074 varas, center of  
Gulf and Interstate Rv. at 38018 varas set monument No. 20; at 39  
8 varas set monument No. 21, about 600 varas West of South end of  
Briarley Island; at 41713 varas the North line of Valmore League, 2  
varas East of its N.W. corner and the South line of T & N.O. Rv.  
Section No. 83, 18 varas West of its S.E. Corner; at 41817.6 varas  
set monument No. 22, 30 varas South of same; at 42222 varas set  
monument marked W.E. corner Chambers & N. varas West of a fence on  
East line of T & N.O. Survey No. 83, . . . . .  
90° 15' between the North & East line of Chambers County; at 551  
the East bank of a pond 60 varas in diameter; at 628 varas cross  
Gully; at 1440 varas, crossed same Gully; at 1900.8 set monument  
at 2555 varas crossed same Gully; at 3286 varas, recrossed same G  
at 3801.6 varas set monument . . . . .  
cross square, 67x. N. 489.5 varas, marked 35 M.C.C.I. and I.C.I.; at  
varas crossed fence on line between T & N.O. Rv. Survey No. 8  
81, 1257 varas North of their S.E. and S.W. corners respectively,  
5702.4 varas set monument No. 23 in old Orchard at East edge of li  
Pine Island Timber; at 6282 varas passed through the S.W. corner  
an old branding pen; at 6408 varas, the West side of Little Pine  
land Timber; at 6696 varas center of market; at 7003.2 varas set  
ment No. 24, on East side of large market; at 8072 varas, center of  
marsh; at 8516 varas an old levee on line between T & N.O. Rv. Sur  
78-12 and 78-34 789 varas North of their S.E. & S.W. corners re  
respectively; at 9228 varas crossed and old levee on E. line of T &  
Rv. Survey No. 30, 203 varas South of the N.E. corner; at 9304 var  
set monument No. 25, and at 9514 varas set monument for S.W. corner  
Jefferson County and S.E. Corner of Liberty County, the North  
boundary line of Chambers County, 60 varas North of the channel of  
the marsh. . . . . From this point an old cypress post 8 inches square,  
marked C.I.C. 32 on South side and I.C.I. on North side, bears N.  
41' W. 704.2 varas distance.

We Geo. W. White and H. J. Walger, County Surveyors of Jefferson &  
Chambers Counties, respectively, do hereby certify that the foregoing  
survey was made according to law, and that the initial points, mile  
post and County Corners, with the marks, natural and artificial, are  
hereby described in the accompanying sketch and field notes, just  
as established same on the ground.

Geo. W. White,  
County Surveyor, Jefferson Co.  
H. J. Walger,  
County Surveyor, Chambers Co. Tex.

State of Texas)  
County of Chambers) I, John Wooten Clerk of the County Court of said Co  
do hereby certify that the above and foregoing is a true and correct  
copy of the field notes and map of the East boundary line of Chambers County  
surveyed by H. J. Walger, County Surveyor of Chambers County and Geo. W.  
County Surveyor of Jefferson County, Texas, as the same appears in  
minutes of the Commissioners' Court of said Chambers County, and  
original papers now on file in my office.  
I witness my hand and seal of office, this 4th, day of March, A.D. 1909

County Court Chambers County, Texas.  
Countel 51265



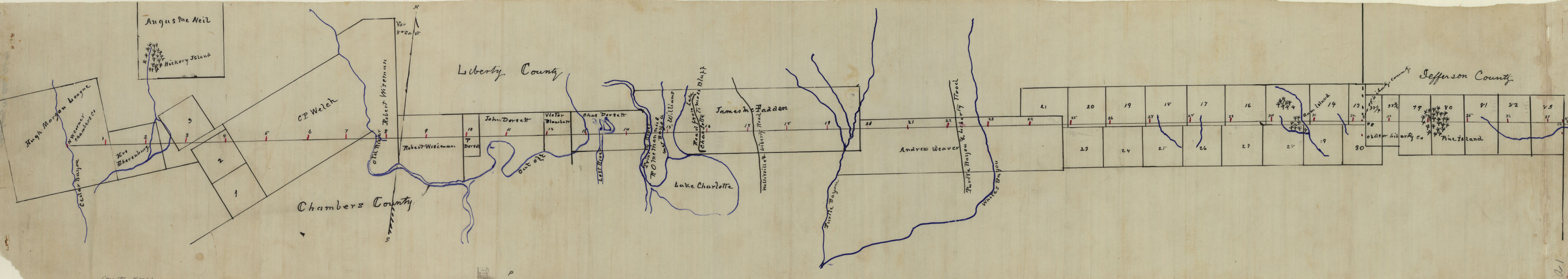

Counted 5/26/60

21