

REPORT OF SURVEYORS.

THE STATE OF TEXAS, #  
COUNTY OF RUSK. #

WHEREAS, by virtue of an order issued out of the Commissioners' Court of Cherokee County, at its regular May term, and entered on the minutes of said Court on the 13th day of said month, 1905, in Volume "E," page 263, appointed C. H. Hill, Special Surveyor, to represent Cherokee County in re-establishing the boundary line between the Counties of Cherokee and Rusk, and at said term of the Court the said Commissioners made a requisition on the County of Rusk to appoint a surveyor to assist in the survey and the re-establishing of the said boundary line; and, whereas, the said Commissioners' Court of Rusk County, at the regular term in August, passed an order appointing R. H. Thompson as Special Surveyor from Rusk County, to assist in said survey as provided by the statute.

Now, therefore, in obedience to said orders from said Courts, we, the undersigned surveyors, did, upon the fourth day of September, 1905, meet and enter upon the grounds and begin the survey of said line, and from day to day and from time to time make the said survey and finish and complete the said work the 9th day of December, as shown by the following field notes as made upon the ground by actual survey:

Beginning at the Southeast corner of Smith County, on the West line of Rusk County, a post in a mound, the same being 240 varas East of a former corner made heretofore erroneously, in 1902, from which a double red oak 18 inches in diameter, marked W.B.R.C. brs. S. 64 E. 10 vrs.; a red oak 12 inches, marked S.E.C.S.C. brs. N. 82 1/2 W. 17 1/2 vrs. a red oak 12 inches marked N.E.C.C.C. brs. S. 5 1/2 W. 14 vrs. Thence South with the said line between the said Counties at 1900 8/10 varas, the first mound or mile post in Allen Kershe's field, from which a hickory 10 inches marked C.C. brs. S. 8 W. 11 1/4 vrs. Another hickory 8 inches marked R.C. brs. S. 28 E. 15 vrs. at 2237 vrs. a black oak 20 inches marked R.C. & C.C. at 2336 varas, a spring branch one vara wide, C.S.E. at 2559 varas past the N.W. corner of the Joseph McAllister survey on the South line of the E. B. Foulks survey, at 2874 vrs. pass the N. E. corner of the T. A. S. Pratt survey, at 3734 varas, the Henderson & Troupe road, at 3801 6/10 varas, the two mile post in a mound, from which a P. O. 20 inches marked C.C. brs. N. 13 W. 21 vrs. Another P. O. 22 inches marked R. C. brs. N. 87 E. 20 1/2 varas; at 3829 6/10 vrs. pass the Southeast corner of said Pratt survey, and the Northeast corner of the Wesley Dyke survey, at

5702 4/10 varas, the three mile post in the Southeast corner of Jack Scroggins' field, from which a dead oak 36 in. brs. S. 2 W. 31 vrs., a dead Pine 20 inches brs. N. 52 1/2 W. 7 1/2 varas, at 6630 varas, Bowles Creek 15 varas wide, C.S.W., at 6760 varas, Bowles Creek, C.S.E., at 6840 varas, same creek C.S.W. at 7230 varas, same creek C.S.E. at 7603 2/10 varas, the four mile post in a mound, from which a pin oak 20 inches, marked R.C. brs. N. 8 1/2 E. 7 1/2 varas. Pin Oak 18 inches brs. S. 8 1/2 W. 8 varas, marked C.C., at 7658 varas same creek C.S.W. at 7753 varas, the old Henderson & Jacksonville road, at 8008 2/10 varas passed an old corner and line going east, at 8103 same creek C.S.E., at 8193 2/10 varas pass the Southeast corner of the Wesley Dyke survey, and the Northeast corner of the Perry Reese survey, at 8493 same creek C.W. at 9504 varas, the fifth mile post in Bowles Creek, at 10573 varas same creek C.S.E. at 11089 8/10 varas pass the Southeast corner of the Perry Reese survey, and the Northeast corner of the R. H. Tobin survey, at 11404 8/10 varas, the six mile post in a mound, from which a red oak 18 inches marked R.C. brs. N. 20 E. 3 varas, hickory 6 inches marked C.C. brs. S. 2 W. 2 3/4 varas, at 11950 varas, pass the Northwest corner of John Clay's place, and at 12157 varas pass John Clay's house 13 2/10 varas to the East, at 12527 1/2 varas pass the Southeast corner of the Tobin and the Northeast corner of the Elizabeth Taylor surveys, at 12624 varas pass the Southwest corner of the Thos. Fannin survey, at 12944 varas, a branch C.E. at 13305, the seven mile post in the channel of Bowles Creek C.S.W. at 13424 varas same creek C.S.E., at 13545 same creek C.W., at 13629 varas, same creek C.S.E. at 13725 1/2 varas, Pin Oak for line tree, at 13951 varas West bend of said creek at 14122 varas, an old line running East and West and an old corner 19 varas to the West, at 14958 varas, Stricker Creek 20 varas wide C.S.W. at 15206 4/10, the eight mile post in a mound from which a Pin Oak 10 inches C.C. West 2 varas, Pin Oak 16 inches brs. N. 14 1/2 E. 8 1/2, marked R.C. at 15565 4/10, Sweet Gum 40 inches marked R.C. and C.C. at 17107 6/10, nine mile post in a mound in G. D. Boatright's field, at 17484 2/10 varas, the Henderson and Lone Star road, at 17737 2/10 varas creek two varas wide C.S.W. at 18371 varas the N.B. line of the J.I. Sanchez survey, at 18917 varas, a double red oak for line tree, at 18927 6/10 varas, another double red oak for line tree, at 19008 varas the ten mile post in a mound from which a hickory 16 inches marked R.C. brs. S. 87 1/2 E. 1 1/2 varas, a black jack 16 inches marked C.C. brs. N. 41 1/2 W. 2 vrs., at 19438 6/10

varas, old Henderson and Rusk road, 20338 6/10 varas, branch C.S.W. at 20908 8/10, the eleven mile post in a mound from which a post oak 16 inches marked C.C. brs. N. 44 W. 6 1/2 varas, Sweet Gum 14 inches marked R.C. brs. N. 64 E. 7 1/2 varas at 21248 8/10 varas, branch two varas wide C.S.W. 21623 8/10 varas, a branch C.S.W. 22669 8/10 varas, an old ditch in the Montgomery field, C.S.W., at 22809 varas the twelve mile post in a mound, from which a sweet gum 8 inches brs. South 3 1/2 varas, at 23189 6/10 varas, a slough 10 varas wide, C.S.E., at 23371 varas, the South line of the Sanchez league and the North line of the B. C. Walters' league, at 24157 6/10 varas, an Elm 22 inches marked R.C. & C.C., at 24710 7/10 varas, the thirteen mile post in a mound from which a white oak 24 inches marked R.C. brs. N. 56 E. 5 varas. A hickory 15 inches in diameter marked C.C. brs. N. 54 W. 7 varas, at 24820 4/10 varas, a slough 10 varas wide, C.S.E., at 25495 4/10 varas, Stricker Creek, C.S.E., at 26230 4/10 varas, branch C.E. at 26245 4/10 varas, same branch, C.N.W., at 26280 4/10 varas, channel of same branch, at 26305 4/10 varas, pass out of the channel of said branch, at 26325 4/10 varas, same branch C.N.E. at 26341 4/10 varas, same branch C.N.W. at 26405 4/10 varas, same branch C.N.E. at 26611 2/10 varas, the fourteen mile post in a mound from which a pin oak 14 inches marked R.C. brs. S. 66 1/2 E. 1 vara, a maple 5 inches marked C.C. brs. N. 63 1/2 W. 3 1/2 vrs., at 26806 2/10 varas, the New Salem and Lone Star road, at 27561 2/10 varas, branch C.E. at 27576 2/10 varas, passed a sweet gum with corner marked on it 15 varas to the East of this line, at 28371 varas, the South line of the Walters league, at 28341 2/10 varas, branch C.E. at 28512 varas, the fifteen mile post in a mound, from which a black jack 16 inches brs. S. 37 E. 2 6/10 varas and marked R.C., a post oak 8 inches marked C.C. brs. S. 57 W. 3 1/2 varas, at 29057 varas, a black oak 22 inches marked R.C. & C.C. at 29864 varas, a branch C.E. at 30148 varas, the North end of Sam P. Richie's dwelling, at 30413 8/10 varas, the sixteen mile post in a mound from which a post oak marked C.C. brs. S. 63 W. 7 varas, a post oak 18 inches marked R.C. brs. N. 57 E. 3 3/4 varas, at 30501 8/10 varas, branch C.N.E. at 31552 8/10 varas, iron stake 70 varas East of G. W. Richie's house, at 32316 6/10 varas, the seventeen mile post in a mound from which a red oak brs. N. 76 W. 2 3/4 vrs. marked C.C. and a hickory marked R.C. brs. N. 16 E. 5 1/2 varas at 32610 varas, the South line of the G. W. Jewel and the North line of the S. J. Nelson 334 1/2 varas East of the Northwest corner of the latter survey, at 33233 6/10 varas, branch C.S.W.

at 33362  $6/10$  varas a post oak 16 inches marked R.C. & C.C. at 33703  $6/10$  varas, the South line of the said Nelson survey and the North line of the Mary Able survey, at 34055  $6/10$  varas, the New Salem and Reklaw road, at 34214  $4/10$  varas, the eighteen mile post from which post oak 24 inches marked C.C. brs. N. 5 W. 16  $1/4$  varas, a post oak 24 inches marked R.C. brs. S. 17  $1/2$  E. 21  $3/4$  varas, at 35684  $9/10$  varas, the North line of the town of Reklaw, and the South line of Mrs. Walker's line, 340 varas East of the West line of the Mary Able West line, at 36115  $2/10$  varas, a piece of iron piping for the nineteen mile post in the street known on the map of the town of Reklaw as Henderson street from which the Northwest corner of the Dallas Foreman storehouse brs. S. 64  $3/4$  W. and the Southwest gallery post of the Hughes storehouse brs. S. 71  $1/2$  W. at 36585  $2/10$  varas, the South line of the town of Reklaw and at 36690  $2/10$  varas, the center of the T. & N. O. R.R. C.N. 53 W. at 37074  $2/10$  varas black gum 16 inches marked R.C. & C.C. at 38016 varas the twenty mile post in a mound on the East side of a pin oak from which a pin oak 18 inches marked R.C. brs. N. 11 E. 10  $1/4$  varas. Another pin oak 24 inches marked C.C. brs. S. 6 W. 22 varas, at 38246 varas, the Southwest corner of Rusk County, a post on the West edge of a slough of Mud Creek from which a sweet gum 22 inches brs. N. 57 E. 6 varas, marked S.W.C.R.C., a pin oak 20 inches brs. N. 60 W. 9 varas, marked N.E.C.C.C. Thence East at 322 varas old run of White Oak Creek, at 1401 varas branch C.S.W. at 1573  $8/10$  varas, the center of the T. & N. O. R.R. C.N. 38  $1/2$  W. at 1798 varas a mile post in a mound, being two miles West from the Angelina river, from which a hickory 14 in. marked R.C. brs. N. 68 W. 7 varas, a post oak 18 inches marked C.C. brs. S. 54 E. 13  $3/4$  varas, the section house on said railroad brs. S. 15 E. about 200 varas, at 2446  $8/10$  varas, a red oak 14 inches marked R.C. & C.C. at 2702  $8/10$  varas, a pine 18 inches marked R.C. & C.C. at 3274  $8/10$  varas, the New Salem and Sacul road, at 3560  $8/10$  varas, a red oak 14 inches marked R.C. & C.C. at 3599  $6/10$  varas, the East line of the Mary Able survey 163 varas North of the Northwest corner of the B. A. Stone survey, at 3698  $8/10$  varas, a mile post in a mound, being one mile from the Angelina river, from a black jack 10 inches marked C.C. brs. S. 79 E. 1  $1/2$  varas, red oak 13 inches marked R.C. brs. N. 64 W. 12  $1/2$  varas, at 3764  $8/10$  varas, a sweet gum 20 inches marked R.C. & C.C., standing in the edge of a dry branch C.S.E. at 4994  $6/10$  vrs., a slough C.S. at at 5599 -  $6/10$  varas, a post on the West **Bank** of the West fork of the Angelina river

and the Northwest corner of Nacogdoches County, on the South line of Rusk County, about seventy five varas above the forks of the two Angelinas, from which a bitter pecan brs. N. 55 W. 8 varas and marked N.E.C.C.C., a hickory 14 inches brs. S. 28 W. 9 varas marked N.E.C.C.C. This corner being 163 varas North of the South line of the Rebecca Gray survey. Completing the survey on the 9th day of December, 1905, as directed by the Commissioners' Courts of the respective Counties as aforesaid.

Respectfully submitted,

R. H. Thompson,  
Surveyor for Rusk County, Texas.  
C. H. Hill,  
Surveyor for Cherokee County, Texas.

Sworn to and subscribed by R. H. Thompson before me, this the 1st day of February, A.D., 1906.

Hall Wood,  
Clerk, County Court, Rusk County, Texas.

Sworn to and subscribed by C. H. Hill before me, this the 10th day of February, A.D., 1906.

C. M. Hill,  
Notary Public, Shelby County, Texas.

THE STATE OF TEXAS, #  
COUNTY OF CHEROKEE. #

I, L. W. Tittle, Clerk of the County Court, in and for said County and State, hereby certify the above and foregoing five pages to be a true and correct copy of a Report of Surveyors, appointed by the Honorable Commissioners' Court, as the same appears of record in Volume "E," pages 329 to 334, Minutes of the Commissioners' Court of Cherokee County, Texas, in my office. *also a true copy of maps showing the line as located by the Surveyors.*

Given under my hand and seal of office, at Rusk, Texas, this the 16th day of February, A.D., 1906.

L. W. Tittle  
Clerk, County Court, Cherokee County, Texas.



Map showing a survey of the Boundary line between Cherokee and Rusk Counties as run by R.H. Thompson and C.H. Hill Surveyors.

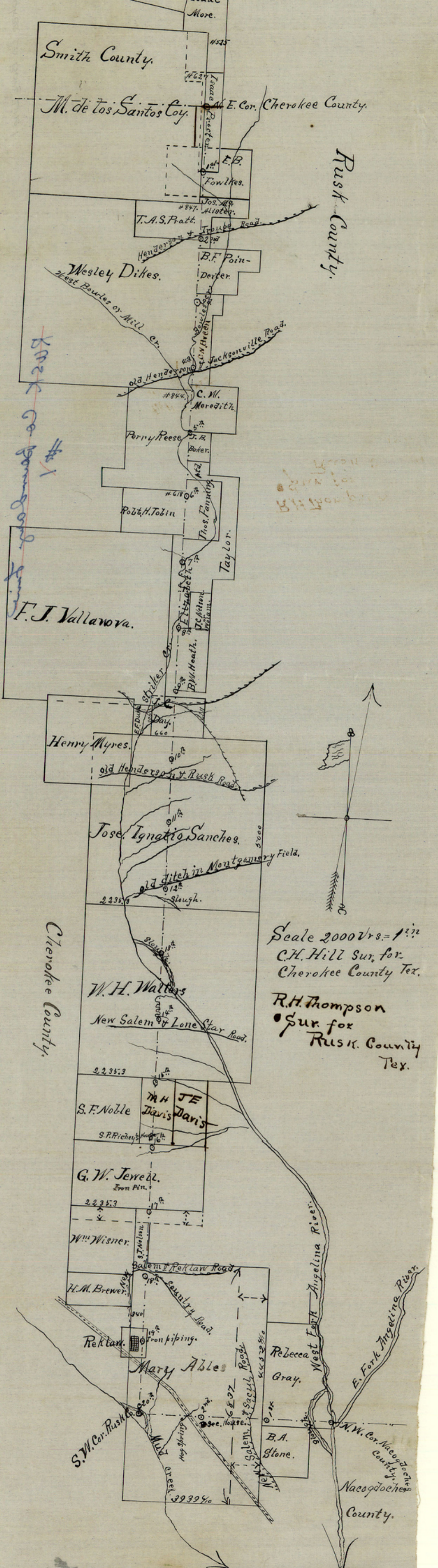

Breck Co. Boundary

Rusk County.

Cherokee County.

Scale 2000 Yrs. = 1<sup>1/2</sup> in.  
C.H. Hill Sur. for Cherokee County Tex.

R.H. Thompson  
Sur. for Rusk County Tex.

A6 31 32 33 34  
23 258 60 2089 2090 244 1852 W 1887 1893 24  
4 Bk A.

Chas Parke

Galveston, Harrisburg & San Antonio

Railway Company

23 30 29 28 27 26 25 24  
4 59 2088 2087 2086 23  
Fe 2508 ptd 58 1037 1036 Mrs C. Isaac O. Still Noble Well  
55 56 399 256 2083 2084 2085 1039  
32 2831 ptd 57 4 18 17 16 15 14 2080  
Company 53 54 3 5 6 9 10 11  
G. C. & S. F. Block A4

George K. Weaver Rutledge Morris  
er Gibson 225 370 521  
k OV2. 395 16 14  
Sarah Haggard 1484  
George Thompson  
Robt W. Presser  
Wind Mill. 10  
1074 1847 23  
G.C. & S.F. R.R. Co  
1786 ptd

John F. Finnerty Mrs. S. C. Craig  
1772 7861 696 1644 W. B. Rome  
12 40 39 38 37 30 22  
G. Ruiz B.F. Goss  
1159 1159 1986  
Mary A. Smith 2116 2115 35  
Emilio Diaz

G. Ruiz 19  
1159 1986  
Emilio Diaz

Cherokee Co. Bdry Line

County Boundary  
Rusk & Cherokee Cos.

March 30<sup>th</sup> 1906

County 51279