

Cochran Co.

6

FILES

along the boundary lines of:

COCHRAN,

HOCKLEY,

TERRY, and

YOAKUM counties

} Notified  
the Assrs.  
of these Cos.  
v L.A. Harris  
5/15/35

abstracted for Volume 57, according to the acreage division made by A L Harris, State Surveyor, but later taken off the abstract sheets on account of protest filed here by the County Judge of Hockley county.

May 15, 1935

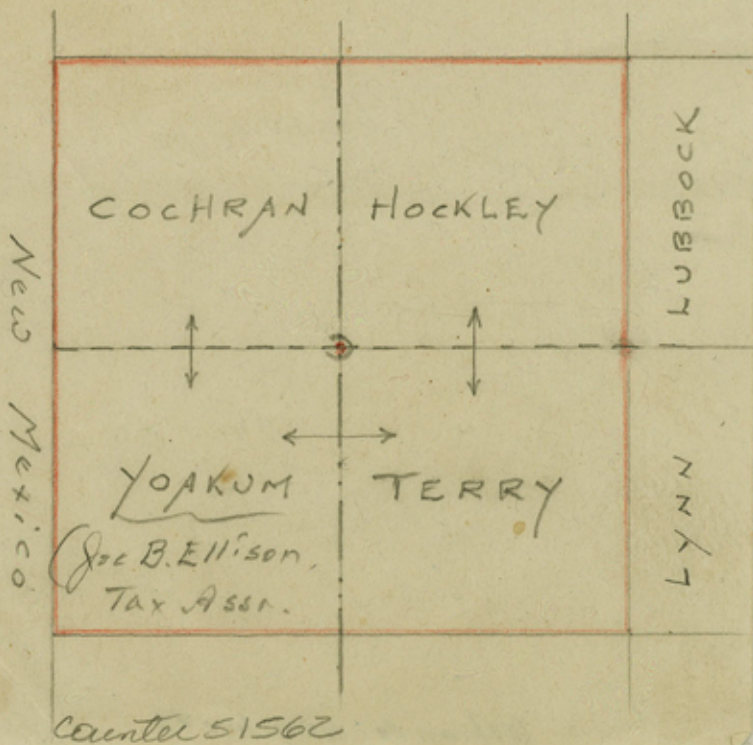

# COCHRAN Co.

---

70442

72088-9

72102-3-5-7-8-9-10-29

64-5-6

72687-95

880-1

934

73037-40

930-1-2-3

74010-11-42-3

75725-6.

896-7

77957

82346

118204-9

# TERRY Co.

70085-7-90-1-2-3-7-8-9-

100-1-3-4-5-6-12-13-26-7-

8-9-34-45-6-50-1-2-3-4

70177

442-6

801

72800

933-4-94

76160-1

86208

92794-

93960

94253

95715

96132-3-4

99455

109047

111198

112686

118308

120008

287

325

432-4-72

121338-9

123760

124941

125034

431-75

844-5-6-7-54

126285-129063

130041

640

131858

132399

741

134837

135589

137862-73

141007

813

142219

431

521-2

752-66

143152

144822-

999

145079

146086

478

147698

847-8

# HOCKLEY Co.

70085.7-90-1-2-3.7-8-9

100-1-3-4-5-6-12-

13-26.7.8-9

34-45-6-50-1-2-

3-4-77

72933-4

94

76160-1

92794

93960

95715

99455

109047

112686

124941

129063

130041-

640

131858

135589

141007

YOKUM CO.

S.F. 10480.

72042-3-88-9	137862-73
102-3-5-7-9	141813
110-29-64-5-6	142219
687-95	306 1/2
725-6	431
880-1	521-2
933-4-94	752-66
73037-40	846
930-1-2-3	143152
74010-11	144999
75896-7	145079
77957	146086
82346	478
86208	147698
94253	847-8
96132-3-4	
111198	
118204-9	
308	
120008	
287	
432-4-72	
141338-9	
472	
123760	
145034	
431-75	
844-6-7-54	
126285	
134837	