

2 No 17

Boundary line
in County of
Coleman

and the Counties of
Callahan, Brown
and Russell

Filed May 26th/84 and
May 11th 1885.

Abstract Corrected on the
line between Coleman & Brown
and Copy for'd Comp June 27/85

Abstract Corrected between
the Co of Coleman & Counties
of Callahan & Russell. June
21st 1885 & Copy handed
the Com for Pub Acts.

Resubmitted

Counter 51628

County Surveyor of Coleman County.

Coleman, Texas, May 20 1884

W. C. Walsh

Gen Land Com

Dear Sir:
 Enclosed you will find
 Survey E-B Line Coleman &
 \$1.00 recording fee, Please let
 us know if the work will be appr
 ed ~~of~~ our County want to estab
 sh ~~his~~ other lines as soon as this
 one is adapted

Yours truly

J. J. Evans

Sur C & L

Rec'd 5/26/84, P.M. - of which is returned, there
 being no fee

J. D. Roberdeau
 Recd

Spn. returned 5/26/84

Milson

nty line
between

Coleman & Brown
Counties.

Filed May 26th
1884.

D. N. Robinson
Chf Clerk.

Abstract corrected
June 27th 1884

Recessed

No 17(1)

11

8

12

Counters E1632

Ordered that the field notes of the Plat
of a survey of the line dividing Coleman
and Brown Counties made by J. J. Evans
Surveyor Coleman County and
W. B. Morgan Special Surveyor for
Brown County, Texas be approved
and that the same be recorded in
the Deed records of Coleman County Tex
to be by him returned to the Commis-
-sioner of the General Land office

The State of Texas }
County of Coleman } L. L. Williamson
County Clerk in and for Coleman
County Texas hereby certify that the
above is a true copy of the order
approving the field notes and Plat
of a survey of the County line between
Coleman and Brown Counties, as ap-
-pears upon the Minutes of Commis-
-sioners Court Journal Book 6 page 27
Witness my hand and official at
office in Coleman this May 15th 1884.

L. L. Williamson
County Clerk Coleman Co Tex
By P. P. Williamson Dep.

Certified Copy

of

an order

Commissioners Court
Journal page 27 of
Book C.



1 MEPR PRCO.

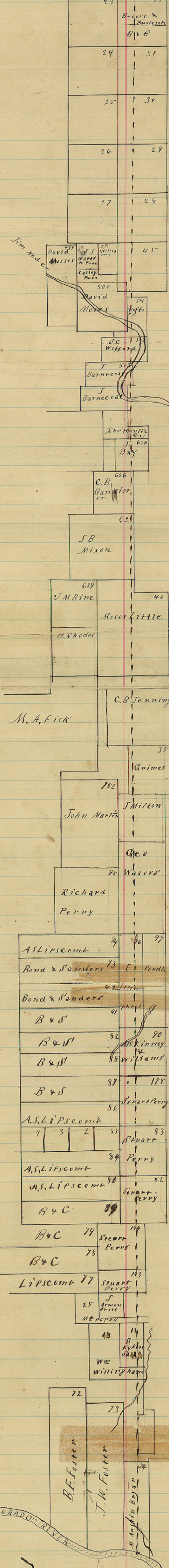

COLORADO RIVER

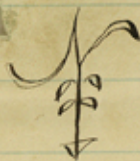

No 181.

Comal County School Land

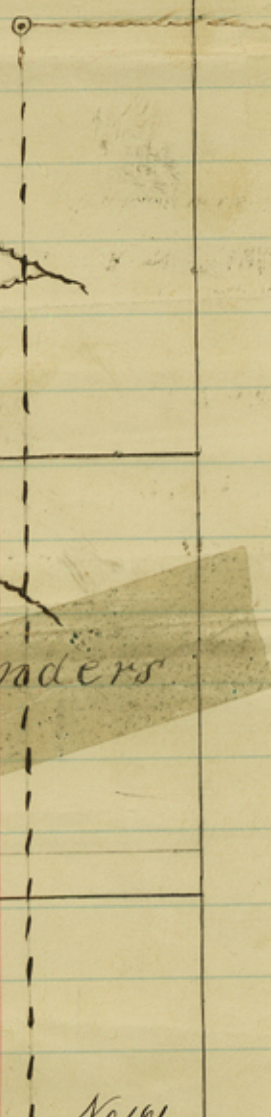
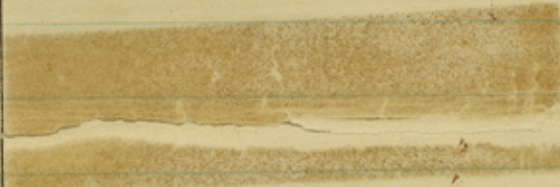

John Sanders

No 101

Alex. White

Variation 9.36 E

The State of Texas

Coleman County. Field notes of a survey of the West Boundary Line of Brown County 2nd East Boundary Line of Coleman County made by virtue of an order of Commissioners Court of Brown County at its June called Term of said Court A D 1883 And by order of Commissioners Court of Coleman County at its August Term A D 1883.

Beginning at a stone marked N.W. B.C.C. 2nd N.E.C.C. 16 M. Sixteen miles west of N.E. corner Brown County in the South Boundary line of Callahan County from which a Post Oak, 13 ins in dia marked N.E.C.C. brs S 86 1/2 W 49 or 4 a Live Oak 15 ins in dia marked NW B.C. brs S 34 1/2 W 35 3/5 ors Thence South 1900 ors Stone from which a Post Oak 18 ins in dia marked C.C.L. 1. M brs S 17 1/2 W 28 3/5 ors & Do 16 ins in dia ^{marked} B.C.L. 1. M brs S 15 E 30 1/5 ors Thence South 220 ors branch 390 ors prong of said branch 1900 ors Stone from which a Live Oak brs N 76 E 44 ors marked B.C.L. 2 M Do 12 ins in dia marked C.C.L. 2 M brs S 82 W 32 ors Thence South 422 ors cross Comal county Survey No 181 its South boundary line 2753 ors West of its S.E. cor

Johnson Co. Ark., June 17, 1871

1520⁰⁰ vs cross branch 1900⁰⁰ vs stone
 from which a Live Oak 5 ins in dia marked
 BCL 3 M. brs N 5 E 23⁰⁰ vs & Do 8 ins in dia
 marked CCL 3 M brs N 29 1/2 W 30⁰⁰ vs Thence
 South 1900⁰⁰ vs Stone, from which a Live
 Oak 12 ins in dia marked BCL 4 M brs N 8 2/4
 E 46 1/2⁰⁰ vs Do 8 ins in dia marked CCL 4 M
 brs N 46 1/2 W 56⁰⁰ vs Thence South 1268⁰⁰ vs
 cross South Boundary line of John
 Sanders Survey 1900⁰⁰ vs Stone from
 which a Live Oak 9 ins in dia marked
 BCL 5 M brs N 65 1/2 E 41⁰⁰ vs Do 7 ins in
 dia marked CCL 5 M brs S 41 W 77⁰⁰ vs
 Thence South 1900⁰⁰ vs Stone from which
 a Live Oak marked BCL 6 M brs S 81 1/2 E
 14 1/5⁰⁰ vs Thence South 1360⁰⁰ vs branch
 1420⁰⁰ vs cross branch 1900⁰⁰ vs Stone
 from which a Post Oak 9 ins in dia
 marked CCL 7 M brs S 71 W 14 3/4 Do 12 ins in
 dia marked 11 1/2 E 28 3/5⁰⁰ vs Thence South
 400⁰⁰ vs cross Shifers Branch 985⁰⁰ vs
 center of Pecan Bayou 1512⁰⁰ vs cross
 South Boundary line of Alex White
 Survey no 161. 145⁰⁰ vs East from T.H. Mahan
 Survey no 160 N W Corner 1900⁰⁰ vs Stone
 from which a Post Oak 9 ins in dia
 marked CCL 8 M brs N 59 W 23 3/5⁰⁰ vs
 Thence South 350⁰⁰ vs cross Gobler Branch

2

Ch 64500 cross Hay creek 1030000 cross
Same 1090000 recross same 1900000
Stone from which a Post Oak 10 ins in
dia marked B.C.L. 9 M hrs S $75\frac{1}{2}$ E $13\frac{3}{4}$ 000
Do marked C.C.L. 9 M hrs S 29 W $13\frac{1}{2}$ 000
Thence South 650000 cross small
ravine 1900000 Stone from wh a Post
Oak 8 ins in dia marked B.C.L. 10 M. hrs
S 51 E 1900000 Thence South 1900¹⁰000 Stone
in Jennings field from which a Post
Oak 10 ins in dia marked B.C.L. 11 M. hrs
S $14\frac{1}{2}$ E 1190000 Thence South 1136000
cross S.B. line of section No 30 survey
ed for H T & B R R Co 546000 East of
S W corner, 1790000 cross ravine 1900¹⁰
000 Stone from which a Post Oak 6 ins
in dia marked B.C.L. 12 M hrs S $48\frac{1}{2}$ E $13\frac{3}{4}$
000 Do 5 ins in dia marked C.C.L. 12 M.
hrs N 65 W $4\frac{1}{2}$ 000 Thence South 1125
000 cross S-line section No 29. H T &
B R R Co Survey. 1900¹²000 Stone from
which a Post Oak 9 ins in dia marked
C.C.L. 13 M. hrs S 83 W 13 000 & a Do
5 ins in dia marked B.C.L. 13 M hrs
N 72 E $12\frac{3}{4}$ 000 Thence South 1158000
cross South line of section 28 H T &
B R R Survey 441000 East of its S W corner
1900000 Stone from which a double Post
Oak hrs N $10\frac{1}{4}$ W 70 000 marked C.C.L. 14 M

Coleman Co. Survey. Unit # 1721

Thence South 1248 vrs cross South
Boundary line of Section 45 N 7 & BR Re-
Survey. 1900 stone in the Valley of Jim
Ned creek Thence South 440 vrs to the
Center of Jim Ned creek Thence South
860 vrs passed 1180 vrs East of S E corner of
David Moses Sur- No 500. 1268 vrs cross
Comanche & Coleman road 1715 vrs Lake
1900 vrs Stone from which an Elm
12 ins in dia brs N 1 E 69 3/4 vrs Marked
B C L 16 M Thence South 375 vrs
cross Jim Ned creek 1700 vrs
re-cross Jim Ned creek 1900 vrs Stone
set in field 180 vrs South of the bank
of Jim Ned creek Thence South 530
vrs Bank of a Lake 1680 vrs cross N. W.
line of Jeremiah Day Survey No 630.
578 vrs East of its N W corner 1900 vrs
Stone from which a Post Oak 8 ins in
dia marked B C L 18 M brs S 54 1/2 E 45 3/4 vrs
& Do 10 ins in dia marked C. C. L. 18. brs N 10 W
30 vrs Thence South 300 vrs creek Mouth
of a ravine 970 vrs cross Brown Wood
& Coleman City road 1900 vrs Stone
from which a Live Oak 13 ins in
dia marked C C L 19 M brs N 43 W 63 3/4
vrs Thence South cross Little Mud
Creek 1375 vrs cross creek 1475 vrs

cross creek 1900. vs Stone 20 vs East-
of the bank of a creek from which a Live
Oak 20 ins in dia marked BCL 20 M
brs N 57 1/2 E 39 vs Thence South 395-
vs cross Little Mud creek 710. vs
recross same 1900 vs Stone from
which a Live Oak 10 ins in dia
marked BCL 21 M brs N 31 E 81 vs
Thence South 1900. vs Stone from which
a Past Oak 9 ins in dia marked B.C.L. 22.M.
brs N 21 1/2 E 11 4/5 vs Thence South 1640
vs cross N Line of Moses Little survey
1900 vs Stone from which a Past
Oak 14 ins in dia marked BCL 23 M
brs S 9 E 16 vs Thence South 1220. vs
cross Pugh Hollow 1900. vs Stone from
which a Past Oak 12 ins in dia marked BCL
24 M brs N 72 E 8. 4/5 vs Do 9 ins in dia
mark CCL 24 M. 14 4/5 vs from ^{the} Stone
Thence South 1244 vs cross Brown
Wood & Coleman ^{City} road 1840 vs
cross North line of Millers Survey
1900. vs Stone from which a Past Oak
8 ins in dia marked BCL 25 M brs
S 29 E 14 vs Thence South 1900. vs
Stone Black Jack 8 ins in dia marked
CCL 26 M brs N 57 1/2 W 34. vs Thence
South 350 vs pass 10. vs East of
bank of creek 917. vs cross prong of a

Section to Bldg line # 17 (1)

a tree marked \bar{x} 730 vrs pass 10 vrs East
of a bank of a creek 917 vrs cross prong of
Mike Water creek 1900 vrs Stone in Coffee
field Thence South 565 vrs cross road
800 vrs cross branch 1900 vrs Stone in Prai-
rie Thence South 1900 vrs from which
a Post Oak 13 ins in dia marked C.C.L. 29
M. brs N 13 W 82 $\frac{3}{5}$ vrs Thence South 1900
vrs Stone from which a Mesquite
Stump marked C.C.L. 30. M Thence
South 452 vrs cross South boundary
line of E Humphreys Survey no. 96.
320 vrs West of SE corner of said no. 96.
850 vrs cross Mike Water creek East prong
1900 vrs Stone from which a Live Oak 10 ins
in dia marked C.C.L. 31 M brs S 8 W 33 $\frac{1}{2}$ vrs
Thence South 625 vrs cross J L Vaughn
Pasture fence 1900 vrs Stone Thence
South 1900 vrs Stone on a hill Live
Oak 12 ins in dia marked C.C.L. 33 M
brs N 11 W 125 $\frac{3}{4}$ vrs. Thence South 1900
vrs Stone in prairie from which
a Live Oak 8 ins in dia marked C.C.L.
34 M brs S 21 $\frac{1}{2}$ W 124 vrs Thence South
1900 vrs Stone from which a forked
Live Oak 10 ins in dia marked C.C.L.
35. M. brs S 69 $\frac{1}{2}$ W 83 vrs Thence South
1900 vrs Stone from which a Live

Oak 10 ins in dia marked C.C.L. 36 M.
125.00 vs from the stone. Thence South
1900 vs stone from which a Post-Oak
12 ins in dia marked C.C.L. 37 M brs S 32 1/2
W 63 vs ^{Thence South 1900 vs stone.} Thence South 525 vs pass
123 vs East of the Pugh Preemption 1900
vs stone from which a Elm 8 ins in
dia marked C.C.L. 39 M brs S 26 W 12. vs
Thence South 602 vs pass 280 vs West
of SW corner of Beady Survey. 1020 vs
cross Boggie creek 1900. vs stone pro.
which a Live Oak 8 ins in dia marked
B.C.L. 40 M brs S 38 1/2 E 11 3/5 vs Thence
South 1900 vs stone on top of West-
Brough of a Mountain Thence
South 1480 vs stone ^{on} the bank of Color-
ado river from which a thrible Elm
brs S 73 W 30 vs marked X Do 8 ins in dia
brs N 62 W 18 vs marked X Do 5 ins in dia
marked S.W. Co BC brs N 72 E 18 vs stone
marked S.W. Cor BC & S.E. Cor C.C. 41 M
1400. vs. Mile stones marked B.C.L. & C.C.L. &
distance. Lin trees marked ≡

Surveyed March 24. " 25. " 26. " 27. " 28. " 29. " A.D. 1884

G. W. Grady } chain
A. J. Dillon } carrier

I. J. Evans Surveyor Coleman
County do hereby certify that foregoing
survey was made according to Law

and that the limits boundaries and corners with marks natural and artificial are truly described in the foregoing plat and field notes and the work was actually done on the ground and they are recorded in book & No 2428
 249th in my office.

J. I. Evans
 Surveyor Coleman County

W. C. Morgan - Special
 Surveyor Brown Co. & Co.

Filed in my office for
 Record May 14th 1884
 at 12 o'clock No.
 L. C. Williamson
 Cr. Clk. C. C. Co.
 P. P. Williamson Dep.

1702

THE STATE OF TEXAS, }
 Coleman County. } I, L. O. WILLIAMSON, County Clerk in and for said County,
 do hereby certify that the foregoing instrument was filed for Record in my office, the
 14th day of May 1884 at 12 o'clock M., and duly recorded
 the 15th day of May 1884, in the Records of said County, in Book
 No. 1152
 On page 1152.

WITNESS MY HAND and the Seal of the County Court of said County, at
 office in Coleman, Texas, the day and year last above written.

L. C. Williamson
 County Clerk, Coleman County, Texas.
 By P. P. Williamson Deputy.

