

A.L. Clement

Cattle Co. Bldg.
Wm. H. ...
...

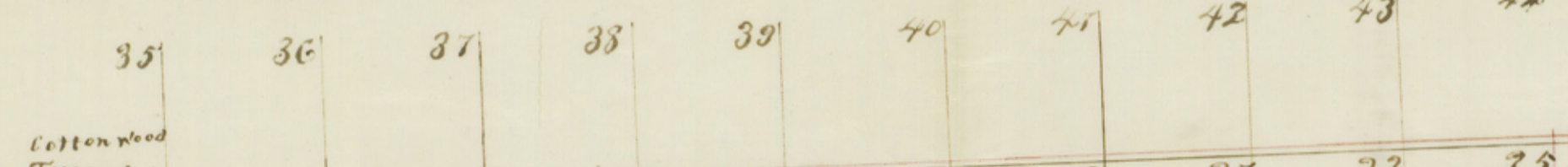

M. Forsythe Bldg. B.



R. M. Thompson

Bldg. M.

T. A. Thompson

Bldg. M.

Matador Cattle Co.

Bldg. E.

Paducah

R. M. Thompson

WE, A. A. NEFF & D. L. REAVIS, Do hereby certify that the foregoing Plat is true & correct according to the work done on the ground on the 11, 12, 13, & 14 days of Jan. 1893

A. A. NEFF, Sur. Cattle Co.
D. L. REAVIS, Sur. ...
of Ford County,

J. G. Short, do hereby certify that I was authorized to sign the names of A. A. Neff & D. L. Reavis to the foregoing Plat.

Witness my hand this the 18th day of Feb. 1893.
J. G. Short,

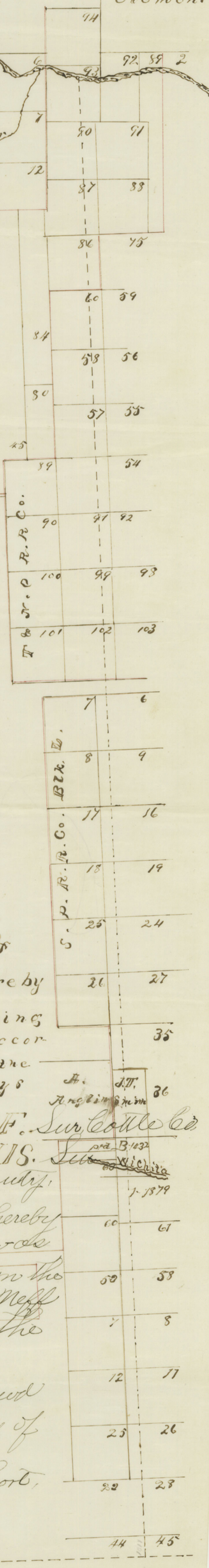

①
 This sketch is not
 signed officially
 Sketch of the
 Co. body of Cottle Co.
 Filed Febry 18th 1890.
 Cottle Co. Bdry.

Counter 51956

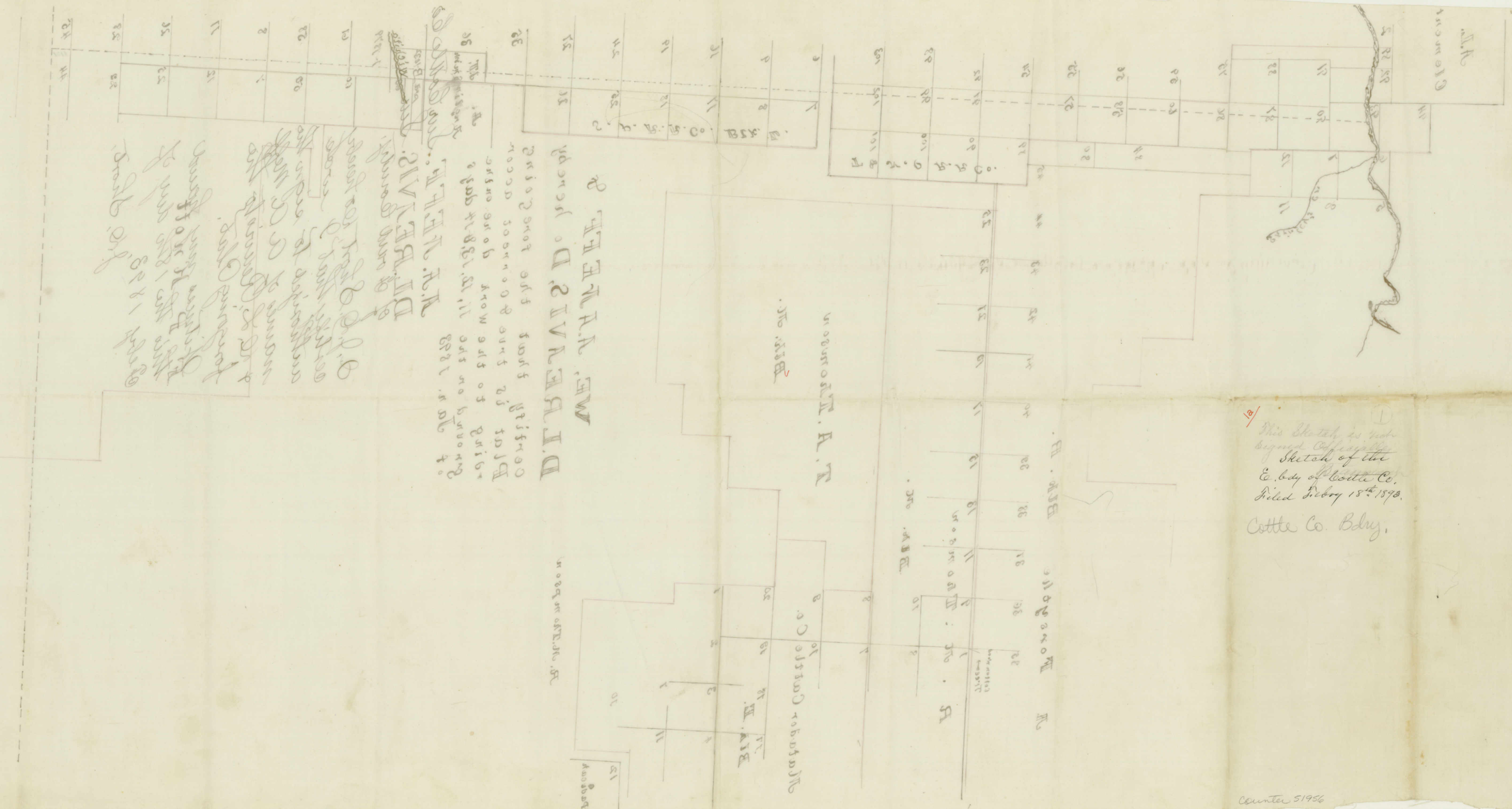

Handwritten notes in cursive script, likely providing details about the survey or the parties involved.