

*FIELDNOTES & SKETCH  
OF  
CROSBY-DICKENS COUNTY LINE  
BY A.L. HARRIS  
RECEIVED AND FILED IN GENERAL  
LAND OFFICE FEB. 6, 1935*

*Court Decree with Lynn Garza Report*

*Received and filed in General Land Office on February 6th, 1935.*

*Platted on map Feb, 1936.*

*— Abstracted 3-23-1935. Vol. 57 —*

920

THE STATE OF TEXAS  
COUNTY OF Crosby

I, Emzy Pieratt County Clerk of Crosby

County, Texas, do hereby certify that the foregoing is a true correct copy of a typewritten and blue print map report of A.L.Harris, Surveyor, who was duly authorized to survey and mark the boundary line between Crosby County and Dickens County, together with its certificate of authentication, was filed for record in duplicate in my office this the 14th day of January A.D. 1935, and duly recorded the same day in Special County Line Volume No. 1: one copy in the Clerk's Records and one copy in the Surveyors Records

Witness my hand and the official seal, at my office in Crosbyton Texas, this the 14th, day of January A.D. 1935

Emzy Pieratt  
County Clerk Crosby County, Texas

THE STATE OF TEXAS        { In the County Court of Dickens  
                                  \*  
COUNTY OF Dickens        { County, Texas, Jan.    Term, A.D. 1935.

In The Matter of Establishing the Dickens and  
Crosby County Boundary Line.

This the 14th day of Jan. A.D. 1935, came on to  
be considered the report, consisting of typewritten field notes  
and blue print map, of A.L. Harris, Surveyor, who heretofore  
having been duly and jointly employed by said Counties to survey  
and mark said boundary line, and the court having examined the  
same, it is ordered by the court that said report be and is  
hereby in all respects approved, and said report has been duly  
filed for record in duplicate with the County Clerk of said  
county.

Jim C. Cland  
County Judge Dickens County, Tex.

The STATE OF TEXAS        {  
                                  \*  
COUNTY OF Dickens        { I, Fred Arrington, Clerk of the  
County court of said county, do hereby certify that the above-  
foregoing instrument in writing is a full, true and correct copy  
of an order of the County Court of said County, approving the  
report of A.L. Harris, Surveyor, in the matter of establishing  
the true boundary line between Crosby County and Dickens  
County: as same was filed for record the 14th day of January  
A.D. 1935, and recorded in Vol. 7 560 Minutes of County  
Court of said county, and also remain on file in my office among  
the papers of said report.

Witness my hand and seal of office, in Dickens Texas,  
this the 14th day of January A.D. 1935.

Fred Arrington  
Clerk County Court of Dickens  
County, Texas.

(seal)

THE STATE OF TEXAS            §  
   §  
COUNTY OF Dickens            §

I, Fred Arrington,                      County Clerk of Dickens  
County, Texas, do hereby certify that the foregoing is a true  
correct copy of a typewritten and blue print map report of  
A.L.Harris, Surveyor, who was duly authorized to survey and  
mark the boundary line between Dickens                      County and  
Crosby                      County, together with its certificate of  
authentication, was filed for record in duplicate in my office  
this the 14th day of January                      A.D. 1935, and duly  
recorded the same day in Special County Line Volume No.1 : one  
copy in the Clerk's Records ~~and one copy in the Surveyors Records.~~

Witness my hand and the official seal, at my office in Dickens  
Texas, this the 14th day of January                      A.D. 1935.

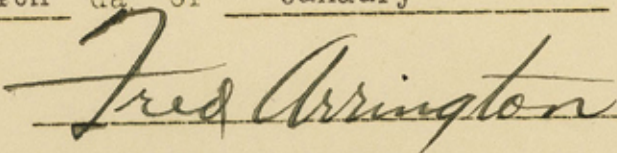
  
\_\_\_\_\_  
County Clerk Dickens                      County, Texas



THE STATE OF TEXAS        (    In the County Court of CROSBY  
                                      \*  
COUNTY OF CROSBY        (    County, Texas, Jan. Term, A.D. 1935 .

In The Matter of Establishing the Crosby and  
Dickens County Boundary Line.

This the 14th day of January A.D. 1935, came on to  
be considered the report, consisting of typewritten field notes  
and blue print map, of A.L. Farris, Surveyor, who heretofore  
having been duly and jointly employed by said Counties to survey  
and mark said boundary line, and the court having examined the  
same, it is ordered by the court that said report be and is  
hereby in all respects approved, and said report has been duly  
filed for record in duplicate with the County Clerk of said  
county.

Geo. S. Bond  
County Judge Crosby County, Tex.

The STATE OF TEXAS        (    I, Emzy Pieratt Clerk of the  
                                      \*  
COUNTY OF Crosby        (    County court of said county, do hereby certify that the above an  
foregoing instrument in writing is a full, true and correct copy  
of an order of the County Court of said County, approving the  
report of A.L. Farris, Surveyor, in the matter of establishing  
the true boundary line between Crosby County and Dickens  
County: as same was filed for record the 14th day of January  
A.D. 1935, and recorded in Vol. 7 of        Minutes of County  
Court of said county, and also remain on file in my office among  
the papers of said report.

Witness my hand and seal of office, in Crosbyton Texas,  
this the 14th day of January A.D. 1935.

Emzy Pieratt  
Clerk County Court of Crosby  
County, Texas.

(seal)

GLO

CROSBY- DICKENS COUNTY BOUNDARY LINE REPORT #1

FOREWORD:

In the suit Garza VS Lynn County et al, the decree of the court placed the north common corner of Garza and Kent counties at a point thirty miles easterly of the SE corner of Lubbock county as marked by J.B.Jones, and having been duly appointed to survey and mark the line as between Crosby and Garza counties, I set a concrete C marker in the W.H.Stagner survey at a point 360 varas East of its West line and 208 varas North of its south line for the common corner of Crosby-Dickens, Garza and Kent Counties, and from observation on the polar star at elongation I ran this line N0°8'W in a straight line to the SW corner of Motley county as marked by Ira Millington, to form the line as between said Crosby and Dickens counties.

- (1) Beginning mile one at the said common corners of Crosby-Dickens, Garza and Kent counties, thence N08'W at 495 vs. cross fence line, at 727 cross fence line marking the north line of said Stagner survey, at a point 369 varas East of its NW corner, and 51 varas west of the SE corner of the S.W.Rathers survey, at 880 vs. cross spring creek, bridge 25 varas east of line, at 1314 vs. draw, at 1321 vs fence line, at 1540 vs pass about 75 varas east of house, at 1690 vs center line of roadway to the east, at 1700 vs. C concrete marker set at fence corner fence lines north-south-east, at 1901 vs, the end of mile one.
- (2) Beginning mile two at the end of mile one, thence N0°8'W at 770 vs. cross fence line, fence corner 25.5 vs. west, at 786 vs. pass 623.6 vs. east of stone and post, the NW corner Rathers survey, the SW corner Airhart survey 11, at 1901 vs, the end of mile two, in deep shinnery sand land.
- (3) Beginning mile three at the end of mile two, thence N0°8'W 1901 vs, through rough sand-hill shinnery land, to the end of mile three.
- (4) Beginning mile four at the end of mile three, thence N0°8'W 1278 vs. C concrete marker set on south side of high shinnery clump, a t 1286 east-west fence line, north-south fence line 716.5 vs west of line, in all 1901 vs, through high shinnery sand hill land, to the end of mile four.
- (5) Beginning mile five at the end of mile four, thence N0°8'W at 700 vs. pass 55 vs. west of fence corner, fence line north and east, at 1821 vs. fence line south side of land and C concrete marker, at 1830 vs. center line of east-west roadway, the NW corner of section 6 W.C.Garrett is west 741 vs. at 1838.5 fence line, at 1901 vs, the end of mile five.
- (6) Beginning mile six at the end of mile five, thence N0°8'W 786 vs. the north line of section 5 S.B.Preslar and fence line, stone marking SW corner A.M.Sowell section 24 bears west 29 vs, at 1319 vs. fence corner about 13 vs. west of line, at 1788 cross fence line, in all 1901 vs, to the end of mile six.
- (7) Beginning mile seven at the end of mile six, thence N0°8'W at 386.5 vs. pass 50 vs. east of stone , the NW corner said section 24, at 393 vs. fence line and C concrete marker, at 1536.5 vs. cross north line of E.A.Cochran No.3 at a point 495.5 vs east of its NW corner, in all 1901 vs. to the end of mile seven.
- (8) Beginning mile eight at the end of mile seven, thence N0°8'W at 86 vs. pass 150 varas east of fence corner, at 208 cross fence line, at 467 vs. pass 4 varas west SW corner C.K.Black tract, at 664 vs. cross west line Black tract, at 1191 vs. pass 751.5 vs. east of north south fence line, at 1285 vs. the north line Black tract, 12.6 vs east of its NW corner, the SW corner L.A.Barrow tract bears west 90.6 vs. at 1350 vs. C concrete marker, in all 1901 vs. to the end of mile eight.

- (9) Beginning mile nine at the end of mile eight thence  $N0^{\circ}8'W$  at 98 vs. fence line, the NW corner said Barrow tract is west 110 vs. same being the SW corner J.E. Day tract 1, at 563.5 vs. cross fence line at 976 vs. east-west fence line in ravine, at 1040 vs. creek flows south-westerly, at 1350 vs. C concrete marker in a hill, in all 1901 vs. to the end of mile nine.
- (10) ~~Thence~~ Beginning mile ten at the end of mile nine, thence  $N0^{\circ}8'W$  at 80 vs. the north line Day, the south line section 326, their west corner west 225 vs. at 1350 vs. C concrete marker in valley, at 1901 vs. the end of mile ten.
- (11) Beginning mile eleven at the end of mile ten, thence  $N0^{\circ}8'W$  at 82 vs. cross line between sections 326 and 327 at a point 262 vs east of their west corner, at 140 vs cross head of deep draw, in all 1901 vs. to the end of mile eleven.
- (12) Beginning mile twelve at the end of mile eleven, thence  $N0^{\circ}8'W$  at 84 vs. pass 298.7 vs. east of iron pipe and post, the west corner of section 327 and 362, at 94 vs. fence line and C concrete marker, at 1034 vs. fence line, in all 1901 vs. to the end of mile twelve.
- (13) Beginning mile thirteen at the end of mile twelve, thence  $N0^{\circ}8'W$  at 86 vs. fence line, section corner is west 312 vs. C concrete marker in fence line, at 885 vs. fence line, at 1350 vs. creek flowing southwesterly, in all 1901 vs. to the end of mile thirteen.
- (14) Beginning mile fourteen at the end of mile thirteen, thence  $N0^{\circ}8'W$  at 87 vs. fence line east-west, the SE corner Ed Hutson survey 1 bears east 121 vs. iron pipe at fence corner, the NW corner section 363 bears west 325.5 vs. in all 1901 vs. to the end of mile fourteen.
- (15) Beginning mile fifteen at the end of mile fourteen, thence  $N0^{\circ}8'W$  at 370 vs fence line, in all 1901 vs. to the end of mile fifteen.
- (16) Beginning mile sixteen at the end of mile fifteen, thence  $N0^{\circ}8'W$  at 230 vs. point on cap rock, at 950 vs. bluff up on cap rock, at 1057 vs. east-west fence line intersecting north-south fence line 133 vs east of line, in all 1901 vs. to the end of mile sixteen.
- (17) Beginning mile seventeen at the end of mile sixteen, thence  $N0^{\circ}8'W$  at 130 east-west fence line, at 250 vs. fence line and C concrete marker at south side of roadway, at 700 vs. south side deep draw at 850 vs. north side same, at 1064 vs. fence line, corners 164.6 vs west, at 1163 fence line, in all 1901 vs. to the end of mile seventeen.
- (18) Beginning mile eighteen at the end of mile seventeen, thence  $N0^{\circ}8'W$  104 vs. fence corner 54.6 vs. west, at 275 vs. center of lane about half mile west of line, at 788 vs. fence line, in all 1901 vs. to the end of mile eighteen.
- (19) Beginning mile nineteen at the end of mile ~~seventeen~~ eighteen, thence  $N0^{\circ}8'W$  at 109 vs. east-west fence line and C concrete marker, iron pipe at fence corner 161 vs. east, iron pipe 180 vs. west under fence, the north line Ed Hutson No. 3, in the south line of Liberty County School Land, its SE corner being east 1223 vs., at 895 vs. fence at 1172.5 fence, in all 1901 vs. to the end of mile nineteen.
- (20) Beginning mile twenty at the end of mile nineteen, thence  $N0^{\circ}8'W$  at 1423 vs. south line of State Highway, and B concrete marker, at 1441 vs. center line of paved highway, and the north line of said Liberty School land, at 1459 north line of highway, in all 1901 vs. to the end of mile twenty.
- (21) Beginning mile twenty-one at the end of mile twenty, thence  $N0^{\circ}8'W$  at 240 vs. center line of old highway, the SW corner section 5 bears west 700 vs., at 1188.5 vs. fence line, at 1717 vs. fence line, in all 1901 vs. to the end of mile twenty one.
- (22) Beginning mile twenty-two at the end of mile twenty-One

(22 Cont)

thence N0°08'W at 232 vs. south fence of land and telephone line, at 240.5 vs. center of roadway, the SW corner section 19 is west 691 vs. at 249 north fence of land and C concrete marker, at 1212 vs. fence line in all 1901 vs. to the end of mile twenty-two.

(23) Beginning mile twenty-three at the end of mile twenty-two thence N0°08'W at 241 vs. fence line and C concrete marker, at 1192 fence line, in all 1901 vs. to the end of mile twenty three.

(24) Beginning mile twenty four at the end of mile twenty-three Thence N0°08'W at 234.6 vs. fence line and C concrete marker, at 241.5 vs. center line of roadway, the west corner of sections 7 and 18 bear west 672 vs. at 249 fence line, at 1192 fence line, in all 1901 vs. to the end of mile twenty-four.

(25) Beginning mile twenty-five at the end of mile twenty-four thence N0°08'W at 240.5 vs. fence line on section line, in all 1901 vs. to the end of mile twenty-five.

(26) Beginning mile twenty-six at the end of mile twenty-five thence N0°08'W at 234.5 vs. fence line and C concrete marker, at 241.7 vs. center line of roadway, the west common corners of sections 1 and 6 bear west 653.7 vs, at 249 vs. fence line, at 736.5 vs. and 990.5 vs cross fence lines, in all 1901 vs. to the end of mile twenty-six.

(27) Beginning mile twenty-seven at the end of mile twenty-six thence N0°08'W at 990.5 vs. fence line and C concrete marker, in all 1901 vs. to the end of mile twenty-seven.

(28) Beginning at the end of mile twenty-seven, <sup>6354</sup> thence N0°08'W at 255 fence line and section line, corner is west 626.2 vs. at 1180 vs fence line and C concrete marker, at 1201 vs, fence line north side roadway, in all 1901 vs. to the end of mile twenty-eight.

(29) Beginning mile twenty-nine at the end of mile twenty-seven <sup>1180</sup> thence N0°08'W at 244 fence line and section line, section corner bears west 626.2 vs., at 1581 vs. fence line, 1642 vs. fence line and C concrete marker, at 1770 vs. narrow deep draw, in all 1901 vs. to the end of mile twenty-nine.

(30) Beginning mile thirty at the end of mile twenty-nine, thence N0°08'W at 245 vs. section line, the NW section 4 bears west 617 vs. the SW J.W.Holt bears west 70 vs. at 1280 vs. fence line and the south line section 21 its SW corner bears west 755.2 vs, the NW Holt bears west 75 vs. in all 1901 vs. to the end of mile thirty.

(31) Beginning mile thirty-one at the end of mile thirty, thence N0°08'W at 180.7 vs, stone about 12x18 inches and probably 6 feet long standing some four feet out of the ground and marked SW Motley Co., on its north side, the common corners of Motley-Dickens, Corsby and Floyd counties as originally marked by Ira Millington.

This survey and report thereof made under appointment made jointly by the County Courts of Dickens and Crosby counties.

RECEIVED

FEB 6 1935

REFERRED TO MAP



CROSBY-DICKENS BOUNDARY LINE REPORT  
ACREAGE DIVISION

Sec.	Blk	Cert.	File	T Ac	Crosby County		Dickens County	
					Abst.	Ac	Abst.	Ac
21	M			643½	808	107	938	162.4
21	M		S-17360		(Floyd County 1082	148.5	Motley County) 471	225.6
1	M		SF4493	474		13.	1273	461
4	EL&RRRR	807	128417	480	1479	210	1421	270
	W½NE¼							
3	EL&RRRR	807	S-13029	640	884	213	315	427
2	EL&RRRR	803 S Part	124067	260	1422	87.9	1398	172
	W pt N pt							
		803	55334	200.4	1129	128.	1154	72
1	EL&RRRR	803	S-13026	640	883	219	316	421
6	A	15	22455	640	889	222	843	418
7	A	12	S-10768	640	885	225	42	415
18	A	<del>12</del> 11	16969	640	890	228	799	<del>12</del> 412
19	A	21	S-10776	640	886	231	44	409
5	BS&F A	1509	S-10755	640	880	234	25	406
1	M.G.Leatherwood		68881	449	1268	351	1408	98
	Liberty Co. School Land		1-1912	1809	898	1114	319	695
3	Ed Hutson - No such Sec. See Letter in			21.5	S.F. 2191	17.5		4.
	Blk 16							
2	Ed Hutson	SF2191		717.2	1292	598.5	1246	118.7
	Blk 16							
1	Ed Hutson	SF-2190		714.8	12921	610.8	1245	104
	Blk 16							
363	1	10/2077	S5975	640	1209	107	188	433
362	1	10/2076	13644	640	882	102.8	592	437.2
			S5957	640				
327	1	10/2059	<del>849</del>	<del>822</del>	893	94	170	546
326	1	10/2058	13381	640	881	81	602	559
1	JEDay RM	SF1692	113248	520.8		33	1367	487.8
		SW part		75.5		23	1233	52.5
	L.A.Barrow RM		P-9459	80	1195	12	1048	68
							(1015)	
3	CERoy RM	SF4277	73962	414.9		345.4	1254	69.5
	E.A.Cochran RM		SF-369	326.8		97.3	1228	229.5

Dickens-Crosby County line report--Acreage Division.

Crosby-Dickens boundary lien report  
Acreage division #2

Sec.	Blk	Cert.	File	T Ac.	Crosby County Abst. Ac	Dickens County Abst Ac
24	RM	SF-2620		339	11.8	1256 327.2
RMSowell						
5	RM	SF-4196			216	1252 215
S.B.Preslar						
} See letter from A.L.Harris, dated 3-15-35, in 431 SF 4196.1297 } correcting this acreage division.						
6	RM	SF-1406		640	191	1235 449
W.C.Garrett						
17	RM(Npt)	SF-1407	74258	259.43	117.7	1236 141.73
W.C.Garrett						
	(Spt)		99816	80	58.5	1347 21.5
} See letter from A.L.Harris, dated 3-17-35, in SF 4266, correcting this acreage division.						
11	RM	SF-4266		640	440	1223 200
J.H.Airhart						
} See letter from A.L.Harris, dated 3-17-35, in SF 4266, correcting this acreage division.						
32						
L.S.Scott	RM	SF-3258			4.	Balance
31	RM	SF-3259		204	200.	1253 4.
S.W.Rathers						
W.H.Stagner				160	45.5	77.9
					Garza County 13.3	Kent County 23.3

I, A.L. Harris, Licensed State Land Surveyor of Lubbock, Lubbock County Texas, do hereby certify that the foregoing described survey was actually made by me on the ground, according to law, on the months of November and December 1934, with the chain carriers aforesaid, duly qualified and that all the lines, corners, boundaries and marks of the same, whether natural or artificial, are truly and correctly described and set forth in the foregoing plat and field notes of this report.

T.H. Thomas and Jack Medley, chainmen.

*A.L. Harris*

Licensed State Land Surveyor.

Received and filed in General Land Office on Feb. 6th, 1935

*J.H. Walker, Comm.*  
*C.F. Blucher, clk.*

C R O S B Y C O U N T Y



GARZA  
KENT

DICKENS  
CROSBY

VERTICLE NUMBERS FIELD NOTE CALLS  
SLANT BY MEASUREMENTS

DICKENS-CROSBY COUNTY LINE  
A.L. HARRIS, STATE SURVEYOR, LUBBOCK TEXAS. 1934

LIBERTY COUNTY SCHOOL LAND

BLK W-T