

# Exhibit (A)

Field notes of the line between Dallas and Tarrant Counties

We planted for the S.W. Corner of Dallas County and the S.E. Corner of Tarrant County a Bais d'arc post 8 inches square three feet in the ground and two and a half feet above the ground. We marked said post on its west side S.F.C.T.C. and on its East side S.W.C.D.C. Said post at the foot of the North Side of a ridge and at the South East edge of Mountain Creek Valley from which a Mesquite Tree 4 inches marked T.C.X bears  $N68^{\circ}W$  11 varas and a mesquite 4 inches marked D.C.X bears  $N20\frac{1}{2}^{\circ}E$  36 varas, and a mesquite 10 inches standing on a hill bears  $S37\frac{1}{4}^{\circ}E$  250 $\frac{3}{4}$  varas and a Mesquite 14" marked X on South Side standing in a branch Valley north of a small branch bro.  $N73\frac{1}{2}^{\circ}E$  287 $\frac{1}{2}$  varas. Said corner post is 369 varas back of a small hole in the ground on the Top of a hill, and 243 $\frac{1}{2}$  varas South of a Branch, and 275 varas west of a bend in said branch and 305 varas west of a small drain, that now runs into said branch from the South and in the South line of F. Houston Survey 263 varas East ~~of~~ its S.W. Corner at 243 $\frac{1}{2}$  varas a prong of

Thence North at 243 $\frac{1}{2}$  varas a prong of Mountain Creek 1503 varas intersecting the North line of said Houston Survey and the South line of the G.W. Gresham Survey. 35 varas west of the ~~west~~ southerly S.E. corner of said Gresham Survey and 268 varas East of the S.W. corner of said Houston Survey, at 1540 varas the first Mile post in small wet valley.

1st  
Mile

Thence North at 419 varas center of mountain creek Course South East following up the said creek and leaving it at 709 varas intersecting the North line of said Gresham Survey and the South line of the C.W. Adams Survey at 237 varas



Dallas Co. Bdry. F.L. # 42

2d.  
mile

west of of the South East Corner of said Adams survey  
at 1909 varas the second miles post in the west  
bank of Mountain Creek

Thence North at 22 1/2 varas a line in said  
line course north east at 433 1/2 varas passed 5 varas west  
of a Spring in the west bed of Mountain Creek, run with  
the west edge of said creek about 40 varas intersecting  
the North line of said Adams and South line of J.A. Lunny  
Survey 229 varas west of their North East and South East  
corners, at 1124 1/2 varas intersecting the North line of said  
Lunny and the South line of the G.A.T. Wash survey at 2223  
varas west of their North East and South East corners.  
at 1511 1/2 varas intersecting the N.W. line of the J.S.  
Goodnight and S.E. line of the B.B.B. & Co. R.R. Co survey  
90 varas N60E from the N.W. corner of said Goodnight  
survey and 280 varas N60E from the S.W. corner of  
said R.R. Survey - in all 1902 1/2 varas to the 3d mile post.

3d  
mile

Thence North at 1215 varas intersecting the  
North west line of the B.B.B. & Co. R.R. Co survey and 485 varas  
S60W from its N.E. corner and near the South west corner  
W. Lynn Survey in all 1904 varas to the 4th mile post.

4th  
mile

Thence North intersecting the N.W. line of the  
W. Lynn and the S.E. line of the B. Estis Survey 461 varas  
from their N.E. and S.E. corners. intersecting the N.E. line of  
said Estis Survey 109 varas S30E from N.E. corner and the  
North<sup>west</sup> corner of the J. Childress and the S.E. corner of the  
J. Banks Survey in all 1908 1/2 varas. the 5th mile post.

5th  
mile

Thence North intersecting the North west line  
of said Banks and the South East line of the W.S.



Webb Survey at 418 varas N60E from their N.W. and S.E. corners at 420 1/2 west bank of Walnut Creek - grows wide, course of creek North continuing down said creek at 599 1/2 varas west bank. Course of creek North East intersecting the N.W. line of said Webb and the S.E. line of the J. Lee Survey 137 varas from their N.E. and S.E. corners. in all 1919 1/2 varas to the 6<sup>th</sup> mile post in wet land.

6<sup>th</sup>  
mile

Thence North intersecting the N.E. line of the J. Lee and the S.W. line of the St. Brito Survey 238 varas N30W from the S.E. corner of said Lee Survey intersecting the N.E. line of said Brito and the S.W. line of the J. M. Carter Survey 1663 varas N30W from their S.E. and S.W. corners. at 1669 varas intersecting the South line of the S. T. Brown Survey 256 varas east of the S.W. corner of same in all 1911 varas to the 7<sup>th</sup> mile post.

7<sup>th</sup>  
mile

Thence North at 1815 varas Fish Creek - course North East - at 1851 varas intersecting the North of said Brown and the South line the S. H. Beuman Survey 634 varas west from their S. East corner of said Beuman Survey in all 1905 varas to the 8<sup>th</sup> mile post.

8<sup>th</sup>  
mile

Thence North 921 varas intersecting the North line of said Beuman Survey and the South line of the M. Hunt Survey 629 varas west of their N.E. and S.E. corners at 1879 varas intersecting the North line of said Hunt and the South line of the L. D. Ball Survey 1276 varas east of the N.W. corner of said Hunt and 1910 varas east of the S.W. corner of said Ball Survey in all 1906 varas to the 9<sup>th</sup> mile post.

9<sup>th</sup>  
mile

Thence North at 339 varas the north prong of Fish Creek course South east at 940 varas intersecting



The north line of said Hall and the south line of the V. M. Long survey 903 varas west of their North east and south east corners at 1898 varas intersecting the north line of said Long and the south line of J. M. Gill survey 955 varas west of the north east corner of said Long and 900 varas west of the south east 10<sup>th</sup> corner of said Gill survey in all 1908 varas to the 10<sup>th</sup> Mile post.

Thence

North intersecting the north line of said Gill and the south line of W. Pruitt survey 448 varas west of 11<sup>th</sup> Gills north east corner and 10 varas east of the S. W. corner of 11<sup>th</sup> mile said Pruitt survey in all 1908 varas to the 11<sup>th</sup> Mile post.

Thence

North at 907 varas a large branch (course east) intersecting the north line of said Pruitt and the south line of Papeley 12<sup>th</sup> Holland survey 428 varas west of the north east corner of said 12<sup>th</sup> mile Pruitt survey in all 1909 varas to the 12<sup>th</sup> Mile post.

Thence

North intersecting the south line of the M. C. Mayr survey 734 varas east of its south west corner intersecting 13<sup>th</sup> the north line of said May 734 varas west of its North 13<sup>th</sup> mile west corner in all 1931 varas to the 13<sup>th</sup> Mile post.

Thence

North at 550 varas center of S. P. R. R. Track, 494 varas west of Culvert No 1043 at 1240 varas intersecting the North line of the S. Holland and the south line of the S. A. Ford survey 439 varas west of the S. E. 14<sup>th</sup> corner of said Ford survey in all 1908 varas to the 14<sup>th</sup> mile 14<sup>th</sup> Mile post.

Thence

North at 301 varas a Pecan tree 24 inches near the head of a drain marked X on his south side intersecting the



1  
1  
1  
north line of said Ford and the south line of J. H. Ford surveys 431 varas west of their North east and south east corners at 950 $\frac{1}{2}$  varas intersecting the north line of said Ford and the south line of J. W. Farrans surveys 192 varas east of their south west corners, intersecting the north line of said Farrans and the south line of In. & G. R. R. surveys 706 varas west of their North east and south east corners in all 1900 varas to the 15<sup>th</sup> Mile post, marked 15<sup>th</sup> on its south and north side 15 and on its west side Mile D. C. I. and on its east side T. C. I.

Thence

North at 150 $\frac{1}{2}$  varas intersecting the North line of the In. & G. R. R. and the south line of the M. Goodwin's survey 706 varas west from their North east and south east corners a 112 $\frac{1}{2}$  varas Trading House creek, course east 112 $\frac{1}{2}$  varas to the 16<sup>th</sup> Mile post.

Thence

North at 142 $\frac{1}{2}$  varas intersecting the North line of said Goodwin and the south line of M. Farrans's surveys at 663 varas West of their North east and south east corners intersecting the North line of said Farrans and the south line of the H. J. Crocker surveys 655 varas West of their North east and south east corners at 1170 varas a large sand stone 10 feet in diameter at 1242 $\frac{1}{2}$  varas Center of West Fork Trinity River course east at 1202 $\frac{1}{2}$  north bank of River intersecting the north line of H. J. Crocker and the south line of the J. Crocker surveys 645 varas west of the north east corner of H. J. Crocker and 543 varas west of the south east corner of the J. Crocker 17<sup>th</sup> survey in all 1842 $\frac{1}{2}$  varas to the 17<sup>th</sup> Mile post. Marked

17<sup>th</sup> Mile D. C. I. T. C. I.

Thence



Thence

Darius Co. Bdry. F.L. # 40

North at 87 $\frac{1}{2}$  varas East Bank of West Fork Trinity River course south west continuing up said Bank at 547 $\frac{1}{2}$  varas leaving the River to an old Mill site intersecting the north line of the P. Crocker and the south line of W. P. Crocker survey 533 varas west of their North east and south east corners at 1188 varas a large Prairie course south west intersecting the north line of said Crocker and the south line of J. R. Splane surveys 525 varas west of the North east corner of said Crocker survey in all 1907 $\frac{1}{2}$  varas to the 18<sup>th</sup> Mile 18<sup>th</sup> post marked B. D. C. I. & T. C. I. said post 18<sup>th</sup> post being west of a glade prairie.

Thence

North at 587 $\frac{1}{2}$  varas a stake on the south edge of glade prairie at 977 $\frac{1}{2}$  varas intersecting the north line of said Splane and the south line of L. D. Burnett survey 421 varas west of the south east 19<sup>th</sup> corner of said Burnett survey in all 1907 $\frac{1}{2}$  19<sup>th</sup> varas to the 19 Mile post.

Thence

North intersecting the north line of said Burnett and the south line of the J. J. Goodman's survey 412 varas west of their north east and south east corners at 1625 varas Bear Creek course south east in all 1915 varas to the 20<sup>th</sup> Mile 20<sup>th</sup> post marked 10 - 20 D. C. I. & T. C. I. Post oak 20<sup>th</sup> post 14 inches x bears North 16° East 58 varas:

Thence

North at 62 varas intersecting the north line of said Goodman and the south line of the J. Thomp-







<sup>Dahms on Edg. File # 40</sup>  
said Burgoon and the south line of H. Atkinson  
survey's 308 varas west of their north east and  
south east corners in all 1900 varas to the 24<sup>th</sup>  
24<sup>th</sup> Mile post.

Thence

North at 870 varas intersecting the north line of  
said Atkinson and the south line of the R.  
H. Burnett survey's 270 varas West of the north  
east corner of said Atkinson and 420 varas west  
of the south east corner of said Burnett survey's  
at 1820, 8 varas intersecting the north line of  
Burnett and the south line of W. Bruton survey's  
419 varas west of the north east corner of said Burnett  
and 209 varas west of the south east corner of said  
25<sup>th</sup> Bruton survey's in all 1900, 8 varas to the 25<sup>th</sup>  
25<sup>th</sup> Mile post on high prairie.

Thence

North at 1259, 8 varas center of the D. A. & P. R. R. Co  
course southwest in all 1900, 8 varas to the 26<sup>th</sup> mile  
post a Bois darc post marked on its south side  
26<sup>th</sup> 20 on its west side T. C. L. and on its east side  
26<sup>th</sup> Mile D. C. L.

Thence

North at 100 varas intersecting the north line of  
said Bruton and the south line of the S. L. J.  
Ford survey's 253 varas west of their north east and  
south east corners at 415 varas a Branch, course  
north east, intersecting the north line of said Ford  
and the south line of H. L. Hope survey at 1089 varas  
intersecting the north line of said Hope and the  
south line of W. Russell survey's 319 varas west of  
the S. L. Corner of said Russell survey in all

2150



2150 varas to the 27<sup>th</sup> Mile post a Bois'darc post marked  
27<sup>th</sup> on south side 27 on east side D. C. I. and on west side  
Mile T. C. I.

Thence  
north at 445 varas intersecting the north line  
of said Russell and the south line of the S.  
Thompson survey 311 varas west of the north east corner  
of said Russell survey at 675 varas center of the  
St. L. A. + T. Ry. course south west about 675 varas  
west of the 26<sup>th</sup> Mile post in all 1900 varas to  
the 28<sup>th</sup> Mile post a Bois'darc post in level  
28<sup>th</sup> prairie 6 inches square marked 28 on south side  
Mile T. C. I. on west side and D. C. I. on east side.

Thence  
north at 26 varas intersecting the north line of said  
S. Thompson and the south line of J. Gibson survey  
230 varas west of the south east corner of said Gibson  
survey at 412 varas a large drain course north east  
at 621 again and again at 658 varas at 1000 varas  
a small drain course east in all 1900 varas to the 29<sup>th</sup>  
Mile post, a Bois'darc post in a flat prairie  
29<sup>th</sup> marked 29 on south side T. C. I. on west side and  
Mile D. C. I. on east side.

Thence  
north at 74 varas intersecting the north line of  
the said J. Gibson survey and the south line of an  
other Gibson survey, 200 varas west of their north  
and south east corners intersecting the north line  
of the said Gibson and the south line of the J. M.  
Parker survey at 1275 varas to a brow of Hill at

the



The south edge of Bottom of Denton creek at 1530 center of Denton creek at 1501 to a 6 inches Hackberry on north bank of Denton creek at 1678 a 10 inches Hackberry, blazed on both four sides in all 1900 varas to a post, a mile Hackberry, marked 30 bears  $N 1/2^{\circ}$  or

Thence north  $S 1/2^{\circ}$  varas to the north east corner of Dallas County as herein constructed, an 8 inch Bois d'arc post standing in the head of a small drain or draw, course south, from which an 8 inch Post oak marked C.T.C. bears  $S. 19^{\circ} E.$  90 varas and a Post oak 10 inches marked C.T.C. bears  $S. 11^{\circ} E. 11 1/2$  varas and a Post oak 8 inches marked N.W.C. Dallas Co bears  $S. 20 1/2^{\circ} W. 11$  varas.

Each mile post is a Bois d'arc 7 inches square set 3 feet in ground & 2 1/2 feet above ground marked "D.C.L." on east side & "T.C.L." on west side.

Surveyed Oct. 1890

J.M. Strong

Special Surveyor for  
Dallas County

J. Goodfellow

Special Surveyor for  
Tarrant County



Map showing boundary line between Dallas and Tarrant County, established October 1890 Scale 2000 var to 1 inch

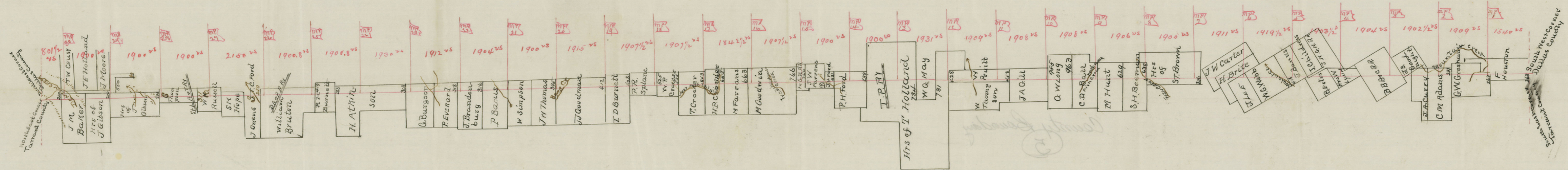

J.M. Strong  
Special Surveyor for Searles County

J.J. Goodfellow  
Special Surveyor for Tarrant County

Filed for Record  
November 29<sup>th</sup> 1890  
at 9<sup>45</sup> O'clock A.M.  
J.A. Scott Co. clk  
By J.C. Salmon

The State of Texas, I, S. B. SCOTT, Clerk of the County Court of  
County of Dallas, do hereby certify that the foregoing is a true Copy of  
Boundary line between Dallas & Tarrant County  
as the same appears of record in Book No. 158 page 288 of the  
Aid Record of Dallas County Texas  
Witness my hand and seal of office this 5 day of December 1890  
J. T. Rarkin Co. Clerk, Dallas Co., Tex.

Filed in the General Land Office  
December 10<sup>th</sup> 1890.  
R. S. Kelley  
Chief Clerk



12-10-1890

The cap following boundary line between Dallas County and Garret County, established October 1890

Scale: 1000 feet to inch

County 52153

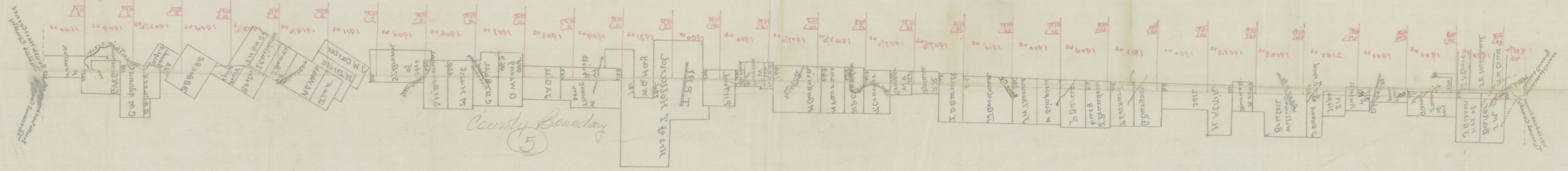

*J. M. Stewart*  
 appears document for Dallas County

*J. Woodhouse*  
 appears document for Garret County

The State of Texas,  
 County of Dallas,  
 J. M. Stewart, Clerk of the County Court,  
 do hereby certify that the following is a true copy of the  
 original line between Dallas & Garret County  
 as the same appears in records of the County Clerk  
 at the date of the date of the said boundary, 1890  
 J. M. Stewart, Clerk of the County Court.

Filed for Record  
 November 20 1890  
 J. M. Stewart, Clerk  
 of the County Court

Filed in the General Land Office  
 December 10 1890  
 J. M. Stewart, Clerk

Dallas Co. 52153