

Edwards County

Edwards County

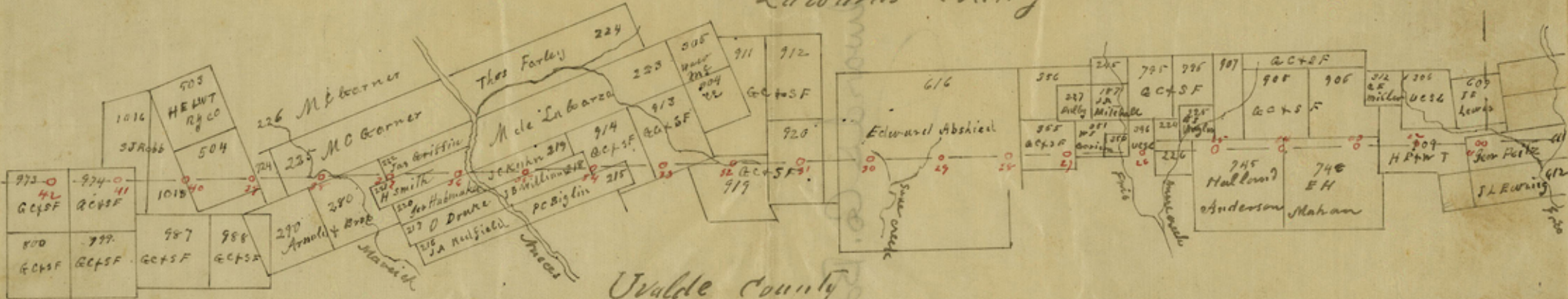

Uvalde County

Counter 52887

Plat and Field Notes of the
 County line Between Wauke and
 Edwards Counties as run and
 Established by J. M. McCormick
 Special Surveyor of Wauke Co.
 and T. B. Reeves Special and Deputy
 Surveyor of Edwards County Assisted
 by J. H. Bennett a practical Surveyor
 of Wauke County in March 1884
 Beginning at the south-
 east corner of Edwards County, the
 south-west corner corner of Bandera
 County, being a stone mound four
 feet high, in the Valley of the Rio
 Frio and 1995 Vrs. west of said river
 and 1095 Vrs. west from Buffalo Creek,
 Said Mound is N. 61° W. 100 Vrs. on the
 South side, Edwards Co. on the west
 and Bandera Co. on the east side
 with Red paint, from which a
 Live Oak 20 in. dia bis N. 31. 11. 65 Vrs.
 and is 20 Miles and 1745 Vrs. west from
 the N. E. corner Wauke County.
 Thence N. at 155 Vrs. a Rock
 Mound for the 21st Mile Mound from
 which a L. O. bis S. 1. E. 16 Vrs. a
 Spanish Oak, 8 in dia bis S. 72 E 22 Vrs.
 Thence west at 255 Vrs foot of
 Mountain, 650 Vrs. to top of same.
 1070 Vrs top of another Mountain at
 1438 Vrs. a Rock Mound 1900 Vrs. a
 Rock Mound for the 22nd Mile

Mound on an open point of mountain.

Thence N. 63° Vis. foot of Mountain
 938 Vis. Top of Mountain 1438 Vis. to
 Rock Mound from which a Sp. O
 10 in. dia. bis. S 24 E. 2 Vis. do. 6 in dia
 bis S 63 1/2 E. 7 Vis. these bearings are defaced
 1538 Vis. branch 1638 another branch 1900
 Vis. a Rock Mound for the 23rd Mile
 Mound on the east point of a mountain
 from which G. E. Miller's house
 bis N. 44 E.

Thence N. at 347 Vis. Top of Main
 Ridge between Fried's and Mares Creek or
 Dry Tree from which point Miller's
 house bis N 54 1/2 E. at 652 Vis. Rock Mound
 in back of Pine Oak 922 Vis. Top of
 divide 1900 Vis. Rock Mound in a
 deep gulch for the 24th Mile Mound

Thence west at 252 Vis. Top of
 Ridge 554 Vis. a Rock Mound in a
 small Cedar brake from which a forked
 Cedar bis N. 57 1/2 E. 2 Vis. do 6 in dia. bis.
 S. 6 1/2 E. 5 Vis. 1900 Vis. to a Rock Mound
 for the 25th Mile Mound from which
 a L. O. 6 in dia. bis. N. 70. N. 90 Vis. do 6 in.
 dia. bis. N. 57 1/2 E. 22 Vis.

Thence west 284 Vis. a Rock Mound
 from which a Cedar bis. N. 54 N. 24 1/2 Vis.
 do bis S. 51. N. 3 1/2 Vis. 1062 Vis. Mares Creek
 1522 Vis. Road. 1587 Vis. East line of
 survey No. 396 made for Wauke County

School Land 160 Vis. South of the
S.W. corner of survey No. 225 in the name of
O. C. Maylor 1900 Vis. to a Rock Mound
for the 26th Mile Mound, from which a
L. O. 6 in dia br. N 11 E 15 Vis.

Thence west 339 a Rock Mound
from which a many pranged Cedar Pick'd
E br N. 4 Vis. a cedar S. 45 E. 1 Vis. at 397 Vis.
crossed line of survey No. 396 also east
line of 350 in the name of B. F. Bryant
and 202 Vis. North of the S.E. corner of
said survey No. 350, at 763 Vis. a Rock on
east side of Dry Tris at 939 Vis. Center
Channel of Dry Tris 957 Vis. high bank on
west side Dry Tris in W. J. Garrison
field at 1132 Vis. west line of survey No. 350
and 202 Vis. North of the S.W. corner of said
Survey No. 350 from which point the
house of W. J. Garrison br. N 2 E. about 200
Vis. and B. F. Bryant's house br. N. 15 E.
At 1382 Vis. County Road 1886 Vis. Rock
Mound on the west line of survey No. 350
202 Vis. North of the S.W. corner of said
survey, 1900 Vis. a Rock Mound for the
27th Mile Mound from which a L. O. 4 in
dia br. S 42 E. 3 Vis.

Thence west at 286 Vis. a Rock
Mound from which Spanish Oak 4 in
dia br. S. 32 $\frac{1}{2}$ E. 5 Vis. another Sp. O. br.
N. 10 W 16 Vis. at 889 Dry branch at 1394
Vis. crossed the west line of survey
No. 355 made for Central and Montgomery R.R. Co.

1 Cert. No. 119 also east line of survey No. 616
2 Made for Edward Abshier 432 Pcs. North of
3 the S. W. corner of said survey No. 355
4 1900 Pcs. to a Rock Mound on top of a
5 Ridge for the 28th Mile Mound

6 Thence west 1900 Pcs. to a Rock
7 Mound for the 29th Mile Mound from
8 which a small Mat. of L. O. trees bears
9 N. 163^o Vis. a Round Mountain brs N. 45
10 N. about 900 Pcs.

11 Thence west at 1504 Vis. a Rock
12 Mound in forks of Lake Creek from
13 which the house of W. Yancy brs S. 17^o
14 N. at 1900 Vis. a Rock Mound for the
15 30th Mile Mound from which a beech
16 at the head of Lake Creek brs. N. 200 Pcs

17 Thence west at 842 Vis. west line
18 of survey No. 616 at 1900 Pcs. Rock Mound
19 for the 31st Mile Mound in a deep
20 gulch from which Pin Oak & in dia.
21 brs N. 40th 14 Vis.

22 Thence west 603 Pcs Cedar Ridge
23 1900 Vis. Mound in bed of south prong
24 of Ranch Creek, for the 32nd Mile
25 Mound from which a L. O. 6 in dia.
26 brs. N. 25^o N. 12 Pcs, do 4 in dia brs N. 32^o
27 E. 10 Pcs

28 Thence west 500 Vis. foot of
29 Mountain on the west bank of creek
30 870 Vis. a Rock Mound from which a
31 L. O. 8 in dia. brs. N. 81. N. do 10 in dia
32 brs. S 60^o E. at 1776 top of Mountain

276

1900 Pcs, a Rock Mound for the 33rd
Mile Mound from which a Mesquit 4 in
dia. br. S. 45 N. 40 Pcs. a L. O. 8 in dia br
N. 64 1/2 E. 6 Pcs.

Thence west at 1415 Pcs top of
Mountain 1900 Pcs Rock Mound in the
Valley of the Mueces River for the 34th
Mile Mound from which a Mesquit 10 in
dia br. S. 45 N. 75 Pcs. a L. O. 2 in dia
br. N. 27 E. 10 Pcs.

Thence west 1900 Pcs. a Rock Mound
for the 35th Mile Mound from which a
Mesquit 10 in dia br. N. 34 1/2 N. 15 Pcs.
do. 10 in dia br. S. 24 N. 15 Pcs.

Thence west 90 Pcs. Road 66 Pcs.
County Road, 1400 Pcs. Arnolds pasture
1540 Pcs. point on east bank of
Mueces river 50 Pcs. due North of the
S. N. corner of survey No. 223 in the name
of M. de. La Garga 1580 Pcs Gravel bed
of Mueces 150 Pcs. ^{West bank Mueces} Rock Mound for
the 36 Mile Mound, from which a cedar
br. N. 14 Pcs. and the S. E. corner of
survey No. 221 in the name of Hamilton
Smith br. S. 42 E. 196 Pcs.

Thence west 1068 Pcs top of Moun-
tain, 1900 Pcs. Rock Mound in the
Valley of Maverick Creek. for the 37th Mile
Mound from which a L. O. 10 in
dia. br. S. 42 N. 75 Pcs. do. 4 in dia. br
N. 82 1/2 N. 20 Pcs.

Thence west 150 Pcs. drain 1620 Pcs

Maverick Creek 1900 Vis. Rock Mound
for the 38th Mile Mound from which a
L.O. 30 in dia bis. S 52° E. 61 Vis. a
Hackberry 4 in. dia. bis. S 8 $\frac{3}{4}$ ° E. 36 Vis.

Thence west 50 Vis. Road 140 Vis.
Creek 240 Vis. Creek again. 1195 Vis. west
line of survey No. 225 in name of
M.C. Garner 1900 Vis. Rock Mound for
the 39th Mile Mound

Thence west 1900 Vis. to a Rock
Mound for the 40 Mile Mound near
the head of the south fork of Maverick Oak.

Thence west 530 Vis. Mound on top
of Mountain 1900 Vis. Rock Mound
in deep gulch for the 41st Mile
Mound from which a Pine tree
bis. S. 83 N. 15 Vis.

Thence west at 709 Vis. Rock
Mound on low Mountain, a Round
mountain bis. S 37 $\frac{1}{2}$ ° E. another Round
mountain bis. S 39 $\frac{1}{4}$ ° E. do. bis. S. 7. N.
a deep pass in mountain bis S 26° E
at 1125 Vis. Enters a dense Cedar brake
1900 Vis. a Rock Mound in Cedar brake for
the 42nd Mile Mound. This Mound is 4 ft
high and Nkd on the south side
Uvalde County, on the North Edwards Co.
and Bennett 1884 on the top
of the Mound

Bearings North of line Nkd E
" South " " " U
Side line Marked ≡

Lycander Soant }
Louis Alexander } Chem Carriers
Joseph Felts }
Shickelford }

The J. M. McCormick Special Surveyor
Woods County, and T. B. Reeves
Special and Deputy Surveyor of Edwards
County do hereby Certify that the
Limits boundaries and Courses with
the Marks Natural and Artificial are
truly described in the foregoing Plat
and Field Notes Surveyed from
March 17th to 22nd inclusive

J. M. McCormick
Special Surveyor Woods County Tex
T. B. Reeves
Special Surveyor Edwards County Tex

THE STATE OF TEXAS, }
COUNTY OF Edwards } I, J. B. Jackson, County Clerk,
in and for said County, do hereby certify that the foregoing field notes & plat of boundary line dated
the 19th day of May 1884, with its certificates of authentication, was filed for Record in
my office the 19th day of May A. D. 1884, at 11 o'clock A. M., and duly Recorded
the 23rd day of May A. D. 1884, at 5.30 o'clock P. M., in the Records of said County,
in Vol. one on Page 667 & 27

WITNESS my hand and the seal of the County Court of said County, at office in
the Town of Beverly Texas, the day and year last above written.

J. B. Jackson
Clerk County Court Edwards County.
By J. M. Beardon Deputy.

6 Had June 8th 1884

219

Filed May 19th 1884

at 11 o'clock a.m.

left Jackson

Missile

By J. M. Richardson
Deputy

signed by both Surveyors

abstract corrected

July 25th 1884

Beaman

Correct

7
Edwards Co. Bdry.

1 2 3 4 5 6 7 8 9 10 11 12 13 14 15 16 17 18 19 20 21 22 23 24 25 26 27 28 29 30 31 32