

13

County Body Lines between  
Edwards

of

Val Verde & the Co's  
N of Edwards.

Filed July 2/88

Examined & affixed  
July 6/88  
Beaman

utton - Kimble

cc 4



North Ry lines of  
Edwards Co

Filed July 2/89

Examined, approved and  
applied July 6/89  
Beaumont

Edwards Co. Survey

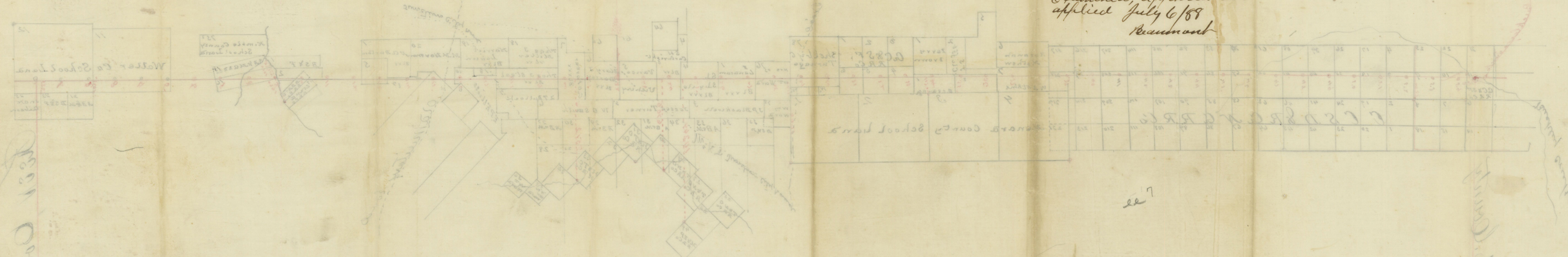

Walter Co Survey

Edwards Co Survey

# Field Notes of North Boundary line of Edwards County Texas

## 1<sup>st</sup> Mile

After testing Compass and Chain and duly swearing Chain Carriers began at the North West Corner of Kerr County on South Boundary line of Kimble County from which a L.O 10 in dia brs S. 60 E 82 1/2 vs a L.O 6 in dia brs N 63 3/4 E 90 vs marked KKE

Thence West 268 vs from which the N.W cor of Sur 25 Jas H Gibson brs South 1083 vs at 1900 vs a rk mound in prairie from which a L.O 3 in dia brs N 27 E 4 vs do 8 in dia brs N 37 E 32 vs bearings mkd  $\frac{K}{E}$  (1)

## 2<sup>nd</sup> Mile

Thence West through level prairie 1900 vs to rk md from which a L.O 6 in dia brs S 42 W 63 vs do 4 in brs S 64 E 65 vs bearings marked  $\frac{K}{E}$  (2)

## 3<sup>rd</sup> Mile

Thence West at 270 vs the N.W cor of Sur 21. A B + M brs S 1084 vs at 1900 vs rk md a L.O 3 in dia brs N 83 E 46 vs bearings mkd  $\frac{K}{E}$  (3)

## 4<sup>th</sup> Mile

Thence West 1900 vs through rolling prairie to rk md from which a L.O 3 in dia brs N 16 E 16 vs bearings mkd  $\frac{K}{E}$  (4)

## 5<sup>th</sup> Mile

Thence West 1900 vs Crossing drains of Paint Creek to rock mound from which a Cedar 8 in dia brs N 38 W 68 vs (5) bearings mkd  $\frac{K}{E}$

## 6<sup>th</sup> Mile

Thence West at 1900 vs rk mound in draw of Paint Creek no trees for bearings rock marked  $\frac{K}{E}$  (6)

## 7<sup>th</sup> Mile

Thence West at 1900 vs rock mound in ravine from which a Cedar 4 in dia brs S 65 E 41 vs bearings mkd  $\frac{K}{E}$  (7)

## 8<sup>th</sup> Mile

Thence West at 1260 vs high bluff on East bank of Paint Creek at 1700 vs crop Leakey & Junction City road a L.O  
(Continued on next page)

Examined, approved & sealed  
July 6/1898  
B. M. Beaumont

8<sup>th</sup> mile (Continued)

8 in dia mkd  $\frac{K}{E}$  at 1900 vs a rock mound from which a shin oak 4 in dia brs N. 6 W 17 vs & a Cedar 10 in brs N 89 W 23 vs marked  $\frac{K}{E}$  (8)

9<sup>th</sup> mile

Thence West through Cedar Brake 1900 vs to rock mound on East bank of South Llano River in Mr. Bray's field from which a Pecan 10 in dia brs S 64 W 59 vs a Mesquite 6 in dia brs S 37 W 46  $\frac{1}{2}$  vs bearings marked  $\frac{K}{E}$ . The S. E. Cor of Survey B B B & C R R Co brs S 21  $\frac{1}{2}$  W 1700 vs the mouth of Paint Creek N 12  $\frac{1}{2}$  E 1632 vs bearings mkd  $\frac{K}{E}$  (9)

10<sup>th</sup> mile

Thence West through Scrubby Cedar hills 1900 vs to rock md in head of ravine from which a Cedar 6 in dia brs S 55 W 12 vs and a L.O 6 in dia brs N 22 E 16  $\frac{1}{2}$  vs bearings marked  $\frac{K}{E}$  (10)

11<sup>th</sup> mile

Thence West through Scattering Cedar at 1900 vs rock mound in Cedar Brake from which a many pronged Cedar brs N 62 E 6  $\frac{1}{2}$  vs & another Cedar brs N 55 W 17  $\frac{1}{2}$  vs bearings mkd  $\frac{K}{E}$  (11)

12<sup>th</sup> mile

Thence West through Cedar brake 1900 to rock mound in edge of little prairie from which a Cedar brs N 14 W 3 E vs bearings mkd  $\frac{K}{E}$  (12)

13<sup>th</sup> mile

Thence West crossing dividing ridge at 1900 vs rock mound on side of ravine from which a large lone Cedar bears N. 1 E 126 vs bearings mkd  $\frac{K}{E}$  (13)

14<sup>th</sup> mile

Thence West across long rolling ridges at 1900 vs rock mound from which a bunchy Cedar brs N 13 W 50 vs bearings mkd  $\frac{K}{E}$  (14)

15<sup>th</sup> mile

Thence West across open level plateau 1900 vs to rock mound from which a L.O 2 in dia brs N 6 W 6  $\frac{2}{5}$  vs bearings marked  $\frac{K}{E}$  (15)

16<sup>th</sup> Mile

Thence West at 1240 vs Government Road 1900 to rock mound on level plateau from which a L.O 6 in dia brs N 63 E 44 vs do 6 in dia brs N 61 E 42 vs bearings mkd <sup>K</sup>E (16)

17<sup>th</sup> Mile

Thence West across open rolling ridges 1900 vs to rock mound from which a L.O 4 in dia brs S 21 1/2 W 7 vs bearings marked <sup>K</sup>E (17)

18<sup>th</sup> Mile

Thence West at 440 vs rock Md Green Lake & Junction City Road at 1900 vs rock md on open divide from which a Live Oak 10 in dia brs S 85 E 112 vs bearings marked <sup>K</sup>E (18)

19<sup>th</sup> Mile

Thence West through open divide 1900 vs to Rock mound in balley on draws of Llano from which a L.O 8 in dia brs S. 80 1/2 W 88 vs bearings mkd <sup>K</sup>E (19)

20<sup>th</sup> Mile

Thence West through open rolling land at 1900 vs to Rock Mound on Level Plateau from which a L.O 6 in dia brs S 5 1/2 W. 7 vs do 3 in dia brs S 20 1/2 E 7 vs bearings mkd <sup>K</sup>E (20)

21<sup>st</sup> Mile

Thence West at 603 vs West Corner of 34 H & T C R.R. Co brs South 7512 vs crossing long open hollows 1900 vs to Rock Mound on draws of S. Llano no bearings mound mkd <sup>K</sup>E (21)

22<sup>nd</sup> Mile

Thence West across open hollow at 1900 vs rock mound in ravine from which a L.O 10 in dia brs S. 3 W 66 vs do 8 in dia brs S. 70 W 87 vs bearings mkd <sup>K</sup>E (22)

23<sup>rd</sup> Mile

Thence West at 940 vs McKenzie Lake and Junction City Road at 1900 vs Rock Md from which a L.O 6 in dia brs N 60 E 5 vs bearings marked <sup>S</sup>E (23)

(Connection) At 1430 vs on the 23<sup>rd</sup> mile a point from which the S corner of 30 H & T C R.R. Co brs South 6

24<sup>th</sup> Mile

Thence West at 1450 vs a point from which the  
 S cor of 30 T<sup>h</sup> & O R R Co brs South 6706 vs crossing draws  
 of S. Llano at 1900 vs a rock mound from which a L.O  
 24 in dia brs S 52 W 50 vs do 12 in dia brs N 25 1/2 E 67 vs  
 bearings mkd  $\begin{matrix} S \\ E \end{matrix}$  (24)

25<sup>th</sup> Mile

Thence West crossing draws of S. Llano at 1175 vs a point  
 from which the E cor of Sur 26 T<sup>h</sup> & O R R Co brs S 10244 vs  
 at 1900 vs rock mound no trees for bearings mound mkd  $\begin{matrix} S \\ E \end{matrix}$  (25)

26<sup>th</sup> Mile

Thence West across rolling hollows at 1900 vs a rock  
 mound from which a L.O 6 in dia brs N 31 1/2 E 80 vs and  
 do brs S 63 1/4 W 48 vs bearings mkd  $\begin{matrix} S \\ E \end{matrix}$

27<sup>th</sup> Mile

Thence West at 800 vs cross road a rock mound from  
 which a L.O 10 in dia brs N 7 1/2 W 62 vs at 1900 a Rock  
 Mound on side of hill in Drago Hollow from which a  
 L.O 10 in dia brs N 57 1/2 W 110 vs bearings marked  $\begin{matrix} S \\ E \end{matrix}$

28<sup>th</sup> Mile

Thence West at 1177 a point from which the S.E. Cor of  
 League No 1 Menard Co School Land brs S 6172 vs at 1400 vs  
 a rock water hole on draws of S. Llano at 1900 vs rock  
 mound from which a L.O 4 in dia brs S 82 E 19 vs do 4 in  
 dia brs S 34 W 16 vs bearings marked  $\begin{matrix} S \\ E \end{matrix}$

29<sup>th</sup> Mile

Thence West at 1700 vs cross road (McKangie Trail)  
 at 1900 vs rock mound from which a L.O 12 in dia brs N 28 W  
 a L.O 4 in brs S 74 W 21 vs do 4 in N 75 W 23 vs mound on  
 level plateau marked  $\begin{matrix} S \\ E \end{matrix}$

30<sup>th</sup> Mile

Thence West through level plateau at 1900 vs a rock  
 mound from which a L.O 18 in dia brs N 7 W 103 vs mound  
 on level land marked  $\begin{matrix} S \\ E \end{matrix}$

31<sup>st</sup> mile

Thence West at 730 a large L.O 12 in at butt at about 3 ft it forks having 3 forks middle fork marked 3 hacks the other forks blazed middle fork marked on W side  $\bar{x}$  the other forks blazed on W side at 860 vs crossed road named (8 mile or Snake road) at 1900 rock mound from which a L.O 14 in dia by N 52 W 14 vs in level prairie marked  $\overset{S}{E}$

32<sup>nd</sup> mile

Thence West across level Table land at 1900 vs rock mound no bearing trees mound marked  $\overset{S}{E}$

33<sup>rd</sup> mile

Thence West across level open prairie at 1677 a point from which the N.W cor of league No 2 Mcnair Co School land by S 117 2 vs at 1900 vs rock mound in cluster of Live Oaks one 8 in dia by S 74 W 140  $\frac{3}{5}$  vs bearings marked  $\overset{S}{E}$

34<sup>th</sup> mile

Thence West through level prairie at 1900 vs to rock mound from which a L.O 12 in dia by N 64 W 58  $\frac{3}{5}$  vs and another L.O 6 in dia by East 8 vs bearings marked  $\overset{S}{E}$

35<sup>th</sup> mile

Thence West through level mesquite flat at 1900 vs to Rock mound from which a mesquite 4 in dia by N 44  $\frac{1}{2}$  E 3  $\frac{1}{2}$  do 4 in dia by S 17  $\frac{1}{4}$  W 24 vs also a L.O 30 in dia by S 14  $\frac{1}{2}$  E 145 vs bearings marked  $\overset{S}{E}$

36<sup>th</sup> mile

Thence West through level mesquite flat about 800 vs the rolling open prairie at 1900 vs rock mound from which a L.O 14 in dia by N 6 W 5 vs do 8 in dia by W 109 vs said mound on draws of N Llano bearings marked  $\overset{S}{E}$

37<sup>th</sup> mile

Thence West through open rolling prairie at 1900 vs rock mound from which a L.O 8 in dia by N 81 W 32 vs do 10 in dia by N 48 W 30 vs mound in level prairie bearings marked  $\overset{S}{E}$



38<sup>th</sup> mile

Thence West through rolling prairie at 1900 as rock mound from which a L.O 15 in dia brs N 31 E 117 vs bearings mkd  $\frac{S}{E}$

39<sup>th</sup> mile

Thence West through level prairie with motts of L.O bushes at 1900 as Rock mound in flat from which a L.O 12 in dia brs S 65 W 30 vs bearings mkd  $\frac{S}{E}$

40<sup>th</sup> mile

Thence West at 277 as a point from which the SW corner of Menard Co School Lands brs S 61 1/2 vs through level land covered with L.O. bushes at 1900 as rock mound from which a L.O 6 in brs E 18 vs bearings mkd  $\frac{S}{E}$

41<sup>st</sup> mile

Thence West through open prairie country at 1900 as Rock mound in open prairie no trees for bearings near mound marked  $\frac{S}{E}$

42<sup>nd</sup> mile

Thence West through open prairie at 1900 as rock mound on draws of Buckley Creek from which a L.O 6 in dia brs S 59 W 34 vs and another L.O. 8 in dia brs N 15 E 5 1/5 vs

43<sup>rd</sup> mile

Thence West crossing rolling hollows on Buckley Creek at 1900 as Rock mound from which a L.O 8 in dia brs N 82 1/2 E 51 vs do 12 in dia brs S 89 1/2 W 150 vs

44<sup>th</sup> mile

Thence West through rolling prairie at 1900 as rock mound from which a Mesquite 4 in dia brs E 25 vs a L.O 12 in dia brs S 72 1/4 E 132 vs

45<sup>th</sup>

Thence West through open prairie, to rock mound in draw of Buckley Creek from which a L.O 8 in dia brs N 12 vs mkd  $\frac{S}{E}$

46<sup>th</sup>

Thence West through open ridges, to rock mound 3 ft high on draw of Buckley Creek no trees for bearings and marked  $\frac{S}{E}$

Edwards Co. Bdry. Line # 27 1/2

47<sup>th</sup> Mile

Thence West through open hollows at 1900 as Rk Mnd in valley on draws of Buckley Creek no trees for bearings mnd marked <sup>S</sup>E

48<sup>th</sup> Mile

Thence West at 1900 as Rock Mnd in valley of draw of Buckley Creek from which a L.C. 10 in dia brs W 74<sup>th</sup> ds 6 in brs N 20<sup>1</sup>/<sub>2</sub> W 33<sup>rd</sup> vs marked <sup>S</sup>E

49<sup>th</sup> Mile

Thence West at 645 as a point from which the SW corner of Sur 45 CCSD & RGN & RRC<sub>0</sub> brs S 55 20<sup>th</sup> vs at 1900 as L.C. stake in open valley on draw of Buckley Creek from which a L.C. 5 in dia brs N 76 W 94<sup>th</sup> ds 5 in dia brs N 82<sup>1</sup>/<sub>2</sub> W 89<sup>th</sup> vs bearings mnd <sup>S</sup>E

50<sup>th</sup> Mile

Thence West at 1900 as a rock mound on side of ridge from which a L.C. 5 in dia brs S 85 W 42<sup>nd</sup> vs + another L.C. 10 in dia brs N 83<sup>1</sup>/<sub>2</sub> W 66<sup>th</sup> vs Bearings mnd <sup>S</sup>E

51<sup>st</sup> Mile

Thence West through open rolling country crossing draws of Buckley Creek at 1900 as rock mnd from which a L.C. 6 in dia brs West 172<sup>nd</sup> vs mnd <sup>S</sup>E

52<sup>nd</sup> Mile

Thence West at 1900 as Rk Mound in draws of Buckley Creek no trees for bearings mnd mnd Ed Co Line

53<sup>rd</sup> Mile

Thence West at 645 as a point from which the N E cor of Sur 9 GC & S & RRC<sub>0</sub> brs S 17 20<sup>th</sup> vs at 1900 as rock mnd in open prairie from which a L.C. 4 in dia brs N 3<sup>1</sup>/<sub>2</sub> E 84<sup>th</sup> vs ds 6 in dia brs N. 2 W 80<sup>th</sup> vs mnd <sup>S</sup>E

South East cor. mnd  
of N Co. cor.

54<sup>th</sup> Mile

Thence West at 1900 as rock mnd from which a L.C. 4 in dia brs N 64<sup>1</sup>/<sub>2</sub> W 26<sup>th</sup> vs ds 8 in dia brs S 30<sup>1</sup>/<sub>2</sub> W 39<sup>th</sup> vs bearings mnd <sup>S</sup>E

55<sup>th</sup> Mile

Thence West at 1330 as a point 738<sup>th</sup> vs North from the terminus of Co line run by Boyle & Holmes a Large Rock Mound  
(Continued)

55<sup>th</sup> Mile (Continued)

made for the N.W. Cor of Edwards County and the N.E. Corner  
of Val Verde Co from which a Live Oak 12 in dia brs N 89 W 91<sup>o</sup> 45  
do 6 in dia brs S 58 W 48<sup>o</sup> 35<sup>o</sup> 45. The N.E. cor of No 11 G.C. & S.F.R.R. Co is  
East 685<sup>o</sup> 45 + North 180<sup>o</sup> 45 from N.W. cor of Edwards Co Texas S.E.  
Cor of Sur 11 G.C. & S.F.R.R. Co brs S 17 20 + E 685<sup>o</sup> 45 bearings mkd VVE  
Surveyed from June 1<sup>st</sup> to June 18<sup>th</sup> 1888

Bearings marked  $\frac{K}{E}$  for 22 miles balance  $\frac{S}{E} + \frac{E}{E}$

Variation N.W. cor New Co 9<sup>o</sup> 15 E increased variation 15" mile  
Chain Carriers J. B. Dodd. H. J. Edwards D. J. Brice

We. W<sup>m</sup> P. W. Holmes County Surveyor of Edwards Co Tex  
do hereby certify that the foregoing Survey was actually  
made in the field according to law and that the limits  
boundaries and Corners with the marks natural  
and artificial are truly described in the foregoing  
Plat & Field Notes

W<sup>m</sup> P. W. Holmes

Co Sur Edwards County Tex

J. B. Reeves

Depty Sur Ed Co Tex