

Warde County

The State of Texas } (Variation $8^{\circ}45' E$
 County of Bandera }

Field notes of the survey of the Boundary line between Bandera and Edwards Counties, made under an order of the Commissioners courts of said Counties, and in accordance with the provisions of an Act establishing and prescribing the manner of ascertaining the boundaries of Counties, approved April 22nd 1879.

Beginning at a Rock mound set for the N.W. corner of Bandera County and the S.W. corner of Kerr County, from which a Shin Oak 5" bears North $37^{\circ} W.$ $24\frac{2}{5}$ varas; a do 5" bears $N.39\frac{1}{2}^{\circ} W.$ 27 varas, and from which the N.E. corner of Survey No. 18 C.T. R.R. co bears $N.22^{\circ} E$ 4800 varas:

Thence South 1900 varas to a Rock mound from which a Shin Oak 5" bears $S.16\frac{3}{4}^{\circ} W.$ $46\frac{3}{5}$ varas; a do 4" bears $S.38\frac{3}{4}^{\circ} W.$ 40 varas.

Thence South 1400 varas to the South bank of Paint Creek 1488 varas to a Rock mound on road side from which the junction of Paint creek and the Friso River bears $S.46^{\circ} W.$ 200 varas; 1900 varas to a Rock mound in the valley near the foot of a hill, and 90 varas East of the Friso River, from which a Shin Oak 6" bears $S.13\frac{3}{4}^{\circ} E$ $11\frac{1}{2}$ varas; a L.O. 12" bears $S.36^{\circ} W.$ $7\frac{1}{2}$ varas.

Thence South 400 varas crossing bend of the Friso River 1900 varas to a Rock mound from which a Shin Oak 5" bears $S.34^{\circ} E$ 43 varas; a do 5" bears $S.75^{\circ} W.$ 78 varas.

Thence South 600 varas crosses Bluff Creek 600 varas above its mouth 1900 varas to a rock mound on a branch of Bluff creek from which a Cedar 8" bears $S.25\frac{1}{2}^{\circ} W.$ $17\frac{1}{2}$ varas.

Thence South 762 varas to a point from which the S.W. corner of Survey No 10 C.T. R.R. co. bears west

5 804 varas, 1900 varas to a rock mound on a high bluff
on a branch of Rain valley.

6 Thence South 1900 varas to a Rock Mound in
Rain Valley, from which a S.O. 2" bears S. 5° E. 8 varas.

7 Thence South 1146 varas to a point from which
the N.E. corner of Survey no. 4. C.T.R.R. Co bears west-216
varas, -1260 varas crosses East slope of a Mountain in
Rain Valley, -1900 varas to a Rock Mound on foot of
said Mountain from which a L.O. 10" bears N 78½° W. 7
varas, a Cedar 20" bears N. 30½° W. 5 varas.

8 Thence South 1900 varas to a Rock Mound on West
slope of point of Mountain, from which a L.O. 5" bears
N. 38° W. 27 varas.

9 Thence South 1900 varas to a Rock Mound on
west side of Mountain and 300 varas East of the
Frio River.

10 Thence South 1900 varas to a Rock Mound from which
a L.O. 48" bears S. 58½° W. 180 varas

11 Thence South 636 varas to a Rock Mound on
the Frio Road from which a Pecan 12" bears S. 38½°
E. 16 varas, 692 varas to a point on south line of Survey
no. 1531.4 S.A. & M.G.R.R. Co and 483 varas S. 83° W. from its
S.E. corner, -1000 varas to the Frio River 1530 varas to
an old ditch. 1740 varas crossing ditch, -1900 varas
to a Rock Mound from which a L.O. 20" bears S 47½°
W. 6 varas, a do 24" bears S. 65° W. 4 varas.

12 Thence South 1228 varas to a point from which
the S.W. corner of Survey No. 1531 J.F. Pickett bears west
80 varas, 1900 varas to a Rock Mound in main road-way
from which a L.O. 12" bears S. 45½° E. 19 varas, a Cedar 12" bears
S 30¾° E 17 varas.

13 Thence South 1100 varas to a point from which
the N.E. corner of the Public Square in the Town of Deary
bears west 65 varas, 1900 varas to a Rock Mound from
which a L.O. 10" bears S. 25° E. 15 varas, a do 5" bears S. 79° E. 20 varas.

14 Thence South 676 varas to a point from which the N.W. corner of Survey No. 1527 J.A. Ortiz bears East 78 varas, - 1900 varas to a Rock Mound from which a L.O. 10" bears S $13\frac{1}{2}$ W. 20 varas, a B of 5" bears S $12\frac{1}{2}$ E 12 varas.

15 Thence South 1850 varas to a point from which the S.W. corner of Survey No. 1525 T. Applewhite bears West 154 varas, - 1900 varas to a Rock Mound in a field embracing parts of Surveys No. 1525 T. Applewhite and No. 601 Nancy Spencer.

16 Thence South 414 varas to a point from which the N.W. corner of Survey No. 602 Wm. Bryan bears East 104 varas - 1273 varas to a point from which the N.W. corner of Survey No. 603 C. Wilkinson bears East 540 varas - 1900 varas to a Rock Mound from which a L.O. 8" bears S 54 E 47 varas, a D of 10" bears S $20\frac{1}{2}$ W. $57\frac{2}{5}$ varas.

17 Thence South 290 varas to a point from which the N.W. corner of Survey No. 604 J. Metcalf bears East 740 varas 1900 varas to a Rock Mound in a valley from which a S.O. 4" bears N $29\frac{1}{2}$ W. $9\frac{3}{5}$ varas, a D of 3" bears N $21\frac{1}{2}$ W 9 varas.

18 Thence South 657 varas crosses top of mountain ridge 1280 varas to a point from which the N.W. corner of Survey No. 607 Adam Hagan bears East 460 varas - 1900 varas to a rock mound in a valley from which a S.O. 6" bears S $7\frac{3}{4}$ W 78 varas.

19 Thence South 550 varas crossing top of round mountain, 1900 varas to a rock mound in the valley of Buffalo Creek from which a L.O. 10" bears S. 60 E. 20 varas, a D of 8" bears S 67 E 21 varas.

19 1/2 Thence South 270 varas crosses Buffalo Creek, 950 varas to a rock mound 4 feet high on the line of Uvalde County 20 miles and 1745 varas from its N.E. corner, placed for the S.W. corner of Bandera County and the S.E. corner of Edwards County

from which the S.W. Corner of Survey No 610 Wm Lewis
Bears N. 55° E. 612 Varas, and a L.O. 20" bears N 31° W 65-
Varas,

Bearings Marked B.E.
Surveyed Nov 19th 1894 to Dec 8th 1894.

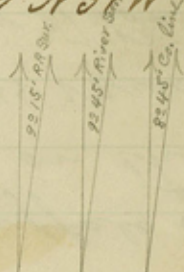

We, A.L. Scott appointed of the Court of Bandera
County and Jos Buswell appointed of the Court
of Edwards County to survey the Boundary line
between the said Counties do hereby certify
that the said survey was actually made in
the field and according to law, and that the
limits, boundaries and corners are truly
described in the foregoing plat and field
notes.

Given under our hands this 3rd day of
January A.D. 1895.

A.L. Scott - Surveyor Bandera Co
Jos Buswell Surveyor
Edwards Co.

Edwards Co. Bdry (H)
28

Boundary line between
Bandera and
Edwards Counties

Received & Filed
01/19/95
A.L.C.

Plat acknowledges receipt
the following of the same line
has been received and approved
and Abstract corrected accordingly
in this Office in 1884.
G.W. Proctor

FILED FOR RECORD
the 11 day of January 1895
at 9 o'clock A.M.
Wm. Sanford Clerk C. C.
Edwards Co., Texas.
By Deputy

Filed in my Office this 28th day of
January 1895 at 11.15 o'clock A.M.
J. J. Fontagne
Clerk C. C. COURT,
BANDERA COUNTY

THE STATE OF TEXAS,

County of Edwards } I, Wm. Sanford Clerk of the

County Court in and for said County, do hereby certify that the foregoing Field notes & plat

dated the 3rd day of January 1895, with its certificates of authentication, was filed for Record

in my office, the 11th day of January 1895 at 9 o'clock A.M., and duly Recorded

the 12th day of January 1895 at 10 o'clock A.M., in lower court

Record of said County, in Vol. 2 on Pages 343 to 346

WITNESS my hand and the seal of the County Court of said County, at office in Rockspring

Texas, the day and year last above written.

By Wm. Sanford Deputy County Court Edwards County.

82937

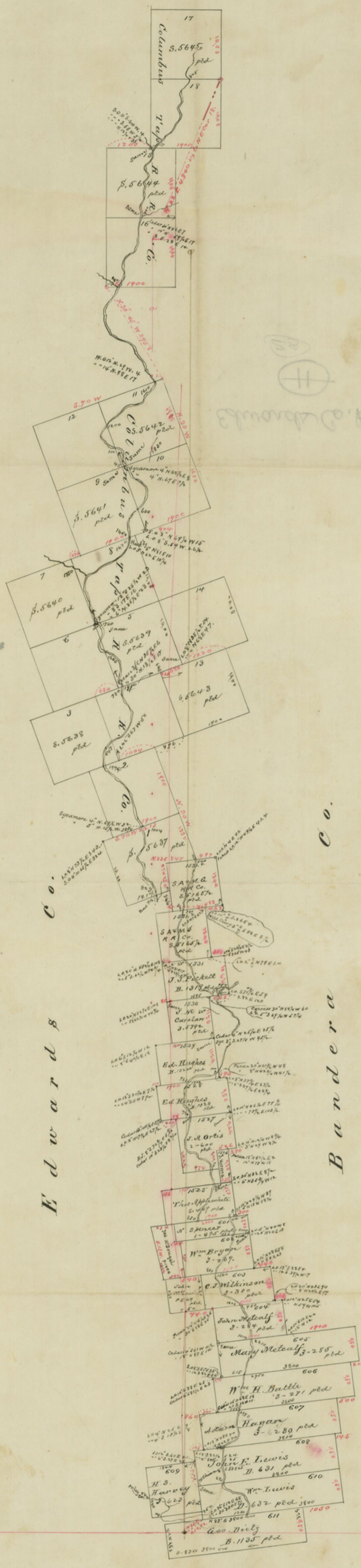

Edward & Co.

Banda & Co.

Uvalde Co.

Counter 52937

Map of Edwards Co. Ga.

Edwards Co. Ga.

Edwards Co. Ga.

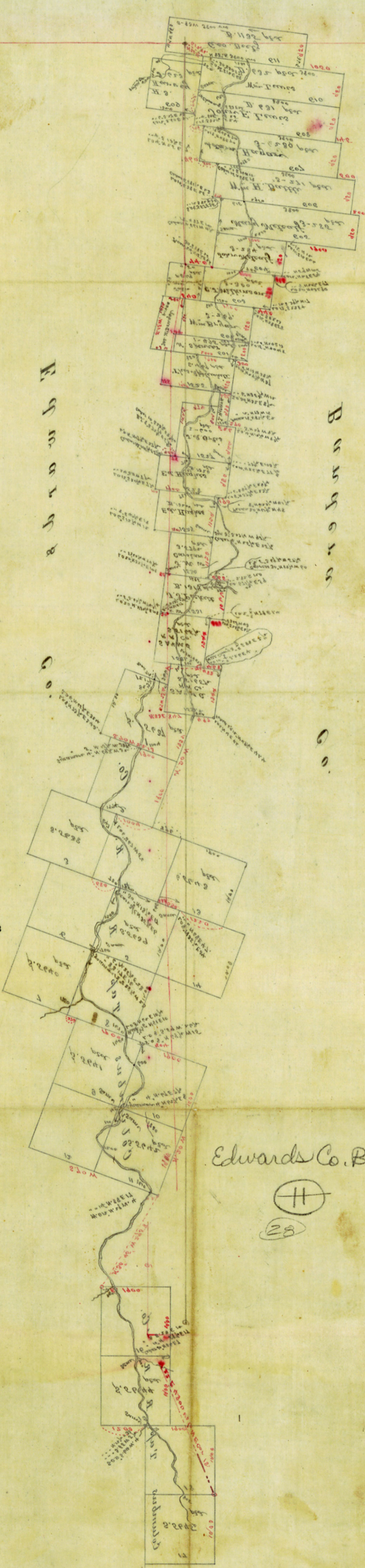

Edwards Co. Bdry

(11)

(28)