

County SS 279

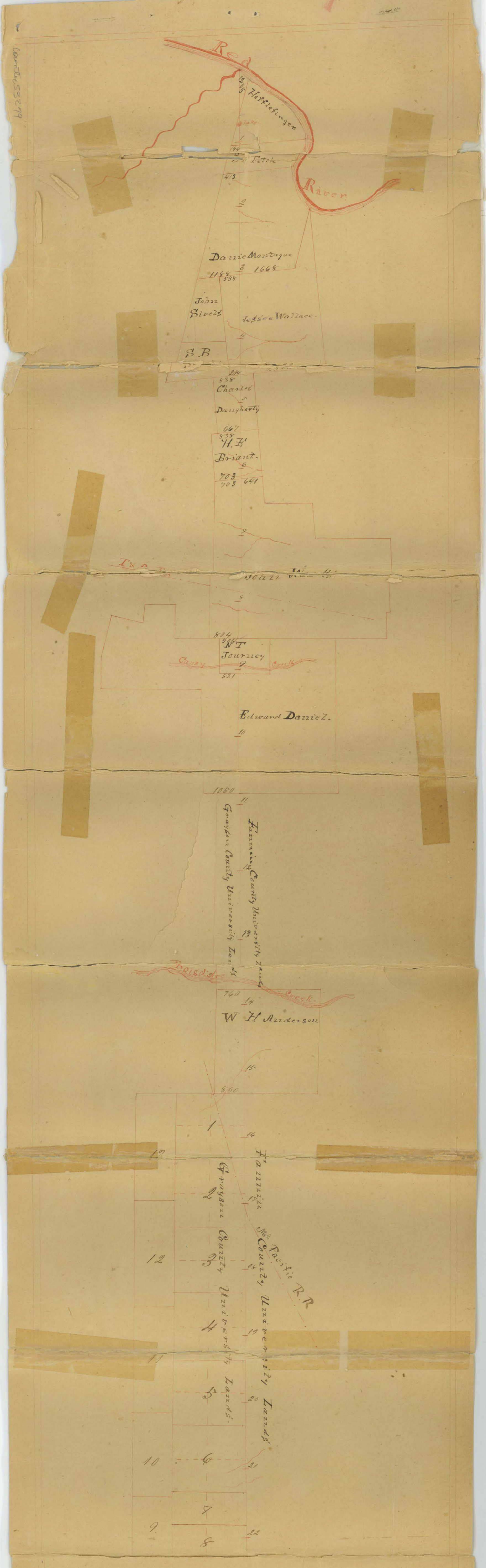

State of Texas
 County of Tarrant }
 Me. M. Kintly duly appointed
 by the County Court of said County and Samuel
 Bonham duly appointed by the County Court of Gray-
 son County, to establish mark and measure, the
 Eastern boundary line of Grayson County and the
 Western boundary line of Tarrant County do certify
 under the oath of our Office, that the above and
 foregoing sketch, Map is a true representation of
 said line as defined by us, and the survey
 through which it runs and the natural and
 artificial marks, called for in field notes of
 said line are correctly represented above. In testimony
 whereof witness our Official Signatures, on this the
 7th day of August 1882
 M. Kintly C.S. & G.
 Samuel Bonham C.S. & G.

Fannin Co Bdy 10

County line
between
Fannin & Grayson Cos

Filed Decem^r 6/82

D. N. Robinson
Chief Clerk

Signed by both Surveyors

Witnessed by
John P. ...

County 5329