

"FAYETTE and GONZALES COUNTY:

-----oOo-----

- 1- Field Notes by J.B. Armstrong, Fayette Co - 5/19/55 Page 1
- 2- " " " " " " 5/22/55 " 3 + 4
- 3- " " " R.A. Doss. + E.H. Stearns April + May 1882 7 + 8

J. B. Armstrong having submitted to the Court a report in writing in reference to the running of the County line between the County of Fayette and Gonzales and between the County of Fayette & Bastrop the same having been examined and approved by the Court and ordered to be filed and recorded.

State of Texas, |

County of Fayette. | To the Hon'l. the County Court of said County. The undersigned, by virtue of an order of your Hon'l. Court, made at its February Term, A.D. 1855, requiring him to proceed forthwith and run the line between the Counties of Gonzales and Fayette, and between said County of Fayette and the County of Bastrop, begs leave to make the following report viz: Commencing at the North East corner of a quarter of a league of land, granted to Morris situated on the head waters of the Lavaca and Waters of Peach Creek in Gonzales & Fayette Countys. Thence North $49^{\circ} 15'$ West to the North East corner of a fourth of a league of land, granted to Stiffler. Thence North 45° East crossing the Colorado River at a place known as Grassmeyers old Ferry continuing same course to Rabbs Creek. The undersigned would further state to your Honl. body that after corssing the Colorado river running North 45° East as aforesaid he run with the Old County line heretofore made from said river to said Creek the line is marked plainly with a blaze and three chops above it, and three below it, all of which is respectfully submitted. La Grange 19th, May 1855.
(Signed) J.B.Armstrong Co.Surveyor of Fayette Co.,Texas.

-----oCo-----

/d

THE STATE OF TEXAS, |
COUNTY OF FAYETTE. | I, ALBERT F. MACH, Clerk of the
County Court and ex officio Clerk of the Commissioners'
Court of Fayette County, Texas, do hereby certify that the
above and foregoing is a true and correct copy of the Order
of the Commissioners' Court, approving the Report of the
County Surveyor, and the Report of the County Surveyor, as
to running a line between the Fayette County and Gonzales
County, as the same appears of record, in Volume "B", upon
pages 2 and 3, Minutes of the Commissioners' Court, in and
for Fayette County, Texas.

WITNESS MY HAND AND THE SEAL OF SAID COURT, at my office,
in the city of La Grange, Texas, this the 21st. day of June,
A.D. 1927.

ALBERT F. MACH,
Clerk County Court and Ex Officio
Clerk Commissioners Court, of
Fayette County Texas.

By *R. L. Brant*, Deputy.

---oOo---

2d

J. B. Armstrong County Surveyor of Fayette County, having presented to the Court an amended Report in Writing in reference to the running of the County line between the County of Fayette and Gonzales and between Fayette & Bastrop County, together with a Plot of said line so run, the same being examined by the Court and found to be in conformity to law, the same is hereby approved by the Court and ordered to be filed and it is further ordered that said report be entered on the minutes of this Court.

The State of Texas, |
County of Fayette. | To the Hon'1. the County Court of
said County.

The undersigned by virtue of an order of your Honl. Court made at its February Term, A.D. 1855, requiring him to proceed forthwith and run the line between the Counties of Gonzales and Fayette and between said County of Fayette and the County of Bastrop. Begs leave to make the following report, viz: Beginning at the North East corner of a quarter of a league of land granted to J. Morris, situated on the headwaters of the Lavaca and Waters of Peach Creek in Gonzales and Fayette Counties, a cedar stake from which a Live Oak 12 inches in diameter marked x bears N. 52° E. 170 varas. Thence North 49° 15' ^{West} East to the North East corner of a quarter of a league of land granted to Stiffler a stake from which a Post Oak marked G.C. bears S. 50 W. 7 varas, a Ditto marked C.C. bears West 8 varas a Do. marked B.C. bears N. 20° E. 10 varas, a Ditto marked F.S. bears S. 60° E. 12 varas. Thence North 45° East crossing the Colorado River at a place known as Grassmeyers Old Ferry, continuing same course to Rabb Creek. The undersigned would further state to your Honl. body that after crossing the Colorado River running N. 45 E. as aforesaid he run with the old County line heretofore made from said river

to said creek the lines is marked plainly with a Blaze & three chops above it & three below it, all of which is respectfully submitted. La Grange, 22d. May 1855.

J. B. Armstrong, County Surveyor of Fayette County.

-----oOo-----

THE STATE OF TEXAS, |
COUNTY OF FAYETTE. | I, ALBERT F. MACH, Clerk of the County Court, and ex officio Clerk of the Commissioners' Court, in and for Fayette County, Texas, do hereby certify that the above and foregoing is a true and correct copy of the Order of the Commissioners' Court, approving the Report of the County Surveyor, and the Report of the County Surveyor, as to running line, between Fayette and Gonzales County, as the same appears of record, in Volume B., upon pages 5 and 6, Minutes of the Commissioners' Court, in and for Fayette County, Texas.

WITNESS MY HAND AND THE SEAL OF SAID COURT, at my office, in the city of La Grange, Texas, this the 21st. day of June, A.D. 1927.

ALBERT F. MACH,
Clerk County Court, and ex officio clerk
Commissioners' Court, in and for
Fayette County, Texas.

By *R. L. Branek*, Deputy.

-----oOo-----

It is ordered by the Court that Jesse B. Armstrong, Co. surveyor, is hereby appointed to act in conjunction with the County Surveyor of Gonzales County for the purpose of running the County line between the County of Fayette & Gonzales on the 10th. day of January, A.D. 1855, and report to the next regular term of this Court.

-----oOo-----

THE STATE OF TEXAS, |
COUNTY OF FAYETTE. | I, ALBERT F. MACH, Clerk of the County Court, and ex officio Clerk of the Commissioners' Court, in and for Fayette County, Texas, do hereby certify that the above and foregoing is a true and correct copy of the Order of the Commissioners' Court, ordering the County Surveyor to survey the County line, between Fayette and Gonzales County, as the same appears of record, in Volume "A", upon page 337, Minutes of the Commissioners' Court, in and for Fayette County, Texas.

WITNESS MY HAND AND THE SEAL OF SAID COURT, at my office, in the city of La Grange, Texas, this the 21st. day of June, A.D. 1927.

ALBERT F. MACH,
Clerk County Court, Fayette County, Texas.

By *A. P. Brank*, Deputy.

-----oOo-----

It is ordered by the Court that the County Surveyor of this County in conjunction with the surveyors of adjoining Counties be authorized and directed to ascertain by actual survey the boundary lines of Fayette County, or any part thereof of said County, not yet sufficiently and well defined and determine ~~and~~ at the same time the amount of acres in the border surveys or portions of them lying in Fayette County and to report to the court a correct list of the surveys penetrated by the County line, also a correct map of said Co. line and border surveys as required by law. in Art. 1 of the Act of April 22, 1879, to provide for, ascertain and establishing the boundaries of Counties, to be recorded in the surveyors Book, and the clerk of this court notify the clerk of the various counties adjoining Fayette, of this order.

-----oOo-----

THE STATE OF TEXAS, |
COUNTY OF FAYETTE. | I, ALBERT F. MACH, Clerk of the County Court and ex officio clerk of the Commissioners' Court, in and for Fayette County, Texas, do hereby certify that the above and foregoing is a true and correct copy of the Order of the Commissioners' Court, ordering the County Surveyor to mark out the County Line, between Fayette County and other Counties, etc., as the same appears of record, in Volume 2, upon page 63, Minutes of the Commissioners' Court, in and for Fayette County, Texas.

WITNESS MY HAND AND THE SEAL OF SAID COURT, at my office, in the city of La Grange, Texas, this the 22nd. day of June, A.D. 1927.

ALBERT F. MACH,
Clerk County Court, Fayette Co., Texas &
Ex Officio Clerk of the Commissioners
Court, Fayette County, Texas.

By *R. D. Drane*, Deputy.

-----oOo-----

THE STATE OF TEXAS, |
COUNTY OF FAYETTE. |

REPORT ON GONZALES COUNTY LINE.

To the Honorable Court of Commissioners of Fayette County.
We the undersigned surveyors of Fayette & Gonzales Counties respectfully submit to your honorable body the following report of a survey locating & establishing the boundary line between Gonzales & Fayette Counties in accordance to your order issued at your November term 1881 and further in accordance with the act passed by the Legislature establishing said line also with an act establishing and prescribing the manner of ascertaining the boundaries of Counties passed Ap.22,1879, Now, therefore and as there was no record of said line in either of the two Counties giving any description or course of said line we had to run a preliminary line to ascertain the course of the true line, after satisfying ourself about the N.E. cor. of the John Morris 1/4 league for which the act calls for, we run a line at N. 50° W. and failed to strike the N.E. corner of the Joseph Stiffler 1/4 league and after a careful calculation we found the course of the true line to be S. 48° E. at a variation of 9° 50' E. Thence beginning to locate the line we started again at the N.E. corner of the John Morris 1/4 league and set a post for corner at 1100 vs. crossed a branch of Peach Creek at 1900 vs. set post No.1. Thence at 453 passing the west line of Jesse Richards league and entering the James Murphy survey 1371 vs. from its N.E. corner at 1000 vs. crossing a branch at 1900 vs. set post No.2. Thence at 622 vs. passing West line of Jos. Murphy survey 60 vs. south of its N.W. corner at 712 vs. passing west line of James Ryans survey and entering Prosper Hope at 1900 vs. set post No.3. Thence at 100 vs. cross a branch at 688 vs. passing the South line of the Christopher Williams 1/4 league 420 vs. West of its S.E. corner at 1480 vs. cross Cedar Creek running West at 1580 vs. across the track of the G.H. & S.A.R.R. at a place from which the house of C.D.Williams bears N. 12° E. 110 vs. Thence at 1900 vs. set the 4th.post.

Thence at 1587 vs across the West line of Chris. Williams 1/4 league at 1620 vs. cross big five mile at 1900 vs set the 5th. mile post in Chesners field. Thence passing about 120 vs. S.W. of Sayers dwelling house and 25 vs. N.E. of his well on the Flatonia & Waelder road at 1542 vs. passing the North line of the J. Gibson league and the South line of the John Menefee at 1900 vs the 6th. mile post. Thence at 575 vs. intersecting the East line of the Adam Zumwalt league at a point North 690 vs. from its S.E. corner at 1900 vs. set the 7th. mile post from which Boid Cochrans dwelling house bears N. 50° E. 70 vs. Thence passing about 50 vs. N.E. of Post Oak grove Schoolhouse at 1900 vs. set the 8th. mile Post in old Cochrans field thence at 250 vs. cross Pin Oak Creek running S.W. at 1900 vs set Post No. 9, in Peach Creek bottom. Thence at 200 vs. across Peach Creek at 1900 vs. the Post No. 10 about 400 vs. S.W. of the old Mullin house. Thence continuing same course trough Mesquit Prairie at 1900 vs. set the Post No. 11, in Fishers Pasture. Thence at 200 vs. intersecting the West line of the Joseph McCoy 1/4 league at a place 236 vs. South of its N.W. corner at 1900 vs. the 13th. mile post in the Post Oaks on the East bank of a deep ravine. Thence trough Post Oak timber at 900 vs. across a branch at 1900 vs set the 14 mile post. Thence at 400 vs cross little Coperas at 1035 vs. intersecting the East line of Chas. McKinney survey at 1900 vs. the 15th. mile a Post at the N.E. corner of the Joseph Stifler 1/4 league and the initial corner of the two Counties & 175 S. 25° W. from the North corner of the Ch. McKinneys survey in the S.W. line of the S.M. Williams league. Surveyed from Apl. 24 to May the 4th., 1882.

R. A. Doss, C.S.F.C.

E. H. Steen, C.S. G. C.

W.J.O'Daniel

Chainmen. J. Eisenberg Marker.

Charles A. Doss.

We the undersigned surveyors of Fayette & Gonzales Counties do hereby certify that the foregoing survey was

made by us according to law and that the marks natural and
artificial are truly described in the foregoing field notes.

Given this
the 4th. of
May 1882.

R. A. Doss, C. S. F. C.

E. M. Steen, C. S. G. C.

(Map to follow)

-----oOo-----

THE STATE OF TEXAS, |

COUNTY OF FAYETTE. | To the honorable Court of Commissioners of Fayette County.

As an order was issued by your Honorable body during your November term, 1881, to determine the amount of acres in the border surveys or portions of them lying in Fayette County, and to report to the Court a correct list of the Surveys penetrated by the County line also a correct map of said County line & border surveys, as required by law in Sect.1, of the act of April the 22;, 1879. Therefore I do herewith respectfully Report as follows:

1. of Charles McKinney Survey of 480 acres of which are 43 acres in Fayette County.
2. of Freeman George 23 labors, of which are 2700 acres in Fayette County.
3. of Adam Zumwalt 1 league, of which are 1917 acres in Fayette County.
4. of Joseph McCoy 1/4 league, of which are 806 acres in Fayette County.
5. of John Menefees 1/3 league, of which are 1429, acres in Fayette County.
6. of James Gibson 1 league, of which are 125 acres in Fayette County.
7. of Christopher Williams 1/4 league, of which are 743 acres in Fayette County.
8. of Prosper Hope 19-1/4 labors, of which are 108 acres in Fayette County.
9. of James Murphy survey of 808½ acres, of which are 188 acres in Fayette County.
10. of North part of Jesse Richards league, of which are 683 acres in Fayette County.

I, R. A. Doss, County Surveyor of Fayette County, do hereby certify that the above is a correct list of surveys penetrated by the line dividing Fayette County and Gonzales County and that the areas as given on said list of each of

such surveys is the full amount of land lying in the County of Fayette and that the same was determined by me through an actual survey after the line dividing said two Counties was located & established in the lawfull manner and that a map thereof is recorded in Surveyors Book A. on page 243. Given under my hand and office this the 10th.day of May, 1882.

R. A. Doss, C. S. F. C.

-----oOo-----

THE STATE OF TEXAS, |
COUNTY OF FAYETTE. | I, ALBERT F. MACH, Clerk of the
County Court and ex officio Clerk of the Commissioners' Court, in and for Fayette County, Texas, do hereby certify that the above and foregoing is a true and correct copy of the Report of the County Surveyor, running the line between Fayette and Gonzales County, together with the map thereto attached, and Report of Surveys, (Border Surveys) as to acreage, etc., as the same appears of record, in Volume "A", upon pages 242 to 244, Surveyor's Record, in and for Fayette County, Texas.

WITNESS MY HAND THE SEAL OF SAID COURT, at my office, in the city of La Grange, Texas, this the 22nd. day of June, A.D. 1927.

ALBERT F. MACH,
Clerk County Court, Fayette County, Texas,
Ex Officio Clerk, Commissioners Court,
Fayette County, Texas.

By *W. D. Brank*, Deputy.

-----oOo-----

Bastrop County Line

Plat of the
 Line dividing Fayette & Gonzales
 Counties and the leader surveys, as
 made by the surveyors:
 R. A. Glass, Fayette & E. M. Steen
 for Gonzales Co.
 in April of 1882.

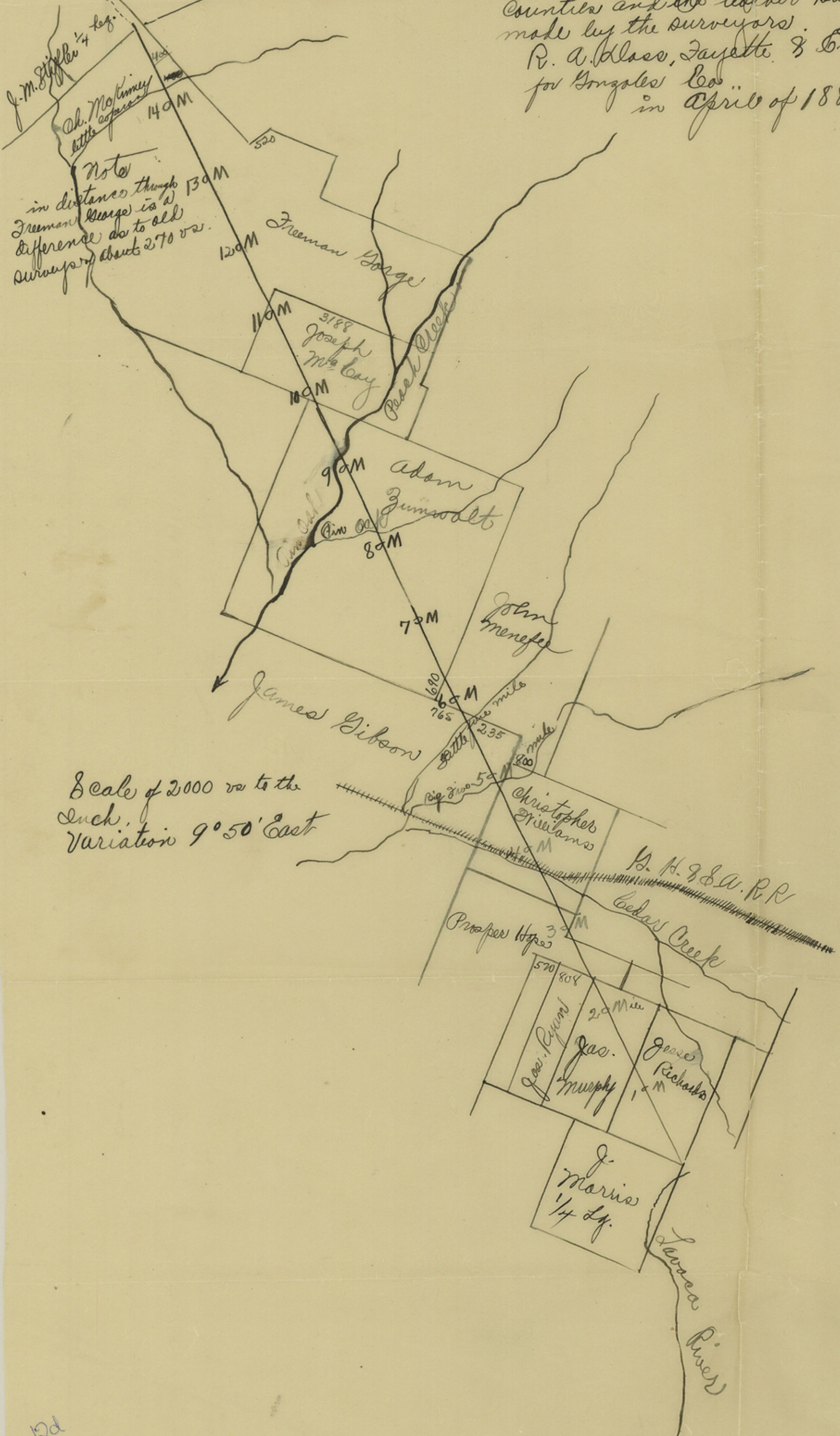

Note
 in distance through
 Freeman Gorge is a
 difference as to all
 surveys of about 270 or 280.

Scale of 2000 ft to the
 inch.
 Variation 9° 50' East

24
County Line -

Fayette & Gonzales
Counties -

Filed June 28th 1927

J. S. Roberson, Court-
Clerk-

See F/N^o Filed
9-16-30

Counter 63344

130