

"FAYETTE AND COLORADO COUNTY LINE."

-----oOo-----

|    |   |              |            |                 |          |
|----|---|--------------|------------|-----------------|----------|
|    |   | Field Notes. | West River | dated 7-20-77   | Page 2+3 |
|    |   | " "          | East "     | " 5-15-78       | " 6+7    |
| OK | ✓ | " "          | West "     | " Oct + Nov. 79 | " 11+12  |
| OK | ✓ | " "          | East "     | " 79?           | " 15+16  |

FAYETTE & COLORADO CO. LINE.

Wednesday 16<sup>th</sup>, May, A.D. 1877.

This day came on to be heard the petition of citizens of Fayette Co., praying for an order to have the County line between Fayette & Colorado Counties, survey\_ & marked out, as follows: Beginning at the West Bank of the Colorado River. Thence to Survey and mark out said line to the point where Lavaca Colorado & Fayette Counties joins and it appearing to the court that there exist a necessity for the location of said line. It is ordered by the Court that the County Surveyor proceed in accordance with this order and in company with the surveyor of Colorado Co., to survey and mark out said line. It is further ordered by the court that the clerk of this court furnish the County Judge of Colorado Co. with a copy of this order, asking him to make a similar order in his county so that both surveyors can act in concert.

-----oOo-----

THE STATE OF TEXAS,    §  
COUNTY OF FAYETTE.    § I, ALBERT F. MACH, Clerk of the County Court, and ex officio Clerk of the Commissioners' Court, in and for Fayette Co., Texas, do hereby certify that the above and foregoing is a true and correct copy of the Order of the Commissioners' Court, as the same appears of record, in Volume 1, upon page 141, Minutes of the Commissioners' Court, in and for Fayette County, Texas.

WITNESS MY HAND AND THE SEAL OF SAID COURT, at my office, in the city of La Grange, Texas, this the 16th. day of June, A.D. 1927.

ALBERT F. MACH,  
Clerk County Court, Fayette County, Texas,  
and ex officio Clerk of the Commissioners  
Court of Fayette County, Texas

By *R. P. Branek*, Deputy.

-----oOo-----

Surveyor's  
Report and  
Field notes  
of line be-  
tween Fay-  
ette & Col-  
orado Co-  
untys.

*West of River*

Filed the  
25th. July  
1877.

Thos.R.Mullin  
C.C.C. By  
Fr.Lidiak,  
Dept.

Report Re'cd.  
and ordered to  
be recorded in  
surveyors Book  
Aug.17/77.  
John C.Stiehl,  
C.J.F.C..

I do hereby  
certify that  
the foregoing  
is a true copy  
of the original  
recorded the  
30th. day of  
August, A.D. .  
1877.  
R.A.Doss, C.S.  
F.C.

*See later 7/12  
dated Nov. 1879  
Page 11*

THE STATE OF TEXAS, )

COUNTY OF FAYETTE. )

Whereas a\_ order was issued by the  
Hon. Comm'r. Court of Fayette County on May the 16th. A. D.1877,  
to survey and mark out the line between the county of Fayette  
and the County of Colorado to the County Surveyor of Fayette County  
to join the County surveyor of Colorado County and to act in  
concert. Therefore we the surveyors of the said two Countys  
after executing the work lawfully and according to the order  
report as follows: Field notes of a survey of the line divid-  
ing Fayette and Colorado County's made according to an Act  
passed by the Legislature on Feb.11th. 1854, fixing the corner  
of Lavaca-Colorado & Fayette County's on the Navidad at the  
N.E. of a survey for Marmadecke Standifur and the other end  
of the line ordered to be runned from the East bank of the Co-  
lorado river the upper corner of the Joseph Duty league and  
the said line is more fully described as follows, to-wit:  
Beginning at the mouth of a deep ravine on the East side of  
the Colorado river which is the upper corner of the Joseph Duty  
league and lower corner of J. Petty league, thence running S.  
39 W. crossing the river at a half mile crossing the river  
again thence at a mile crossing the river another time and to  
the west side a Cottonwood is marked F/C and a Hackberry mkd.  
Fayette Co. line. Thence through low bottom crossing a fine  
spring and to a groupe of four Live Oaks standing on a hill  
at the enterance of the prairie one is marked Fayette, one  
Colorado and one Co. line. Thence continuing the same course  
through prairie and fields to a rock mkd. F.C. about 50 vs.  
W. of Wm. Mango(s house (a.f.m.c.) Thence same course passing  
about 50 vs. West of a tenant house belonging to Ed. Adams.  
Thence to a branch in Rankins field about 350 vs. S.E. of  
Mitchells dwelling house. Thence the same course to the end  
of a cross fence N.W. of a tenant house belonging to T.H.Smith,  
Thenceto a rock mkd. F/C set on the East string of J. T. Holl-  
mans pasture fence. Thence same course passing 200 vs. N.W.of  
said Hollman's barn. Thence to a rock and post on the G. H.&  
S.A. R.R. Thence continuing same course to a Live Oak mkd.  
F/C between two tenant houses belonging to Mr. McCormick, sen.

and passing about 300 vs. S. E. of Squire Blacks dwelling.  
Thence to a **L.O.** mkd. F/C about one hundred vs. North of One  
of his tenant houses. Thence to a **L.O.** mkd. C/F Thence passing  
the Crenshaw house 200 vs. S.E. and the same course to a **L.O.**  
mkd. F/C standing in an old field. Thence passing 20 vs. E. of  
a spring E. of Mr. Basses old place. Thence a marked line  
through timber to the corner of Lavaca Colorado and Fayette  
County's on the East Navidad the N.E. corner of the Marmaduke  
Standifur survey and in the South boundary line of the Jesse  
Burnham league a big leaning Sicamore mkd. Cor. Fayette Co.,  
and a Burroak mkd. L. Co. and a Sicamore 12 inch in.d'.mkd.  
cor. Col. Co. in all 14 miles distance from the beginning.  
Surveyed July the 20th. A.D. 1877.

Rich'd. A. Doss, C.S. F.C.

A. Dunlavy, Dept. Surv. C.C.

L. F. Leeds     ) Chain  
                  )     )  
Th. Berry.       ) Carriers.

We the undersigned surveyors of Colorado and Fayette  
County's do hereby certify that the foregoing survey was made  
by us jointly and according to law and that it is fully des-  
cribed in the foregoing field notes that all the points and  
places and corners are natural and artificial and that we have  
examined the foregoing field notes and find them correct.

Rich'd. A. Doss, C.S.F.C. A. Dunlavy, Dept. Surv. C.C.

-----oOo-----

THE STATE OF TEXAS,     ) I, ALBERT F. MACH, Clerk of the County  
COUNTY OF FAYETTE.     ) Court of Fayette County, Texas, do hereby certify that the above  
and foregoing is a true and correct copy of the Report of the  
Surveyor's, as to surveying the line between the Fayette and  
Colorado County's, as the same appears of record, in Volume A.,  
upon page 233, Surveyor's Record, in and for Fayette County,  
Texas.

WITNESS MY HAND AND THE SEAL OF SAID COURT, at my office,  
in the city of La Grange, Texas, this the 16th. day of June,  
A.D. 1927.

ALBERT F. MACH,  
Clerk County Court, Fayette Co. Texas.  
By *R. P. Branch* Deputy.

-----oOo-----

FRIDAY 17", Aug. A.D. 1877.

This day came on to be heard the Report of R. A. Doss, County Surveyor of Fayette County and A. Dunlavy, Deputy of Colorado County on the line between the Counties of Fayette & Colorado on the S.W. side of the Colorado river and the same having been examined by the Court. It is ordered by the Court that the same be received and adopted and that the Surveyor R.A.Doss, spread the field notes of said line on the Surveyors Book of Fayette County.

-----oOo-----

THE STATE OF TEXAS, )  
COUNTY OF FAYETTE. ) I, ALBERT F. MACH, Clerk of the County Court of Fayette County, Texas, and Ex-Officio Clerk of the Commissioners' Court of said Fayette County, Texas, do hereby certify that the above and foregoing is a true and correct copy of the Order of the Commissioners' Court, approving the Report of the Fayette and Colorado County's surveyor, as to the County line between the said Counties, as the same appears of record, in Volume 1, upon page 180, Minutes of Commissioners' Court, in and for Fayette County, Texas.

WITNESS MY HAND AND SEAL OF SAID COURT, at my office, in the city of La Grange, Texas, this the 16th. day of June, A.D.1927.

ALBERT F. MACH,  
Clerk County Court, Fayette County, Texas, &  
Ex-Officio Clerk of the Commissioners'  
Court, Fayette County, Texas.

By *R. L. Branek*, Deputy.

-----oOo-----

This day came on to be heard the application of S. D. Delany, County Judge, Colorado Co., asking this Court to make an order in conformity with the order of the Commissioners Court of Colorado County, to have the County line between Fayette & Colorado Counties on the North side of the river run out. It is therefore ordered by the Court that the County Surveyor, R.A.Doss meet the surveyor of Colorado County, at such time as will suit their earliest convenience & survey said line and make their report to this court.

-----oOo-----

THE STATE OF TEXAS, }  
COUNTY OF FAYETTE. } I, ALBERT F. MACH, Clerk of the County Court and ex officio Clerk of the Commissioners' Court, in and for Fayette County, Texas, do hereby certify that the above and foregoing is a true and correct copy of the Order of the Commissioners' Court, ordering to have the County Line surveyed between Fayette & Colorado Counties, as the same appears of record in Volume 1, upon page 256, Minutes of the Commissioners' Court, in and for Fayette County, Texas.

WITNESS MY HAND AND THE SEAL OF SAID COURT, at my office, in the city of La Grange, Texas, this the 16th. day of June, A.D. 1927.

ALBERT F. MACH,  
Clerk County Court, Fayette County, Texas.  
and ex officio Clerk of the Comm'r. Court,  
of Fayette County, Texas.

By *R. H. Branch*, Deputy.

-----oOo-----

THE STATE OF TEXAS, }  
COUNTY OF FAYETTE. } Whereas it was ordered by the Hon-

orable Commissioner\_ Court of Colorado County during their April Term, that the true line between the County's of Colorado and Fayette shall be runned and established by H. F. Dittmar the County Surveyor of Colorado County in conjunction with the County Surveyor of Fayette County to begin on a certain place on the Colorado river and to make connection with a place on the line of Austin County and that they shall makè due report to their respective Commissioner\_ Courts of their Countys & we the undersigned County Surveyors of Colorado and Fayette Countys have therefore acted under the said order and likewise order issued of the court in Fayette County, report as follows: After an carefull\_ examination of all the County records we found nothing in regard to the line between the Countys of Fayette and Colorado, except an act passed by the Legislature of the State of Texas, Dec.14, A.D. 1837, (P\_\_\_ Digest Art. 323) fixing the North corner of Colorado County with is also the East corner of Fayette County at the S.W. corner of a league of land granted to Wm. Burnett. Thence to run S.W. wardly crossing the Colorado river where the upper line of the J.Duty corners upon the same we therefore proceeded in compliance to the said act and started at the South West corner of Wm. Burnett league with is situated in Austin County and Thence runned S. W. and as we failed to make connection with the upper corner of J. Duty league on the river we went to the place and started backwards and runned marked and established the true line between the Countys of Colorado and Fayette with runs N. 38° E. by a variation of 10° E. and is described as follows, to-wit. The upper corner of the J. Duty league on the East bank of the river is a Hackberry mkd. D. and two Hackberrys pointers mkd. H. Thence N. 38° E. passing E. of some rent houses, on Dutys league and East of Estels house, a P.O.mkd. F.C. Thence passing 75 vs. E. of J. Dutys North corner a P.O.

East of River  
May 15  
1878

See FMS  
1879?  
Page 15

mkd. F.C. Thence across the line deviding Dunlavy and Town-  
 send surveys a P.O. mkd. F.C. Thence across the LaGrange and  
 Columbus road a P.O. mkd. F.C. running West of Schobels  
 dwelling across his spring a Willow mkd. F.C. Thence S. E.  
 of Mathews Reinhardts dwelling. Thence crossing the S.W.line  
 of Ehlingers league 320 vs. S. E. of its West corner a P.O.  
 Mkd. F.C. Thence passing S.E. Zapalac dwelling also E. of  
 Mrs. M. Bekers house passing near the N.W. corner of Ehlinger  
 league a Hackberry mkd. F.C. Thence passing S.E. of Lokmanns  
 dwelling an Ash mkd. F.C. Thence crossing the line of John  
 and Alois Polantzky's farms leaving them in Fayette County, a  
 P.O. mkd. F. C. Thence passing S. E. of Schmidts place, a  
 P.O. m. his field Mkd. F.C. Thence East Kurzmans house and  
 entering the timber a P.O. mkd. F.C. crossing Fayetteville  
 and Frelsburg road 280 vs. W. of the 7 mile post a P.O. mkd.  
 F.C. Thence passing by the Cliffts place to Cummings Creek,  
 crossing the same a little b\_low the crossing of the Fay-  
 etteville and Industry road. Thence Passing N.W. Pevitz mile  
 a P.O. mkd. F.C. Thence passing S.E. of J.E. Els house a P.O.  
 mkd. F.C. thence passing N.W. of Joe Urbanofsky house a P.O.  
 mkd. F.C. Thence across the Chappel branch or Andrews creek  
 an Ash mkd. F.C. Thence S.E. of said branch and upwards  
 through open Prairies to the S.W. corner of the Burnett League,  
 in the W. line of Austin County a rock and a Hackberry Mkd.F.C.

H. F. Dittmar County Surveyor Colorado Co.

R.A.Doss, County Surveyor of Fayette Co.

Surveyed May the 15th. A.D. 1878.

Chas. Dittmar     ) Chainmen &  
                           )  
 Chris Fertsch    ) markers.

-----000-----



THE STATE OF TEXAS, }  
COUNTY OF FAYETTE. } I, ALBERT F. MACH, Clerk of the  
County Court in and for Fayette County, Texas, do hereby  
certify that the above and foregoing is a true and correct  
copy of the Report of the County Surveyors, surveying the  
line between the Fayette and Colorado County, as the same  
appears of record, in Volume "A", upon page 235, Surveyors'  
record, in and for Fayette County, Texas.

WITNESS MY HAND AND THE SEAL OF SAID COURT, at my  
office, in the city of La Grange, Texas, this the 16th. day  
of June, A.D. 1927.

ALBERT F. MACH,  
Clerk County Court, Fayette County, Texas.  
By *W. H. Frank*, Deputy.

-----000-----

It is ordered by the Court that the report of the County Surveyor of Fayette County, in regard to the line between Fayette and Colorado Counties on the East side of the river be and the same is hereby received & approved, and that the surveyor be instructed to record the same in the surveyors Book.

---oOo---

THE STATE OF TEXAS,    |  
COUNTY OF FAYETTE.    | I, ALBERT F. MACH, Clerk of the  
County Court and ex officio Clerk of the Commissioners'  
Court, in and for Fayette County, Texas, do hereby certify  
that the above and foregoing is a true and correct copy of  
the order of the Commissioners' Court, approving the report  
of the County Surveyor of Fayette County, in regards to the  
line between Fayette and Colorado Counties, on the E. side,  
of the river, as the same appears of record, in Volume 1,  
upon page 267, Minutes of the Commissioners' Court, in and  
for Fayette County, Texas.

WITNESS MY HAND AND SEAL OF SAID COURT, at my office,  
in the city of La Grange, Texas, this the 16th. day of June,  
A.D. 1927.

ALBERT F. MACH,  
Clerk County Court, Fayette Co., Texas.,  
& Ex Officio Clerk of the Commissioners,  
Court, Fayette County, Texas.

By *R. L. Branek*, Deputy.

---oOo---

Wednesday, 13<sup>th</sup>, Aug., A.D. 1879.

This day came on to be heard the copy of the order of the Commissioners Court of Colorado County in regard to having the County line between Fayette & Colorado Counties. It is therefore ordered by the Court that the County Surveyor of Fayette County be and he is hereby instructed to proceed in Company with the County Surveyor of Colorado County to survey and mark out the County line between Fayette & Colorado Counties according to the Act of the 16<sup>th</sup> Legislature, Chapter 129, pages 137 & 138.

-----oOo-----

THE STATE OF TEXAS,    §  
COUNTY OF FAYETTE.    § I, ALBERT F. MACH, Clerk of the County Court and ex officio Clerk of the Commissioners' Court, in and for Fayette County, do hereby certify that the above and foregoing is a true and correct copy of the Order of the Commissioners' Court, ordering the Fayette County Surveyor and the Colorado County Surveyor, to survey the line between the Colorado County and Fayette County, etc., as the same appears of record, in Volume 1, upon page 410, Minutes of the Commissioners' Court, in and for Fayette County, Texas.

WITNESS MY HAND AND THE SEAL OF SAID COURT, at my office, in the city of La Grange, Texas, this the 16<sup>th</sup>. day of June, A.D. 1927.

ALBERT F. MACH,  
Clerk County Court, Fayette County, Texas.

By P. L. Branch, Deputy.

-----oOo-----

THE STATE OF TEXAS, )

COUNTY OF FAYETTE. ) REPORT of a survey of the line between  
Fayette and Colorado Counties as ordered by the Commissioner  
Courts of the said two Counties in accordance with an Act  
passed by the 16th. Legislature April 22, 1879, entitled an  
Act establishing and prescribing the manner of ascertaining  
the boundaries of counties (General Laws of 79, page 137)  
The said line is described in Article 777 on page 129, which  
reads as follows from the South West corner of a league of  
land granted to Wm. Burnett to the upper corner of the  
Joseph Duty's league on the East side of the Colorado river  
and continuing in the direction of the upper corner of a  
league of land for Wm. Ponton on Lavaca river to the Lavaca  
County line. The part of the line on the West side of the  
river after running a trial line from the upper corner of J.  
Duty league or Colorado river, which is a distance of 46,679  
vs. or 24-1/2 miles to ascertain the course of the true line  
which turned out to be S. 41° 40' W. Thence set a post on  
E. bank of said river for upper corner of J. Duty's league,  
said Post is like the balance, 5 feet long 8 inches square  
of Cypress timber three feet in the ground with the initials  
of the County's on the respective sides and 1879 on the  
S.W. side and B. for beginning on N.E. side. Thence at 164  
vs. across the river at 684 vs to the river again and 819  
to other side of the river at 1799 vs to the river again  
putting the first mile post in the river which was at that  
place 164 vs wide after 1000 vs. living bottom second mile  
post set in Taylor pasture which is mkd. C on Colorado side  
and F..on Fayette side and II on side towards the river and  
1879 on side towards Navidad. Thence 1900 vs. to third mile  
post on hill in W. Mangos field mkd. III and the initials of  
the County's Thence 157 vs. crossing line running N. and S.  
at 1900 vs. set the 4th. mile post about 120 vs. North of  
Wm. Bufferds dwelling house. Thence passing N.W. of Mitchels  
house 1900 vs. set the 5th. mile post some 300 vs. W. of

West of River  
Nov. 1879

Mitchels dwelling. Thence passing 170 vs. N.W. of Sanders dwelling 1540 vs. crossing La Grange and Weimar road 1900 vs. set the 6th. mile post. Thence 1900 vs. set the 7 mile post in John Holmans pasture. Thence at 620 vs. pass the West line of H. Austin 5 leagues 1900 vs. set 8 mile post on N. side of DeGraffenrieds branch. Thence 759 vs. crossing Murchisons East line 33 vs. S. of the S.W. corner of a survey of 211 acres for the heirs of Elizabeth Windle and East line of J.A.Sergeant league and passing 15 vs. N. W. of Woods dwelling at 1697 vs. crossing the tract of the G.H. and S.A.R.R. a little West of the curve West of Weimar at 1900 vs. the 9 mile post. Thence at 560 vs. passing the South corner of Thom Chandlers dwelling and about 150 vs. South of the old Chandler place at 1900 vs. set the 10 mile post on the Weimar and Schulenburg road also on the North line of the J.G.O.Ferrell league and 44 vs. N. 80° E. from the N.E. corner of Wm. Blaks 100 acres survey. Thence 1900 vs. set the 11 mile post N.E. of the old Peerce place now Allens place. Thence 600 vs. passing a little South of Allens S.W. corner 917 vs. passing Kozureks S. cor. in a ravine 1900 vs. set the 12 mile post on South side of a branch running about West in to East Navidad. Thence 1900 vs set a 13 mile post inside of Cranchos or now McNellys field about 200 vs. S.E. of Navidad bottom. Thence through Thom Bassfield to 14 mile post in Navidad bottom 100 vs. N.E. of the Channel. Thence 100 vs. to the South line of the Burnham league, which is the North boundary line of Lavaca County set likewise post.

Surveyed from the 13th. day of October to the first of November, A.D. 1879.

By B. F. Toliver, C.S.C.C. and R.A.Doss, C.S.F.C.

-----oOo-----

THE STATE OF TEXAS,    §  
COUNTY OF FAYETTE.    § I, ALBERT F. MACH, Clerk of the  
County Court, in and for Fayette County, Texas, do hereby  
certify that the above and foregoing is a true and correct  
copy of the Report of the Fayette County and Colorado Co.,  
Surveyors, as to the County Line between Fayette County and  
Colorado County, as the same appears of record, in Volume 1,  
upon page 236,<sup>237</sup> Surveyor's Record, in and for Fayette Co.,  
Texas.

WITNESS MY HAND AND THE SEAL OF SAID COURT, at my  
office, in the city of La Grange, Texas, this the 16th. day  
of June, A.D. 1927.

ALBERT F. MACH,  
Clerk County Court, Fayette County, Texas.  
By *R. P. L. Brant*, Deputy.

-----oOo-----

This day came on to be heard the report of R. A. Doss, County Surveyor on the line between the Counties of Fayette & Colorado, and the same having been excepted by the Court, and found correct. It is ordered that the same be approved that further ordered that the said Doss record said report in the surveyor's book of Fayette County, with plat of same.

-----oOo-----

THE STATE OF TEXAS,    ) )  
COUNTY OF FAYETTE.    ) I, ALBERT F. MACH, Clerk of the Co.  
Court and ex officio Clerk of the Commissioners' Court, in  
and for Fayette County, Texas, do hereby certify that the above  
and foregoing is a true and correct copy of the ORDER OF THE  
COMMISSIONERS' COURT, approving the Report of the Surveyor ,  
as appears on the record, in Vol. 1, page 445, Minutes of the  
Commissioners' Court, in and for Fayette County, Texas.

WITNESS MY HAND AND THE SEAL OF SAID COURT, at my  
office, in the city of La Grange, Texas, this the 16th. day  
of June, A.D. 1927.

ALBERT F. MACH,  
Clerk County Court, and Ex Officio Clerk,  
~~Fayette County, Texas~~  
of the Commissioners' Court, in and for  
Fayette County, Texas.

By *R. P. Drank*, Deputy.

-----oOo-----

The State of Texas,    |  
County of Fayette.    | Field notes of the County line  
between the Counties of Fayette and Colorado lying on the  
East side of the Colorado river.  
Beginning at the upper corner of the Joseph Duty League a  
Clump of Buckeyes, one of which is marked F. on the East  
side standing on the bank of said river for corner the  
original bearings are gone. Thence N. 38° E. passing through  
the Residence of Wm. Hoelscher at 1900 vs. or 1 mile set a  
Post of Cypress 8 inches in diameter 3 feet in the ground and  
2 feet out the said post being marked <sup>I</sup>M on one side C. on  
one, F. on one & 1879 on the other. Thence N. 38° E. at 1900  
vs. or 1 mile further set another Cypress post 8 inches in  
diameter set 3 feet in the ground 2 ft. out of the ground  
mkd. <sup>II</sup>M on one side C on one side F. on one and 1879 on the  
other. Thence N. 38 E. at 200 vs. vs. passed the N. E. corner  
of the John Petty League 70 vs. distant at 500 vs. further  
pass the North boundary line of the Joseph Duty league 75  
vs. East of the N.W. corner of said Duty League at 1200 vs.  
further or 1900 vs. in all set another post of Cypress marked  
<sup>III</sup>M on one side, C on one F. on one and 1879 on the other.  
Thence N. 38° E. passing through on said course Schobels corn  
Cribb and further on passing to the West of the Rheinhardt  
house leaving said house in Colorado County 1900 vs. or 1  
mile to a Cypress post set on the East boundary line of  
Joseph Ehlinger league in a lane said Post Mkd. <sup>IV</sup>M on one side  
C. on one side F. on one and 1879 on the other. Thence N.  
38° E. at 1900 vs. or 1 mile set a Post marked <sup>V</sup>M on one side,  
C on one, F. on one and 1879 on the other near the residence  
of Engbrook in Fayette County. Thence N. 38° E. at 1900 vs.  
or one mile set a Post East of Kreneks Steam gin and mile  
in Fayette County, said post is marked <sup>VI</sup>M on one side, C. on  
one, F. on one and 1879 on the other. Thence N. 38° E. passing  
through Smiths farm near a Cabin at 1900 vs or one mile at  
a post leaving Roohmann in Colorado Co. said post is set

East River

1879?



about 100 vs. North of said Roohmans house, said post marked VIII  
M. on one side C. on one side F. on one, and 1879 on the other. Thence N. 38° E. through timber passing a Public road on said line at 1900 vs. or one mile set a Post on a Rocky Hill in Post Oaks said Post marked IX, and on one side C., on one F. on one and 1879 on the other. Thence N. 38° E. passing the Rypel farm leaving said farm in Colorado 1900 vs. or one side to a stake, or post set near a Ravine said post mkd. X on one side, C. on one, F. on one and 1879, on the other. Thence N. 38° E. through bottom and crossing Cummings creek just where the Fayetteville and Industry road crosses said creek mkd. 2 trees on the West bank of said Creek, one mkd. C. and the other mkd. F. at 1900 vs. set a Post mkd. XI on one side C. on one F. on one and 1879 on the other said post stands in the old farm of Dr. Smiths now owned by Collector J.R.Scates. Thence N. 38° E. passing through farms at 1900 vs. or one mile set a Post in Pevitz farm near a Cabin in Fayette County said post marked XII on one side, C. on one, F. on one and 1879 on the other. Thence N. 38° E. passing through farms at 1900 vs. or one mile set a Post in Thomsons farm at 1900 vs. or one mile set a Post in Thomsons farm, said Post mkd. XIII on one side C. on one, F. on one and 1879 on the other. Thence N. 38° E. at 156 vs. set a Cypress post for the corner of Fayette and Colorado Counties on the Austin Co. line said Post is marked F. cor. on one side C. cor. on one side, and A. on one and 1880 on the other, run'd. at a variation of 10° East.

Respectfully submitted to the Honorable Comm'r. Court of Fayette and Colorado Counties.

Signed: B. F. Toliver, C.S. C.C.

R. A. Doss, C. S. F. C.

-----oOo-----

THE STATE OF TEXAS,    §  
COUNTY OF FAYETTE.    § I, ALBERT F. MACH, Clerk County Court,  
in and for Fayette County, Texas, do hereby certify that the  
above and foregoing is a true and correct copy of the Report  
of Fayette County and Colorado County Surveyors, as to the  
line between the Fayette and Colorado County, as the same  
appears of record, in Volume A., upon page 239, Surveyor's  
Record, in and for Fayette County, Texas.

WITNESS MY HAND AND THE SEAL OF SAID COURT, at my  
office, in the city of La Grange, Texas, this the 16th. day  
of June, A.D. 1927.

ALBERT F. MACH,  
Clerk County Court, Fayette County, Texas.

By *P. D. Drane*, Deputy.

-----oOo-----

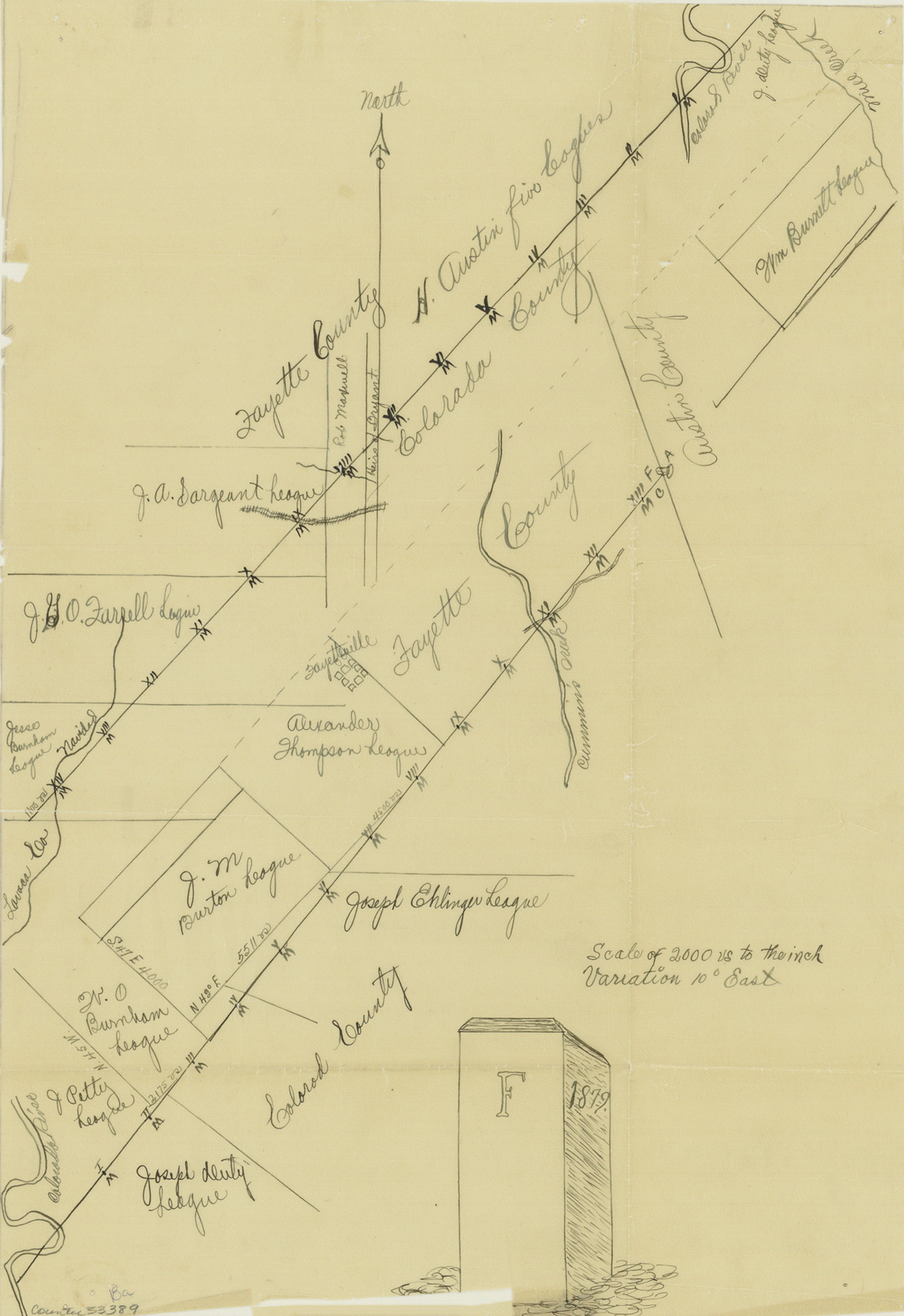

Fayette Co. Bdry. (5)  
County line

Fayette and

Colorado Cos-

---

Filed June 28<sup>th</sup> 1927

J. T. Robison - Cour.  
Clerk

Duties - 160 cc in Fayette

Charges 243 . . . 4

M. D. D. D.