

variation 8° E.

Scale of Plat 2000 us per inch



63

Map of Plover 0000 0000 0000

St. Andrews

Franklin Co. Bathy Line 2  
7  
Counter 53514

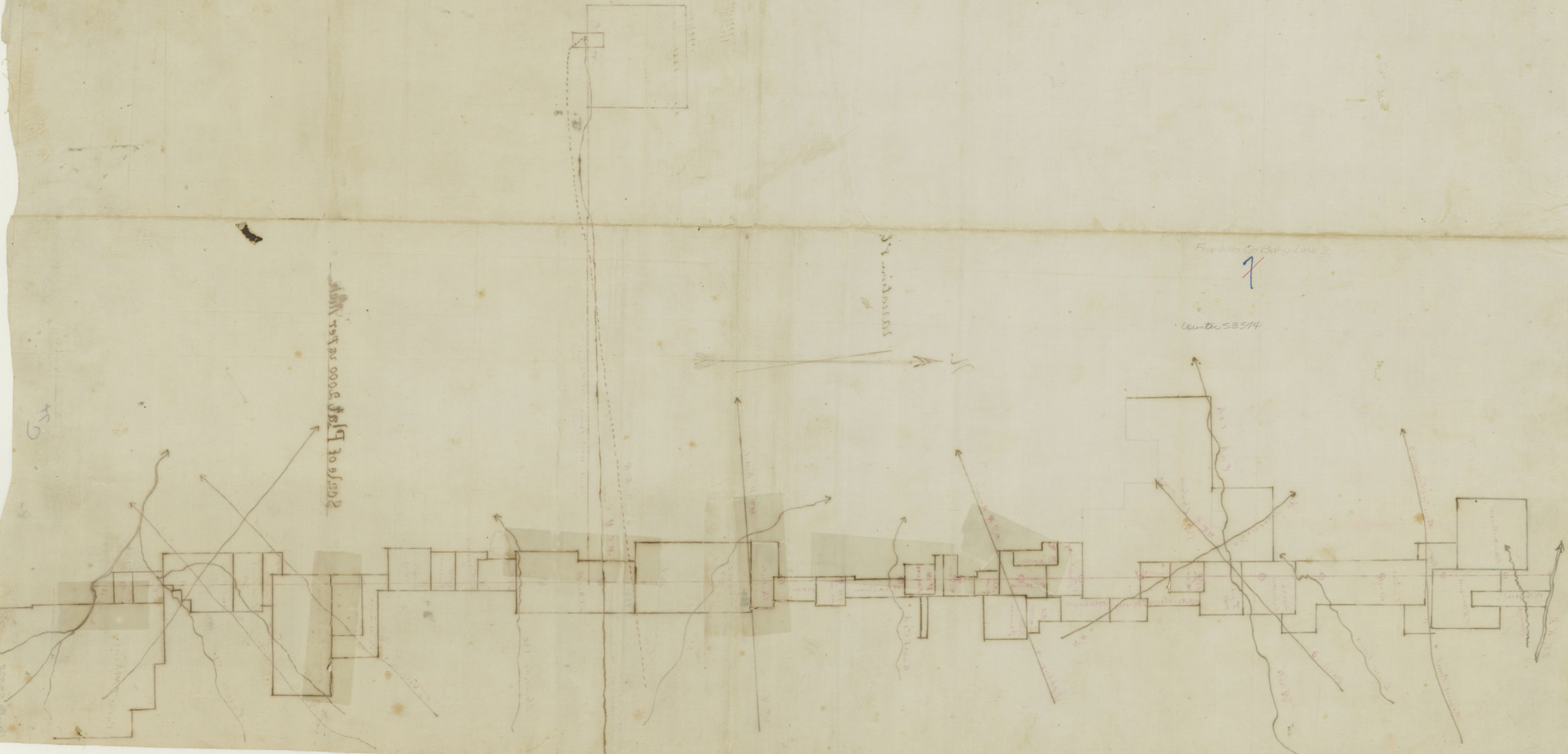



State of Texas  
 County of Franklin Field notes of a survey of  
 the boundary line between the  
 Counties of Franklin and Titus made by  
 virtue of an order of the County Court  
 of Franklin County as surveyed by  
 G. E. Bowman and J. P. Mitchell Surveyors  
 appointed by the County Court of Franklin  
 County and J. S. Riddle Surveyor appointed  
 by the County Court of Titus County  
 to begin said survey on the 18<sup>th</sup> day of  
 Jan'y. 1898.

Beginning at a point 9 miles West  
 of the town of Mt. Pleasant in the County  
 of Titus on the road leading from the  
 town of Mt. Pleasant to the town of  
 Sulphur Springs in the County of Hopkins  
 a Baisden's Post planted at said  
 point marked T.C. + F.C.

North end  
 of line

Thence north at  $91^{\circ} 7 \frac{1}{2}'$  vs the  
 N. W. line of the Jos. P. Riddle survey and  
 the S. B. line of the Jos. Reed survey  $987$  vs.  
 East from Riddle's N. W. and Reed's S. W.  
 corner at  $1900^{\circ} 10'$  vs. set the 1 mile Post  
 from which a Hickory has  $776^{\circ} 7 \frac{1}{2}'$  E  $11^{\circ} 10'$  vs.  
 a Black Jack has  $755^{\circ} 7 \frac{1}{2}'$  vs. at  $3560$  vs. Pipleys  
 Creek C. E. at  $3801^{\circ} 10'$  vs. set 2 mile Post in  
 field at  $4705$  vs. Jos. Reed's N. B. and a  
 Roberts' S. B. line  $869$  vs. East from a Roberts'  
 S. W. corner here crosses the Mt. Pleasant  
 and Mt. Vernon public road at  $5462$  vs.

Franklin Co. Bdry. Line 2

Franklin Co. Bdry. Line #2



1 Robert's NB. and J P Atkins's SB line 585 vs.  
 2 East from said Atkins's SE corner  
 3 at 5702<sup>4</sup>/<sub>10</sub> vs. Set the 3 mile post at  
 4 6806 vs J P Atkins NB and A K Rainier's SB.  
 5 Line 140 vs. West from Rainier's SE corner  
 6 at 7603<sup>7</sup>/<sub>10</sub> vs. Set 4 mile post at 7756 vs.  
 7 said Rainier's NB. & M Christian's SB. line  
 8 540 vs. East from Christian's SE corner at  
 9 7763 vs. Macy's Creek 8 vs. wide @ East at  
 10 9504 vs. Set the 5 mile post in a field at  
 11 9634 vs. Christian's NB and J M Sharer's SB.  
 12 Line 490 vs. East from Sharer's SE corner at  
 13 10584 vs. Sharer's NB and G K Herring's SB.  
 14 Line 773 vs. West from Herring's SE corner  
 15 at 10820 vs. Herring's NB. and R D Fay's  
 16 SB line 540 vs East from Fay's SE corner  
 17 at 11004<sup>8</sup>/<sub>10</sub> vs Set 6 mile post from which  
 18 a Hickory has. 744<sup>1</sup>/<sub>16</sub> vs. another has  
 19 88<sup>1</sup>/<sub>2</sub> E 3 vs. at 11820 vs. Fay's NB and S M  
 20 ~~Reese's~~ Reese's SB line 90 vs West from Fay's NE. The same  
 21 being Reese's SE corner at 12000 vs. prairie  
 22 at 12564 Reese's NB. and G L Hood's SB  
 23 Line 387 vs East from Hood's SE corner  
 24 902 vs West from his SE corner (Hood's SB line  
 25 measuring 1324 vs. instead of 854 vs.) at  
 26 12820 vs. The M A Pleasant and Daphne road  
 27 at 13305<sup>6</sup>/<sub>10</sub> The 7 mile post on prairie  
 28 at 14139 vs G L Hood's NB. and M Deubrist's  
 29 SB line 588 vs. East from M Deubrist's SE  
 30 corner and 422 vs West from his SE corner  
 31 at 15206<sup>4</sup>/<sub>10</sub> vs set 8 mile post at 15276 vs  
 32 Deubrist's NB and Jas. Chatham's SB line

Franklin Co. Bldg. List #2



1 675 vs. East from Chatham's S E corner at  
 2 17070 vs Chatham's NB. and H S Armstrong's  
 3 S B line 675 vs East from Armstrong's S E  
 4 corner at 17107 <sup>7</sup>/<sub>10</sub> vs. set 9 mile East 17207  
 5 vs timber at 17997 vs. the Gray Rock and  
 6 Clarksville road and Armstrong's NB.  
 7 and the B B B + C R R Co. S B line 491 vs. West  
 8 from the S E corner of said R R survey at  
 9 19008 vs. set the 10 mile East in a field  
 10 at 19060 vs. the B B B. + C R R Co. NB and  
 11 the Shas. Hills S B line 491 vs. West from Shas  
 12 Hills S E corner at 20008 vs White Oak Creek 20  
 13 vs Hide C. East at 20768 vs. the M Plesner and  
 14 Paris road at 20798 vs. said Hills NB. and  
 15 Joseph Salmon's S B line 491 vs. West from  
 16 Salmon's S E corner at 20908 <sup>8</sup>/<sub>10</sub> vs. set the 11  
 17 mile East in Grassy Lake at 22000 Salmon's  
 18 NB and Orlando James' S B line at 22070 vs  
 19 Lewis' Creek 12 vs. wide C. East at 22100 vs  
 20 same Creek at 22160 vs same Creek at 22809 <sup>6</sup>/<sub>10</sub>  
 21 set the 12 mile East from which a Past Oak  
 22 East 6 vs. another S. N. 76° N. 7 vs. at 23669 vs  
 23 the Gray Rock and Clarksville road 24360  
 24 vs sulphur prairie at 24710 <sup>4</sup>/<sub>10</sub> set 13  
 25 mile East at 26060 James NB. Charlton  
 26 Paynes S B line 516 West from James N E  
 27 corner 26190 vs. the Gouldborough and Hagans-  
 28 port road 26250 Paynes NB. and J E Hopkins'  
 29 S B line 190 vs. West from Hopkins' S E  
 30 corner at 26611 <sup>7</sup>/<sub>10</sub> vs. set the 14 mile East  
 31 at 27430 vs timber at 28331 vs. Hopkins'  
 32 NB. and W<sup>m</sup> Walker's S B line 550 East

Franklin Co. Bldg. Unit #2



1 from Walker's S<sup>th</sup> Corner at 28512 vs set the  
2 15 mile Post in Sulphur Bottom at 28972  
3 vs Big Slough C. East 10 vs wide at 29952 vs  
4 the Sulphur Fork of Red River a Boisdarc  
5 Post on the South Bank of the same from  
6 which a large Sycamore bro. S. 65° E. 4 vs. 3/4 mi. @  
7 NWC TC and a large Sweet Gum bro. S. 61 1/2 N  
8 27 vs. NEFC.

South

9 Line South from the beginning -  
10 Boisdarc Post heretofore mentioned as  
11 the beginning -  
12 Thence South at 1908 8/10 vs  
13 Set 1 mile Post in J B Bickerstaff's field  
14 at 2670 Rhinoceros Creek 10 vs wide C-  
15 50° E at 2870 vs Joseph P Riadles S B and  
16 J B Stewart's N B line 290 vs. East from  
17 Stewart's N<sup>th</sup> corner at 3801 6/10 vs. Set the  
18 2 mile Post from which a Post can  
19 bro. S. 15° N 15 vs. another bro. S. 63° E. 14 1/2 vs.  
20 at 3976 vs. Stewart's S B. and J B Fitzgerald's  
21 N B line 290 vs East from Fitzgerald's N<sup>th</sup>.  
22 corner at 4656 vs Fitzgerald's S B and  
23 C J H Dodson's N B line 290 vs. East from  
24 Dodson's N<sup>th</sup> corner at 4689 vs. the Mt.  
25 Pleasant and Hopewell road at 5413 vs.  
26 Dodson's S B. and Jonathan Piigs N B.  
27 line 290 vs East from Piigs N<sup>th</sup> corner  
28 5702 4/10 vs. Set the 3 mile Post from  
29 which a Sweet Gum bro. S. 77 E. 4 vs. another  
30 bro. S. 19° N 1/2 vs. at 6758 vs. Piigs S B. and  
31 Jas Lawe's N B line of north 160 acre  
32 survey 273 vs. West from Lawe's NE corner

Franklin Co. Boling. line # 2



at 7522 vs. The Monticello and macon  
 road at 7592 The line dividing the two  
 Lowe surveys 223 vs. West from the NE corner  
 of the South 160 acre survey at 7603  $\frac{7}{10}$  vs  
 set the 4 mile Post in a field at 8543 vs  
 James's SB. and Samuel Buckhannan's NB.  
 line 223 West from Buckhannan's NE  
 corner at 9404 vs the Mt Vernon and  
 Pittsburg road at 9504 set the 5 mile  
 Post in a field at 10444 vs Buckhannan's  
 SB & Wm Sicut Blain's NB. line 687 vs. East  
 from Sicut Blain's NW corner at 10857 vs.  
 Sicut Blain's SB and Belia Coats' NB line  
 687 vs. East from her NW corner at 11404  $\frac{9}{10}$   
 set the 6 mile Post in field at 11584 vs.  
 Audy's Cood 8 vs. wide C. 528 E. at 11802 vs  
 Coats' SB. and Coats' NB. line 687 vs  
 East from Coats' NW corner at 12624 vs  
 The Mt Vernon and Leesburg road at  
 12904 vs. The Mt Pleasant and Kingsboro road  
 at 13305  $\frac{4}{10}$  vs. set the 7 mile Post at the  
 edge of cypress bottom from which a  
 White Oak has S. 10° E. 10 vs. an ash has S. 79° W 10  
 vs at 13398 vs. Coats' SB line 23 vs. West from  
 his Ell corner at 13595 vs cypress creek  
 15 vs wide C. E. 13775 vs. same creek C.  
 West at 13975 same creek C. East 14078  
 vs has Edgar's NB. line 328 East from  
 his NW corner at 15028 vs Edgar's SB. and  
 J M Stovalls NB line 328 vs. East from  
 Stovalls' NW corner at 15206  $\frac{4}{10}$  vs. set the  
 8 mile Post at 15649 vs. Stovalls' SB. line

Franklin Co. Bday. line #2



at 16126  $\frac{4}{10}$  vs South on Dry Fork of Cypress  
a Boisdare Pass on the North Bank from  
which a Survey Run S. 78  $^{\circ}$  E. 14 vs N. 11  $^{\circ}$  W.  
T.C.S.W.C. a Hickory S. 79  $\frac{1}{2}$   $^{\circ}$  W. 30 vs. marked  
FCSE/C -

Mile Posts marked T.C. & F.C. and  
numbered from the beginning to  
the North consecutively and from the  
beginning to the South the same -

The survey began on the 18<sup>th</sup> day of  
January 1898.

G.E. Cowan  
Surveyor  
J.H. Riddle  
Surveyor  
H.A. Kyle  
and E.G. Stephenson & Chain carriers

State of Texas  
County of Franklin  
G.E. Cowan  
and J.H. Riddle

Surveyors appointed to survey the above  
designated line hereby certify that we have  
actually made the survey on the  
ground according to law and  
that the foregoing plot and field notes  
with statement of surveys crossed by  
said line hereto attached and Exhibit  
"A" are correct and that we have  
given an accurate description of  
all prominent natural objects  
crossed by or adjacent to said line  
as well as of the corners and lines  
on or near the line, and we hereby

Franklin Co. Bdry. Unit #2



1 further certify that in order to locate  
2 the beginning point of said line was  
3 accurately measured 9 miles West  
4 from the center of the Court House in  
5 the town of Mt. Pleasant in Titus County  
6 said center being on the S 1/2 line of the  
7 Berry Merchants survey abstract no.  
8 358. 104 1/2 vs West from the S E corner of  
9 said survey -

10 Witness our hands, this 8<sup>th</sup>  
11 day of March, 1898.

12 G E Coward,  
13 Surveyor  
14 J G Riddle  
15 Surveyor



# "Exhibit A"

1	Surveys Crossed by said line -				
2	Name	Abs.	no acres in survey	no acres in Franklin Co	no acres in Litus Co.
3					
4	Jos Reed	462	1043 <sup>78</sup> / <sub>100</sub>	830	573 <sup>78</sup> / <sub>100</sub>
5	A Roberts	479	370	116	204
6	J R Aikid	5	160	139	21
7	A H Lammie	279	160	136	24
8	M Christian	124	206 <sup>6</sup> / <sub>10</sub>	179 <sup>4</sup> / <sub>10</sub>	27 <sup>7</sup> / <sub>10</sub>
9	F M Shaver	536	160	82	78
10	G W Keating	242	160	129	33
11	W D Fay	2 <sup>14</sup> or 2 <sup>15</sup>	160	95	65
12	B M Reese	415	160	135	25
13	* C L Hoard	6 <sup>16</sup> or 6 <sup>17</sup>	160	125	165
14	N Dembiski	160	209 <sup>8</sup> / <sub>10</sub>	111	139
15	Thos. Chatham	105	3746	200	3546
16	W S Armstrong	8	213	210	3
17	B B B. & C R Co.	70	200	108	92
18	Thos Hill	293	320	212	108
19	Jos Salmon	505	502 <sup>1</sup> / <sub>2</sub>	350 <sup>1</sup> / <sub>2</sub>	148
20	Orlando James	315	1280	909	371
21	Charter Payne	371	320	169	151
22	J E Hopkins	218	540	470	70
23	W <sup>m</sup> Haeker	591	1292	146	1146
24	Jas P Riddle	463	1212 <sup>1</sup> / <sub>2</sub>	686 <sup>1</sup> / <sub>2</sub>	526
25	J B Stewart	501	206	56	150
26	J B Fitzgerald	221	160	36	124
27	C H P Dodson	184	160	39	121
28	Jonathan Ping	451	320	69	251
29	Jas Lowe	343	160	128	32
30	" "	357	160	123	37
31	Jas Buchanan	22	1280	1205	75
32	W. L. Sisk Blair	526	160	50	110

The C L Hoard's and N Dembiski's both have a very large gain

\*  
C7  
County 53582

Franklin Co. Deeds, Line #2



Name	Abs	710 acres in survey	710 acres in Franklin Co	710 acres in Titus Co.
belia boots	114 or 115	320	115	205
Q boots	119	640	197	443
Thas Egan	199	160	55	105
J M Stovace	328	106 1/2	36	70 1/2

The State of Texas  
 County of Franklin  
 I, J. Patton Clerk of the County  
 do hereby certify that  
 the foregoing survey &c (field notes of) dated  
 March 8<sup>th</sup> 1898, was filed in my office  
 March 9<sup>th</sup> 1898, and duly recorded  
 May 31<sup>st</sup> A.D. 1898 in the minutes of  
 Commissioners Court, in Vol. C on  
 pages 190-1-2-3-4

Witness my hand and seal of office  
 this 31<sup>st</sup> day of May A.D. 1898  
 {L.S.} J. Patton Clerk County  
 Court Franklin Co. Texas  
 By B.E. Morris Deputy

The State of Texas  
 County of Franklin  
 I, J. Patton Clerk of the County  
 Court of Franklin Co. Texas, do  
 hereby certify that the foregoing is a true and  
 correct copy of the original. "Field notes of survey  
 of line between Titus & Franklin Counties as  
 surveyed by G.E. Cowan & J.B. Riddle. now  
 on file in my office.

Given under my hand & seal of said  
 Court, at office in Mt Vernon this June 1<sup>st</sup> 1898  
 J. Patton Clerk  
 By B.E. Morris Deputy

Franklin Co. Bdry. Line #2



Franklin Co ~~7~~ Bdry Line 2

Boundary Line  
between Titus + Franklin  
Surveyed March 1898

Filed in Deed Land Office  
April 1<sup>st</sup> 1899

Examined and Approved  
April 7<sup>th</sup> 1899  
J. C. Wise

See Franklin + Titus

Line Platted on Titus Co  
map of Oct 1908 according  
to F/m herein.

9  
County 53584

11