

B

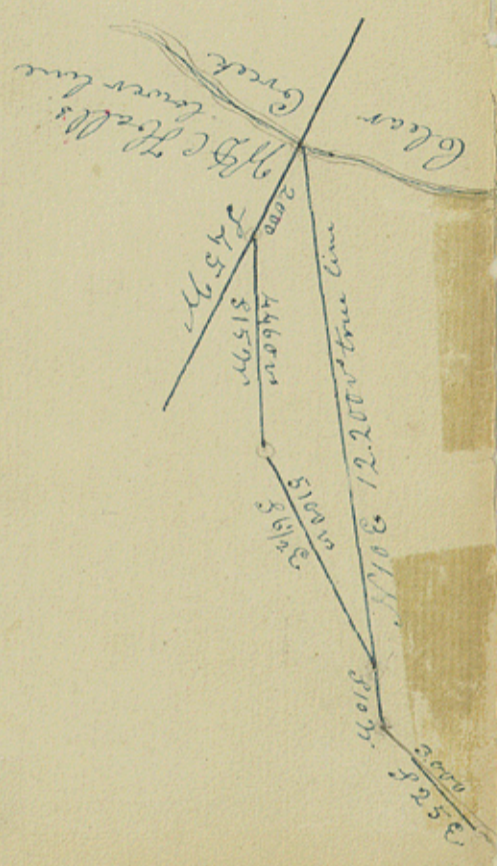

B



Galveston Bdry line ①
File 22

Galveston District

Plot and field notes
of the western boundary line of
Galveston County as run by
Saml P. Brown, Deputy Surveyor,
in pursuance of an order of Court
of Galveston Co. dated Jan. 18.
run Feb. 20. 1848.

B

Galv

No 32

(2)

Galveston District

See old wrapper inside.

To notes of Co. B. B.

Brazoria & Galveston
Co. Boundary Line

Counter 53660



52

2

File 3.
Galveston Dis.

Halls Bayou.
Received June 19. 1848.
Plotted on map. June 21. 48.

Galveston & Brazo-
ria Co.

Plotted.

Galveston Co. Tex.



File 32
7th
counter 53662

In obedience to an order of the County Court of Galveston County dated Jan^y 1848. I have surveyed & run of the line between this County of Galveston & the County of Brazoria at the time specified in the order of Survey as follows
 Beginning at W & C Halls lower line where the same crosses Clear Creek Thence on Random line S 45° W at 2000 vrs crossed a branch & altered course to S 15° W at 4460 vrs & altered course to S 6 1/2° E at 5100 vrs (to a branch of 3 Cotton Wood trees about 18 m dia each & connected at the bottom) altered course to S 10° W at 12700 vrs the head of Dickinsons Creek. Thence on a direct line to the place of beginning N 10° E 12.200 vrs

From the head of Dickenson on Random line S 25° E 3000 vrs altered course to S 26° E 10.000 vrs altered course to S 30° E 12.200 vrs (from this point run a line to the lower corner of Brighams or League N° 3 on the East side of Halls bayou S 65° W 2431 vrs) altered course to S 42° E 4750 vrs altered course to S 28 1/2° E 3340 vrs altered course to S 8 1/2° E 4260 vrs altered course to N 66 1/2° E 255 vrs the back or North corner of Lot N° 15 Surveyed for James O Flaherty & thence S 52° E 3170 vrs to the corner on the Bay between Surveys N° 14 & 15 made for James O Flaherty. Thence with the meanders of the bay westward as follow. S 47° W 1500 vrs S 47 1/2° W 500 vrs N 27° E 1060 vrs N 37° W 940 vrs N 13° W 500 vrs N 72 1/2° W 1480 vrs N 30° W 1680 vrs N 66 1/2° W 2875 vrs N 35 1/2° W 2100 vrs N 43 1/2° W 1320 vrs S 45° W 500 vrs S 2° W 230 vrs S 40° W 460 vrs the mouth of Chocolate bayou altogether 20.574 vrs

The meanders of the bay Eastward from the same point that is from the corner between 14 & 15 N 53 1/2° E 2160 vrs N 64° E 1040 vrs N 14 1/2° E 1040 vrs N 41° E 3000 vrs N 67° E 1125 vrs N 34° E 3720 vrs N 48° E 2580 vrs N 37° E 2400 vrs N 21° E 1960 vrs the mouth of Highland bayou altogether 19.025 vrs

From the corner between Surveys 14 & 15 S 68 1/2° W 476 vrs the points equally distant from Chocolate & Highland bayous Thence on true line N 28° W 39.700 vrs the place of beginning at head of Dickenson. Feb^y 20th 1848

John Harvey Chain
 W^m Biggs men

Sam^l P Brown Dep^t District
 Surveyor for Galveston C^t

Connecting lines

From the North West or back corner of League N^o 6 on Highland Bayou & Galveston Bay known as Virginia point League. West 4171.0^{rs}
Thence South 1005.0^{rs} to the corner of J. Spilmans League N^o 1 on the South side of Highland Bayou.

From the North West or back corner of League N^o 6 the above named corner North 2215.0^{rs} the Southern line of one third League surveyed for John S. Sydnor. Thence West to the S. W. Corner made for P. Sydnor: 920.0^{rs}

no 37
Galveston-Brazoria
County line

Red June 19 1848
Plattsmouth map
July 21 1848

Counter 53665

12