

In County Commissioners Court of Gillespie
County, Next Term, 1889.

To the Honorable County Commissioners
Court of Gillespie County.

In obedience to the order of Court
given at the February Term 1889 by which I
was appointed to represent Gillespie County
in running and establishing the County-
line, between Kerr and Gillespie Counties - have
the honor to report that I have proceeded in
said matter, have met J. H. Davis the sur-
veyor of Kerr County, and that we together, as-
sisted by George Sawley, Hears Boecking, H.
DeShert, and Chas Rausch did commence the
work at the appointed time. - Beginning
at a point S. 17° W. 18000 varas from where
the old Texas and Travis Dist. line crosses
the Pedernales river, said point being the
S. E. corner of Gillespie County, as recently es-
tablished. Thence running west we ascer-
tained, that there is an old marked line
in existence, same being considerably South
of where the Southline of Gillespie County, pro-
perly should have been marked. After ar-
riving at the San Antonio and Fredericks-
burg road, or at a distance of 24570 varas
west from the S. E. corner of Gillespie Co. we
ran South several hundred varas, to the
old line above mentioned; thence running
west we retraced the same, for a distance
of 4000 or 5000 varas, after that the course
of the old line changes to the right, at a
distance of 11396 varas west from the San
Antonio road, at a point on the westline

1 of Kendall County, we found the old line
2 north of said point. Having thus ascer-
3 tained that an old marked line existed,
4 J. H. Davis the Surveyor of Kerr County and
5 myself could not agree on the line to be
6 run between Kerr and Gillespie Counties. -

7 The Surveyor of Kerr County held that the old
8 marked line, could not be accepted as
9 the boundary line between Gillespie and Kerr
10 Counties for the following reason viz: 1)
11 because the same is incorrect 2) because
12 no report of same has been made, accord-
13 ing to law. 3) because same is not the
14 line designated and described by the act
15 creating Gillespie Co., 4) because there is no
16 legal record of same. -

17 I held, that the old line should be accepted
18 as the true boundary line between Gillespie
19 and Kerr Counties, for the reason that said
20 line is found marked on the ground. -

21 As is in such cases provided by law, we, Mr.
22 J. H. Davis and myself, reported the question
23 at issue between us, as well as the facts
24 in the case, to the Hon. R. M. Hall Commis-
25 sioner of the General Land Office, praying
26 for his decision. The Commissioners de-
27 cision sustained the argument of J. H.
28 Davis and overruled my opinion. The
29 Commissioners answer being in substance
30 as follows;

31 General Land Office Austin July 20th 1889
32 J. H. Davis Esq.

Spec. Sur. Kerr Co. Kerrville Texas.

Dear Sir;

Replying to your communication of date in regard to the line between Kerr and Gillespie Counties, have to say that the result desired in re-running the boundary lines between Counties, is to have them correct. So, if the line between Gillespie and Kerr Cos. as run by Mr. Kueschler is found to be erroneous, either in the beginning point, or in the course of the line, it must be disregarded in so far, as the error exists, notwithstanding the line may be found marked on the ground.

Respectfully R.M. Hall Commr.

* General Land Office Austin Tex July 29, 1889

Mr. A. E. Schuchard Fredericksburg.

Sir: - Replying to yours of the 25th inst: I will state that the S. E. corner of Gillespie Co. established by Gillespie Co. and Blanco Co. Surveyors recently shows that Kueschler's corner is erroneous, therefore Kueschler's South line running from said corner is also incorrect, and the establishment of a new line from the new corner is required.

Respectfully

R.M. Hall Commissioner

After the Commissioners decision had been rendered we again resumed our labors, and assisted by August Weinaum P. B. Love, Cha. Gehman & Ben - we commenced at a point on the westline of Kendall County herein before described, and running as far

1 north as we had run south, in running
2 to and retracing the old line, we ran to a
3 point 35966 varas due west from the S. E.
4 Corner of Gillespie Co. and erected a stone-
5 monument and marked same NE Cor. K. Co.
6 from which a Spanish oak 3 in dia. marked
7 G bears N. 75° W. $1\frac{3}{5}$ vrs and a Cherry 5 in dia.
8 marked K bears S. $17\frac{1}{2}^{\circ}$ E 19 varas. - Thence run-
9 ning west at 694 varas cross the eastline
10 of Survey N^o 191 made for T. T. R. R. Co. 159
11 varas north from its S. E. corner and 1713
12 varas south from its N. E. corner, at 570 varas
13 cross a branch at 1644 varas cross the west
14 line of Sur. N^o 191 do eastline Sur. N^o 192-159
15 varas north from the S. W. Cor. N^o 191 do S.
16 E. N^o 192 and 1606 south from N. E. N^o 192 and
17 1713 south from the N. W. Cor. Sur. N^o 191 at
18 1900 vrs. varas erected a stonemound mark-
19 ed IMNEK from which a Spanish oak 4' in
20 dia; bears N. $20\frac{1}{2}^{\circ}$ W. $11\frac{1}{5}$ varas do 4' in dia;
21 bears S. $64\frac{1}{2}^{\circ}$ W. $12\frac{3}{5}$ varas; (at one mile ⁴²⁴
22 694 vrs. a point from which the N. W. Cor.,
23 ner of Survey N^o 227 in name of Daniel Arhel-
24 ger, bears south 159 varas, at one mile and
25 774 varas cross the westline of Survey N^o 192
26 do eastline of Survey N^o 99 in name of John
27 H. Cocks 159 varas north from the S. W. Cor.
28 of Survey N^o 192 and 1606 varas south from
29 the N. W. corner of Survey N^o 192 and 420
30 varas north from the S. E. corner of Survey
31 N^o 99 in name of John H. Cocks and 967
32 varas south from its N. E. corner; at 2 miles

Section in
N E Cor of Kerr
Co
694 E of 159 N
of S E Cor 191 T

Gillespie Co. Bdry. Line #3

2

1 erected a stonemound and marked same
 2 II MNEK from which a Post oak 14' in
 3 dia; bears S. 77° W. 3 1/2 vrs do 16' in dia; bears
 4 N. 16 1/2° E. 16 varas) (at 2 miles and 225 varas
 5 cross the westline of Sur. N° 99 do eastline
 6 of Sur. N° 102. 420 varas north from the S.
 7 W. Cor. of N° 99 do S. E. Sur. N° 102 and 967 varas
 8 South from the N. W. Cor of Sur. N° 99 do N. E. N°
 9 102 at 2 miles and 510 varas. West Prong of
 10 Bear Creek at 2 miles and 1620 varas the
 11 westline of Survey N° 102 do eastline of Jesse
 12 Johnson Survey 397 varas north from the
 13 S. W. N° 102 do S. E. of Jesse Johnson survey at
 14 three miles a stonemound marked III
 15 MNEK from which a Post oak 14' in dia; bears
 16 S. 86° E 4 3/5 vrs do 16' in dia; bears N. 89° E. 22
 17 varas) (at 3 miles and 1015 varas cross east
 18 line of Survey N° 1124 in name of W. H. Hill,
 19 men 176 vrs South from the S. E. corner of Sur.
 20 N° 1123 do N. E. N° 1124 at 3 miles 1063 varas
 21 cross the west-line of Jesse Johnson Sur 397
 22 varas north from its S. W. Corner at 4 miles
 23 stonemound marked IV MNEK fr. wh.
 24 a Live oak 20' in dia; brs N. 9° E. 20 varas and
 25 a Spanish oak 8' in dia; bears S. 57° W. 21
 26 varas) (at 4 miles and 897 varas cross the
 27 westline of Sur. N° 1124 at a point 176 vrs
 28 south from its N. W. Corner at 4 miles 1110
 29 varas cross the westline Sur. N° 1123 do
 30 eastline Sur. N° 964 in name of Tardis 214
 31 vrs north from its S. E. corner, at 4 miles
 32 1240 varas cross a branch, at 5 miles - a

2

3

4

5

Gillespie Co. Bdry. Line # 3

stone monument on the divide between Wolf
& Bear Creek marked VMNEK from which
a live oak 8' in dia; bears N. 26° W. $5\frac{2}{5}$ varas
do 10' in dia; bears S. 53° W. 12 varas (at 5 miles
and 1160 varas the west line Survey N^o 964 do
eastline of Survey 554 in name of C. E. Mitschke
214 varas north of the S. E. corner of Sur. N^o
554. at 5 miles 1260 varas the westline of sur-
vey N^o 554 - 214 vrs north of its S. W. corner
same being the eastline of Survey N^o 360 in
name of Manchaca, at 6 miles a stone monu-
ment marked VI NEK from which a
cherry 4' in dia; bears S. 35° W. 36 varas and
a live oak 3' in dia; bears N. $23\frac{1}{2}^{\circ}$ W. $13\frac{3}{5}$ varas
(at 6 miles and 120 varas divide between
east and middle prong of Wolf Creek at 6
miles and 1000 varas middle prong of Wolf
creek at 7 miles stone monument marked
VII NEK. from which a Black oak 5' in dia;
bears N. 35° W. 8 varas and a live oak 18' in
dia; bears S. 28° W. 48 vrs) (at 7 miles and 476
varas cross westline of Survey N^o 360 do east
line of Survey N^o 180 - 583 varas from its N.
E. cor. do N. W. N^o 360 at 7 miles 604 varas
cross the westline of Sur. N^o 180 do eastline
of Sur. N^o 179 at a point 583 varas South
from its N. E. corner, do N. W. Cor. of Sur. N^o 180
at 7 miles and 700 vrs. cross branch at
7 miles 1400 vrs. divide Middle and West
Prong of Wolfcreek at 8 miles stone monu-
ment marked VIII M. NEK from which a
Spanish oak 10' in dia; bears N. 58° W. $6\frac{2}{5}$ varas

A Manchaca
360 made only
3316 vrs wide
instead of 3807

Gilispie Co. Barry line #3

9

10

11

and a live oak 5' in dia; bears S. 82° E. $19\frac{7}{5}$ varas) (at 8 miles and 106 varas a point from which the S.W. corner of Survey N^o. 359 in name of Manchaca bears north 583 varas, at 8 miles and 705 varas top of Bluff at 8 miles 780 varas crosses Fredericksburg & Kerrville road at 8 miles 810 varas crosses West Prong of Wolf Creek at 8 miles and 834 varas crosses the eastline of Survey N^o. 1. same being the westline of Sur N^o. 179 - 1100 varas South from its N.W. cor. do N.E. cor. Sur. N^o. 1. at 9 miles stonemoument marked IX MNEK from which a Post oak 14' in dia; bears N. 82° W. 8 varas and a Blackjack 16' in dia; bears S. 34° E. $6\frac{2}{5}$ varas) (at 9 miles and 910 varas crosses westline of N^o. 1. do eastline of N^o. 2 - 1100 varas South from N.W. Cor. N^o. 1. do N.E. Cor. Sur. N^o. 2 at 9 miles and 1850 varas branch at 10 miles stonemoument marked X NEK from which a Double Blackjack 18' in dia; bears N. 83° W. $18\frac{1}{5}$ varas and a live oak 4' in dia; bears S. $73\frac{1}{2}^{\circ}$ W. $5\frac{1}{5}$ varas;) (at 10 miles and 681 varas a point from which the East Corner of survey N^o. 101 made for Rust Transportation Company bears north 1015 varas; at 10 miles and 910 varas crosses the westline of Survey N^o. 2 do eastline of Survey N^o. 1658 in name of James Lindsey 800 varas north from the S.W. Cor. of Sur. N^o. 2 at 10 miles and 1636 varas crosses the westline of Survey N^o. 1658 do east. line of Survey N^o. 101 N. 43° E. 500 varas from its South Corner and S. 43° W. 1400 varas from

Gillespie Co. Bdry Line #3

its east-corner; at 11 miles a stone monument
 marked XI on the head breaks of Town-creek,
 from which a Cedar 12' in dia: bears N. $67\frac{1}{2}^{\circ}$
 E. $5\frac{3}{5}$ varas do 3' in dia: bears S. 18° W. $3\frac{1}{5}$ varas
 (at 11 miles and 1498 varas cross the westline
 of Sur. N^o 1658 do eastline of Sur. N^o II - 728
 varas north from its S. E. corner and 1172
 varas South from its N. E. corner; at 12 miles
 a stone monument marked XII MNEK
 from which a liveoak 6' in dia: bears N.
 $4\frac{1}{2}^{\circ}$ E. $19\frac{4}{5}$ varas do 5' in dia: bears S. $7\frac{1}{2}^{\circ}$ W. $10\frac{4}{5}$
 varas (at 12 miles and 1498 varas cross the west
 line of Survey N^o 2 do eastline Sur. N^o 726
 in name of D. B. Knowlton 222 varas South
 from the N. E. corner of Sur. N^o 726 at 13 miles
 stone monument marked XIII MNEK from
 which a Spanishoak 6' in dia: bears N. 7°
 W. $3\frac{3}{5}$ varas do 3' in dia: bears S. 32° E. $4\frac{2}{5}$ varas
 (at 13 miles and 542 varas cross the west
 line of Sur. N^o 726 in name of D. B. Knowlton
222 varas South from its N. W. Corner, at 13
 miles and 923 varas cross the eastline of
 Survey N^o 1. B. & F. 410 varas South from the
 South-line of Survey N^o 358 and 205 varas
 South from N. E. N. E. Corner of Sur. N^o 1 and
1695 varas north from the S. E. corner of
 Sur. N^o 1. B. & F. at 13 miles and 1145 varas
 cross Town-Creek-Road; at 14 miles stone
 monument marked XIV MNEK from which
 a Spanishoak 4' in dia: bears N. 85° E. 15 varas
 and a Walnut 2' in dia: bears S. $73\frac{1}{2}^{\circ}$ W. 12 varas
 (at 14 miles and 923 varas cross the westline

12

13

14

Gillespie Co. Bdry. Line #3

15 of Sur. N^o. 1. B. S. & F. do eastline of Sur. N^o. 2. B. S. & F. 205 varas south from N. W. Cor. of Sur. N^o. 1. do. N. E. Cor. Sur. N^o. 2 and 1695 varas north from the S. E. Cor. Sur. N^o. 2 do S. W. Cor. Sur. N^o. 1. at 14 miles and 1455 varas divide between Town-creek and Goat-creek, at 14 miles and 1732 varas point from which the S. E. Corner of Survey N^o. 357 bears N. 410 varas; at 15 miles a stonemoument marked XV M. N. E. K from which a Cedar 2' in dia; bears N. 51° E. 7 1/5 varas a Walnut 2' bears S. 84 1/2° E. 13 3/5 varas) at 15 miles and 660 varas cross a road at 15 miles and 675 varas cross East Goat-Creek, at 15 miles and 923 varas cross westline Sur. N^o. 2 and eastline of Sur. N^o. 1927 in name of J. A. Saunders, 205 varas south from the N. W. Cor. N^o. 2 and 410 varas south from the N. E. corner of Survey N^o. 1927 in name of Saunders, at 15 miles and ¹⁸⁷³1373 varas cross the westline of Saunders survey do eastline of Sur. N^o. 1405 in name of David M Lawrence N. 47 1/2° W. 125 varas from the east-corner of said survey N^o. 1405, at 15 miles and 1690 vrs. cross Middle prong of Goat Creek, at 15 miles and 1890 vrs. cross Main Prong of Goat Creek at 16 miles a stonemoument marked XVI M. E. K from which a hioe oak 15' in dia; bears N. 68 1/2° W. 43 2/5 vrs. do 10 bro. S. 11° E. 14 2/5 vrs. (at 16 miles and 562 vrs. cross westline of Survey N^o. 1405 in name of D. M. Lawrence N. 42 1/2° E. 190 varas from its west corner said westline of Survey N^o. 1405 being also

15
16
17
18
19
20
21
22
23
24
25
26
27
28
29
30
31
32

16
17
18
19
20
21
22
23
24
25
26
27
28
29
30
31
32

Gillespie co. Bdry. Line #3

17
a line of Survey N^o. 1823 made for D & P Ry Co.
at 16 miles and 689 varas a point from which
the west corner of said Survey N^o. 1405 bears
South 140 varas, at 16 miles and 864 varas
a point from which the east corner of sur-
vey N^o. 1406 in name of J. W. Harris bears South
140 varas, at 16 miles and 1054 varas cross
a line of said Sur. N^o. 1823 do eastline of sur-
vey N^o. 1406 in name of J. W. Harris N. 54° W.
238 varas from its east corner, at 16 miles and
1110 varas Goat-Creek-Road, at 16 miles 1560
varas cross west prong of Goat-creek,
at 16 miles and 1600 varas a high bluff;
at 17 miles a stone monument marked
XVII MNEK from which a Cedar 10' in dia;
bears N. 63° W. 5 varas do 8' in dia; br. S. 18°
N. 11 varas) at 17 miles and 37 varas crosses
westline Sur. N^o. 1406 in name of Harris
do line of sur. N^o. 1823 D & P. Ry Co. S. 36° N. 526
varas from the North corner of survey N^o. 1406
at 17 miles 290 varas, crosses line of survey
N^o. 1824 D & P. Ry Co. 10 varas South from its
N. E. corner, at 17 miles and 814 varas crosses
the westline of N^o. 1824 do eastline of N^o. 1530
D. & P. Ry. Co. 10 varas South from N. W. Cor. of
said Survey N^o. 1824 and 1294 varas South
from the N. E. corner of said survey N^o. 1530
at 17 miles and 1877 varas cross westline of
Survey N^o. 1530 do Eastline of Sur. N^o. 758 in
name of W. Henderson N. 50° E. 248 varas,
from its South corner - at 18 miles stone monu-
ment marked XVIII MNEK from which

1 a cedar 14' in dia; brs S 30° W. 9 7/5 ors. & the
2 chimney of Howard Henderson's house brs
3 N. 28 1/2° W. 320 varas) (at 18 miles and 357
4 varas cross the westline of Sur. N° 758 in
5 name of Henderson N. 50° W. 290 varas from
6 its South-corner and S 50° E. 660 varas from
7 its West-corner the westline of said Survey,
8 being also the eastline of Sur. N° 1529 at
9 18 miles and 863 varas a point from which
10 the West-corner of the Howard Henderson
11 Survey bears North 425 ors. at 18 miles and
12 949 ors. a point from which the S. E. corner
13 of Survey N° 142 bears north 87 varas; at 19
14 miles a stone monument marked XIX
15 MNEK from which a hives oak 4' in dia; brs
16 N. 54° E. 3 ors. Shinoak 2' brs S. 12 1/2° E. 2 1/5 ors)
17 (at 19 miles and 780 varas cross the westline
18 of Survey N° 1529 do eastline of Survey N° 1556
19 87 varas South from the N. W. corner of sur-
20 vey N° 1529 and 39 varas south from the
21 N. E. corner of Survey N° 1556, at 19 miles and
22 872 varas a point from which the S. E. cor. of
23 W. A. M. Terry's preemption bears north 39 varas
24 at 20 miles a stone monument marked XX
25 MNEK from which a cherry 4' in dia; bears S.
26 65° E. 3 ors. Spanish oak 3' brs N. 82° E. 3 ors) (at 20
27 miles and 1082 varas cross line of Sur. N° 1556
28 do eastline of Sur. N° 740 in name of John A.
29 Henderson, N. 45° W. 300 varas from the East cor-
30 ner of said Survey N° 740; at 21 miles a stone
31 monument marked XXI MNEK from which
32 a cherry 5' in dia; brs S. 7° E. 8 7/5 ors. hives oak 4' in

19

20

21

Last one
mile
mi. 0.75
21 + 1134
S.W. corner
Gillespie Co
to S.W. cor
Gillespie

dia: bro. N. 13° W. 28 varas) at 21 miles and 42 varas
crosses the west line of Survey N° 440 N. 45° E
300 varas from its west corner, said line being
also a line of Survey N° 1410; at 31 miles and
1134 varas, a stonemount, on point of moun-
tain on East side of a dry branch for S.W.
corner of Gillespie County marked S.W. cor. Co
from which a Cedar 6' in dia: bro. S. 10° E. 12
varas do 6' in dia: bears N. 79 1/2° E. 25 1/5 varas.)
Thence running north at 125 varas strike
a dry branch at 700 varas leave same at point
of mountain between two dry branches, at
one mile stonemount marked I M S W
G from which a Spanish oak 4' in dia: bears
S. 21° E. 19 varas do 5' in dia: bears S. 23° E. 19 1/5
varas) at one mile and 120 varas cross the
northline of survey N° 1410 do southline of sur-
vey N° 29 granted to J. V. Massey 36 varas east
from the N.W. cor. sur. N° 1410 do S.W. cor. N° 29
at two miles stonemount marked II
M S W G from which a live oak 16' in dia: bears
S. 47° E. 10 3/5 var. do 16' in dia: bro. N. 37 1/2° W. 16 3/5 var.)
(at 2 miles and 129 varas cross the northline of
Survey N° 29 do southline of Survey N° 33 made
for S. B. Turner 46 varas east from the N.W. cor
sur. N° 29 do S.W. Cor. Sur. N° 33; at three miles
stonemount marked III M S W G from which
a live oak 18' in dia: bears S. 27° W. 26 3/5 Black
Jack 8' in dia: bro. N. 25° E. 14 3/5 var.) at 3 miles and
114 varas cross the northline of Survey N° 33 do
southline of Survey N° 26. - 30 varas east from
the S.W. Cor. Sur. N° 26 do N.W. Cor. Sur. N° 33 at

mount

2

3

4

Gillespie Co. Bdry. line #3

four miles a stonem monument marked **IV**
 M S W. G from which a live oak 14' in dia,
 brs. N. 46° E 10 vrs do 8' in dia, bears S. 77 1/2° W.
 31 4/5 vrs (at 4 miles and 98 varas cross northline
 of survey N° 26 do southline of survey N° 444 six,
 ten and one-half varas east from the N. W
 corner of Survey N° 26 do S. W. Corner of Survey
 N° 444) at 4 miles and 1516 varas cross the
 northline of Survey N° 444 do northline of
 survey N° 1. C. C. & D. & R. G. N. 9. R. R. do southline
 of Survey N° 3 C. C. & D. & R. G. N. 9. R. R. 60 varas
 west from the N. E. corner of Survey N° 1 and
 510 varas west from the S. E. cor. of sur. N° 3
 at 5 miles a stonem monument marked **V** M
 S. W. G from which a live oak 5' in dia; bears
 N. 71 1/2° E. 14 1/5 varas do 14' in dia; brs. S. 68° W. 58 3/5
 vrs (at 5 miles and 1495 vrs. crosses the north
 line of Sur. N° 3 510 vrs. west from its N. E. cor.
 ner; at six miles erected a stonem monument
 marked **VI** M S W. G from which a live oak 18'
 brs N. 75° W. 19 vrs do 0.5 brs N. 29° E. 25 1/2 vrs (at 6
 miles and 495 vrs. crosses the northline of sur.
 vey N° 5 do southline Survey N° 19 made for Leona
 Orr. & Mfg. Co. 876 varas east from the S. W. cor. sur.
 N° 19 do N. W. Cor. Sur. N° 5 and 1024 varas west
 from the S. E. cor. Sur. N° 19; at seven miles stone
 mound marked **VII** M S W. G from which a live
 oak 20' in dia; brs. N. 68 1/2° W. 4 1/5 vrs. and a Post
 oak 14' in dia; brs. N. 56° E. 9 1/5 vrs. (at 7 miles
 and 495 vrs cross the northline of Survey N° 19 do south
 line of survey N° 19 - 876 varas east from the N. W.
 Cor. of sur. N° 19 do S. W. Cor. Sur. N° 19 at 8 miles

4 m 1516 vrs
 north line of sur.
 CC & D. & R. G. N. 9. R. R.
 N. 9. do S. E. corner
 510 vrs of S. E. Cor.

5 m 1495 vrs do line
 of N. E. corner
 of Sur. N° 3

6 m 495 vrs do line
 of S. W. corner
 of Sur. N° 19
 876 vrs do S. W. corner
 of Sur. N° 19
 1024 vrs do S. E. corner
 of Sur. N° 5

Gillespie Co. Bdry. line #3

8

9

10

10 mi
534 varas
Gillespie County
line of sec 9

a Post set in ground and squared marked
 VIII MSWG from which a Post oak 10' in dia;
 bro. S. 27° E 6 vrs, do 12' N. 72° W. 4 2/5 vrs) at 8
 miles and 495 varas cross the northline of
 sur. N° 17 do southline of survey N° 10 - 876 varas
 east from the N.W. corner of sur. N° 17 do S.W.
 cor. sur. N° 10; at 9 miles stonemoument
 marked IX MSWG from which a live oak
 10' bro. S. 68° W. 104 3/5 vrs, P. O. 10 bro. S. 4° E 69 vrs;
 at 9 miles and 495 varas cross northline
 sur. N° 10 and the southline of survey N° 9 - 876
 varas east from the N.W. Cor. sur. N° 10 do S.W.
 Cor. N° 9 at 10 miles stonemoument marked
 X MSWG from which a live oak 15' in dia; bro
 N. 39° E. 34 3/5 vrs and a Blackjack 14' in dia; bears
 N. 85° W. 42 3/5 vrs) at 10 miles and 534 varas
 cross the northline of survey N° 9 do southline
 of survey N° 722 - 876 varas east from the N.
 W. cor. of sur. N° 9 and 324 varas east from the
 S.W. cor. of sur. N° 722 erected a stonemou-
 ment for South-East-Corner of Kinble County,
 marked S.E. Cor. K.C.; from which a live oak
 20' in dia; bears N. 83° W. 37 3/5 vrs, a Post oak
 20' in dia bro. N. 15° E. 44 varas do 14' in dia;
 bears N. 14° E. 40 3/5 varas, and the S.E. corner
 of survey N° 722 bears east 850 varas.
 Bearings on north and east side of line marked G
 " " South and west side of line marked K.
 Variation N 9° 15' E.

I A. E. Schuchard, special surveyor of Gillespie
 County do hereby certify that the above and
 foregoing is a true and correct report & description

Gillespie co. Bdwy. line #3.

of the County line between Kerr & Gillespie Co
and that the same is in accordance
with the plat herewith delivered

A. E. Schuchard
Special Surveyor
Gillespie County Tex,

J. H. Davis special surveyor of Kerr Co.
do hereby certify that I have examined the
above and foregoing report and find the
same correct

J. H. Davis
Spec. Sur. Kerr. Co.

The State of Texas }
County of Gillespie } J. H. Benschwale
Clerk of the County Court

of said County do certify, that the foregoing
14 pages of field notes, and map hereto
attached, are true and correct copies from
the records of the County Commissioners
Court of Gillespie County entered at the Novbr.
term 1889, and as the same were returned
by the special surveyor A. E. Schuchard,

Given under my hand and
seal of office this 14th day of
Decbr. 1889. J. H. Benschwale
Clerk. C. C. G. Co.

Gillespie co. Bdry. line #3

M/ Gillespie-Kerr

Gillespie Boundries

Filed Dec. 18th 1889

~~5~~

There is one mile
lost between N.E.
Cor of Kerr Co + the
S.W. cor of Gillespie
Co.



863

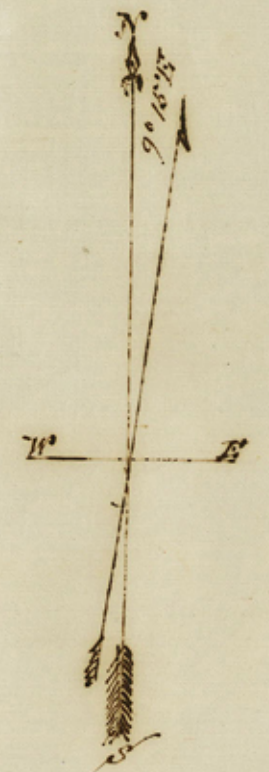
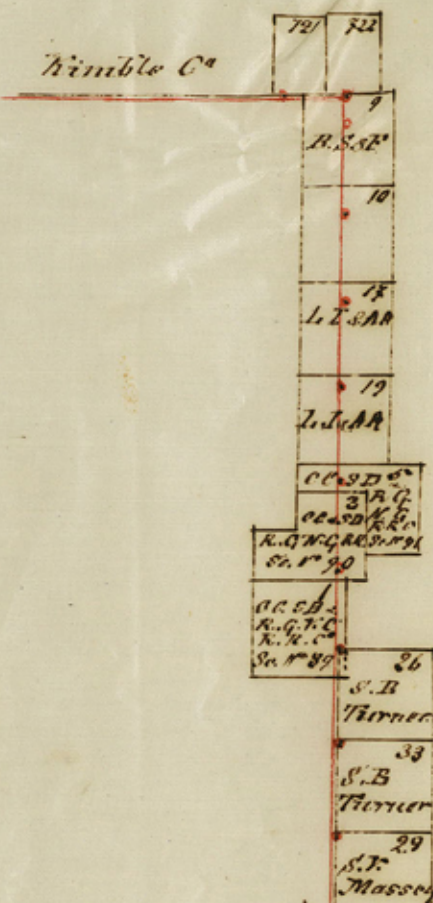

Gillespie County

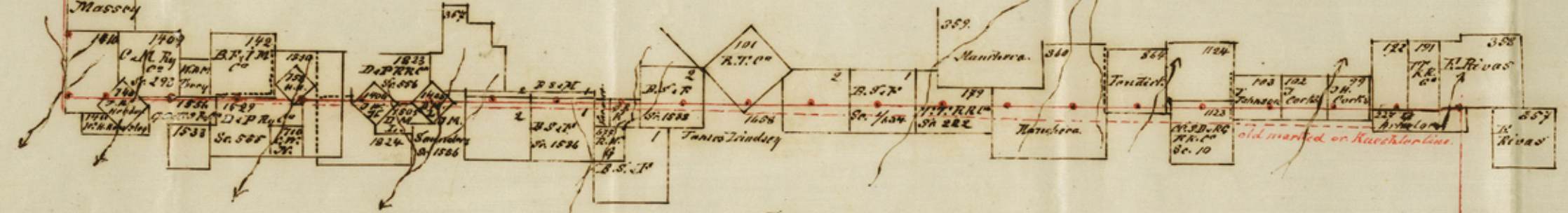

Kerr County

Randall Co