

Scale 1000 yards to one inch

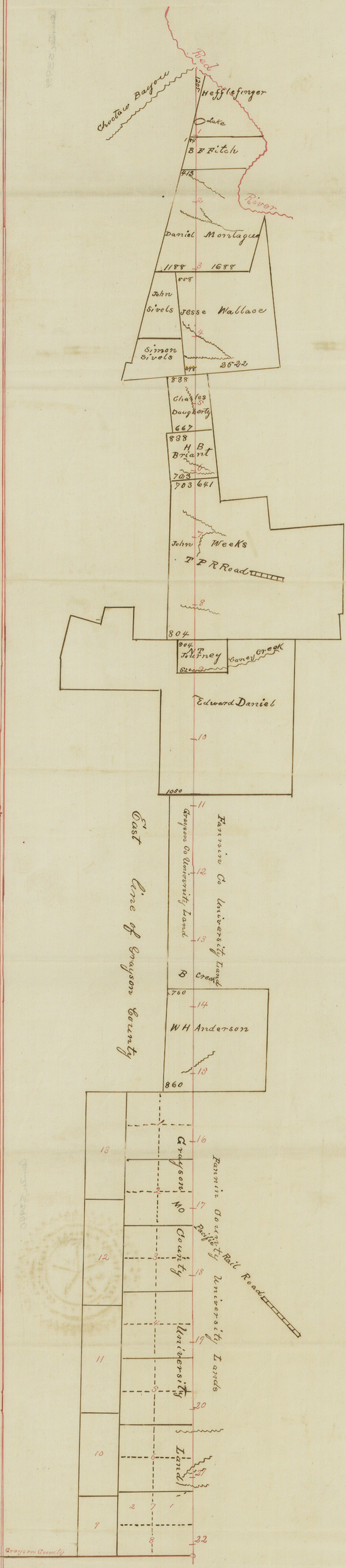

State of Texas We Samuel Bonham duly appointed by the County Court of Grayson County of said County and M Keithley duly appointed by the County Court of Fannin County to establish mark and measure the Eastern boundary line of Grayson County and the Western boundary line of Fannin County do certify under the oath of our office that the above and foregoing sketch map is a true representation of said line as defined by us and the surveys through which it runs and that the natural and artificial marks called for in said notes of said line are correctly represented above  
 In testimony whereof our official signatures on this the 7<sup>th</sup> day of Aug 1882

Samuel Bonham C D & Co  
 M Keithley C D & Co

The State of Texas I J A Dickerman Clerk of the County Court for Grayson County do hereby certify that the foregoing is a true and correct copy of the sketch map of the Eastern boundary line of said County, together with the Surveyors Certificate thereon, as the same appears now on file and of record in my office.



Given under my hand and seal of office at Sherman this the 22<sup>nd</sup> day of December A D 1882  
 J A Dickerman Clerk  
 By C E Fry Deputy



