

E r o l t h C<sup>e</sup>

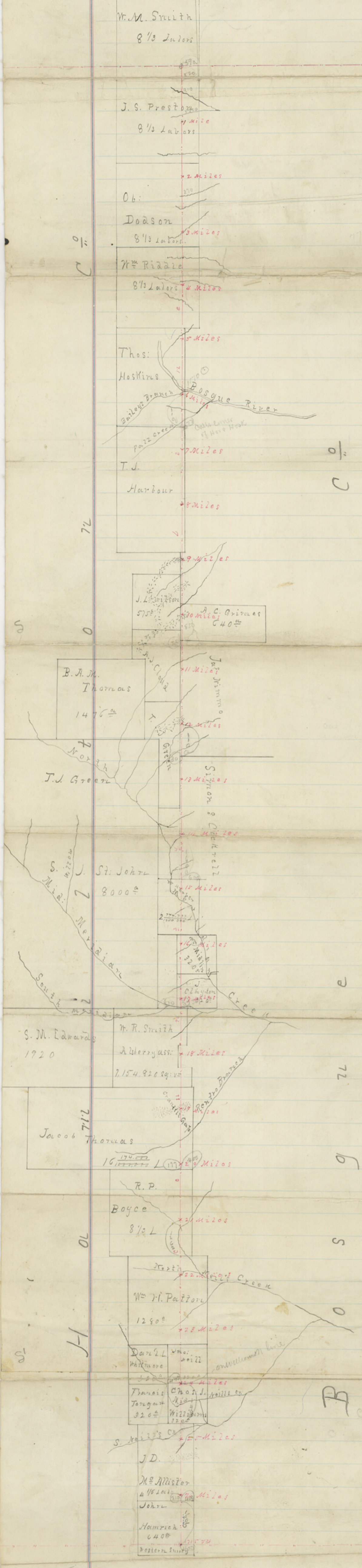

C o r y e 22 C<sup>e</sup>

I of Sayon County Surveyor of Hamill  
do hereby certify that the above is a true  
& correct plat of the surveys along the  
Eastern boundary line of Hamilton County  
and made according to the field notes  
made in establishing the same  
and agreed upon by J. W. Robertson  
County Surveyor of Bosque Co & my  
self - Given under my hand this  
July 7 1879. W. J. Sayon  
C. S. H. C. J.

Approved  
J. W. Pearson  
County Judge Hamill

REC 10/8/41  
U.S.

