

1837

OFFICE OF



**Tax Assessor**

HAMILTON COUNTY

TOM C. PIERSON, TAX ASSESSOR

Hamilton, Texas, 3/14<sup>th</sup> 1918

Cour. G. L. Office  
Austin Texas

Dear Sir -

Enclosed please find certified copy of order of the District Court - approving report of the Surveyor, and sketch showing surveys effected - along County line. Hoping this will give you all information desired I remain

Yours Truly  
Tom C. Pierson

see letter to Tom C. Pierson

6/5/18 Clerk

RECEIVED

MAR 17 1918

Referred to Map.

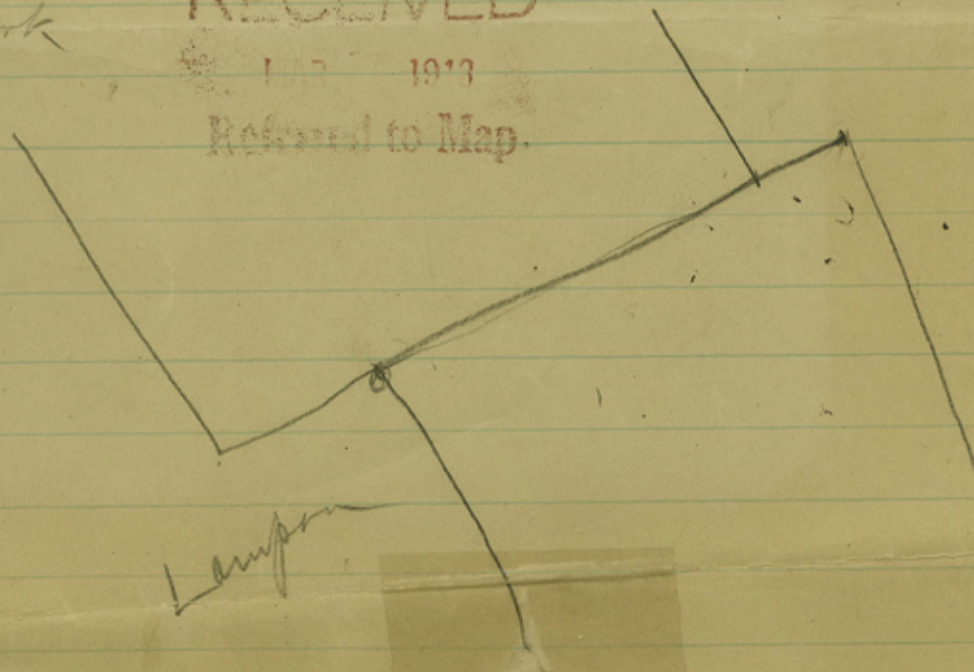

Lampson

191  
1918

Hamilton Co Bary Line 5

(12)

Coryell Co. Bary.

The State of Texas, \* In District Court, Hamilton County, Tex.  
\*  
County of Hamilton. \* March Term, A. D. 1918.

On this 6th day of March, A.D. 1918, came on to be considered the report of W.T.Saxon, County Surveyor of Hamilton County, Texas, in compliance to an order issued out of the District Court of Hamilton County, Texas, ordering the said Saxon to proceed and go upon the ground and establish the boundary line between the Counties of Coryell, Hamilton and Lampasas which was dated Dec. 12th, 1891.

The Court after due consideration finds that said attached report which was made by the said Saxon, Surveyor for Hamilton County, Texas, is a true copy of said report returned in compliance to said above order by him on the 2nd day of June 1892, and from some reason said report was misplaced and never recorded by the Clerk of this Court.

It is therefore the order of this Court that the said attached report be and the same is hereby approved and the Clerk of this Court is hereby ordered to file and record the same in the Minutes of this Court together with the plat or map hereto attached.

State of Texas, \*  
\*  
Hamilton County, \* To Hon.C.K.Bell Judge of District Court of Hamilton Co.

In compliance with the attached order issued from the District Court of Hamilton County Dec. 12th 1891, I, W.T.Saxon, County Surveyor of Hamilton County did on the 19th day of April 1892, go upon the ground & proceed to establish the Boundary Line between the Counties of Hamilton & Coryell according to the wording of said order. After finding and identifying the S.E.corner of Hamilton Co. & the S.W.corner of Bosque County, (which is established thus; within the J.Hamrick survey of 640 acres, a S.M. 400 vrs.S.60 W. and 1505 vrs.S.30 E.from the N.E.corner of said J.Hamrick, from which a group of 6 Live Oaks marked B.W.and H. bear S.3 E.150 vrs.) see sketch Four. Thence I ran S.60 W. and at 1770 vrs.crossed the W.line of said Hamrick Survey & E. line of G.Logan survey at 1900 vrs. a S.M.for 1 mile. Thence at 1900 vrs. a stone marked 2 M. planted in ground for 2 miles. Thence at 500 vrs. cross N. prong Hog Creek at 1500 vrs. pass S.E.corner of Wm.Quinn 1900 a S.M.marked 3 M. for 3 miles. Thence at 1900 vrs.a S.M.marked 4 M. for 4 miles. Thence at 20 vrs. enter timber on brakes of Leon River 180 vrs. a branch 300 vrs.cross Jonesboro Road 500 recrossed said branch 1260 another branch 1900 vrs. a S.M.

Hamilton Co Bary Line 5

marked 5 M. for 5 miles (on side of mountain). Thence at 180 vrs. cross point of mountain 240 foot of mountain, 1900 vrs. a S.M. marked 6 M. for 6 miles, 60 vrs. S. 60 W. from the S.W. corner of the J.W. Lynam survey. Thence 1900 vrs. a S.M. marked 7 M. for 7 miles. Thence at 30 vrs. cross S. line of the A. Frazier survey, S. 71 E. 475 vrs. from the S.W. corner of said Frazier at 800 vrs. cross E. line of James Daugherty Sur. 890 vrs. S. 19 W. from the N.E. corner of said Daugherty, 860 cross Hamilton and Jonesboro Road, 1900 vrs. a S.M. marked 8 M. for 8 miles. Thence at 820 vrs. cross Leon River, 1100 vrs. a branch, 1900 vrs. a S.M. marked 9 M. for 9 miles. Thence at 1600 vrs. cross Key branch 1900 vrs. a S.M. marked 10 M. for 10 miles, (on a bluff in prairie). Thence at 1880 vrs. cross Campbell branch 1900 vrs. a S.M. marked 11 M. for 11 miles. Thence at 1760 vrs. cross N. line ~~of~~ Alex McKinzie 1162-1/2 vrs. <sup>from S. 71 E. from the N.W. corner of 925-004</sup> from the S.W. corner of John Seldon Sur. at 1900 vrs. a S.M. on bank of a branch of Eagle Creek marked 12 M. for 12 miles. Thence at 370 vrs. cross Eagle Creek 1580 cross N. line of Spencer Rice & S. line of Mattie Radford surveys 55 vrs. N. 71 W. from S.E. corner of Mattie Radford & 1288 vrs. S. 71 E. from N.W. corner of said Rice at 1900 vrs. a S.M. marked 13 M. for 13 miles. Thence at 1810 vrs. a branch 1900 vrs. a S.M. marked 14 for 14 miles. Thence at 130 vrs. crossed Mustang Creek 1500 vrs. cross S. line of \_\_\_\_\_ Vermillion & N. line of N. McGlothlin S. 71 E. 635 vrs. from the S.W. corner of \_\_\_\_\_ Vermillion & N.W. corner of said McGlothlin at 1600 vrs. a branch 1900 vrs. a S.M. for 15 miles marked 15 M. Thence at 580 cross E. line of J.P. House 620 vrs. cross Plum Creek 1900 vrs. a S.M. for 16 miles, marked 16 M. Thence at 600 vrs. leaves timber 1900 vrs. a S.M. on divide between waters of Plum Creek and Cowhouse for 17 miles, marked 17 M. Thence at 1000 vrs. cross a branch at 1900 vrs. a S.M. for 18 miles, marked 18 M. Thence at 480 vrs. cross S. line of J.P. House Sur. at 1900 vrs. in Worrells field marked 19 M. Thence 310 cross S. line of the N.E. 1/4 of Sec. No. 4 of the S.P.R.R. Co. survey, S. 71 E. 155 vrs. from the S.W. corner of said 1/4 section, at 1870 vrs. cross Woolseys branch 1900 vrs. a S.M. marked 20 M. for 20 miles. Thence at 420 vrs. cross branch 700 vrs. cross E. line of Wm. Scott survey & W. line of \_\_\_\_\_ Rice 140 vrs. S. 19 W. from the N.E. corner of said Scott, at 1460 vrs. crossed Cowhouse Creek 1900 vrs. a S.M. planted in a slough marked 21 M. for 21 miles. Thence at 420 crossed a branch 1900 vrs. a S.M. on high prairie ridge marked 22 M. for 22 miles. Thence at 1900 vrs. a S.M. for 23 miles. Thence at 1400 vrs. a branch 1900 vrs. a S.M. marked 24 M. for 24 miles. Thence at 100 vrs. a branch

460 another 1620 vrs. cross S. line of H.B. Gilly survey S. 71 E. 32 vrs. from its S.W. corner 1900 vrs. a S.M. for 25 miles marked 25 M. Thence at 600 vrs. cross a branch 1000 vrs. cross S. line of N.J. Gilbreath Sur. 1078 vrs. a branch 1900 vrs. a S.M. for 26 miles marked 26 M. in N. side of Evant & Goldthwaite Road in the town of Evant. Thence 340 cross S. line of E.G. Glover Sur. 905 vrs. E. line J. Rohr 50 vrs. S. 19 W. from its N.E. corner, 1900 vrs. a S.M. for 27 miles, marked 27 M. Thence at 170 vrs. cross S. line of said J. Rohr survey 160 vrs. S. 71 E. from its S.W. corner, at 1900 vrs. a S.M. at foot of mountain for 28 miles marked 28 M. Thence at 260 vrs. pass S. 19 E. 40 vrs. from the S.E. corner of the F. Richardson Pre. Survey, at 1390 vrs. cross N. line of \_\_\_\_\_ Wilson survey 1880 vrs. a branch 1900 vrs. a S.M. marked 29 M. C.L. for 29 miles. Thence at 88 vrs. cross W. line of said Wilson 110 vrs. S. 19 E. from his N.W. corner, at 500 vrs. a branch, 660 another 1180 Baileys Creek 1300 W. line of F. Dunn 190 N. 19 W. from his S.W. corner, at 1545 cross E. line of \_\_\_\_\_ Pilley survey 250 vrs. S. 19 W. from his N.E. corner, 1900 a S.M. marked 30 M. Thence at 1900 vrs. a S.M. in Lampasas Creek bottom for 31 miles marked 31 M. Thence at 100 vrs. cross Lampasas 1900 vrs. a S.M. marked 32 M. for 32 miles. Thence at 25 vrs. cross N. line of Wm. Banta 28 vrs. S. 19 E. from his N.E. corner, at 1900 vrs. a S.M. marked 33 M. for 33 miles. Thence at 50 vrs. a branch 1040 vrs. E. line of J. George survey 1500 intersects E. line of Mills County (as located) in which a planted a Large Stone marked S.W.H.C. for the S.W. corner of Hamilton County and a corner of Lampasas Co. from which a group of Live Oaks bear N. 53 E. 274 vrs. marked H. & X. being within the J. George survey S. 19 E. 548 vrs. and S. 60 W. 460 vrs. from the N.E. corner of said J. George survey.

Given under my hand this June 2nd, 1892.

W. T. Saxon Co. Surveyor  
Hamilton Co. Tex.

Mr 228 Co

# Hamilton County Line

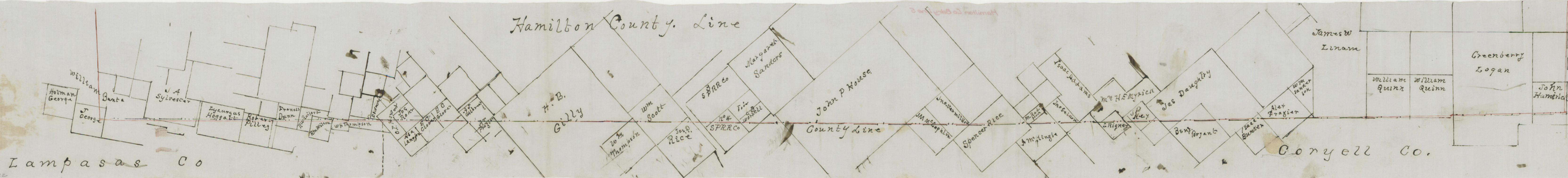

Lampasas Co

Coryell Co.

Posque County



The State of Texas, \*

County of Hamilton. \* I, J.F.Hill, Clerk of the District Court in and for Hamilton County, Texas, do hereby certify that the above and foregoing is a true and correct copy of the order of Court and the report of W.T.Saxon, County Surveyor of Hamilton County, Texas, together with map or plat, as the same appears of record in book J pages 408 and 409, of the Civil Minutes of the District Court of Hamilton County, Texas.

Given under my hand and seal of office, at Hamilton, Texas, this the 14th day of March, A.D. 1918.

*J.F.Hill* District Clerk,  
Hamilton County, Texas.

Hamilton Co ~~16~~ Bdry Line 5

Certified Copy  
of  
Field Notes  
Loryell. Lampson  
and Hamilton Co line  
3-14-1918

(12)

Coryell Co Bdry.

Counter 54224