

Survey of the County Line between
Montgomery & Harris County, Tex.
Line between the Counties of Harris and Mont-
gomery, on the 31st day of March A.D. 1841 - at
Hollbrook - viz.

Beginning at the junction of Lake
Creek and the San Jacinto River, on a Survey
Line 14 in. diam. m & H. Thence S 85° W
at 10368 m. crossed the Egypt and Montgomery
Road; - at 22368 m. crossed the Ford-
ton & Montgomery road in Gibbs Prairie;
at 24768 m. crossed Mill Creek; at 30268 m.
a line S 8° 30' E. at 35000 m. will intersect A.
Robertson's ^{corner} Survey of One Third of a League, as
made by Wm. Rankin Surveyor of Montgomery
County, and Henry Todd of Harris County.

At 54268 m. terminated the Random Line.
Thence S 8° 30' E 9000 m. to the head of
Pond Creek, an Oak 14 in. diam. m & H.
H. & A. Thence N 12° W 54000 m. to the head
of Spring Creek, from which two Post Oaks
bear. S 65° E. dist. 300 m. m & H.

Then commencing the true Line at the head
of Pond Creek, running and marking the same
the Mouth of Lake Creek. Course N 73° E. dist
54500 m.

Chain Carriers
James G. Read

Geo. Copeland

James W. Henderson
for George H. Bonnhurst
to Survey Harris Co
David M. Bullock
for John M. Wade
to Survey of Montgomery

We affirm under oath of Office that the foregoing
admeasurements and distances were run by us, and are

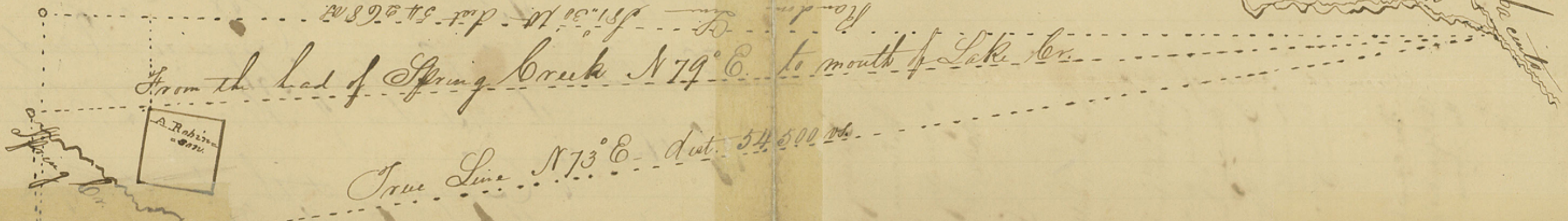

From the head of Spring Creek N 79° E. to mouth of Lake Cr.

True Line N 73° E. dist. 54,500 ft.

equal to Sixty Four and a third ($64\frac{1}{3}$) English
linear miles

variation 9.45° E

James W. Handerson
David M. Bullock

Republic of Texas
Montgomery County

This is to certify that I appointed D. M. Bullock, my deputy, to assist in running the line of division between the Counties of Harris & Montgomery from the head of Pond & Spring Creek to the mouth of Lake Creek - and that I made due return of said work, & signed by J. W. Henderson, deputy of G. A. Brughurst County Surveyor of Harris County, and David M. Bullock Deputy of John M. Wade, County Surveyor of Montgomery County - to the Commissioner of the General Land Office, and that I have never received pay or compensation for the same

John M. Wade
Late Co. Surveyor M.C.

~~Witness~~ Subscribed to before

Signature of the foregoing acknowledged before me by due & made this 12th day of Dec 22 1843, and same also sworn to by him to which I certify for under my hand & private seal for want of a seal retained this the 12th day of Dec 1843

Chas. B. ...
Surveyor Public
Montgomery County

Republic of Texas
County of Harris

This is to Certify that I, George H. Bingham, acting in my official Capacity as County Surveyor of Harris County; did on the 8th February A. D. 1841. especially nominate, and appoint, James. W. Henderson, as Deputy Surveyor, on my part, to run the county line between the Counties of Montgomery & Harris, which said County line was duly run, by James. W. Henderson, and David M. Bullock on the part of John M. Wade then County Surveyor for Montgomery and the Field-notes thereof duly returned, and approved of and Recorded by me

Houston June 21st 1843

Geo H Bingham

Certificate of Vininghurst
recognizing J. W. Henderson
as authorized to run the
boundary line between
Counties of Montgomery
& Harris, dated July 3/1863.

D
5

County 54348

Survey of boundary line
between Harris & Mont
gomery Co. founded by
Wade C. Linn Monty Co
July 3. 1841.

See letter of same date.

Not rec^d in consequence of not
being certified to by the
County Surveyor. The Genl
Land Office had no immediate
communication with the deputy
surveyor. Wm. H. H. and
C. J. P.

The county surveyor
certificates ^{has been} attached since
the above ^{was} made.

Line between Harris &
Montgomery Counties.

D^o

Harris & Montgomery Co line
sketches

Certificates of County Surveyor
and
31st of March 1841
Taken out to the head of Bond Cr.
N. S. H. Co. from the mouth of
Survey of boundary line between
Montgomery & Harris.

File 14. See notes given between
County Boundary & Harris & Montgomery Co