

249-10-253

Corrected Field Notes of  
West Boundary Line  
of  
Hartley County Texas

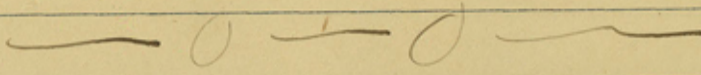

State of Texas } In matters of corrected field  
County of Hartley } notes of West Boundary  
line of Hartley County

Be it remembered that whereas the location of  
the west boundary line of Hartley County was  
incomplete in this, said location did not give  
the distance of the several corners of the different  
surveys along the line of said West Boundary and  
whereas Mr. E. F. Batts the surveyor who established  
said line for Hartley County was by an order of this  
Court required to make corrected field notes & map of  
said line showing the distance between the corners  
of the several surveys along said line and it ap-  
pearing to the Court that said field notes & map have  
been so corrected & has been filed by said survey-  
or and that the same has been duly recorded by the  
County clerk, It is therefore ordered by the Court that  
corrected field notes & map of said West boundary  
line as returned & corrected by Mr. E. F. Batts  
Surveyor and recorded by the County clerk are  
hereby accepted, approved & adopted  
the said field notes & map are  
as follows. ---

Hartley Co Bdry Line 4A



Corrected Field Notes of the West Boundary Line  
of  
Hartley County Texas

Beginning at a Stone set in Line of  
New Mexico and Texas bound-  
ary Line being East boundary  
of New Mexico and West  
Line of Texas

Said Stone is 30 miles South  
from a cedar Post and flat  
rock set in the ground.

Post marked on West Side  
N.M.L., 103. 1859.

And on East Side X T L A. BOBO  
A D 1859, being the North West  
Corner of the Pan Handle of Texas  
Said Stone is marked on North  
side D<sup>M</sup> and on South Side H<sup>X</sup>

Thence South at 1324 Varas a mound  
the South West corner of Survey  
123 Capitol Land

At 1900.8 Varas Stone marked 1

Thence South 1900.8 Varas Mound 2 cut  
in the sod

Thence South 1900 Varas Mound 3  
cut in sod



- 1 Thence South at 1454 Vas the South West  
 2 Corner of Survey No 136 Capitol Land  
 3 At 1900.8 Vasas Mound 4 cut in sod  
 4  
 5 Thence South at 1900.8 Vasas Mound 5 cut in sod  
 6  
 7 Thence South 1900.8 Vasas Mound 6 cut in sod  
 8  
 9 Thence South 1440 Vasas cross Agua Media Creek  
 10 At 1900.8 Vasas Mound 7 cut in sod  
 11  
 12 Thence South 1900.8 Vasas Mound 8 cut in sod  
 13  
 14 Thence South at 720 Vasas cross Springer  
 15 and Tascosa Road.  
 16 At 1584 Vasas the South West  
 17 Corner of Survey No 149 Capitol  
 18 Lands.  
 19 At 1900.8 Vasas Mound 9 cut in sod  
 20  
 21 Thence South, 1900.8 Vasas Mound 10 cut in sod  
 22  
 23 Thence South 1900.8 Vasas Mound 11 cut in sod.  
 24  
 25 Thence South 1900.8 Vasas Mound 12 cut in sod  
 26  
 27 Thence South at 1713 Vasas the SW corner of  
 28 Survey No 164 Capitol Lands  
 29 At 1900.8 Vasas Mound 13 cut in sod  
 30  
 31 Thence South 1900.8 Vasas Mound 14 cut in sod  
 32



- 1 Thence South at 602 Varas the South West  
2 Corner of Durvey No 7 Block X R. W M D Lee  
3 At 1900.8 Varas Mound 15 cut in sod
- 4
- 5 Thence South 396 Varas cross Bonilla Creek  
6 At 1391 Varas the South West Corner of  
7 Durvey No 4 Block X R W M D Lee  
8 At 1900.8 Varas Mound 16 cut  
9 in the sod
- 10
- 11 Thence South 1900.8 Varas Mound 17 cut in sod
- 12
- 13 Thence South at 280 Varas the South West Corner  
14 of Durvey No 13 Block X R. W M D Lee  
15 At 1900.8 Varas mound 18 cut in sod
- 16
- 17 Thence South at 1019 Varas the South West  
18 Corner of Durvey No 17 Block  
19 X R W M D Lee  
20 At 1584 Varas cross Antrana Cr  
21 At 1900.8 Varas Mound 19 cut in sod
- 22
- 23 Thence South at 1858 Varas a point the  
24 South West Corner of Sec 17 in said Blk  
25 At 1900.8 Varas Mound 20 cut in sod
- 26 Thence South at 1900.8 Varas <sup>mud</sup> 21 cut in sod
- 27 Thence South at 746 Varas the South West  
28 Corner of Durvey No 28 W M D Lee Land  
29 At 1900.8 Varas Mound 22 cut in sod
- 30
- 31 Thence South at 1536 Varas the South West Corner  
32 of Durvey No 30 Blk X R W M D Lee Land



1 at 1900.8 Saras Mound 23 cut in sod

2  
3 Thence South at 1878 Saras the South West  
4 corner of Durrey No 41 Block X R  
5 W M D Lee land.

6 At 1900.8 Saras Mound 24 cut in sod

7  
8 Thence South 1900.8 Saras Mound 25 cut in sod

9  
10 Thence South at 1080<sup>Saras</sup> the SW corner of Durrey 42  
11 Block X R W M D Lee land.

12 At 1900.8 Saras Mound 26 cut in sod

13  
14 Thence South 1900.8 Saras Mound 27 cut  
15 in sod

16  
17 Thence South at 291 Saras the South West  
18 corner of Durrey No 62 Blk X R  
19 W M D Lee land

20 At 1900.8 Saras Mound 28 cut in sod

21  
22 Thence South at 124 Saras cross  
23 Minnosa Creek

24 At 1168 Saras N W Corner of Cap-  
25 itol League 194. whence the N E  
26 corner of Capitol League 195 bears  
27 East 5 miles and 184 Saras said  
28 corner being 3 Large Rocks

29 At 1900.8 Saras Mound 29 cut  
30 in the sod

1 Thence South 1900.8 Varas to Large Rock  
2 marked on North side S.W. HX  
3 and on South side N.W. O<sup>m</sup>  
4 said Stone being the South  
5 West Corner of Hartley County  
6 and the North West Corner of  
7 Oldham County  
8  
9  
10  
11  
12  
13  
14  
15  
16  
17  
18  
19  
20  
21  
22  
23  
24  
25  
26  
27  
28  
29  
30  
31  
32

1 State of Texas }  
2 County of Hartley } I E. F. Bate a  
3 practical Surveyor duly appointed  
4 and qualified to establish the  
5 West boundary line of Hartley County  
6 do hereby certify that the corrected  
7 field notes and a map of the  
8 West boundary line of said County  
9 as appears above, made in ac-  
10 cordance with an order passed by  
11 said Court requiring me to correct  
12 said field notes and map so as  
13 to show the distance to the corners  
14 of the different tracts of land crossed  
15 by or adjacent to said boundary  
16 are true and correct as they appear  
17 on said map and <sup>in said</sup> field notes  
18 and that the work was actually  
19 done by me on the ground according  
20 to law and that the Corner lines bound-  
21 -aries and marks of same whether  
22 natural or artificial are correctly  
23 described and set forth in foregoing  
24 plat and field notes as they appear  
25 on the ground

26 Date of Original Survey from Dec 1<sup>st</sup> 1891  
27 to Dec 31<sup>st</sup> 1891

28 Correction Made Nov 1<sup>st</sup> 1893 to Nov 30<sup>th</sup> 1893

29 E. F. Bate  
30 Surveyor  
31  
32

1 The State of Texas }  
2 County of Hottel } J. I. Ben Lawson Clerk  
3 of the County Court in and for  
4 Hottel County Texas. Do hereby certify that  
5 the Libers and foregoing is a true and  
6 correct copy of the corrected map and field  
7 notes of the West Boundary line of Hottel  
8 County, and order of the Commissioners Court  
9 of said county approving said corrected map  
10 and field notes as the same appears of  
11 record in minutes of said court Vol. 1  
12 Pages 249 to 253

13 Given under my hand and  
14 official seal. This 21<sup>st</sup> day of December  
15 A.D. 1893

16 J. I. Ben Lawson

17 Clerk County Court Hottel Co. Tex.  
18 + Ex officio Clerk of Commissioners Court



Hartley Co. Bdry. (4c)

Corrected map and  
Field notes of the  
West Boundary Line  
of Hartley County, Tex.

Filed in Genl. S'd Office  
Jan'y 3<sup>rd</sup> 1894

4c.

Examined and Approved  
Jan'y 3<sup>rd</sup> 1894

G. N. Beaumont

See copy of Decree of Court  
Filed 3-10-1909

Hartley Co. Bary Line 4A

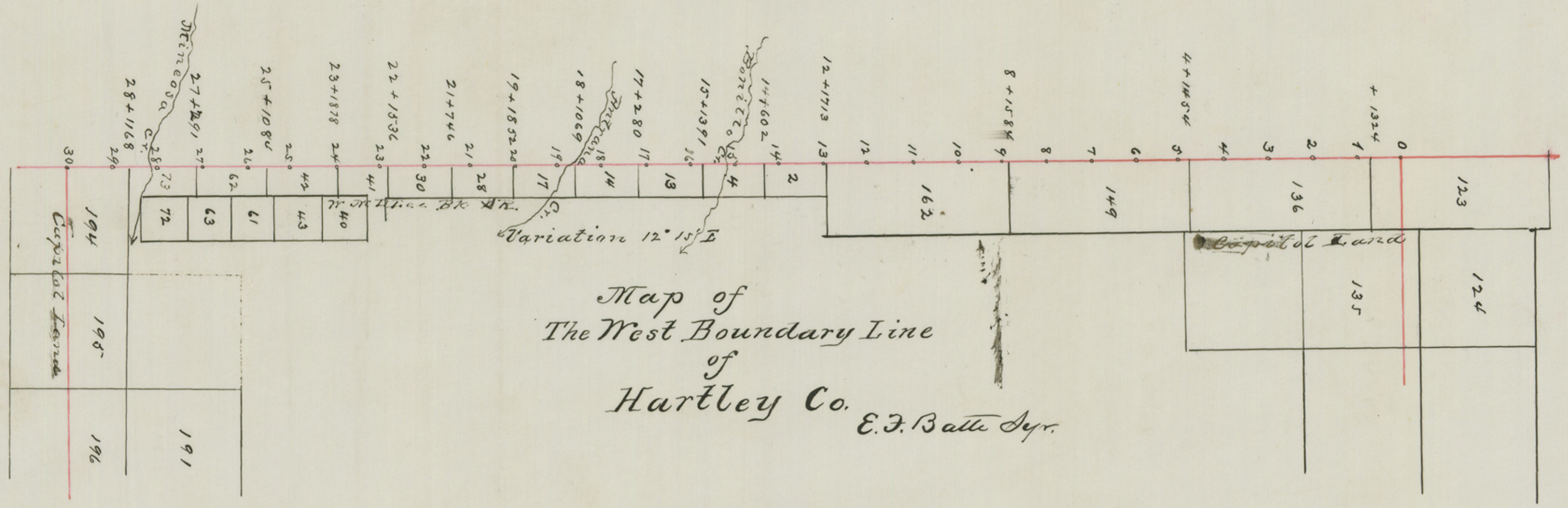

Map of  
The West Boundary Line  
of  
Hartley Co. E. F. Bath Sur.

4A \* 500 \* 1000 \* 1000