

LAMB CO.

HALE CO.

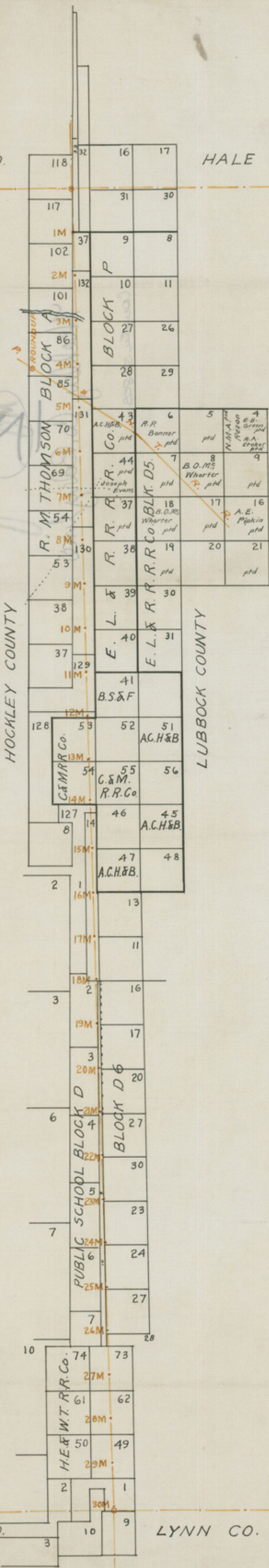

HOCKLEY COUNTY

LUBBOCK COUNTY

TERRY CO.

LYNN CO.

GENERAL LAND OFFICE
 Austin Texas March 14-1914
 Scale 1 Inch = 4000 Varas.

Plat of County Line between Lubbock and Hockley Counties, according to recent compilation of map of Hockley county dated February 1914 and now in use as the official map. Compiled and drawn by J.W. Pritchett, Draftsman.

M

drawn by A.M. Pritchett, Draftsman.
 is the official map. Compiled and
 dated February 1914 and now in use
 compilation of maps of Hockley County
 and Hockley Counties, according to recent
 Plat of County Line between Lubbock
 Scale 1 inch = 4000 feet.
 Austin Texas March 14-1914
 GENERAL LAND OFFICE

