

9/
County Boundary
Collin & Hunt

Filed in Genl
Land Office Oct 26th
1894 (8) (5)

~~Hunt Co Bdry Line 9~~

Examined, approved &
adopted;
Abstract corrected

North

Map of Line between the Counties of
Hunt & Collin

of 80° E.

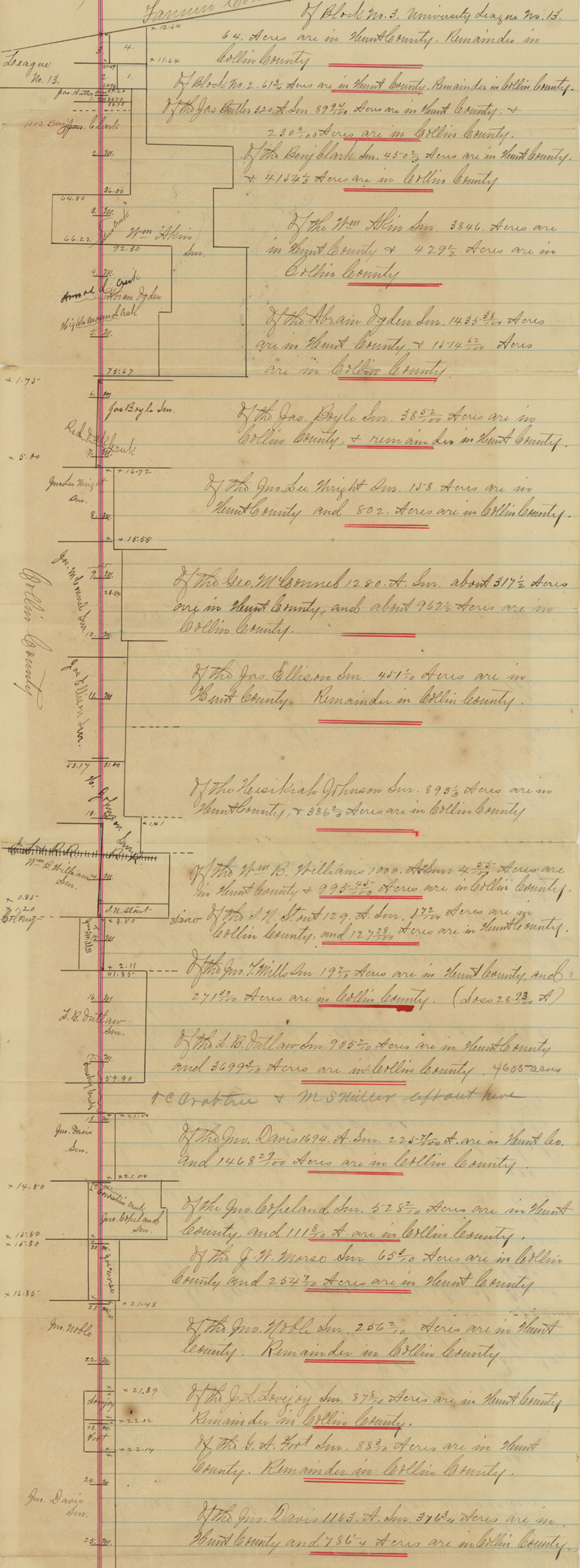

In getting above results, patent distances have been used.

Distances given in Gunter Chains

Scale 100 Chains to 1. inch

The blue line represents the county line.

South

State of Texas J. A. Smith Clerk of the Court,
Hunt County Court in and for Hunt County Texas
do hereby Certify that the above and foregoing
is a true and correct Copy of the Field Notes of
the Boundary Line between the Counties of
Collin & Hunt as established by W. H. Kieck
& M. H. Byrne duly appointed surveyors of said
line with the accompanying diagrams as
the same appears of Record in Book F. page
6 of the Mortgage & Miscellaneous Records of
Hunt County Texas. Given under my hand and
the seal of said Court this 25 day of October
1894.

By J. A. Smith Clerk of
M. Cameron Depty the County Court Hunt Co. Texas.

In the Matter of the Report of J. May 11 1886.
W. H. Kieck and M. H. Byrne & now on this day
Came on to be heard the Report of W. H. Kieck
and M. H. Byrne surveyors heretofore appoint-
ed by the Commissioners Courts of Hunt
and Collin Counties to survey and establish
the Boundary Line between said Counties
and said Report having been examined
and fully heard. His ordered by the Court
that the same be approved and in all
things confirmed and is ordered that
said Report and accompanying plats
be recorded and that the County Clerk
make a duly Certified Copy of the
same and forward to the Commissioners
of the General Land Office of the State
of Texas.

State of Texas J. A. Smith Clerk of
Hunt County the County Court in and
for Hunt County Texas do hereby certify
that the above and foregoing is a true
and correct Copy of the order of the
Commissioners Court of Hunt County
Texas approving the Report of the surveyors
of the Boundary Line between the Counties
of Hunt & Collin as the same appears
of Record in Book C. page 436 of
the minutes of the Commissioners Court
of Hunt County Texas. Given under
my hand and seal of said Court this
25 day of Oct. 1894.

By J. A. Smith Ct.
M. Cameron Depty Co. Court Hunt Co. Texas.

of "Copy" - pay 1.2
HUNT
CO.
4
7
Collin Co. P. D. G.

Plot of Collin
and
Hunt County
Land

Filed May 11th A.D. 1886.
Recorded July 15th A.D. 1886.
J. G. Byrd, clerk

Field Notes of the Eastern Boundary Line of
Collin County, and a portion of the Western
Boundary Line of Hunt County

State of Texas } To the Hon. Commissioners
County of Hunt } Court of Hunt County Texas

Whereas at the Nov. Term A. D. 1885-

the Commissioners Court of Hunt County, appointed
H. J. Kinney County Sur. of said County, to survey
the Boundary Line, between the Counties of Hunt
and Collin, and upon notice thereof, the
Commissioners Court of Collin County, appointed
W. H. Byrne, County Surveyor, of Collin County,
to represent said County, in the Survey of the
Boundary Line, between the said Counties of
Hunt and Collin

We the undersigned, surveyors above
mentioned, most respectfully report, that we
met, by mutual agreement, on the 24th day of
February A. D. 1886, and after mature deliberation,
we established the N. W. Cor. of Hunt Co. and
the Eastern N. E. Cor. of Collin Co., at a point on
that portion of the South Boundary Line of
Hunt Co., which was established by Jas.
Wilson and M. Keithley, September A. D. 1882;
at said point we set a Bois D'Arc post 5 feet long
and 8 inches square, 3 feet in the ground, said post
is marked NW NE, and from which a Mulberry
marked H.C. on N. side and C.C. on S. side, bears
S. 3° W. 52. links, an Elm 10. in. diam., marked H.C.
on N. side, and C.C. on S. side, bears S. 14 1/2° E. 69
links, and the Eastern N. E. Cor. of Collin Co. as

N. W. Cor.
Hunt Co.
+
E. N. E. Cor.
Collin Co.

Miles chains set by G. W. Woyes, bears N. $81\frac{3}{4}^{\circ}$ E. 2120 $\frac{1}{2}$ links,
and the N. E. Cor. of Block No. 3. University League
No. 13. bears N. $81\frac{3}{4}^{\circ}$ E. 1264. links

Thence South at

37.31 The S. B. Line, of said Block No. 3. 1164. links N.
of the S. E. Cor. of same, and 2149. links N. of the
N. E. Cor. of Block No. 2. said League. at

66.41 The S. B. Line of said Block No. 2. 2096. links N.
of the S. E. Cor. of same, and 3920. links N. of the
N. E. Cor. of the J. W. Butler Sur. of 320. Acres, at

74.00 a point about 20. feet E. of the E. end of the
Boorman's residence. at

80.00 Set 1st Mile post, from which an Elm, standing
in a branch, and 12. in. diam. marked X. bears
S. $74\frac{1}{2}^{\circ}$ W. 291. links, an Elm 12. in. diam. marked
H. bears S. $76\frac{3}{4}^{\circ}$ W. 267. links.

1st Mile

Thence continued South at

9.50 The S. B. Line of said Butler Sur. 3870. links N.
of the S. E. Cor. of same, and the N. E. Cor. of the
Benj Clark League and Labor Survey. at

23.23 another N. B. Line of said Clark Sur. at

61.00 a point about $3\frac{1}{2}$ chs N. of G. B. Whelis' residence at

80.00 set the 2^d Mile post in said Whelis' field, from
which an Elm 8. in. diam. marked C. on N. side
and H. on E. side, bears S. $46\frac{1}{2}^{\circ}$ E. 430. links, an
Elm 12. in. diam. marked C. on N. side and H.
on E. side, bears S. 20° E. 549. links.

2^d M.

Thence continued South at

53.50 The S. B. Line of said Clark Sur. 3600. links N. of
the S. E. Cor. of same, and 6480. links E. of the
most Western N. W. Cor. of the W^m Akm 24137360.

2^d M. chains sq. or. Sur. at
 80.00 Set the 3^d mile post, in small lake, in timber, from
 which an Elm 12. in. diam. marked H.C. bears S. 88° E.
 25½ links, an Ash marked H.C. bears N. 24½° W.
 43¾ links

3^d M. Thence continued South at
 4.50 Lees Creek course S. W. at
 9.50 same creek course S. E. at
 12.00 W. bank of same at
 17.00 leave said Lees Creek at
 39.00 the S. B. Line of said Akin Sur. 6622. links E.
 of the most Western S. W. Cor. of same, and
 9230. links W. of the N. E. Cor. of the Abram Ogden
 Sur. at

80.00 Set the 4th mile post, in timber, from which an
 Elm 6. in. diam. marked C bears S. 27° W. 7. links
 a double Elm 5. + 7. in. diam. marked H.C. bears
 N. 23° W. 5. links

4th M. Thence continued South at
 26.55 the center of Arnold Creek, course S. W. at
 62.50 the center of High Mound Creek, course S. W. at
 80.00 Set the 5th mile ^{post} in Mrs. Parker's field, from which
 an Elm 12. in. diam. marked H.C. bears N. 6°-10'
 W. 584. links an Elm 12. in. diam. marked X
 bears N. 6°-10' W. 485. links

5th M. Thence continued South at
 — touch the E. end of Mrs. Parker's residence, at
 51.25 the S. B. Line of the said Ogden Sur. 7567. links
 W. of the most Southern S. E. Cor. of same. at
 54.75 the N. B. Line of Gas Boyle Sur. 175. links E. of
 the N. W. Cor. of same. at
 80.00 Set the 6th mile post in Harrison's pasture

1

from which a double Hackberry 10. + 12. in.
 6th M. chain diam. marked H.C. bears S. 22° E. 517. links.
 Thence Continued South at
 64.50 the center of Red Oak Creek, course N. W. at
 80.50 set the 7th mile post, from which an Elm 7. in. diam.
 marked H.C. bears S. 33° E. 28. links, a Burr Oak
 20. in. diam. standing in a branch, and marked
 7th M. H.C. bears N. 5½° E. 115. links.
 Thence Continued South at
 12.79 the S.B. line of said Boyles Sur. 500. links
 E. of the S.W. Cor. of same, and 1672. links N.
 of the N.E. Cor. of the Gov. Lee Thright 960. Acre
 Sur. at
 79.50 set the 8th mile post, on the N. side of a ravine
 in H. M. Markham's pasture, and from which
 a Spanish Oak 24. in. diam. marked H.C. bears
 S. 20° W. 80. links, a Pecan 6. in. diam. marked
 8th M. H.C. bears S. 29½° W. 41. links
 Thence Continued South at
 32.50 the S.B. line of said Thright Sur. 1555. links
 N. of the S.E. Cor. of same, and a Corner of the
 Geo. McConnell 1280. Acre Sur. at
 80.00 chains set the 9th mile post in H. M. Markham's
 pasture, from which a Pecan 30. inches diam.
 marked H.C. bears S. 77¾° W. 600. links a Pecan
 18. inches diam, standing on N. side of a branch,
 and marked H.C. bears S. 1457. links.
 9th M. Thence Continued South at
 28.15 chains, a point 2104. links N. of G. W. Hayes 14
th mile post, and 2354. links N. of the S.B. line
 of the said McConnell Sur. at
 72.22 chains, the center of lane, N. of Geo. Honaker's field at

80.00 chains, set the 10th mile post, in said Honaker's field,
from which a Pecan 24. inches diam., marked H.C.
bears N. 84° E. 998. links.

10th M.
Thence Continued South at
80.00 chains, set the 11th mile post, in a pasture, from
which an Elm. 8. inches diam. marked H.C.
bears S. 47½° W. 577. links

11th M.
Thence Continuing South at
80.00 chains set the 12th mile post in J. C. Dorton's meadow
from which the center of a well, in said meadow,
bears S. 72½° E. 459. links, and the brick chimney
in Mart Rollin's new residence, bears S. 28° E.

12th M.
Thence Continued South at
3.20 chains, the S. B. line of the Gas Ellison Sur.
3100. links N. of the S. E. Cor. of same, and the
most northern N. E. Cor. of the Heseiah Johnson
1280. A. Survey, and 5317. links E. of the N. W.
Cor. of said Johnson Sur.

13th M.
80.00 chains, set the 13th mile post in said Rollin's field,
from which the aforesaid chimney in his new
residence, bears N. 54° - 50' E. and a Hackberry
20. inches diam. marked H.C. bears S. 8° W. 1178.
links

Thence Continued South at
3.35 chains, the N. B. line of the W. B. Williams
1000. A. Sur. 141. links N. of the N. E. Cor. of same,
and also an inside Cor. of the said Johnson Sur.

49.65 chains, intersect the East Line Rail Road, about
30. feet E. of the 684th mile post.

80.00 chains set the 14th mile post, in a road, and in a
South Westerly direction, from the County Line School
House, and from which an Elm 8. inches diam.

14th M.

marked H.C. bears S. 17° W. 434. links

35.00 Hence continued South at chains, the S.B. line of the said Johnson Sur. 85. links E. of the S.W. Cor. of the same, and the N.W. Cor. of the C.W. Stout 129. A. Sur. at

47.00 chains, the N.B. line of Mercers Colony, 120. links E. of the S.W. Cor. said Stout Sur. and 350. links N. of the N.E. Cor. of the J. L. Mills 320. Acre Sur. at

62.00 chains, pass just E. of a round grove of Hackberry trees at

80.00 chains set the 15th mile post, from which an Elm 8. inches diam. marked H.C. bears N. 52 1/2° W. 125. links, an Elm 10. inches diam. marked H.C. bears S. 34 1/2° E. 110. links

15th M.

Hence continued South at

37.27 chains the S.B. line of the said Mills Sur. 211. links N. of the S.E. Cor. of same, and 6185. links N. of the N.E. Cor. of the S.B. Outlaw ^{outlaw} 3/4 League and Labor Sur. at

80.00 chains, set the 16th mile post, in Brushy Creek Timber, from which an Elm 10. inches diam. marked H.C. bears N. 60 1/4° E. 65. links and an Elm 15. inches diam. marked H.C. bears N. 76 1/4° W. 75. links.

16th M.

Hence continued South at

77.40 chains, center of Brushy ^{brush} course S.E. at

80.00 chains, set the 17th mile post, in timber, from which a Spanish Oak 30. inches diam. marked H.C. bears S. 2 1/2° W. 49. links, and a Spanish Oak 15. inches diam. marked H.C. bears N. 22 1/2° W. 70. links

17th M.

Hence continued South at

- 17th of 1876. 9.50 chains, Brushy creek, course West at
 26.35 chains, a point on the S.B. line of the said
 Dutlaw Sur. from which an Elm marked H.C.L.
 bears N. 3. links, and the S.E. Cor. of the said
 Dutlaw Sur. bears E. 3-990. links, at
 40.00 chains, touch the East bank of Brushy creek, at
 43.60 chains, the N.B. line of the John Davis 1694.
 Acre Sur. about 2100. links N. of the N.E. Cor.
 of same at
 44.00 chains, Brushy creek course East at
 58.00 chains, Brushy creek course S.W. at
 60.20 chains, Brushy creek course S.E. at
 80.00 chains, set the 18th mile post, in timber, from which
 an Elm 20. inches diam. marked H.C. bears S. 6 $\frac{3}{4}$ ° W.
 131. links, and an Ash 12. inches diam. marked
 H.C. bears S. 24 $\frac{3}{4}$ ° E. 97. links
 18th of 1876. Thence continuing South at
 77.27 chains, the S.B. line of the said John Davis Sur.
 about 2100. links N. of the S.E. Cor. of same, and
 also 1480. links E. of the N.W. Cor. of the John
 Copeland Survey of 640. Acres. at
 80.00 chains set the 19th mile post, in timber, from which
 an Elm 14. inches diam. marked H.C. bears N. 11 $\frac{3}{4}$ ° E.
 24. links and an Elm 11. inches in diameter marked
 H.C. bears N. 7° W. 35. links
 19th of 1876. Thence continued South at
 3.85 chains low Skin creek course S.E. at
 10.00 chains prairie at
 76.47 chains the S.B. line of the John Copeland Sur.
 1580. links E. of the S.W. Cor. thereof, and the N.W.
 Cor. of the James W. Morse 320. A. Sur. at
 80.00 chains set the 20th mile post, in prairie, from

20th Mf. which a mulberry 14. inches diam., marked H. C. bears S. 1^o W. 871. links

40.17 chains, a point 2137. links N. of Co. W. Woyes 5th mile post. at

76.49 chains, the S.B. line of the said Jas. W. Morse Sur. 1685. links E. of the S.W. Cor. thereof and 2148. links N. of the N.E. Cor. of the John Noble Survey, at

80.00 chains, set the 21st mile post, in prairie, from which a Hackberry 10. inches diam. marked H.C. bears S. 20³/₄° W. 242. links.

21st Mf.

80.00 chains, set the 22nd mile post, in prairie, from which the chimney of Mr. Carlyle's residence bears S. 84° E.

22nd Mf.

34.66 chains, the S.B. line of the said John Noble Sur. 2189. links N. of the S.E. Cor. of same, and the N.E. Cor. of the J. L. Lovejoy 160. A. Sur. at

74.66 chains the S.B. line of the said Lovejoy Sur. 2202. links N. of the S.E. Cor. of same, and the N.E. Cor. of the G. A. Foot 160. Acre Survey at

80.00 chains set the 23rd mile post, in prairie, no timber near

23rd Mf.

34.66 chains, the S.B. line of the said Foot Sur. 2214. links N. of the S.E. Cor. of same, and the N.E. Cor. of the John Davis 1163. Acre Survey at

80.00 chains, set the 24th mile post, in Fletcher Johnson's field, no timber near.

24th Mf.

80.00 chains, set the 25th mile post, in meadow, no timber near

25th Mf.

28-116

42.35

S.E. Cor.
of
Collin Co.

Thence continued south at
 chains, set for the S.E. Cor. of Collin County,
 a Bois D'Arc post, 5 feet long, 8 inches square,
 3 feet in the ground, and marked ^HWB on the
 East face, and ^SE on the N.W. face, from
 said post, the S.E. Cor. of Collin County as
 set by C.W. Woyes, bears $\text{S. } 22.74 \text{ } ^\circ \text{ E}$ chains
 Variation $8^\circ 3' \text{ East}$ (Kinney's instrument)

The end of each mile, is marked by a Bois
 D'Arc post, 5 feet in length, and 8 inches
 square, set 3 feet in the ground.

In the West face of each post, was
 placed, the letter C.; on the East face was
 placed the letter H. and on the North face
 was placed the number of the mile post.

W. H. Byrne County Surveyor Collin Co. Texas

W. J. Kinney Sur. Hunt Co. Texas

State of Texas } We W. H. Byrne, Surveyor
 County of Hunt } for Collin Co. and W. J. Kinney
 Surveyor for Hunt Co., do hereby
 certify, that the foregoing pages, are correct
 field notes of the Boundary Line between
 the Counties of Collin and Hunt, as established
 by us; that the line was carefully run,
 and objects of note, along the line, are noted
 in said field notes, and the diagram
 accompanying the same, is to the best of our
 knowledge, a correct map of the survey
 on either side of said line. The Survey
 was begun on the 24th day of February

A.D. 1886. and finished March the 6th
A.D. 1886.

J. W. Briscoe } chain
Dickson Boone } carriers

Robt. Bagley } Flagman

W. H. Byrne } markers.
H. G. Kincy }

The County Line is marked with 4 haches.

Witness our hands, this the 22^d day of March
A.D. 1886.

W. H. Byrne, County

Surveyor Collin County Texas

H. G. Kincy, County Sur. Hunt County Texas.

"Copy"

Approved May
11 1886.

Attest. J. C. Byrd
Co. Clerk

Geo Linn between
Collin & Hunt Co's

Filed in Genl
Land office Octo.
26th 1894.

Examined appli-
ed approved and
adopted

450

Filed for record the 11
day of May 1886 at
4 o'clock P. M. Recorded
in Book 7 of Rec. Page. 6.

T. A. SMITH, County Clerk.

Clerk notified Dec 11/94

Abstract corrected
see 94, Warren

Hart Co. Blk. 1st 79.