

V. G. RUNNION

COUNTY CLERK

HUNT COUNTY

GREENVILLE, TEXAS Nov. 18" 1922,

J. T. Robison, Com'r.  
Gen'l, Land Office,  
Austin, Texas.

Dear Sir:

I, am enclosing copy of the order of the Comr's Court of this County, approving report of surveyors establishing the boundary line between Hunt and HanZandt Counties entered on the 11" day of Feb. 1918, while I am sure that I either sent an original report of surveyors and copy of the order of the court at that time, but I am not sure that I did as I find no memorandum on the Comrs Court Docket to that effect, so I am sending a certified copy of one of the originals now on file and of record.

Yours very truly

*J. G. Hales*  
Deputy Co. Clerk.

RECEIVED

NOV 21 1922

*referred to map.*



In Commissioners Court of Hunt County, Texas, February, 11th 1919.

On this day came on to be considered the report of the Commissioners heretofore appointed to survey and establish the boundary line between Hunt and VanZandt County, which report is as follows to wit:

Field notes of that portion of the South Boundary Line of Hunt Co., Texas, which forms the North Boundary line of Van Zandt County, Texas, East to the Channel of Sabine river, from the N E corner of Kaufman County, Texas, as established by H. W. Kyser and H.Y. Kincy, in January 1892.

To the Hon County Court of Van Zandt and Hunt Counties, Texas: Whereas at the September term A. D. 1918, the County Court of Van Zandt County, Texas, appointed J W Bateman, County Surveyor of Van Zandt County, Texas, to survey and establish the Boundary Line between the Counties of Van Zandt and Hunt, and upon notice thereof, the Hon. County Court of Hunt County, Texas, appointed H Y Kincy County Surveyor, of said Hunt County to represent said County in the survey and establishment of the Boundary Line between the said Counties of Van Zandt and Hunt.

We the undersigned County Surveyors, appointed as above stated met on Monday the 18 day of November A D 1918, and surveyed and established the Boundary Line between the said Counties of Van Zandt and Hunt, as hereinafter described.

Beginning at the N E corner of Kaufman County, Texas, as established by H W Kyser and H.Y. Kincy in January 1892, a large Bois D'arc post marked N.E.K.C. on S side and H.C. on N side (original witness trees having been destroyed) we marked other witness trees to said corner as follows: A double post oak marked C. on S. prong, and H on N prong. brs. N 74 1/2 W 47 3/10 vrs, a post oak mkd V C brs S 31 1/4 E 65 1/3 vrs, a post oak marked K brs S 66 1/2 W 36 2/10 vrs a post oak mkd C brs S 64 1/2 W 36 vrs, also the S W Corner of the John Roark 320 acre survey, brs S 75 W 206 1/6 vrs, Thence East at 598 8/10 vrs set post on the E side of the Greenville and White Prairie public road from which a post oak marked X brs S 17 E 3 vrs, at 760 3/10 vrs intersect the E B line of said Roark Survey and the W B line of the H G. Brewer 320 acre survey 47 4/10 vrs N of their division corner at 967 vrs Duck creek C S at 1679 4/10 vrs intersect the E B line of said



Brewer Survey, and the W B line of the S L Davidson 320 acre survey, 44  $\frac{3}{10}$  vrs N of their dividing corner, at 1900  $\frac{8}{10}$  vrs set 1st mile post in Cox field from which a post oak mkd V C brs S  $9 \frac{1}{2}$  W  $46 \frac{8}{10}$  vrs; Thence Continue East at 568  $\frac{1}{4}$  vrs intersect the E B line of said Davidson Survey, and the W B line of the S F Pyle 320 acre survey a small Hack-berry line tree on the E side of the Wills Point and Greenville public road, 41  $\frac{6}{10}$  vrs. N. of the dividing corner of said surveys at 1500  $\frac{8}{100}$  vrs intersect the E B line of said Pyle survey and the W B line of the Jackson Fitzgerald 640 acre survey 38  $\frac{4}{10}$  vrs N of their dividing corner, at 1540  $\frac{5}{10}$  vrs a small Black Jack line tree, at 1900  $\frac{8}{10}$  vrs. set 2nd mile post in Paris field from which a Post Oak marked V C brs. S 1 E 29  $\frac{1}{4}$  vrs. Thence continue East at 726  $\frac{5}{10}$  vrs a B J line tree, at 1337  $\frac{6}{10}$  vrs. a Black Jack line tree at 1481  $\frac{4}{10}$  vrs intersect the E B line of said Fitzgerald Survey, and the W B line of the Texian S. McGee 160 acre survey, 11  $\frac{1}{2}$  vrs N of their dividing corner at 1900  $\frac{8}{10}$  vrs set 3rd mile post in Baileys pasture lot, from which a post oak marked V C brs S  $82 \frac{1}{2}$  E 5 vrs a post oak marked H C brs N  $86 \frac{3}{4}$  W  $9 \frac{7}{10}$  vrs, Thence continue East at 528  $\frac{6}{10}$  vrs intersect the E B line of said McGee Survey, and the W B line of the A Parham 320 acre survey, 22 vrs N of the S E corner of said McGee Survey, and 321  $\frac{8}{10}$  vrs S of the N W corner of said Parham survey, at 1270  $\frac{8}{10}$  vrs intersect E B line of said Parham survey, and the W B line of the Elegis Alvarado league survey 321  $\frac{8}{10}$  vrs S of their dividing corner, at 1604  $\frac{2}{10}$  vrs set stake on the East side of Wills Point and Hunt County public road at 1900  $\frac{8}{10}$  vrs set 4th mile post in Rinks field; Thence East at 590  $\frac{9}{10}$  vrs. pass 1  $\frac{3}{10}$  vrs N of small pecan tree in James Morris garden, W of his house through about the center of which the County lines run; Thence continue East at 1584 vrs a post oak line tree, at 1900  $\frac{8}{10}$  vrs set 5th post, from which small Black Jack marked H C brs N  $66 \frac{1}{2}$  W  $2 \frac{8}{10}$  vrs a B J marked V C brs S 47 W  $3 \frac{1}{6}$  vrs, Thence continue East at 202  $\frac{3}{10}$  vrs set stake on the W side of Wills Point and Quinlan public road 351- $\frac{7}{10}$  vrs S of the N B line of said Alvarado Survey, at 1900  $\frac{8}{10}$  vrs set



6th mile post in Sabine bottom from which a Post Oak marked V C brs S 70 W 1 6/10 vrs a Pin Oak marked H C brs N 78 3/4 W 6 1/10 vrs. Thence continue East 1076 vrs. an Elm line tree at 1418 4/10 vrs the E B line of said Alvarado survey and the W B line of the Z T Belew survey, 386 vrs S of their dividing corner at 1856 9/10 vrs intersect the Western E B line of said Belew Survey, and the W B line of the J D Raines 320 acre survey 69 1/3 S of the inside cor. of said Belew survey, and the N W corner of said Raines Survey at 1900 8/10 vrs set 7th mile post in Sabine bottom from which an Elm marked H C brs N 80 1/2 E 3 6/100 vrs, a post oak marked V C brs S 19 E 14 3/4 vrs, Thence continue East at 1866 1/3 vrs the E B line of said Raines survey, and the W B line of the R Earl -- acre survey, 84 1/4 vrs S of their dividing cor at 1900 8/10 vrs set 8th mile post, in Sabine Bottom from which a Hackberry marked H C brs N 1 W 2 97/100 vrs. an over cup oak, marked V C brs S 7 1/2 E 6 vrs, Thence continue East 81 4/10 vrs set post on the West bank of Sabine River from which a Burr Oak marked V C brs S 67 1/2 W 5 3/4 vrs, an Elm marked V C brs S 18 1/2 E 5 3/4 vrs, a Hack-berry marked H C brs N 77 1/2 W 8 3/4 vrs, Thence continue East, 11 vrs to a point in the channel of said Sabine River, which point we have established as the N E corner of Van Zandt and as the Southern S E Corner of Hunt County, variation 8\_15 E each mile post is marked V on the S side H on the N side and with the number of the mile which it ends on the W side.

J.W. Mc Donald                      Chain Carriers  
B.F. Brockaway

THE STATE OF TEXAS:

COUNTY OF HUNT:                      WE, J. W. Bateman, County Surveyor of Van Zandt Texas, and H.Y. Kincy County Surveyor of Hunt County, Texas, do hereby certify that the above and foregoing field notes of the Boundary line between the Counties of Van Zandt and Hunt, as established by us as surveyed and established by us on the 18, 19, 20, 21 and 22 days of November, A. D. 1918, and also the accompanying plat of same, are true and correct to the best of our knowledge and belief.



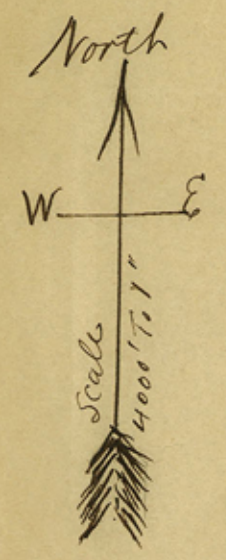

J. M. Coart 3320 a	Acres	6 1/2 a	in Van Zandt Co, Bel in Hunt Kaufman
H. C. Brewer	"	7 1/2 "	" " " " " " Hunt Co
S. L. Davidson	"	6 3/4 "	" " " " " " "
S. F. Pyle	"	6 1/10 "	" " " " " " "
J. Fitzgerald 640	"	8 1/10 "	" " " " " " "
J. M. Lee 160	"	2 1/10 "	" " " " " " "
A. Parkum	"	42 1/10 "	Hunt Co " Van Zandt Co
E. Alvarado League	"	367 2/10 "	" " " " " "
Z. T. Pelew	"	65 2/10 "	Van Zandt " Hunt Co
J. D. Rous 370	"	25 8/10 "	Hunt " " Van Zandt Co
R. Earl	"	1 "	" " " " " "

Hunt County

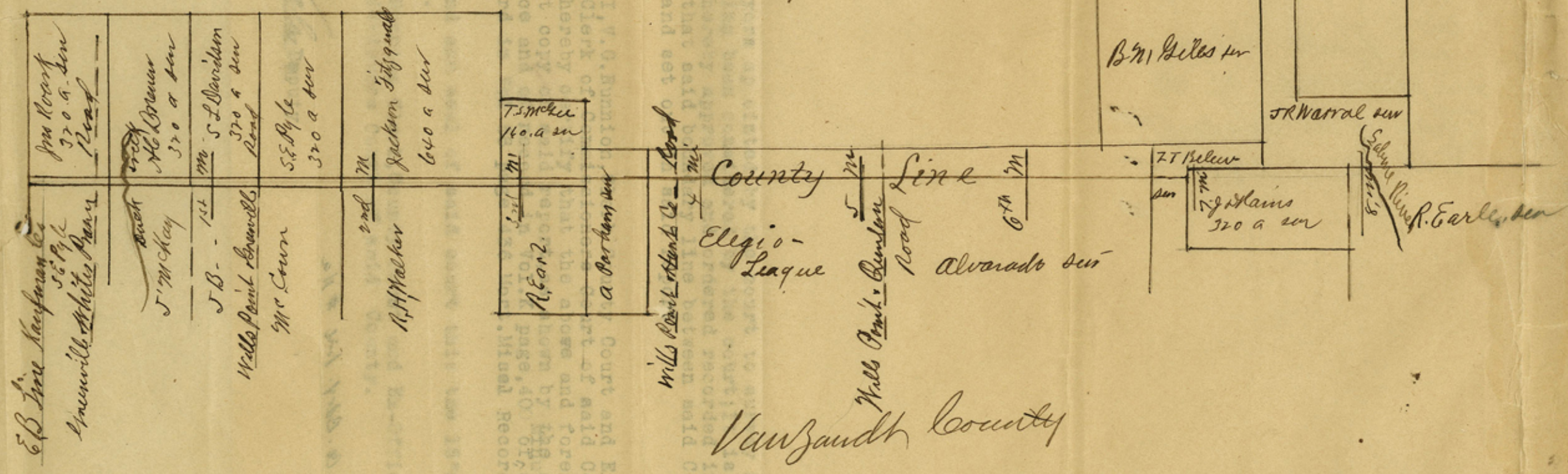

Van Zandt County

This the 29 day of November, A. D. 1918.

H. Y. Kinsey, County Surveyor of Hunt Co. Texas  
 J. W. Bateman, County Surveyor of Van Zandt County, Texas.



*Handwritten notes and signatures, possibly related to a survey or legal proceeding.*

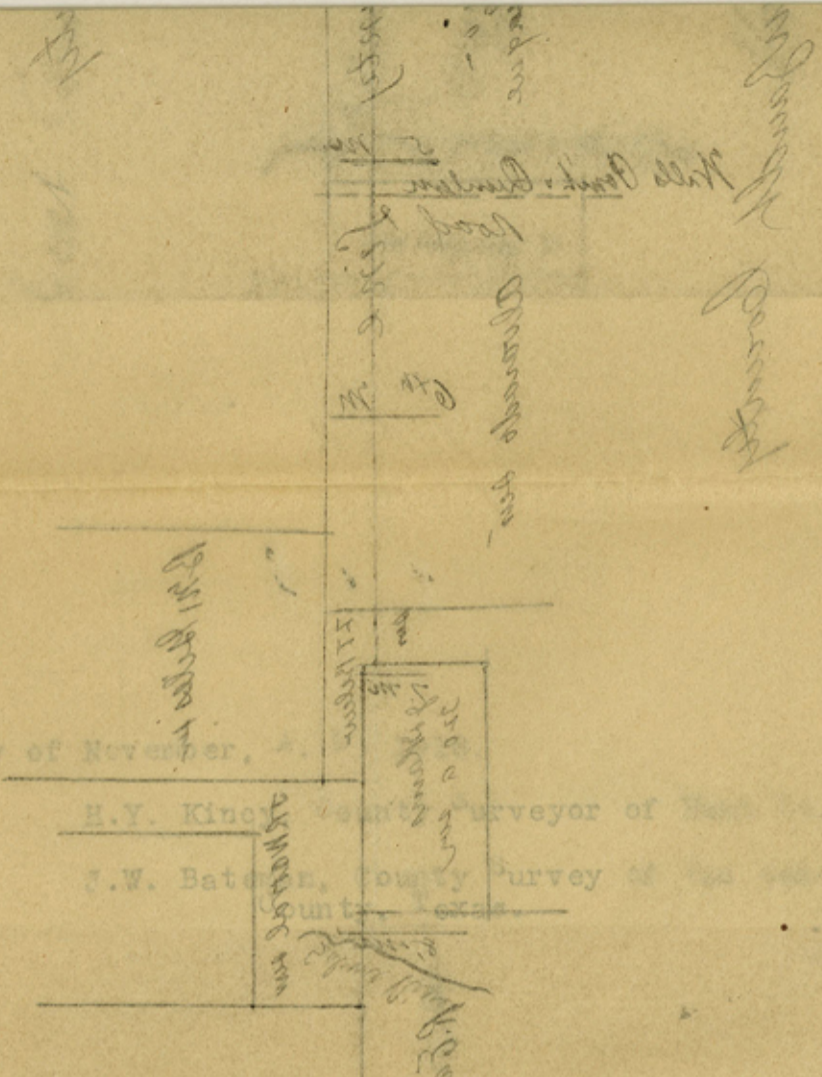

This 18th day of November, 1922.

H.Y. Kincaid, Surveyor of Hunt County  
 J.W. Bate, County Surveyor of said County

*Faint, mostly illegible handwritten notes covering a large portion of the middle section of the page.*

And said report of Surveyors appointed by the court to survey and establish said boundary line, having been considered by the court; It is ordered that said report be and is hereby approved and ordered recorded in the Minutes of said Court, and that said boundary line between said Counties be established as surveyed and set out in said report.

The State of Texas, I, V.G. Runnion, Clerk County Court and Ex-Officio County of Hunt. Clerk of Commissioners Court of said County, do hereby certify that the above and foregoing is a full, true and correct copy of said report, as shown by the original now on file in my office and of record in Vol. K page, 400 <sup>Minutes</sup> of said Court, and also of record in Vol 88 page 436 Mort. Miscel Records of said County.

Given under my hand and seal of said court this the 18th day of November, A.D. 1922.

V.G. Runnion Clerk, County Court and Ex-Officio Clk. Commissioners Court of said County.

By *[Signature]* Deputy



112/ Hunt Co Bdry Line 11a  
Hunt Co. Bdry Line

<sup>21</sup>  
County Boundary  
Between  
HUNT & VAN ZANDT  
— COUNTIES —

Filed November 21/22  
J. T. Robison, Comr-  
Sd Clerk Clk.

These 7 notes are a  
Duplicate copy of the  
7 notes of this Boundary  
Filed 11-7-1919-

This the 29 day of November, A. D. 1918.  
J. T. Robison, County Surveyor of Hunt Co. Texas  
J. W. Bateman, County Surveyor of Van Zandt  
County, Texas



Commissioners Court of said County  
J. T. Robison, Clerk, County Court and Ex-Officio  
Commissioner  
J. W. Bateman, County Surveyor of Van Zandt  
County, Texas  
The State of Texas, J. T. Robison, Clerk County Court and Ex-Officio  
Commissioner  
J. W. Bateman, County Surveyor of Van Zandt  
County, Texas  
I hereby certify that the above and foregoing is  
a true and correct copy of said report, as shown by the  
minutes of said court, and the said report is filed in  
the office of the County Clerk of said County, Texas,  
this 21st day of November, A. D. 1922.