

Jackson Bdry <sup>2</sup> line  
Co line, between  
Jackson  
&  
Wharton

---

Filed in this Office  
Aug 4<sup>th</sup> 1887

---

See endorsement on file  
Notes

Oct 25/87 G. M. Beaumont

---

Abstract corrected and a  
copy for'd Comp<sup>r</sup> of Pub.  
Accts  
Jan'y 24<sup>th</sup> /88 G. M. Beaumont  
Court Clerk

---

Jackson Co. Abstract

Jan'y 25/88

Beaumont

To The Honorable County Court of Jackson County  
 The undersigned P.P. Putnam County Surveyor  
 of Jackson County. Reports, that in pursuance of  
 an Order of The County Court of Said County made at  
 the April Term 1886, That he proceeded at the time  
 and place fixed by Said Order to Survey establish  
 and mark the line between Jackson and Wharton at the S.  
 W. Corner of the latter County and the East Corner of Jackson  
 and N. W. Corner of Matagorda, (The Wharton Co Surveyor not  
 meeting me at the Appointed time), and after having run the  
 same did afterwards meet, (the 15<sup>th</sup> June 1886,) H. J. Schley Co  
 Surveyor of Wharton County and Fred S. Robbins Co. Surveyor  
 of Matagorda County, and together with the undersigned  
 agreed to the Establishment of Said Corner and The Said  
 H. J. Schley Co. Surveyor of Wharton County who agreed to  
 the running of the line between Jackson and Wharton  
 Counties as evidenced by an agreement signed in duplicate  
 and of the Field Notes and Map, a copy of which is as follows:  
 Beginning at an Iron Post, Part of a Rail Road T Rail 7 feet  
 long and set 3 1/2 ft. in the ground, in the same place that a live  
 oak post was set (which now was broken down & in a thick growth  
 of Live Oak Bushes) by J. B. Collingworth in April 1861 near a  
 live Oak Burn, for the South Corner of Wharton County, and the  
 same point, that Geo. W. Brackensridge run from for Jackson and  
 Matagorda County line in <sup>the</sup> same year, as per Order from their respective  
 County Courts. Said Corner is between two Branches of the East  
 Carancahua, from which the N. E. Corner of the Lane White 320 acre  
 Survey Bns. N. 45° W. 600 Pcs. and the E. Boundary line of said Sur.  
 Bns. West 430 Pcs. and a Point 245 Pcs. E. of the S. E. Corner  
 of said Survey Bns. South 2 3/4° W. 956 Pcs. and the W. Branch of the E.  
 Carancahua Creek Bns. S. 2 3/4° W. 2990 Pcs. and the North line of the 2<sup>d</sup> S.  
 Murphy Survey at a Point 690 Pcs. East of its N. W. Corner Bns. S. 3 3/4° W.  
 3032 Pcs. -

Thence North 45° West (Dev. 8° 45' E.)  
 at 600 Pcs. N. E. Cor. of Lane White's Sur. and S. line of S. A. & M. G. R. R. Co. 640  
 Counter 55421

W

- acres tract, No 1, 556 was from its S. E. Corner  
 at 1819 as. Through, mostly live Oak & Pin Oak follow a Branch of the  
 East Caran coveau
- " 1829 as. a live Oak Blazed on 3 sides & was N. E. of line
- " 1 mile a Cypress post 8 in Square, 5 ft long, and set 3 ft in  
 the ground with a mound around same, Marked, with  
 letters cut in wood, on N. E. Side <sup>Wharton</sup> Co., on S. W. Side  
<sup>Sachs</sup> Co., on S. E. Side <sup>Line</sup> <sup>Line</sup>, and on N. W. Side <sup>Line</sup> - all the Post  
 hereafter mentioned are of same dimensions & put in ground  
 same depth & marked same with the proper miles represented  
 thereon
- at 600 as. E. Boundary line of No. 2 S. A. & M. G. R. R. Co. 640 acre Survey  
 556 was from its N. E. Corner
- " 1390 " N. B. line of said No. 2 Survey - 556 was from its N. E. Cor.
- " 2 Miles Post and Mound, in prairie - this mile good prairie land.
- " 3 Miles Post & Mound, through land adjoining sec 18 of Morris & Cummings sur  
 in Jackson Co. - good prairie, sandy soil -
- " 948 as. Cross wire fence, runs S. 67 1/2° E.
- " 4 Miles Post & Mound - in prairie, good sandy soil -
- " 274 was cross wire fence, runs N. 1/2° E.
- " 1436 " on E. Edge of live Oak runners & a small pond to the west
- " 5 Miles Post & Mound, small live oak knots on the west - in lands adjoining sec  
 17 Morris & Cummings sur. in Jackson Co. Poor wet sandy land
- " 326 was Center of Looney Branch, in prairie
- " 6 Miles Post and Mound - in lands adjoining sec. 14 of Morris & Cummings sur.  
 in Jackson Co. - Poor soil this mile -
- " 7 Miles Post and Mound - soil, Rough Hog willow prairie, in lands adjoining  
 F. Menefee League
- " 8 Miles Post and Mound, in lands adjoining said Menefee League, soil,  
 good sandy loam, prairie.
- " 9 Miles Post and Mound - lands & soil same as in 8 mile
- " 337 was to S. E. Boundary line of J. F. Winston sur. and 1086 1/2 was - N. E.  
 from said Winston's S. Co. on F. Menefee - N. E. Boundary line
- " 1634 was a point of timber N. E. of J. M. Hanks Honor

- at 1714<sup>00</sup> to Prairie on S. Edge of timber
- " 10 Miles Post and Mound - good sandy soil, dry - Except near 9 mile Post, which is low & wet
- " 214<sup>00</sup> East Mustang timber
- " 686 " East Mustang Creek - runs S. W.
- " 1559 " Running Branch 55<sup>00</sup> was with Branch
- " 11 Miles Post and Mound in an opening, Prairie on the west, this mile good Bottom soil & well timbered
- " 36<sup>00</sup>/<sub>100</sub> Post oak tree 20 in dia. on line, in Edge of Prairie, Mkd  $\equiv$  old & New
- " 1455<sup>00</sup> Center of N. G. T. & M. R. R. Runs N.  $55\frac{1}{4}^{\circ}$  E. - from this Point N.  $55\frac{1}{4}^{\circ}$  East 44<sup>1</sup>/<sub>2</sub> 00 is a Stake on N. side of track marked 52<sup>1</sup>/<sub>2</sub> Miles
- " 1473<sup>00</sup> - Set Cypress Post & Mound - Mkd. on N. E. side <sup>Wharton</sup> Co. on S. W. side <sup>Sac</sup> Co. and on S. E. & S. W. side, Co. line
- " 1815<sup>00</sup> Point of timber
- " 1836 " Center of Long Branch, runs S. W.
- " 1890 " Intersect S. Boundary line of John Dillard league 2285<sup>00</sup>/<sub>100</sub> was. E. of its S. W. Cor. on W. Mustang - Cr. runs S.  $20^{\circ}$  W. & N.  $15^{\circ}$  W.
- " 12 Miles Post and Mound - This mile good Farming land
- " 200<sup>00</sup> Post oak tree 2 ft dia on Edge of Prairie
- " 13 Miles Post and Mound, in Prairie - Soil good
- " 704<sup>00</sup> West Mustang Creek - a few scattering trees on E. side of creek at this point - Creek runs S. W.
- " 736<sup>00</sup> a Cross Cr. to a Hackberry tree in wire fence - Now in House league -
- " 972 " Col. Sevens old field fence
- " 1307 " " " gallery to House - line running by W. Edge of chimney in Center of House
- " 1500<sup>00</sup> a live oak tree just N. of Col Sevens Cornfield fence  $\frac{1}{2}$  mi. S. W. of line, Enter live oak bushes -
- " 1592 a Stake from which the N. W. Cor. of John Dillard's league on E. Bank of W. Mustang Creek, (brs. N.  $45^{\circ}$  E. 214<sup>00</sup> was -
- " 14 Miles Post and Mound, in timber, H. T. Schley Co. sur Wharton Co. Present at the setting of this Post - Soil - good farming land
- " 15 Miles Post & Mound - This mile through Bottom timber & Brush - Co. Sur. Schley Pres.
- " 1549<sup>00</sup> Post oak tree 2 ft dia 3<sup>00</sup> was W. of line Mkd  $\equiv$  old &  $\equiv$  New, Tom Romans House E. of line, this mile open Post Oaks & Glades - good soil -

- " 16 Miles Past and Mound in a Point of Mustang Prairie, Co. Sur. Schley Present  
 " 78  $\frac{3}{5}$  pas. intersect N. Boundary line of Geo House league 4646 pas -  
 west of its N. E. corner - Running through the said House league  
 from Mustang Creek, being 2 Miles 12.74  $\frac{3}{5}$  pas -  
 " 547 pas. Enter Bushes & timber  
 " 1780 " a Point of Wolf Run Prairie  
 " 17 Miles Past and Mound, in Prairie, Co. Sur. Schley Present - This mile land with  
 a part Heavily timbered  
 " 860 pas. Enter timber  
 " 1758 pas. Intersect Mrs. Kate Whites' E. Boundary line of a 640 acre Sur.  
 from which E. A. Wilson's, S. E. Cor. of a Prescription claim bears  
 N. 180 pas -  
 " 18 Miles Past and Mound in timber (Co. Sur. Schley present) This mile  
 good Sandy Soil - Timber, Live Oak, P. Oak, & Blk Jack  
 " 107 pas. intersect E. A. Wilson's S. Boundary line, 173 pas. West of his  
 S. E. corner  
 " 357 pas. west Point of Sand Pond - a Road leading to Ganado  
 " 482 " 2 Small Sand Jacks in open glade  
 " 944 " 5 live Oaks & a Sweet Bay tree growing up in center of thin Rests  
 " 1120 " Blk Jack woods  
 " 1220 " E. A. Wilson's W. Boundary line and Mrs Kate Whites E.  
 Boundary line. from which said Wilsons N. W. Cor. bears  
 N. 150 pas -  
 " 1441  $\frac{1}{5}$  pas. Mrs Kate Whites N. Boundary line 149  $\frac{7}{5}$  pas - West of her  
 N. E. Cor. & the N. W. Cor. of E. A. Wilson's Prescription  
 " 1497  $\frac{1}{5}$  pas. E. Boundary line of Sec. 31 at 80 pas N. of its S. E. cor.  
 19 Miles Past and Mound, Extra Marks on this Part H. J. S. & P. P. P. - Co. Sur. Schley Present - This mile on a ridge sandy soil - wild Peach, Sweet Bay, yew, Pine  
 & all kinds of upland timber  
 at 660 pas in Bottoms opening, Hickory &  
 " 880 " Hickory and Sweet Bay &  
 " 960 " Bluff or second Bank of Sandy Creek  
 " 990 " Old Bed of Creek  
 " 1060 " 1<sup>st</sup> Bank Sandy Creek, Or. Runs nearly S., Pecan, Elm & by gum timber

- " 1120 as across 1<sup>st</sup> Pool water
- " 1150 " Center Running water of Sandy Creek
- " 1220 " Edge of long Lilly Pond
- " 1300 " with  $\nabla$  Cross Pond to a Holly tree 8 in dia Mkd  $\equiv$  Pond to  
The East
- " 1440 as End of Pond 10 as E. - a large Holly grove on W. side of line
- " 20 miles Past and Mound in live  $\nabla$  Post Oak woods Red Haws, Bamboo vines  
and all other kinds - Co. sun. Schly Present - Soil good, but hard to clear
- " 580 as an Opening, Pond or Marsh
- " 836 " Live Oak  $\nabla$  You Pon Bushes
- " 1306 Prairie
- 21 miles Past and Mound in Prairie, scattering motts of timber, Extra  
marks on this Post H.J.S.  $\nabla$  P.P.P. - surr - This mile low sand & clay soil  
at 38 as - a Double Post <sup>out</sup> on line Mkd  $\equiv$
- " 952  $\frac{1}{2}$  as Intersect East line of J. R. Wickham 766  $\frac{1}{2}$  as from his  
N. E. corner
- " 1330 as. Enter Golden Rod Bottom timber - a Road leading to Browns
- " 1705 " Golden Rod Creek 15 as across creek
- 22 miles Past and Mound in thicket, live Oak Sweet Bay trees  $\nabla$  Bamboo Pines  
- Co. sun. Schly Present - on this mile soil very good Except frost  $\nabla$   
as -
- at 152  $\frac{1}{2}$  as Intersect N. Boundary line of J. R. Wickham survey at  
1120 as - E. of his N. W. Cor. (on E. line Geo. H. Hall Pr.)  $\nabla$  said Point  
of Intersection is 260 as - W. of the Golden Rod Cr.
- " 962  $\frac{1}{2}$  as - The N. E. Cor. of Geo. H. Hall Preemption claim Brs. S. 7  $\frac{1}{2}$  W. 610 as -
- " 1271 a small live Oak thicket 20 as W. of a Spunk Pond
- " 1289 Through thicket to prairie
- 23 miles Past and Mound in Prairie  $\nabla$  in track of a Neighborhood Road  
- Co. sun. Schly Present - This mile mostly through young growth of Black  
Jack  $\nabla$  Post Oak timber, Sandy Soil  $\nabla$  Rolling
- " 200 as - Edge of a small live Oak mott
- " 760 " a lone Post oak in Prairie 10 in dia. 6  $\frac{1}{2}$  as. W. of line  
Mkd 5 Hacks  $\nabla$  X  $\nabla$  Blazed on E. side
- " 1460 " Through two Spunk Ponds
- " 1520 " to E. line of J. & G. N. R.R. Sec. - not No. on Record Book -  
County 55425

W4

- 24 miles Post and Mound, in Prairie - (Co. sur. Schley Point) This mile too low  
 & wet for Farming, good Pasture land
- 670 as Cross Road leading to Farmers House, which is about 400 var E  
 of line
- 25 miles Post and Mound in Prairie on E. Edge of an Open Pond, Soil  
 Sandy, too wet for farming
- at 16 var. E. Edge of a Small live Oak Mott
- 780 " a Double Blk Jack tree to Right of line on Edge of a Branch
- 820 " across Branch, Branch runs E - in Bushes -
- 900 " out of Bushes & enter Prairie
- 26 miles Post and Mound in Prairie, Soil the most of this mile very fair
- 1360 as a Ravine - runs N.E.
- 1372 " Two Small Saplings, live Oak on N. Side of Ravine
- 15 1/4 as Intersect Mrs Mary Ann Whitneys S. line of Sec No. 2. 1230 var  
 East of its S. W. Cor.
- 27 miles Post and Mound, in Prairie, This mile Sandy & Rolling, a  
 great quantity of Ant or Gopher Holes & Mounds
- 28 miles Post and Mound, in Prairie - Soil level & Sandy full of Ant Knolls
- 105 as. Set Stake and Mound near a Sprink Pond. The distance  
 called for by J. B. Collingsworth Survey for Wharton County
- 1780 as Intersect the N. Boundary line of Sec 4. Mrs Mary Ann Whitneys  
 Surveys
- 29 miles Post and Mound, in Prairie, leaving off Wharton Co. Marks on this  
 Post is local Sandy Soil -
- 788 as. Post and Mound for N. Cor. of Jackson County, in Prairie  
 and on South line of Lavaca County, from which the  
 Golden Rod Creek bears N. 51° E (var 9° 15' E.) 3303 var.  
 Said Point Established by H. H. Russell Co. Sur. of Lavaca  
 Co. and P. P. Putnam Co. Sur. of Jackson Co. when run-  
 ning the Lavaca & Jackson Co. line

A list of the names of the individuals employed to assist in  
 measuring, marking & setting posts on the line and surveys  
 described in the foregoing plat and field notes of

Jackson and Wharton County line: Showing the respective capacities in which they acted

Henry Jump - Chairman Robt. Key, Chairman  
Geo. W. Jump Flag man, Mat. Ham, T. Whedden, Thos.  
Moore, Gabriel Callis - Ax men, in running Co. line

The following, employed in setting Post & making Connecting Surveys with Co. line, John H. Atkinson, Marion Gainer, G. P. Moore, & Glabe Cox - Chainmen, Sam M. Putnam, Wm. Jemison, Wm. Gainer, J. S. Moore, L. Dittmer, Wm. Shore, & R. A. Putnam - The last mentioned, served at different times on said Survey

I P. P. Putnam, do hereby certify that in pursuance to an appointment by the County Court of Jackson County, bearing date the 15<sup>th</sup> day of May 1886, and in strict conformity to the laws of the State of Texas in regard to County lines, I have faithfully surveyed the County line between Jackson and Wharton Counties and that the foregoing are the true and correct <sup>map</sup> field notes of such Survey

P. P. Putnam Co. Sur. J. C. T.  
Sworn to and subscribed before me this

<sup>14</sup>th day of April A.D. 1887

L. F. Wells - ex Co. Cl.  
J. C. S.

The foregoing field notes <sup>or map</sup> of the Survey of Jackson & Wharton County line, executed by P. P. Putnam under an appointment from the County Court of Jackson County of the 15<sup>th</sup> day of May 1886, and I being appointed by Wharton County as the law directs, having been critically examined and from actual observation and examination in the field - The said <sup>map</sup> field notes and the surveys they describe are hereby agreed to and approved Henry J. Schley ex  
C. S. W. C.

Subscribed & Sworn to &



The State of Texas }  
 County of Jackson } L. F. Wiley, Clerk of  
 the County Court of Jackson County  
 Texas do hereby certify that the fore-  
 going seven pages contain a true  
 copy of the field notes of the field  
 notes of the Jackson & Malagorda  
 County line, and of the report of  
 P. P. Putnam Surveyor appointed by  
 the Commissioners Court of Jackson  
 County to survey and establish said  
 line, and I further certify that the  
 map accompanying this report is  
 a true copy of the map which with  
 said field notes was filed in the  
 County Court of Jackson County Texas  
 on the 7<sup>th</sup> day of April A.D. 1887  
 and recorded in the minutes of said  
 Court beginning on page 415



Filed April 7<sup>th</sup>, 1887  
 L. F. Wiley,  
 Clerk

Given under my  
 hand and seal of  
 office this 3<sup>rd</sup>  
 day of August 1887  
 L. F. Wiley,  
 Clerk

County Line between

Jackson and Sparta  
 Jackson Co. Polk Co. line

Filed Aug 4<sup>th</sup>, 1887

This line is too difficult  
 to attempt making a change  
 of abstract by it -  
 the Surveyor fails to  
 name the bearings through  
 which the line passes  
 and does not give  
 name or hold prices  
 from corners of line -  
 says - names of trees,  
 colors & distance from  
 corners of bearings through  
 which the line passes  
 must be given before  
 the line can be properly  
 returned and abstract  
 corrected.  
 Oct 25/87 A. W. Shaw  
 See Supplement filed  
 Jan 18/88

Aug 20<sup>th</sup> 1888 Abstract Corrected and  
 a copy for A. Camp's Returnment



**MAP OF  
JACKSON  
AND  
WHARTON  
CO. LINE  
TEXAS.**

Scale, 4000 vas. to an inch

*Jackson & Wharton Co. Line*  
 P. P. Putnam, Co. Sur. of Jackson County, do certify that the above Map of Jackson & Wharton Co. Line is true & Correct  
 P. P. Putnam, Co. Sur. J.C.C.

*17th February 1854*  
 Jackson & Wharton Co. Line

5430

JACK CO. BOUNDARY #1

Jackson Co. Bdry line

Wapahoga Co.

Jackson Co. Bdry line  
D. H. Jackson Co. v. ...  
is per ...  
Jackson & ...  
that the ...  
Jackson Co. v. ...  
2000 ...

COO. LINE  
LEXAS

MAYBODIE  
MAYBODIE  
MAYBODIE  
MAYBODIE

JACKSON CO.

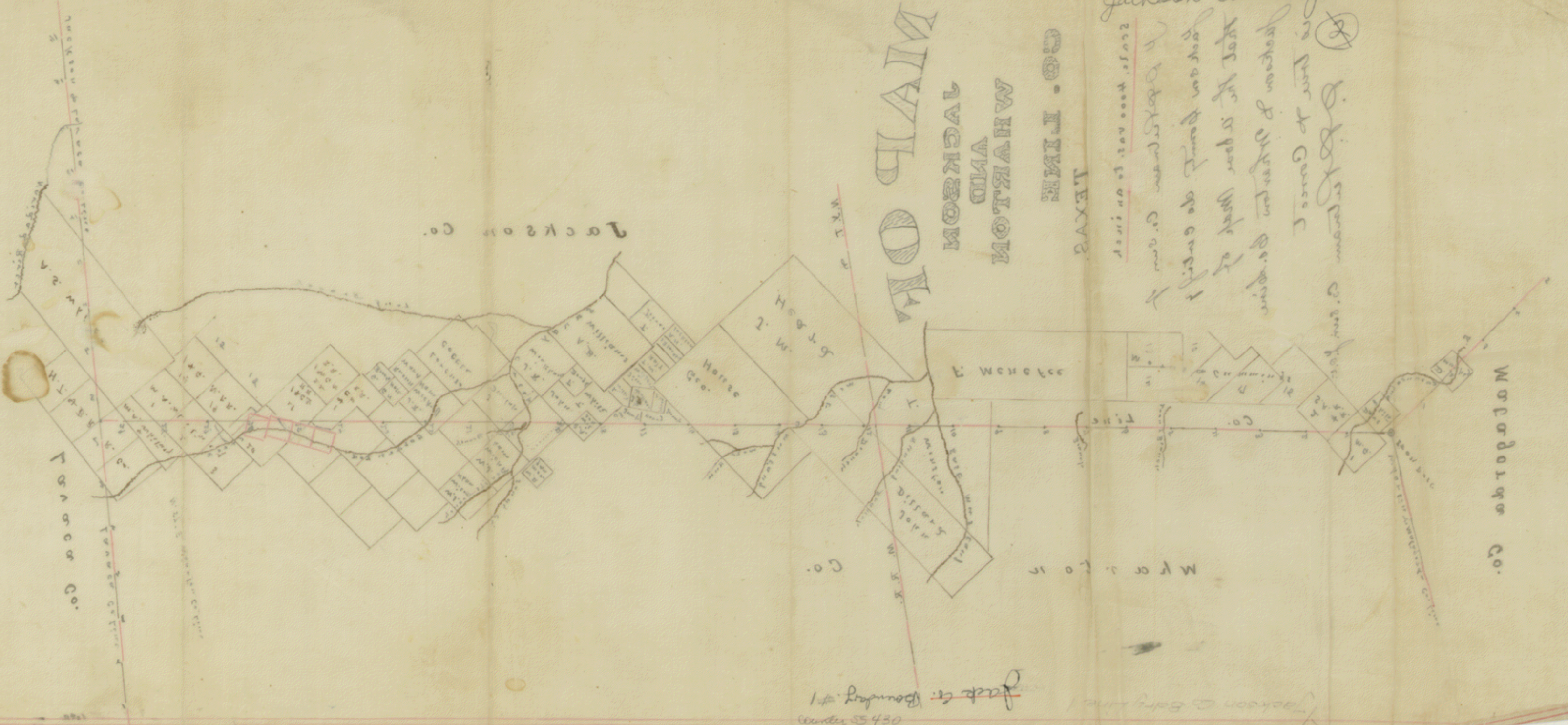

LAVACA CO.