

To the Honorable J. S. McNeill Judge of the
County Court of Jackson County Texas

The undersigned P. P. Putnam County
Surveyor of Jackson County reports:

That in pursuance of an order of the County Court
of said County made at the April Term 1886
That he proceeded at the time and place fixed
by said order to survey establish and mark
the line between Jackson and Lavaca at the
corner common to Jackson and Wharton
Counties on the Lavaca County line and did
meet on the 13th day of July 1886 H. H. Russell
County Surveyor of Lavaca County who with
the undersigned agreed to the Establishment
of said corner and line.

Beginning at a Cypress post 8 inches square
and 5 feet long, set in the ground 3 feet with a
mound around same in prairie. said post
marked on S.E. side and cut in the wood
N cor Jackson Co and on N.W. side LAVACA
and on S.W. side Co LINE from which the 29th
mile post on the Wharton & Jackson Co line
bears S 45° E 788 var - and the Golden Rod
Creek br N 51° E 3303 var and the N.E
course of the Archibald S. White leg
br S 13° E 699 1/2 var

Thence South 51° West (var 9° W)
at 186 var over low wet prairie cross a wire fence
at 797 var set Bois d'arc Post marked miles on N.E. side
and ^{LAVACA} Co on N.W. side and ^{KS} Co on S.E. side
and ^{Co} LINE on S.W. side, said post is 5 feet
long and set 3 feet in the ground with

Jackson Co. Bdry line (5)
for Jackson & Lavaca
Co. Line

with a mound around it - This post is numbered from the SE corner of Lavaca Co and only represents 797 varas - On Jackson Co line all posts hereafter mentioned are of same kind and dimensions put in the ground same depth and mkd same with proper miles represented thereon

- at 309 $\frac{1}{2}$ var - Intersect the N Boundary line of a white league 5109 $\frac{1}{2}$ var from its NW corner on Navidad River and 1172 $\frac{1}{2}$ var from its NE cor in prairie, at this point cross R J Clarks wire pasture fence
- at 9 Miles Past and Mound - soil good sandy Prairie land
110 " " " " the 1st $\frac{3}{4}$ of this mile sandy Prairie and balance Black Hog wallow soil - from this post a lone double or forked live oak 24 diameter mkd L brs N 76 E 120 var
- at 1320 var - Entered the Navidad timber
- " 11 Miles Past & Mound from which a Post oak 20 in dia mkd L brs N 47 E 80 var - soil to timber Black & sandy, in timber light sandy soil.
- at 791 $\frac{1}{2}$ var intersect the S boundary line of a white league and the N Boundary line of Caroline Brown Survey 2742 var from their respective SW & NW corners on Navidad River & 1535 var from NE corner of Caroline Brown sur & 6330 var from SE cor of said a white league
- at 12 Miles Past & Mound from which a Black Jack in dia mkd L brs 9 E 9 var - light sandy soil - this mile
- " 1096 var - Intersect the S B line of Caroline Brown sur and the N B line of the J H Scott sur

2024 var from their SW & NW corners and 3363 var from said Browns SE corner & 267 var from said Scotts NE cor. soil light sandy on heavy white Clay.

- at 13 Miles Past and mound on N margin of a pond from which five (5) live oaks growing together about 8 feet dia mkd L brs N 77 E 27 var - this mile has a number of low open glades - soil poor light & heavy sand & clay
- at 541 var Intersect S B line of J H Scott and N B line of Patrick Scott labor 1146 var from their SW & NW corners on Navidad River
- at 620 var - Intersect Public Road from Edna to Lavaca Co line via of Morales, which dist is 19 miles 1428 var - to Court House square in Edna as per measured route of road.
- at 935 var - crossed a fence - enter field
- " 1018 var Dr Moffitts Hedge fence
- " 1100 " South Side of Old Ellis House
- " 1468 " Intersect S B line of Patrick Scott labor and the N B line of Isaac Madsen sur 560 var from their SW & NW corners on Navidad River
- " 1800 var through Dr Moffitts Pasture to fence in bottom timber
- " 14 Miles Past and mound on the N side of Navidad river from which a Pecan 17 in dia mkd L brs N 40 E 4 var. the 1st $\frac{1}{2}$ mile poor sandy soil etc 3^d $\frac{1}{4}$ mile good sandy soil, the last $\frac{1}{4}$ mile good bottom black soil.
- at 33 var An ash tree 4 feet dia mkd \equiv
- " 40 " Navidad river 20 var across (wide)
- " 380 " Entered old Harry field
- " 700 " " a Thicket
- " 15 Miles Past and mound from which a Pin oak

with a mound around it - This post is numbered from the SE corner of Lavaca Co and only represents 797 varas

- 12 in dia marked \odot by N 51° E 1 va. This mile all good bottom land
- at 240 var - Center of Chalk Branch, runs N & S.
- " 740 " Open Past Oak timber
- " 1330 " Road from Edna to Hallettsville known as the Mitchell road
- " 1560 " Water hole Branch
- " 1600 " Another Branch
- " 16 miles Post and mound from a live Oak 24 in dia marked \odot by N 51° E 1 va. this mile through Past O, Oak J. and some Hickory timber soil light sand
- at 351³/₅ var Intersect the S boundary line of Wm Hardy and the N boundary of John Alley league 1808 var from the SE cor of said Hardy league & NE cor of said Alley, an ash tree marked as their cor's on West bank of Navardos river
- at 1380 var a Road leading to Halletts mill
- " 1540 " Crossed a Branch at its forks
- " 17 miles Post and mound from which a Past Oak mkd \odot by N 51° E 1 va. this mile is open Past O & Oak J. timber broken in places by ravines & gullies, soil sandy, clay subsoil near top
- " 1400 var Enter Prairie
- " 18 miles Post & mound in prairie from which a Past O, 12 in dia mkd \odot by N 17° W 23 var - soil this mile low clay & sand, motts and scattering timber on last 1/2 mile
- " 1600 var Intersect WB line of John Alley & E D line of I & G N. R. R. Co sur.
- " 400 " a Road in open Past O timber leading to Pignal Jones, Oca, Peace & Edna
- at 1700 var Enter Prairie
- " 19 miles Post & mound in Prairie from which a Past Oak 12 in dia mkd \odot by N 51° E 700 var Clay & sandy soil, some good timber in places on this mile
- " 480 var Intersect E. D. line of John Footman sur 80 var from its N.E cor.
- " 600 " N. End of a Ceno pond.
- " 1040 " a road in prairie & another at 1080 var
- " 1760 " a Point of Timber
- " 20 miles Post and mound from which a Oak J 12 in dia mkd \odot by N 51° E 1 va. this mile sand & Clay most all in prairie
- at 50 var Intersect SE cor of John Leads sur on N B line of John Footman sur
- at 1200 var Prairie
- " 1360 " Timber
- " 1800 " A Road in timber
- " 21 miles Post and mound from which a Past Oak 12 in dia mkd \odot by N 10° E 6 var this mile poor sand & Clay soil
- " 220 var Intersect E. D. line of B. P. Depallier sur an West line of John Leads and 220 var from said Depallier SE cor on N line of John Footman
- " 580 " A sprung Pond
- " 740 " across pond and enter timber
- " 1480 " Center of a very dry Branch runs S. N
- " 1870 " Another dry Branch
- " 22 miles Post and mound from which a Oak J 12 in dia mkd \odot by N 25° E 5 var, soil sandy
- " 420 var Center of Lavaca river runs S 50° E

- at 4600 var West Bank of said river at a sycamore 24
in dia 5 var S. of line MKd \equiv and a Pecan
15 in dia 1 var N of line MKd \equiv Co LINE
- " 570 " a Live Oak 3 feet in dia 5 var N of line MKd \equiv
- " 900 " The end of a punk pond.
- " 1120 " a Road leading to the Old Williams place
- " 1800 " a small head.
- " 23 Miles Post and mound in edge of prairie from
which a Post Oak 10 in dia MKd \equiv \times on
N 51° E 82 var and a forked P.O. 24 in dia
MKd \equiv L on N side \times \times S 51° W 50 var. E side
river good sandy soil on W poor sandy
- at 5000 var Timber
- " 370 " Chicote Prairie at a Post Oak 18 in dia
MKd \equiv \times on N side + also old marks
- " 800 " Road from slaughters to Williams old place
- " 1060 " another road.
- " 1170 " a small live oak mostly 5 var through + into
prairie
- " 1560 " left prairie and entered on Chicote timber
- " 1780 " Intersect the N.B. line of W. Williams sur + the
E. B. line of B. Roden Pre sur. 15 var from
said Roden N.E. corner + the S.E. corner
of James Carlile Pre sur
- " 24 Miles Post and mound in edge of a small live oak
matt from which a P.O. 24 in dia MKd \equiv \times
brs S 45° E 37 var. this mile good prairie
soil. But sandy most of the way, a little
poor land on 1st part.
- " 7 var Intersect the S.B. line of James Carlile
Pre + N.B. line of B. Roden Pre 125 var from
S.E. corner of said Carlile + N.E. cor of said

x¹ a³

- " 800 var Russell's pasture wire fence and intersect
the E. B. line of Tho's Bridges league 514 var
from its S.E. cor and also and also the
N.B. line of said Carlile 83 var from his
S.W. corner and B. Roden's N.W. cor.
- " 920 " a Branch
- " 1040 " Chicote Creek
- " 1060 " West bank of said Creek
- " 1075 " was a forked live oak 18 in dia MKd \times on the
S. + L on the N side (old + new marks) \equiv
- " 25 Miles Post and mound in a dense live oak thicket
(mostly dead) from which a live oak 4
in dia MKd \times on N + L on E side this mile
W of creek is all sandy, mostly Creek sand
E. of Creek But sandy good soil
- " 900 var Through brush and timber to a Post O. in edge
of prairie 12 in dia MKd \equiv \times old and new
marks \equiv
- " 26 Miles Post and mound in prairie from which a Post
O. 12 in dia MKd \equiv \times brs N 51° E 1000 var. Poor
sandy soil
- " 27 Miles Post and mound in prairie from which the E
end of the lower or E. twin matt brs N 74° W
and a lone live O. brs S 45° E. this mile
level sandy prairie with some live O. timber
struck rock at 1/2 feet at this post.
- " 576 1/2 var Intersect W. boundary line of Tho's Bridges 1/2
league 1205 var from its S.W. corner.
- " 600 " Old road between Higgins + Old Hanna place
- " 28 Miles Post and mound in prairie from which a Post
O. 1 1/2 from twin matts in Victoria prairie brs
S $30 1/2^{\circ}$ W + the E edge of a lone matt in

x² a⁴

Victoria prairie brs S 30° W. This mile as-
 cending 1st half mile & descending each
 1/2 mile good sandy soil - Grass fine
 at 29 Miles Post and mound in prairie from which a Post Oak
 S. W. of the twin motts brs N 27° E & a lone Red Oak
 brs S 71 1/4° E this mile rolling prairie good sandy soil
 " 426 was Post and mound in prairie on the N.E. boundary line of
 Victoria County, and West corner of Jackson County and
 the South corner of Lavaca County, which is 6763 001
 S. 39° E from the E corner of DeWitt and N corner of
 Victoria County. From which a Post Oak S. W.
 from the Twin Motts brs N 30° 45' E and a small
 lone Red Oak brs S 80° 45' E, and the E edge of a lone mott
 in a pasture in the Victoria Prairie brs S 19° W.
 The old marked line between Lavaca and Jackson Counties was
 found adopted and retraced which we find to have been irregu-
 larly run at a ver of about 9° 15' E. The above line was
 plainly marked with five (5) marks thus =

J. P. Putnam County Surveyor of Jackson County
 Texas do hereby certify that in pursuance to an ap-
 pointment by the County Court of Jackson Co. bearing
 date the 15th day of May 1886. and in strict conformity to the
 laws of the State of Texas in regard to County lines, I have
 with the assistance, cooperation, and agreement of Co
 Surveyor H. H. Russell of Lavaca Co. faithfully surveyed
 the Co line between Jackson and Lavaca Counties and
 that the foregoing are a true and correct plat and
 field notes of such survey.
 Surveyed July 17th 1886
 J. P. Putnam

The State of Texas &
 County of Jackson J. L. F. Wells Clerk of the
 County Court of Jackson County Texas
 do hereby certify that the foregoing attached
 eight pages and accompanying plat
 are a true and correct copy of the
 report of J. P. Putnam, Surveyor appoint-
 ed by the County Court of said County
 to survey and establish the line between
 Jackson and Lavaca Counties, of the
 field notes and plat of said line, as
 the same appear of record in the
 minutes of said Court on pages 416
 to 423 inclusive of Book A.
 Given under my hand and
 seal of Office this 5th day
 of April AD 1888
 J. L. F. Wells
 ccc for

Jackson Co. Boundary line

LAVACA CO.

DEWITT CO.

VICTORIA CO.

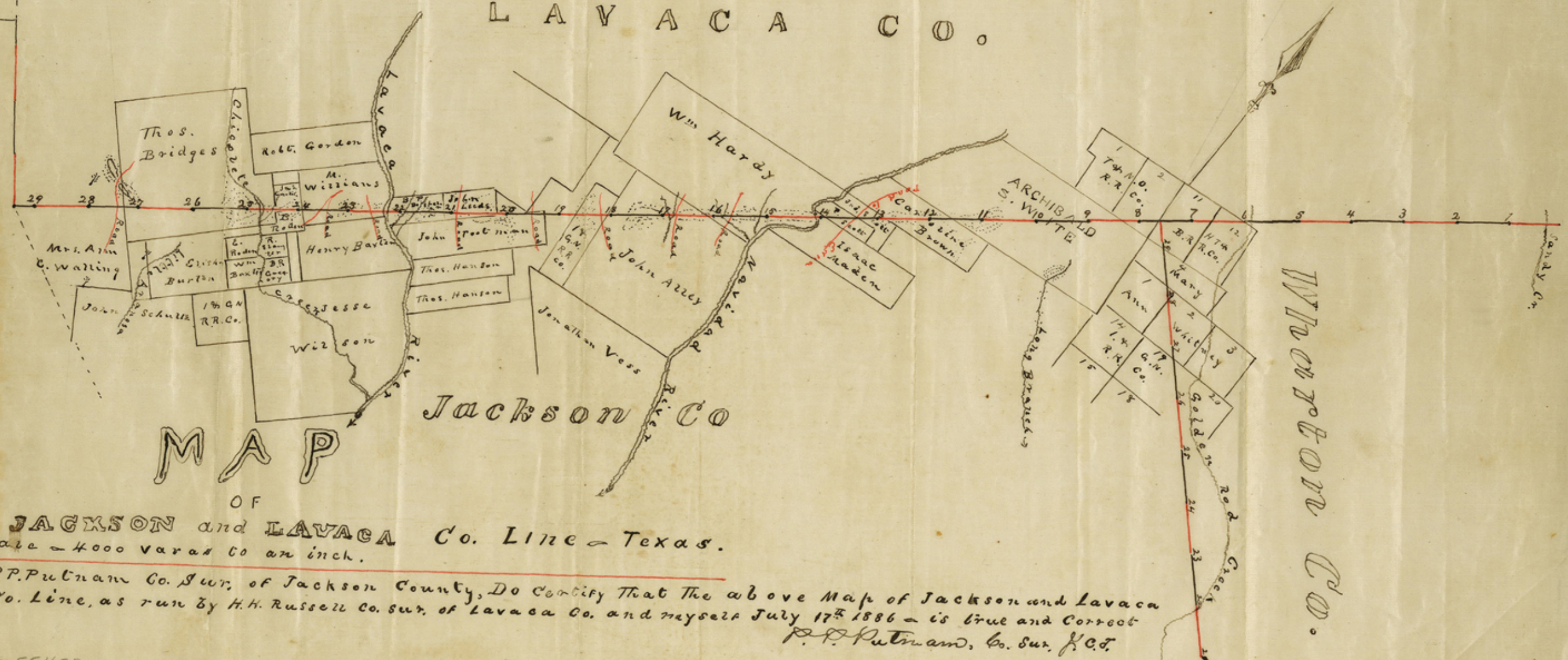

MAP

OF

JACKSON and LAVACA Co. Line - Texas.

Scale - 4000 yards to an inch.

I, P.P. Putnam Co. Sur. of Jackson County, Do certify that the above Map of Jackson and Lavaca Co. Line, as run by H.H. Russell Co. sur. of Lavaca Co. and myself July 17th 1886 - is true and correct

P.P. Putnam, Co. Sur. J.C.

Wm Hardy Co.

1886

Jackson Co. Boundary line

DEWITT CO.

VICTORIA CO.

L A V A G A C O .

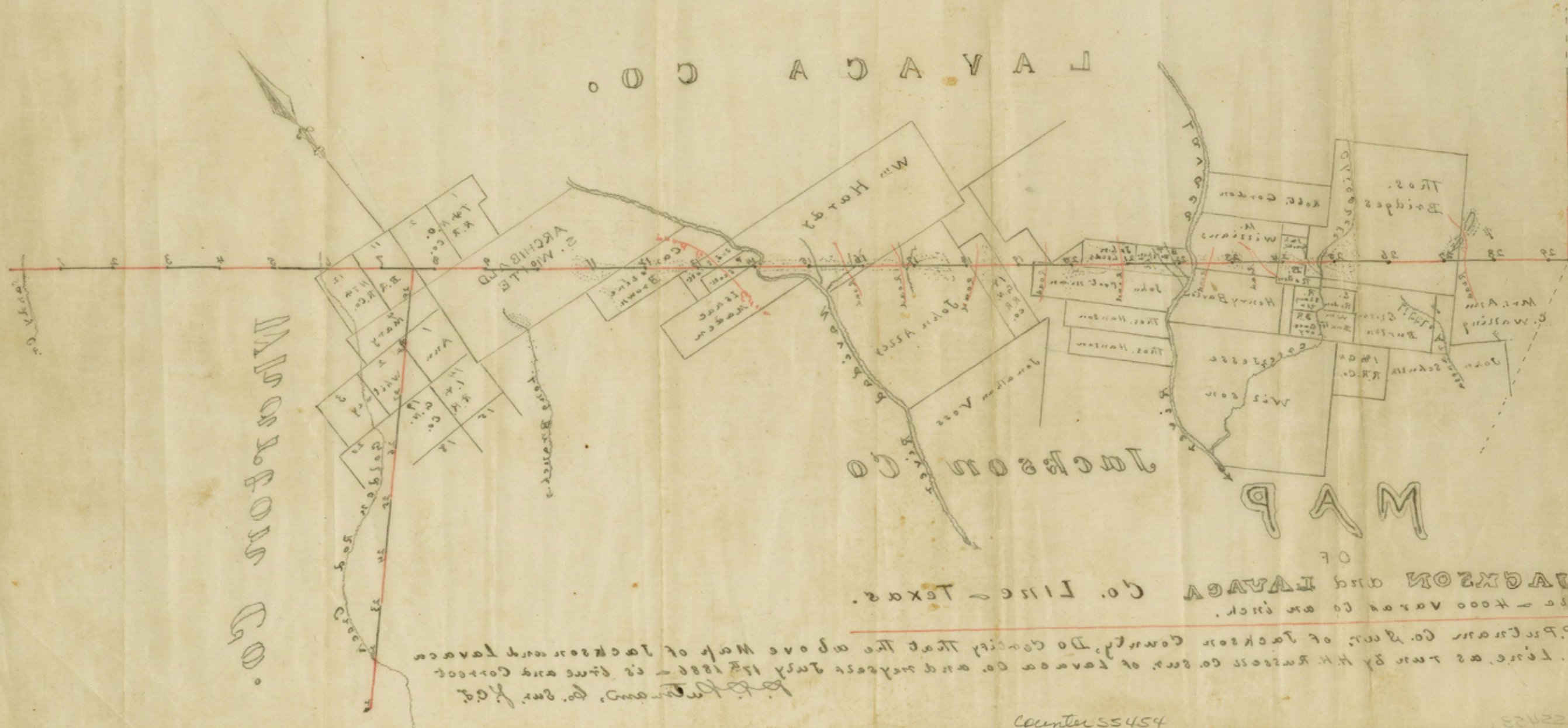

Map of Jackson Co.

JACKSON AND LAVACA Co. Line - Texas.
 Scale - 1000 Yards to an inch.

I, P. P. Johnson, Co. Surveyor of Jackson County, Do hereby certify that the above Map of Jackson and Lavaca Co. Line as run by H. M. Johnson Co. Surveyor of Lavaca Co. and myself July 15th 1886 - is true and correct.