

File No 54

County line

between Kerr &

Kendall Counties

Protected by Kerr Co

~~4~~

Filed March 1st 1880

Signed by Surveyors of
Kendall Co only & no
good guaranty

Counter SS169

127th and 128th of 1852

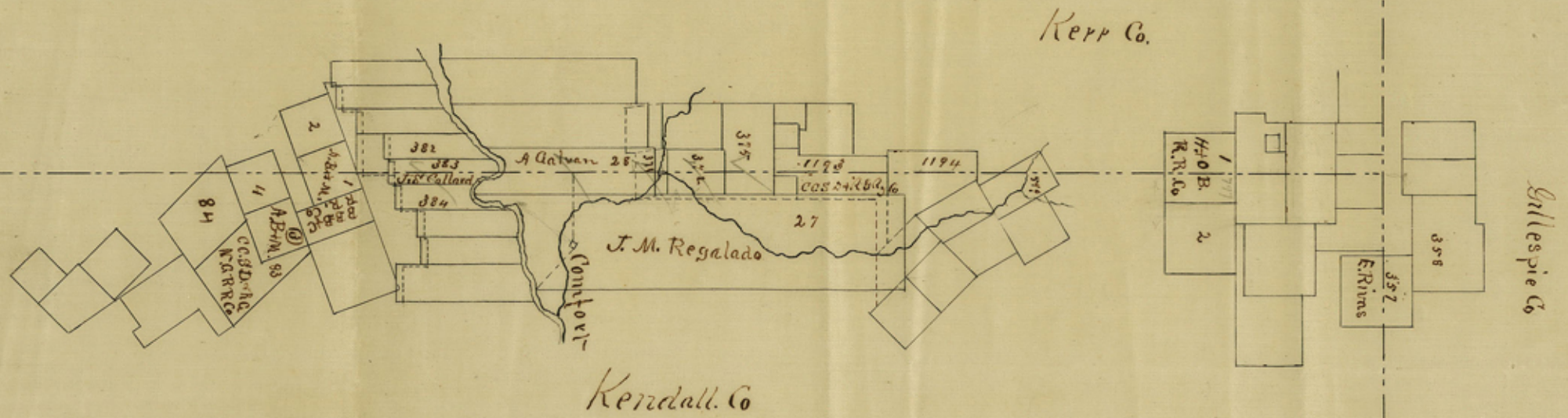

Fieldnotes

of the boundary line between Kendall
Bern counties as established by the Sur-
veyors appointed by the Commissioners
Courts of said counties to run the line
commencing December 16th A.D. 1879

Filed in the
County Clerk's
Office Febry
9, 1880

Beginning at a stone monument on
the Southern boundary line of Gillespie
county 2450 varas North 63° W. of the
S. W. corner of Survey No 357 in the name
of E. Rivas from which a L. O. 5" brs S.
 68° E. 18 $\frac{1}{2}$ vrs do 6" brs S 38 ~~vrs~~ W 84 vrs.

Thence South 1900 varas to a stone monu-
ment (1 $\frac{1}{2}$ mile) from which a P. O. brs. N.
 83° W 11 vrs do 8" brs N. 58° E 7 vrs.

3800 vrs to a stone monument (2 $\frac{1}{2}$ mile)
from which a B. J. 8" brs. N. 23° W. 6 vrs.
do 9" brs N. 76° E 31 vrs, 3978 varas to
the N. boundary line of Survey No 1 H &
O. B. A. R. Co 797 varas W of its N. E. cor.,
5500 head of N. Creek.

5700 varas to a stone monument
(3 $\frac{1}{2}$ mile) on W. side of a hill fr which a
Shin. O. 12" brs. N. 58° E 20 vrs.

7600 varas to a stone monument (4 $\frac{1}{2}$ mile)
on N. side of a hill fr. which a Shin
O. 8" brs N. $37\frac{1}{2}$ E 16 vrs, 8800 to branch
of North Creek 9500 varas to stone monu-
ment (5 $\frac{1}{2}$ mile) on hill fr which a Spau.

- 6 O. 8 brs S 19° E 26 vrs. do 7" brs N. 38° E 14 vrs 11300 vrs to branch 11400 vrs to stone monument (6 $\frac{1}{4}$ m) fr which a L. O. 14" brs N. 55° E 32 varas do 10" brs S 67° W. 30 varas ^{see this 12250} 11250 vrs to a point from which the ^{W. 1194} S. W. cor. of Survey No. 1193 C C S. D. & A. G. N. G. Ar to brs W. 456 vrs.
- 7 13300 vrs. to a stone monument (7 m) on S. side of a hill no trees near 15200 varas to stone monument (8 $\frac{1}{4}$ mile) fr. which a L. O. 8" brs N. 27° W. 36 vrs do 7" brs S. 82° W. 15 varas.
- 9 17100 varas (9 mile) stone monument fr which a L. O. 9" brs S 71° W. 26 varas & a P. O. 11" brs N. 71° E 14 varas 19000 varas to a stone monument (10 mile) in Dieterts field from which a Pecan 15" brs S. $15\frac{1}{2}$ E. 103 varas 20050 vrs to North creek, 20270 vrs recrosses North creek 2029 vrs. to bypass creek 20900 vrs to stone monument (11 mile) 125 varas N. of Comfort & Kerrville road from which a L. O. 13" brs N. $76\frac{1}{2}$ E 9 vrs do 13" brs N. 5° W $37\frac{3}{4}$ vrs. 21555 varas to a point from which the centre of the Public square in the Town of Comfort bears East 1900 varas.
- 12 22800 varas to a stone monument

13

(12 mile) from which a P. O. 24" bts N. 51° E 30 varas (the line running through Survey N^o 28 in name of Stalbin 500 varas W. of its E. boundary line) 23430 vrs to the Guadalupe river 24700 varas to a stone monument (13 mile) Pecan 7" bts W 7 varas & Spanish O. 6 bts S. 45° E 1 vara.

14

26600 varas to a stone monument (14 mile) from which a L. O. 12" bts N. 78° W. 36 varas do 12" bts N. 75° E 46 varas, 27430 varas to N. boundary line of Survey N^o 1 A. B & M 375 varas from its N. E. cor. 28500 to a stone to a stone monument

15

(15 mile) from which a L. O. 16" bts S 19½ E 94 varas, (30400 varas to stone monument (16 mile) on N. side of a hill no trees near, 30880 vrs to S. line of Survey N^o 4 (A B & M) 185 varas

16

from its S. W. cor. 31500 to S. W. line of Survey N^o 84 (C. C. S. D. & A. G. N. G. R. R. Co) 700 varas from its W. cor 32300 varas to a stone monument (17 mile)

17

33370 varas to a point from which the S. E. cor. of Survey N^o 2 B. S. & F. bts W 370 varas. 34200 varas to stone monument (18 mile) from which

18

18

B. J. 12" bro. N. 54° W. 50 vrs B. J. 5" bro N. 28 varas 36100 varas to stone monu- ment (19 mile) from which a B. J. 7" bro. N. 28° W. 73 varas 37770 to Indian Spring

19

38000 to stone monument (20 mile) from which a B. J. 6" bro N. 7° W. 19 varas & Walnut 7" bro N. 22 vrs. 39900 to stone monument (21¹/₂ mile) on W side of hill no trees near.

20

41800 to stone monument (22¹/₂ mile) on the E side of a hill 43700 to a stone monument (23¹/₂ mile) on the North bank of the East prong of Privilege creek from which a L. O. 6" bro S 68° E 14 varas & a Spanish O. 6" bro. S. 2¹/₂ W. 24 vrs 43760 crosses Privilege 45600 to stone monu- ment (24 mile) on W side of a hill no trees near. - Stone monuments 2 feet high - Bearing trees marked K - line trees three chops. -

21

41800 to stone monument (22¹/₂ mile) on the E side of a hill 43700 to a stone monument (23¹/₂ mile) on the North bank of the East prong of Privilege creek from which a L. O. 6" bro S 68° E 14 varas & a Spanish O. 6" bro. S. 2¹/₂ W. 24 vrs 43760 crosses Privilege 45600 to stone monu- ment (24 mile) on W side of a hill no trees near. - Stone monuments 2 feet high - Bearing trees marked K - line trees three chops. -

22

41800 to stone monument (22¹/₂ mile) on the E side of a hill 43700 to a stone monument (23¹/₂ mile) on the North bank of the East prong of Privilege creek from which a L. O. 6" bro S 68° E 14 varas & a Spanish O. 6" bro. S. 2¹/₂ W. 24 vrs 43760 crosses Privilege 45600 to stone monu- ment (24 mile) on W side of a hill no trees near. - Stone monuments 2 feet high - Bearing trees marked K - line trees three chops. -

23

41800 to stone monument (22¹/₂ mile) on the E side of a hill 43700 to a stone monument (23¹/₂ mile) on the North bank of the East prong of Privilege creek from which a L. O. 6" bro S 68° E 14 varas & a Spanish O. 6" bro. S. 2¹/₂ W. 24 vrs 43760 crosses Privilege 45600 to stone monu- ment (24 mile) on W side of a hill no trees near. - Stone monuments 2 feet high - Bearing trees marked K - line trees three chops. -

24

41800 to stone monument (22¹/₂ mile) on the E side of a hill 43700 to a stone monument (23¹/₂ mile) on the North bank of the East prong of Privilege creek from which a L. O. 6" bro S 68° E 14 varas & a Spanish O. 6" bro. S. 2¹/₂ W. 24 vrs 43760 crosses Privilege 45600 to stone monu- ment (24 mile) on W side of a hill no trees near. - Stone monuments 2 feet high - Bearing trees marked K - line trees three chops. -

I D W Grady Surveyor of Kendall county do hereby certify that the bounds limits @ marks natural @ artificial are truly described in the foregoing fieldnote. - Given under my hand at Boerne this 6th day of February A. D. 1880.

(sig.) D. W. Grady
Surveyor Kendall Co.

The State of Texas,
County of Kendall. I, Henry Theis, County
Clerk of said County, do hereby certify,
that the foregoing is a true & correct
copy of the field notes & map of the
boundary line between Kendall & Kern
Counties, as returned into the Commission-
ers' Court of said County, by D. W. Grady,
Surveyor of Kendall County.

I further certify, that said field notes
and map have been recorded in the
Minutes of said Court.

In Testimony Whereof, I hereunto
sign my name & affix the im-
press of my official Seal, at
office in Boerne, this 24th day
of February, A. D. 1880.

H. Theis
Clerk Kendall Co.

Kendall Co Bdry Line 54

(4)

County line between Kerr
and Kendall Counties

Proteted against by Kerr Coun
ty

Filed March 1st 1880

Rhoads Fisher

Incornet generally calls
for but few corners of sur-
veys through which he
passes, and signed by
but one surveyor
no good + protested a-
gainst

