

County Line between
Lamar and Fannin
Counties

abstract corrected
Aug 24th 1885
Beaman

Lamar Co Bdry Line 56a

Read Examined
& approved
May 26/85
W. H. Baird
Com

signed by both surveyors

THE STATE OF TEXAS

LAMAR COUNTY,

In the County Commissioners Court,

TUESDAY MAY 12th. A.D. 1885.

In the matter of establishing the Tuesday, May 12th. 1885.
County Line, between

LAMAR and FANNIN Counties.

Now on this day, THOMAS H. SKIDMORE, County Surveyor of Lamar County, Texas, who was by this Court duly appointed, to ascertain by actual survey, the true boundary line between Lamar county and Fannin county, in the State of Texas, and to mark and establish the lines and corners, on the said line, and to designate the same according to law, together with M. KEITHLEY, appointed by the County Commissioners Court of FANNIN County, for the same purpose, and in accordance with law, made their report of the Field-notes of said survey of said line, ordered to be run, in the words and figures following, to wit:

"To the Commissioners Court of Lamar County, Texas.

Whereas, at the Nov. term of your said Court, in 1884, the undersigned, THOS. H. SKIDMORE, Surveyor for said County, was appointed to survey the boundary line, between LAMAR and FANNIN counties, and upon notice thereof the Hon. Commissioners of FANNIN county, on the day of appointed the undersigned, M. KEITHLEY, Surveyor of said county of Fannin, to assist in said survey, the time designated by said courts being the 16th. day of February 1885;

We the undersigned, Surveyors named, in said orders would most respectfully report; That in obedience to said orders, met on the said 16th. day of February 1885, and having ascertained the variation of the needle at which the original line was run, to-wit: N. 8° 23' E., and having ascertained the point at which the original line between Nacadoches and Fannin Land Districts started, from the center of Bois d'Arc Bayou, at the Carter Clift's crossing, we began said survey of which the following pages contain true and correct field notes:

~~Beginning at the center of Bois d'Arc Bayou, at the center of CARTER CLIFT'S crossing, whence the beginning corner West of the nearest accessible point, marked "L.F.C.L." on its South face, and on its West face Marked "C. L. 30" was set from beginning S. 42° E. 27 varas, and a post-oak tree, on East bank of Bayou, marked, "L." brs. S. 41° E. 28 varas.~~
Beginning at the center of Bois d'Arc Bayou, at the center of CARTER CLIFT'S crossing, whence the beginning corner West of the nearest accessible point, marked "L.F.C.L." on its South face, and on its West face Marked "C. L. 30" was set from beginning S. 42° E. 27 varas, and a post-oak tree, on East bank of Bayou, marked, "L." brs. S. 41° E. 28 varas.

We surveyed thence South with James Garland's line and J.L. Dillingham's East line, - marking the line with 4 chops on face of trees next the line, at 1423 varas crossed a branch 3 varas wide, C. N.W., at 1900 varas, a post-oak on old line, mkd. "I.M.". Set a mile post mk'd. on S. face, C.L.I.M., on East face, "L.", and on West face "F.", Said post of Bois d'Arc 8 inches square, and 5 feet long, 3 feet in ground.

SECOND MILE,

Continued South with the lines of said surveys, at 90 varas a branch, C. W. I v. wide- at 420 vs. a large branch C. N. W. 4 vs. wide- at 689 varas looked closely for S.E. Corner of the

Dillingham's and the N. E. cor. of W. Davis, but failed to find it - at 860 vs. a branch, general course N. W., 2 vs. wide, up said branch 100 vs. at 2881 vs. again looked for Dillingham's & Davis' corner failing to find it, at 1900 varas a red-oak on old line, marked I I. M., - Set 2d. mile post mkd. " 2.M.",

THIRD MILE;

Continued South at 2 miles & 1340 varas or 5140 varas, passed Garland's S.W. and J.H. Mebane's N.W. corner, at 1900 varas a red-oak, 3 mile tree, on old line. 3d. Mile post, mk'd. 3. M.

FOURTH MILE;

Continued South with Mebane's West line and Beasley's East lines - at 540 varas, a branch C. N. E., 2 vs. wide, - at 1900 vs. Set 4th. Mile post, mk'd., 4. M.

FIFTH MILE;

Continued South with Mebane and Williams', and E. P. Stephens' West lines, and Beasley's & Parker's East lines, at 1850 vs. Stephens' S.W. & J. Morgan's N. W. corner, at 1900 vs. 5th mile post. Mk'd. 5. M.

SIXTH MILE;

Continued South, at 350 varas, Slough creek, C. N. E. 7 varas wide, at 450 vs. S. W. corner of J. Morgan's and N. W. corner of H. F. Clark, at 854 vs. Clark's S. W. corner & A. Reed's N. W. cor, at 932 vs. Hawley's S. E., J. J. Cothran's cor, - in all South, 1900 varas, Set 6th. Mile post, Mk'd 6. M.

SEVENTH MILE;

Continued South, at 410 varas the S. W. corner of Reed's and S. E. corner of Cothran, in road from Tigertown to Blue-Prairie, the North line of J. J. Davis' survey crossing said Davis' line 1404 vs. W. of its N. E. and 496 varas East of its N. W. corner - at 885 varas a branch C. E. 2 vs. wide, at 1100 vs. a branch, C. S. E. 2 vs. wide, at 1470 vs. North prong of Sanders creek, 4 vs. wide, C. N. E., at 1900 varas, Set 7th. Mile post mkd 7. M., in edge of prairie.

EIGHTH MILE;

Continued South, at 600 varas through prairie, at 630 varas crossed Davis' South line (survey plus 220 vs.) and W. L. Boyd's North line 496 varas East of his N. W. corner, at 1580 enters prairie at Boyd's S. line 454 varas West of his S. E. corner, a bois d'arc stake stands in Boyd's S. line 3 varas West of our line, cor. Sec. 68 in Lamar, and Sec. 5 in Fannin county, at 1900 varas, corner between Sect's. 68 & 67 stands 3 vs. West of our eighth mile post, set at this point, which is marked 8. M.

NINTH MILE;

Continued South, with lines of 67th. Section on East and Sect. 5 & 4 on West, passing their corner at 515 varas, at 1900 varas, set 9th. Mile post, marked 9. M.

TENTH MILE;

Continued South, at 770 passed corner of Sec. 3 & 4 on the West, in all South, 1900 varas, to the tenth mile post, marked 10. M.

ELEVENTH MILE;

Continued South with lines of Sec. 66 & 65 on East at 837 vs. corner between Sec. No. 2 & 3, on South, at 1900 varas set our 11th. Mile post, mk'd. 11. M., 3 varas East of sub-div. cor. in East line of No. 2.

TWELFTH MILE;

Continued South, at 897 vs. passed N. E. cor. of Sec. 1 & S. E. cor. of Sec. 2, 3 varas West of our line, at 1180 varas a branch, 2 vs. wide C. E. at 1280 vs. a prong of Sanders creek 8 vs

wide, C. E., at 1900 vs., set 12th. Mile post, (near & S.E. of McClure's residence). Marked 12 miles.

THIRTEENTH MILE;

Continued South, at 340 varas, enter edge of brush, at 476 vs a point 37 varas East of R.H. Maxwell's N.E. corner, at 520 vs. a prong of Sanders creek, - up a branch, crossing same several times, through brush leaving branch on East and entering prairie at 720 varas, at 1366 vs. passed N.W. corner of LAMAR SCHOOL LAND at 1900 varas 13th. Mile post, Mk'd 13. M.

FOURTEENTH MILE;

Continued S. at 110 varas, passed 42 vs. West of MAXWELL'S S. E. corner, at 198 passed 15 vs. East of A. J. Musick's chimney, at 1100 varas MARY JOHNSON'S North line, 2063 varas East of her N. West corner, our line passing 33 vs. East of J. J. CRAVEN'S S. E. corner, set in said line, in all South 1900 vs. set 14th. Mile post, Mk'd 14 M.

FIFTEENTH MILE;

Continued South, at 432 varas a Paris & Honey Grove road, at 1380 varas a ravine, at 1560 vrs. same ravine, at 1900 varas, set 15th. Mile post, Mk'd 15. M.

SIXTEENTH MILE;

Continued South, at 1000 varas Paris & Honey Grove road, at 1520 varas a branch Iv. wide, Course S. E. at 1580 South line of MARY JOHNSON'S survey, at 1900 varas set 16th. Mile post, Marked, 16. M.

SEVENTEENTH MILE;

Continued South, at 45 varas MARCUS BRINKLEY'S North line at 160 varas center of T. & P. R. R., at 620 vs. brush, at 1900 vs. set 17th Mile post, at edge of brush S.E. and near Mr. GRIZZARD'S residence, post Marked 17. M.

EIGHTEENTH MILE;

Continued South, at 45 varas M. BRINKLEY'S South line 428 varas East of his S. W. corner, and the North line of W.B. COX survey at 630 varas. Passed 6 varas East of MCGILL'S well, at 1900 varas Eighteenth Mile post in YARBROUGH'S field, Marked 18. M.

NINETEENTH MILE;

Continued South, at 1160 vs. South line of COX survey 302 varas East of his S. W. corner, and JOHN BULL'S North line, 192 varas West of his N. E. corner, at 1500 varas enters brush, at 1900 varas 19th. Mile post, Marked, 19. M.

TWENTIETH MILE;

Continued South, at 390 vrs. crossed road from Ben Franklin, to Honey Grove, at 1900 varas, 19th. Mile post, marked, 19. M.

... TWENTY-FIRST MILE;

Continued South, at 1350 varas brush, & timber, at 1655 varas, Tollett's creek, 15 varas wide, C. S. E., at 1900 varas set 21st. Mile post, mk'd., 21. M.

TWENTY-SECOND MILE;

Continued South, at 175 varas JOHN BULL'S South line, 156 varas West of its S. E. corner, and E. EARLY'S S. N. line, 480 vs. 5 varas East of its N. W. corner, at 740 varas National Bond, at 1521 varas EARLY'S S. line, and T. C. CHISUM'S North, 862 varas West of his E. N. E. corner, at 1900 varas 22d. Mile post, mk'd, 22. M.

TWENTY-THIRD MILE;

Continued South, at 140 varas, CHISUM'S South line, and M. E. MORRILL'S N. line, 1162 varas West of his N.E. corner, and 266 vs. E. of his N. W. corner, at 630 varas branch

C. S. S. E. , 2vs. wide, at 1900 vs. 2 3 d. Mile post, Mk'd 23 M. , and stands S. 74° E. 124 varas from W A L C O T T ' S chimney.

T W E N T Y - F O U R T H M I L E ;

Continued South, at 28 varas MORRILL'S S. line, 266 varas East of his S. W. corner, and 1957 varas West of his S. E. corner, and the North line of F R A N C I S H O L L A N D ' S survey, 122 varas East of his N. W. corner, then South crossing H O L L A N D ' S West and L Y D A Y ' S East at 740 varas, at 900 enters timber, at 1005 & 1120 a branch, course nearly South in all South, 1900 varas to the 2 4 mile post, Marked, 2 4 . M .

T W E N T Y - F I F T H M I L E ;

Continued South, 1825 varas, to the center of N O R T H -- S U L P H U R , set a post on North bank of SULPHUR, 15 varas North of the center of said stream, Post marked on N. E. face N . W . C . and on S . E . face N . W . C . An elm mk'd, X brs. W . C . i-2 vara from post. D . C .

We find at the N . E . corner of Section No. 4, in F A N N I N county, that this corner is set East of the county line, 66 varas, while the N . E . corner of No. 5, and N . W . corner of 68, sets 3 vs. West of the county line, and that Section Nos. 1 , 2 , 3 , & 4 , are run at a lower variation than the county line, the East line of No. 2 crossing the county line as shown by the red line on the Map, and ~~the West line~~ that the S . E . corner of No. 1, is 37 varas West of the county line at M A X W E L L ' S N . E . corner. M A X W E L L ' S entire East line being 37 varas West of the county line; and think, that ~~when these~~ surveys, (Sec. 1 , 2 , 3 , 4 , & 5, in FANNIN County, and 65 , 66 , & 67 in LAMAR county,) were originally made, that they run with the county line, as the original corners of 68, N. W. of 67, and N. E. of 5 , are still standing 3 varas West of the county line, as we run it; and as we are sure it was originally run.

We found that Bois d' Arc Bayou, has found a new channel, from a short distance below the N . W . corner the J A M E S G A R L A N D survey, and S . W . corner of S Q U I R E --- M A Y S ' on said Bayou, to R E D R I V E R , about one and a half miles above, and West of the old mouth, though the old channel or bed of the stream is perfect, running from the ROCK-FORD, or CLIFT crossing with the East boundaries of H . B . B U S H and J A M E S G A R L A N D , S Q U I R E M A Y S and M E R E D I T H H A R T , emptying into RED river at the N. E. corner of F . L E O N A R D , and the North West corner of the M . H A R T , surveys. We conclude from the best information to be obtained, that at this point, the South bank of the river has washed and fallen into the River, for a distance of about one hundred varas, consequently, the old bearings of HART & LEONARD'S corners, and the old bearings of ~~HART~~ of corners between LAMAR and FANNIN counties are gone.

We settled upon the old bed of Bois d' Arc as the true and original boundary line between the two counties, and point on R E D R I V E R , at which the old channel of said Bayou empties into it as the true and correct corner between L A M A R and F A N N I N counties, which point we find to be 5374 varas N . 45° E. from the R O C K - F O R D or C A R T E R C L I F T crossing. There being no ground upon which a post would likely to stand for any length of time, owing to the falling in of ~~the~~ Bank of River, we mark a Cotton-wood, C . L . F . bearing from
G.

from the present center of Mouth of Bois d' Arc, S. 1° E. 90 varas.

The line South from Rock-Ford, is marked at every mile by a substantial Bois d' Arc post, 5 feet long, and eight inches square, set in the ground three (3) feet deep, and besides the mark of the number of the end of the mile, at which each post is set, marked on South face of post, each post is also marked on South face, "C. L.", and on East face, "F", the letters and figures being artistically cut in the wood to the depth of about one-third of an inch.

In running the above line, from Bois d' Arc, through to past Sanders creek, where the old line had been marked, we ran exactly upon the old line. We also, between the 16 & 17 mile posts were on the old line, in the narrow strip of timber through which we passed. ^{again} in timber, on Tollett's creek; and again in timber on L Y D A Y ' S survey on the last 2 miles of the line.

The survey began on the 17th. day of February, and ended on the 14th. day of April, 1885. J. N. Patterson, M. B. Keithly, and Latrobe Cooper were Chainmen, Jas. H. McRady, was Marker and B. M. Patterson, Flagman.

Thos. H. Skidmore, Lamar Co., }
M. Keithly, Fannin Co., } *Surveyors*

We, Thos. H. Skidmore, Surveyor of Lamar County, and M. Keithly, Surveyor of Fannin County, do hereby certify, that the above and foregoing pages are a true copy and correct field-notes of the line between L A M A R and F A N N I N counties, as the same was run by us, that the line was carefully and correctly run, and all objects of note, on or near the line are noted and described in said field-notes, and that the diagram accompanying same is a correct Map of same and surveys on each side of line.

Witness our hands, this 23d. day of April, 1885.

Thos. H. Skidmore, Surveyor, L. C.,
M. Keithly, " " F. C.

THE STATE OF TEXAS, }
L A M A R C O U N T Y, } I, Chas. B. Pegues, Clerk
of the County Court of Lamar county, Texas, do hereby certify, that the above and foregoing and annexed pages and diagram, are a true and correct copy of the original field-notes and Map of the county line between L A M A R and F A N N I N counties, returned to the County Commissioners Court of said Lamar County, at the M A Y term, A . D . 1885, thereof, and recorded by me in Minute Book, No. 4 on pages 34, 35, 36, 37, 38, 39,, 40 and 41.

Given under my hand and the seal of said Court . . . at my office, in the City of Paris, this the 20. th. day of M A Y A . D . 1885 .

Chas. B. Pegues Clerk,
County Court, Lamar County, Texas.
By Austin Pollard Deputy.

B By Austin Pollard Deputy.

MAP

Fannin & Lamar County Line.

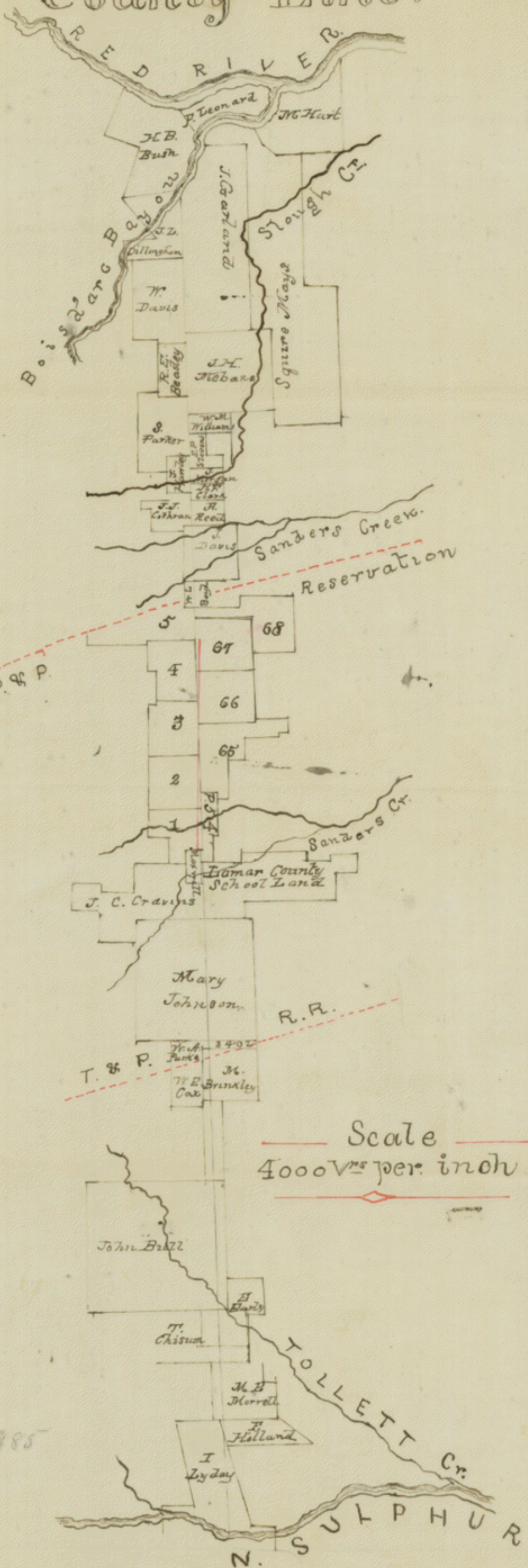

200
LAMAR

Surveyed
From 17th Feby
to
14th day April 1885

