

Field notes & Plot of boundary line between Lampasas
and Burnet Counties -

It appearing to the court that the Boundary
Line between Lampasas and Burnet Counties
is not sufficiently definite and well defin-
ed, It is therefore ordered by the Court that E.
Brown Surveyor of Lampasas County Texas,
be and he is hereby appointed and authorized
to proceed to ascertain by actual survey and
legally mark the "Boundary Line" between Lam-
pasas & Burnet Counties. Beginning at the
upper corner of the Sallie House (widow of
James House) League number fourteen (14) on
the Colorado River, Thence East to a point
N 30° West from the point on the Lampasas River
where the lower line of the W P Reese survey
crosses the same, said survey to be made, run
Established and marked according to Law.

It is further ordered by the Court that E Brown
Surveyor as aforesaid proceed to make said
survey on the 19th day of May 1890 at 12
o'clock noon and to co operate with any person
duly appointed by the proper authority of Bur-
net County and reporting to assist in said
work. It is further ordered by the Court that
a certified copy of this order be sent to the
County Court of Burnet County Texas.

In obedience to and compliance with the above
and foregoing order I proceeded to the N.W. Corner
of the Gas House League Survey N° 14 on the
Colorado River and was there at 12 o'clock noon

May 19th 1890 to begin the survey as ordered. No
one appearing from Burnett County to cooperate
and assist in said survey I proceeded to
qualify Chain Bearers and make the survey
according to article 691 a: Beginning at the
S.W. Corner of the Gas House Survey No 14 as
Established at Goat Head Bluff on E Bank of
the Colorado River by the Burnett County sur-
veyors, I proceeded to meander down the river
found the S.W. Corner of the Gas House survey
as Established with 1 L.S. Bearing mark H this
making said survey 2610 vs between its N^{ed} &
lines instead of 2550 vs as called for in its
field notes, I then proceeded down the river
with my Chain Bearers and guides to the lower
line of the Fredrick McKnight survey No 9 the
S.W. Corner of this survey, being sufficiently
definite, I proceeded to run East along an
ancient well defined line on which is built a
Post and wire fence at 2850 vs I proceeded to
run North at 2638 vs N.B. Line of said McKnight
survey. Thence N at 1892 vs the common line be-
tween the two Tho^s Messon survey's line well
defined Thence N at 1800 vs N.B. Line of the upper
Messon survey line anciently marked.
Thence N at 1323 vs the N.B. Line of the Asa
Fowler survey a well defined line anciently marked.
Thence N at 950 vs the S.B. Line of the Gas House
survey No 14 as Established by and surveyed
from by all the previous surveyors of Burnett County

as shown by their placing the N corner of the two Bonans & Paul Jones Sur as said line, Thence N at 2610 vs the N.B. Line of the Jas House survey N^o 14 as established by surveyors Motley, Moses & Chamberlain of Burnet County, This line is just 22800 farther North than the Field notes of the survey from the F M Knight lower line up north call for said line to be, But all of Burnet County surveyors having agreed on this line and having had Land "patented" from said line, I thought it just right and proper to "move up" to this point, giving Burnet County an excess of 22800 from the lower line of the Fredrick M Knight Sur N^o 9.

Here I established the S.W. Cor of Lampson as County Thence W. along an ancient and well defined line variation 9° E at 5700 vs a st end the N.W. corner of the Jas House Sur N^o 14 on Goat Head Bluff on east bank of the Colorado River which bears at this point N 55 W. by S 00 E. a deep Gulch S 36 vs.

Thence East (variation 9° E) along the North brink of a deep Gulch at 360 vs top of mountain old line marks; here I began to blaze and make two hacks above and two below the blaze to denote County line at 1110 vs a deep hollow at 1900 vs set 1st mile stone a rock monument marked on top L & B Co Line 1 mile East C.R. Thence East at 1080 vs the S.E. corner of J C Withrow and S.W. corner of Sec N^o 32 G & S F R R Co vs S. 3 vs at 1900 vs set 2nd mile stone marked L & B 2 Ms E. C. R. from

Lampasas Co. Bdry. line # 4
which a bunch of Elms Saplings brs E 100 vs Thence
East at 500 vs a cotton Wood brs S 3 vs at 852 vs
S.E. Cor of Sec N^o 32 at 1134 vs rock branch
P.O. with ancient line marks at 1900 vs Sit 3rd
Mile Stone from which a P.O. brs S 75-77.4 vs a
P.O. brs N 31-7 2 1/2 vs mkd X.

Thence East at 254 vs a Stone Division Cor of the
Homer survey made by T.A. Chamberlain Surveyor
of Burnet Co between Hugh M Rea and Gov
Jno Ireland of Austin at 920 vs a st md the
S.E. Corner of U.B. Wilson Survey a P.O. brs N 57 71.
72 vs Do West 9 vs at 1050 vs a dry branch at
1400 vs Indian Water hole at 1808 vs Riding hole
creek at 1872 vs a st md S.W. Cor of W.W. Allards
and S.E. Cor of R.R. tract a P.O. brs N 6 vs Do N 60 71.
2 1/2 vs mkd H at 1900 vs Sit 4th mile Stone from
which the S.W. Cor of the W.W. Allards Sur brs 71
38 vs Thence East at 774 vs a st md an line at
890 vs a st md S.W. Cor of W.J. Estes Sur at
1224 vs a st md the S.W. Cor of Jos Fisher at
1900 vs sit 5th mile Stone from which a P.O. brs
West 18 vs a B.O. brs E 38 vs.

Thence East at 872 vs a st md the N.E. Corner
of the Gas House survey N^o 14 as established
by Motley Moses and Chamberlain Surveyor
of Burnet County a large P.O. brs N 37 1/2 E 22 vs
Do brs N 79 1/2 vs N 21 1/2 vs at 1900 vs Sit 6th mile
Stone from which a P.O. brs N 55 W. 50 vs Marked
X. Thence East at 884 vs a branch 5 Elms mkd X
at 1335 vs Austin and San Saba Public Road

at 1740 vs the East line of the Jas A. Slack Sur
from which the S.W. Cor of the J. C. Burliman sur brs
N 156 vs at 1900 vs Set 7th mile Stone 140 vs E of Slacks
E line a L.O. brs S 45 E 15 vs.

Thence East at 1018 vs the S.W. corner of the Chancy
Williams brs N 786 vs at 1900 vs Set 8th mile Stone
from which a magnt. brs N 89 W. 24 1/2 vs Sam Capps
House brs S 65 W. E. a K Millers House brs N 60 E.

Thence East at 1332 vs a branch head waters of gul
plur at 1548 vs across come at 1900 vs Set 9th mile
Stone in Prairie a L.O. brs East. 144 vs a L.O.
brs S 28 W, Thence East 1900 vs Set 10th mile Stone
at same fence,

Thence East at 792 vs 2 L.O. brs S 71 W 24 vs marked X
at 800 vs Llans Public Road at 1890 vs a dry creek or
branch at 1900 vs Set 11th mile Stone from which
a P.O. brs N 85 W 4 1/2 vs,

Thence at 396 vs the line established between the
Byerly and Squires Surveys at a point which brs
N 17 W 2400 vs from the Common South corner of
said surveys at 1332 Sulphur Fork at 1900 vs Set
12th mile Stone a P.O. brs N 68 vs marked X,

Thence East at 1900 vs Set 13th mile Stone in the
Jas Squires Sur in Jas Abneys pasture from which
a L.O. brs S 51 E 35 vs,

Thence East at 648 vs a branch at J. A. Abneys E
line of fence at 1728 vs a branch. at 1900 vs Set
14th mile Stone a L.O. brs S 81 E vs D1 brs S 45 E
7 vs,

Thence East at 252 vs the E line of the Squires
Sur from this point the S. E. Cor of said Surveys

Lampasas Co. Bdry, line # 4
brs S 19 E 410 vs and the SW corner of the Tho
Jackson sur brs N 19 W 690 vs here we enter the
Tho W Hart sur at 12600 vs Public Road at 1440 vs a
branch at 1900 vs Sit 15th mile Stone from which
a Sp OK brs E 35 vs.

Thence East at 4320 vs a very large Cotton Wood brs S.
30 vs at 452 vs a running branch at 1900 vs Sit
16th mile Stone in the Tho W Hart Survey

Thence East at 1080 vs a Post and wire fence at
1900 vs Sit 17th mile Stone 72 vs N. of the Austin
and Lampasas Public Road in the James
Easley survey -

Thence East Crossing a branch at 900 vs a point
which brs N 19 W from the N.E corner of the
L Blair Survey 200 vs at 1900 vs Sit 18th
mile Stone a B. J. brs E 39 vs Mktl Co line

Thence East at 1110 vs two Burr Oaks at 14600 vs
Smsquit Creek at 19000 vs Sit 19th mile Stone
a L. O. brs S 75 W 10 vs.

Thence East at 140 vs the Georgetown Public Road
at 4780 vs S W Cor of John Run sur brs S 19
E 162 vs and S.E. Cor of Jno Bullberry brs N 19 W
214 vs at 1900 vs Sit 20th mile Stone in the
Seaborn Berry Survey from which a double or
"forked" Live Oak brs N 73 W 39 vs.

Thence East at 300 vs a running Stream at 1900
vs Sit 21st mile Stone in Seaborn Berry sur
vey from which a L. O. brs S 80 W 20 vs Mktl
Co. Thence East at 504 vs Pecan Creek at 710
vs the middle prong of of Pecan Creek at 1900

vs Set 22nd Mile Stone in Sec N^o 5 G.C. & S.F.
R.R. Co, Thence East at 2160 vs a branch at 450
vs E of 22nd mile Stone the N.W. Cor of the Robt
Merritt Sur brs S 19 E^{120⁰⁰} at 1900 vs Set 23rd Mile
Stone in said Merritt Survey a L.O. br N
36 $\frac{1}{2}$ vs 1.

Thence East at 1000 vs a branch at 1900 vs at 1900
vs Set 24th mile Stone in said Merritt sur
Just S of a Bluff

Thence East at 1800 vs crosses said Merritts E
line at 1900 vs Set 25th Mile Stone in Sec N^o 65
T.C.R.R. Co the S.W. Corner of the Sarah Remington
sur just S of 25th Mile Stone is two vague and
unsatisfactory to admit of being called for.
Thence East crossing the N-part Sec N^o 65 T. Land
& W. Edhuridge survey at 1800 vs panther branch
at 1900 vs Set 26th mile Stone.

Thence East at 1080 vs the S.E. Cor of W.J. Webb Sur
brs N 40 E 61 vs at 1512 vs Lampasas River at
1900 vs Set 27th mile Stone in front and S of
W Alexanders House on the M.W. Bigham survey
352 vs East of Lampasas River.

Thence East at 1090 vs the E. line of M.W. Bigham
survey from which point the S.E. Cor of said
Sur brs S 19 E, 136 vs at 1900 vs Set 28th mile
Stone in Lynch survey.

Thence East at 756 vs top of Bluff Lampasas
River brs S about 125 vs at 1440 vs a running
branch at 1900 Set 29th mile Stone a L.O. br
S 8 $\frac{1}{2}$ vs ink'd & Thence East at 1080 vs a branch
Carroll Hollow at 1900 vs Set 30th mile Stone

Lampasas Co. Bdry. Line #4

in the J & H Ridgway survey 4 Spanish oaks br S 4 vs mka 8.

Thence East at 1090 vs oak alley and Kempner Public Road at 1900 vs sit 31st mile Stone in the Benjamin Hoyt Survey a L.O. for S 47 & Back School House br N. 45 E, thence East at 396 vs Copperas Cove and oak alley Pub Road at 1900 vs sit 32 mile Stone in the William Nichols Survey.

Thence East at 480 vs a point which bears North 30° W from the point on the bank of the Lampasas where the lower line of W. O. Russ Survey crosses the same, Here according to the Statute Creating Lampasas County I set the S.E. Corner of said county a large Stone Monument or mound Marked in indelible color S.E. Cor L Co.

32 2/3 Mo E C R

Two L.O. br N 87 W 30 vs and 4 sp oaks br N 87 W 33 vs, Thence N.E. Corner of the William Nichols br thence from the S.E. cor of Lampasas County Texas N 30 W 1140 vs thence N 71 E 756 vs,

Surveyed May 19, 20, 21, 22, 23, 24, 26, 27, 28, 29, 30, 31 and June 1st 1890

Plu initial cor an E band of	W. Brown	13 days	} Qualified
col River is mka S W C L C	Hugh M. Reall	"	
at each mile the Stone is mka	H. C. Turner	1 "	} E. L. Brown
L. P. Linn and 1/2 of miles E. of	Manion Patterson	"	
the Colorado River			

I E Brown Surveyor of Lampson's County
Texas do hereby certify that the foregoing described
survey was actually made by me on the
ground in strict conformity to the order of
County Court and the Statute of the State with
aforesaid chain carriers duly qualified on the
dates given and that all the Corner Lines bound-
aries and marks of the same whether natural
or artificial are truly and correctly described
and set forth in the foregoing Plat and Field
notes
E. Brown Sur L. C. T.

Filed June 19th 1890
Recorded June 25th 1890

A. N. Key Clerk

The State of Texas
County of Lampsonas

I, A. N. Key County Clerk of Lamp-
sonas County Texas do hereby certify that the above
and foregoing is a true and correct copy of a
report of E. Brown surveyor of Lampsonas County
of the field notes and plot of the line between
Lampsonas and Burnett Counties as the same
appears of record in the minutes of the Commis-
sioners Court of Lampsonas County in Book N^o 3 on
pages 179 to 183 Inclusive

In Testimony whereof witness my
hand and seal of office this July 1st 1890

By A. N. Key County Clerk
A. T. Bowman Deputy Lampsonas Co Texas

Now on this 19th day of June 1890 Come on
to be heard and considered the report of E. Brown
County Surveyor of Lampasas County, in relation
to the running the boundary line between Lamp
sas and Burnet Counties, made by said E.
Brown under an order of this Court and
after an examination of said report and survey
of said County boundary line the same was by
the Court approved and ordered to be recorded in the
minutes of the Commissioners Court of Lampasas
County, by the County Clerk of said County, and
a certified copy of the same forwarded to the
Commissioner of the General Land Office
The State of Texas

County of Lampasas examined and found correct
a copy of the same I H Key County Clerk
in and for Lampasas County Texas do hereby
certify that the foregoing is a true and cor-
rect copy of an order of the County Commis-
sioners Court of Lampasas County, as the same
appears of record in Book N^o 3 on page
178 minutes of said Court -

In testimony whereof witness
my hand and seal of office this July
1890

By
H T Bowman Deputy

H Key County Clerk
Lampasas Co Texas

¹⁰
Certified Copy of
Plat ⁴/₄ Field note
of line between Lamp.
and Burnet Counties

Filed in the General
Land Office, July 31st 1890
R. C. Sherry
Chief Clerk.

See Letter Book #396
Page 124

20 Burnet County of Lampson

Colorado River

James House Survey
No 14

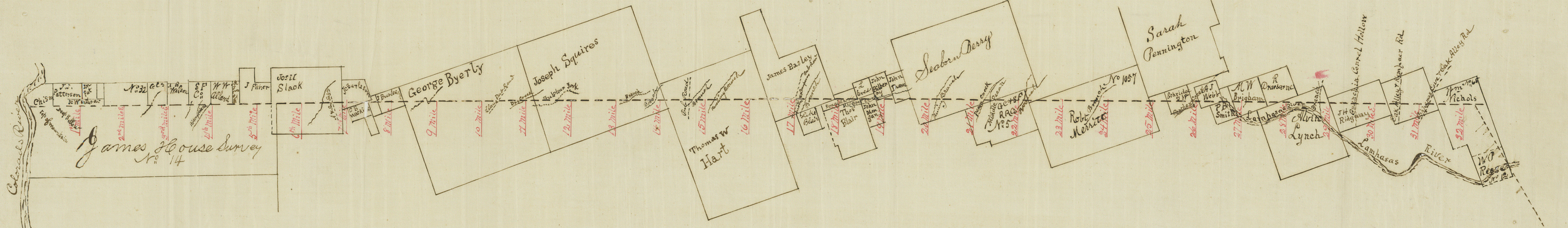

counter 56121

to BAKER

copy 20151

Lampasas Co Entry Line 4

TO BURNET

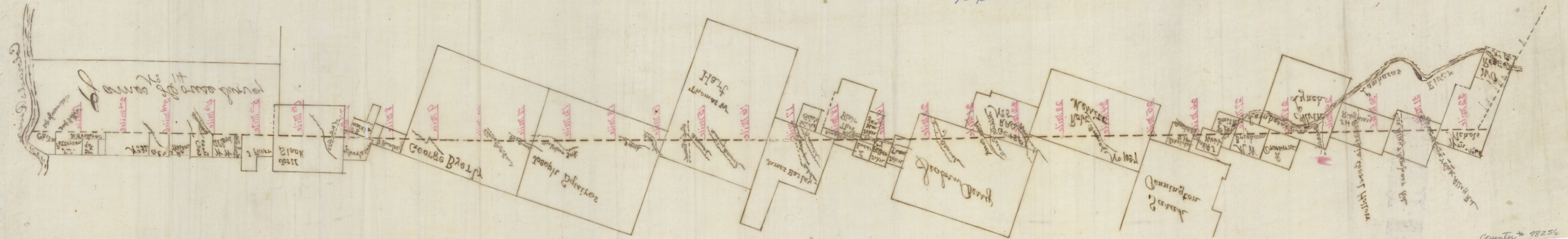

County # 78256