

LANNING SURVEY SERVICE
717 FORD ST.
LLANO, TEXAS
JULY 25, 1970

D365

✓
✓

8

JERRY SADLER COMMISSIONER
GENERAL LAND OFFICE
AUSTIN, TEXAS

ATTENTION MR. RAY WISDOM:

INCLOSED FIND PLAT OF RESURVEY OF MARY RUTH HAYNES ESTATE, BEING PARTIALLY
IN LLANO COUNTY AND BLANCO COUNTY AND DEFINITE LOCATION OF LLANO AND BLANCO
COUNTY LINE.

RESPECTFULLY SUBMITTED

E. H. Lanning
E. H. LANNING REGISTERED PUBLIC SURVEYOR & COUNTY SURVEYOR OF LLANO COUNTY, TEXAS.

RECEIVED
JUL 28 1970
General Land Office

D365

MOSES JOHNSON SUR. NO. 142 A-429

ELISIA H. WILLIAMS SUR. NO. 140 A-872

STATE OF TEXAS X
COUNTIES OF LLANO & BLANCO X
JULY 15, 1970

RESURVEY OF MARY RUTH HAYNES
ESTATE
AND DIVISION OF SAME.

BEING THAT SAME LAND DESCRIBED
IN VOL. 20 PG. 594, DEED OF TRUST
RECORDS OF BLANCO COUNTY, TEXAS

BY RESURVEY, TOTAL ACREAGE 1487,310
BEING 997,867 ACRES IN LLANO COUNTY
AND 489,443 ACRES IN BLANCO COUNTY.

Wm. BURNHAM SUR. NO. 150 A-89

J.H. BURNHAM SUR. NO. 149 A-90

495.770 ACRES
TO
ALBERT R. HAYNES

C.P. HAYNES SUR. NO. 86 A-L-1032 B.820
1374

425.270 ACRES
70.500 ACRES
LLANO COUNTY
BLANCO COUNTY
997,867 ACRES
489,443 ACRES

ANCIENT STONE MOUND
IDENTIFIED ON GROUND
BY ALBERT HAYNES, REF.
BY HIS FATHER

J. HARRINGTON
SUR. NO. 89 A-L-359

Z. TAYLOR SUR. NO. 151 A-L-719

991.540 ACRES
TO
LENORD HAYNES

R.G. STONE SUR. NO. 584

I, E.H. LANNING REGISTERED PUBLIC SURVEYOR NO. 1368 IN THE STATE OF TEXAS
AND COUNTY SURVEYOR OF LLANO COUNTY, TEXAS DO HEREBY CERTIFY
THAT THE FOREGOING PLAT WAS PREPARED BY ME FROM AN ACTUAL SURVEY
MADE ON THE GROUND, WITH CHAINMEN DULY QUALIFIED, THAT THE CORNERS,
LIMITS AND BOUNDARIES ARE JUST AS FOUND AND SET ON THE GROUND AND
SHOWN HEREON.

WITNESS MY HAND AND SEAL THIS THE 15, TH. DAY OF JULY A.D. 1970

E.H. Lanning
E.H. LANNING R.P.S. NO. 1368

E.H. Lanning
E.H. LANNING COUNTY SURVEYOR OF LLANO COUNTY, TEXAS



C.P. BREWTON SUR. NO. 533

C. PHAYNES
SUR. NO. 87

R.G. STONE SUR. NO. 584

NE CORNER S.M. PRICE SUR. NO. 98

C. PHAYNES SUR. NO. 100
A-1197
H. PETERSON SUR. NO. 667
A-717

SCALE 1" = 500 FT.
LANNING SURVEY SERVICE
LLANO 717 FORD ST., TEXAS

RECEIVED
JUL 28 1970
General Land Office

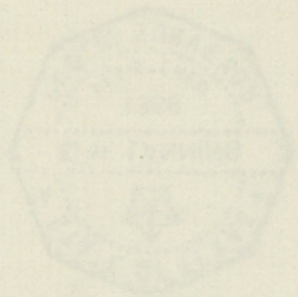

Llano Co 2 Bdry Line 3

File No. Co Line
Llano County
& Blanco
Filed July 28, 1970
JERRY S. BAKER, Comr

By _____
Co. line crossing
Haynes & Taylor
surveys
Filed for information
Bx 3-142, Tr. 5-1277

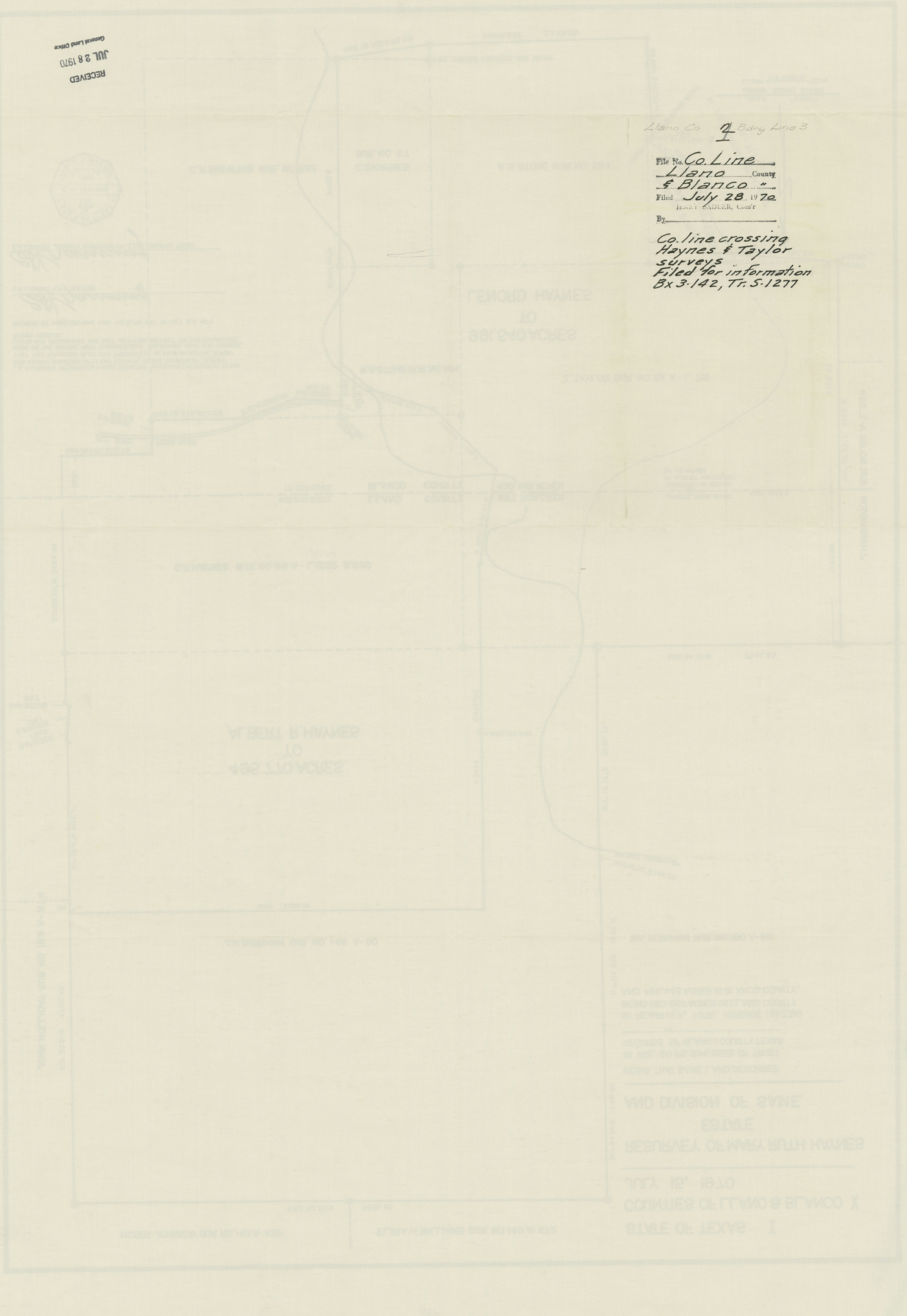

AND DIVISION OF SAME
ESTATE
RESERVED TO YAYAN RUTH HAYNES
JULY 12, 1970
COUNTIES OF LLANO & BLANCO
STATE OF TEXAS