

Mason
AND
Liano 4

Approved July 14/94

See file Mason Co. Bds

The State of Texas } To the Honorable Commissioners Court
County of Mason } of Mason County, Texas,

In compliance with an Order of your Court made at the May Term A.D. 1894. I, in company with F. A. Chamberlain, County Surveyor of Pecos County, appointed by the Commissioners Court of Pecos County, to assist in the work, proceeded on the 4th day of June 1894. to make a Survey of all lines of Original Surveys crossed by the East boundary line of Mason County, it being the West boundary line of Pecos County and run and established by Knight Stith and J. P. Stapleton in 1886,

The object of this Survey being to more definitely fix said line and to furnish data from which the Abstracts of lands in said Counties may be corrected, and I, herewith submit the following field notes, plat and accompanying explanations as my report of said work.

We found it necessary to retrace and measure the larger portion of said County line and to make our reports more intelligible, complete field notes are given of the entire line noting the distance to the points of intersection with all survey lines crossed as determined by measurement from the mile Mounds placed by said Stith and Stapleton, the distances between said Mounds to be substantially correct, with the exception that the fourth and thirteenth miles are each about 360 Varas short, and the twenty fourth mile about 900 Varas excessive.

We mention these discrepancies to explain certain call in the following field notes which might otherwise appear inconsistent and will further explain that local Attraction renders the needle unreliable on all the northern portion of said County line, which together with the fact the County line itself is not perfectly straight may account for the varying distances to the several adjacent corners which should be on the same base line.

Beginning at the S. E. Corner of Mason County and the S. E.

Corner of Platts County, as established by J^{rs} Kyle, County Surveyor of Platts County in 1887, a large stone mound marked L on the E. bank of Cherry Spring Branch, from which a forked Pecan 20 in. in dia. each prong marked L, brs N. 38° E. 7/10 Varas, a Spanish Oak 6 in. in dia. M^{k'd} X brs S. 44° E. 6/10 Varas. From this point the intersection of the S. line of Platts County with E. line of the Leroy Wilkinson Sur, N^o 131. brs E. 1271 1/2, which point of intersection is 190 Varas N. of the beginning Cor. of the Jesus Garcia Sur. N^o 600. from said County Corner we ran North at 35 Var. crossing Cherry Spring Branch at 275 1/2 large Stone M^d established by said Steth and Stapleton as the initial point of the said County Boundary and from which the Measurements were taken by them in establishing the several Mile Mounds and to which the distances on said County lines given in the following field notes all refer and from which a P.O. M^{k'd} 2 1/2 in dia. brs S. 40° N. 1 1/10 Varas,

Thence North with the line marked by said Surveyors at 1311 Var. pass 751 Varas East of S. E. Cor. Sylvanus Battle Sur, and 1081 1/2 E. of the N. E. Cor. of the Joseph Dorden Sur. N^o 130 and 1913 1/2 E. of the S. N. Cor. of said Battle Sur. N^o 128. at 1 Mile a Stone M^d at 1 mile 1077 1/2, the N. line of the Leroy Wilkinson Sur N^o 131. 1266 Var. N. of the N. E. Cor. of said Sur, and 757 1/2 E. of the N. E. of the S. Battle Sur, also the S. N. Cor. of the W. V. N. R. Co. Sur. N^o 7. at 2 Mi. a P.O. 24 in dia brs N. 9° N. 13 1/10 Varas, Do brs N. 5 1/2° E 30 1/10 Varas, at 2 Mi 1341 1/2, the N. line of said Sur. N^o 7. 1263 1/2 N. of said Sur. N^o 7 1263 1/2 N. of its N. E. Cor. and 814 1/2 E. of its N. N. Cor. and 136 1/2 N. of S. E. Cor. of a 160 acre Sub-division of State Section N^o 8 patented to Mrs Wm Marshall, at 3 Mi. M^d P.O. 18 in dia brs S. 85° N. 4 3/10 1/2 Do. 15 in dia brs N. 72 1/2° E. 68 1/10 1/2, at 3 Mi. 1439 1/2, the N. line of said 160 acres tract 1449 1/2 N. of its N. E. Cor. and 801 1/2 E. of its N. N. Cor. at 3 Mi. 774 1/2 the S. bank and 86 1/2 N. of the N. bank of Marshall's Creek, at 3 Mi. 1948 1/2 the N. line of said

Section No. 8. 1260. N. of the N. E. Cor. and 817. N. E. of the N. W.
 Cor. of the same, 457 N. of the S. E. Cor. of the Wm Von Marshall
 Sur No. 28 of a 130 acres and 455 N. E. of the S. W. Cor. of the same at
 4 mi; a P. O. 12 in dia. brs N. $10\frac{1}{2}^{\circ}$ W. $7\frac{1}{2}$ N. at 4 mi 320 N. S.
 pass 143. N. of the S. W. Cor. of State Section No. 10 at 4 mi 645
 N. of the N. line of 28. 143 N. S. of the N. E. Cor. and 455 N. E. of the
 N. W. Cor. of the same; at 4 mi 717 N. a branch at 4 mi
 1805 N. a branch, at 5 mile a Stone Mound at 5 mi 130 N.
 a branch, at 5 mile 369 N. of the S. line of the David Selverigg
 Sur. No. 24. 2102. N. of the S. E. Cor. of the same and 143. N. of
 of the N. E. Cor. of the Cornetts Colony Ditch Co Sur. And 868
 N. E. of the N. W. Cor. of the same being the N. E. Cor. of the James
 Osborn Sur. No. 115. at 6 mi a P. O. 14 in dia brs N. $24\frac{1}{2}^{\circ}$ E. $2\frac{1}{2}$ N. Do
 16 in dia brs S. 39° N. $36\frac{1}{10}$ N. at 6 mi. 1008. N. of the S. bank, 1044 N. S.
 the N. bank of Cold Spring branch, at 6 mi. 1548 N. a Rocky
 Ridge at 7 mi a mound of white rocks from which a natural
 Mt. of white rocks brs N. $11\frac{1}{2}^{\circ}$ E. $2\frac{1}{2}$ N. a P. O. 18 in dia. brs N. $30\frac{1}{2}^{\circ}$
 N. 76° N. - At 8 mile a Stone Mt. on the S. edge of a large flat rock
 on the N. side of a high hill: at 8 mi. 657 N. of the S. line of the
 John Bagley, Peague and Labor. Sur. No. 480 N. E. of the S. W. Cor. and
 2243 N. of the S. E. Cor. of the same: at 9 mi. a P. O. 15 in dia brs.
 E. $1\frac{1}{10}$ N. Do. 17 in dia brs, S. $78\frac{1}{2}^{\circ}$ N. $2\frac{1}{10}$ N. at 10 mi. a P. O. 14 dia
 brs N. 60° E. 12 N. Do. 16 in dia brs S. 20° N. $16\frac{1}{10}$ N. at 11 mi a P. O.
 12 in dia brs S. 19° E. $3\frac{1}{10}$ N. Do. 12 in dia. brs S. 56° N. $6\frac{1}{10}$ N. at 12
 mi a P. O. 12 in dia. brs N. $66\frac{1}{2}^{\circ}$ N. 15° N. a P. J. 20 in dia brs N. $45\frac{1}{4}^{\circ}$ E. $2\frac{1}{10}$
 N. at 13 mi a P. O. 18 in dia brs. N. 7° N. $15\frac{1}{10}$ N. Do 15 in dia brs N. 77° N.
 $18\frac{1}{10}$ N. at 14 Mile a P. O. 3 in dia brs N. $32\frac{1}{2}^{\circ}$ E. $8\frac{1}{10}$ N. Do. 15 in dia
 brs N. $71\frac{1}{2}^{\circ}$ N. $24\frac{1}{10}$ N. at 14 mi 259 N. a Road: at 14 mi 499 N. of the S.
 bank 468 N. of the N. bank of Indian Spring Creek: At 14 mi 701. N. a point
 on S. bank of the Peares River, whence we ran a connecting line up the
 River with its meanderings N. 78° N. 220 N. Thence N. 58° N. 560 N. to
 the N. W. Cor. of the John Bagley Sur. From the same point on the
 S. bank of the River we ran a connecting line down the River with
 its meanders S. $76\frac{1}{2}^{\circ}$ E. 816. N. Thence East 1140 N. Thence N. $7\frac{1}{2}^{\circ}$ E.

1 79 1/2 to the N. E. Cor. of Dogley Sur. at 14 Mi 775 1/2 the S. edge of the
 2 of the water in the Plains River. at 14 mi. 995 1/2, the N. edge of the
 3 same. at 14 mi 1017 1/2 a point on the North bank of said River where
 4 the S. E. Cor. of the A. Prefeste Sur. N^o 716. brs S. 70 1/2 E. 54 1/2. and the S.
 5 N. Cor. of said Sur. brs N. 70 1/2 W. 406. 1/2 at 14 Mi 1044 1/2 the Plains
 6 and Mason Road. at 15 mi a P. O. 30 in dia brs N. 18 E. 36 1/2. at 15
 7 mi 468 1/2 the S. bank 504 1/2 the N. bank of Sandy Creek. at 15 mi 576
 8 1/2 cross two large rocks the North one W. K^d on E. Side L. C. at 15
 9 mi 700 1/2 the N. line of said N^o 716. 275 1/2 N. of its N. E. Cor. and
 10 397. 1/2 E. of the N. N. Cor. of the same at 15 mi 1320 1/2 the N. line of
 11 Carl Richter Sur. N^o 715. 315 1/2 N. of N. E. Cor. and 396 1/2 E. of the N. N.
 12 Cor. of the same. at 15 mi 1320 1/2 the N. line of the Carl Richter
 13 Sur. N^o 715. 315. 1/2 N. of the N. E. Cor. and 396. 1/2 E. of the N. N. Cor.
 14 of the same. at 15 mi 1600 1/2 pass 393. 1/2 N. of the N. N. Cor. of the A.
 15 Prefeste Survey N^o 712 and 315 1/2 N. of the N. Howe Sur. N^o 713 at
 16 16 mi a P. O. 14 in dia brs S. 14 N. 38 1/2. at 16 mi 940 1/2 the N. line of the
 17 Christian Neumann Sur. 1014 1/2 N. of the N. E. Cor. and 392 1/2 E. of N.
 18 N. Cor. of the same. at 16 mi 1123. 1/2 a branch. at 16 mi 1351 1/2 the
 19 S. line of John Alseng Sur. N^o 255. 35 1/2 N. of the S. E. Cor. and
 20 975 1/2 E. of the S. N. Cor. of the same, and 1015 1/2 N. of the S. E. Cor.
 21 of the Peter Neumann Sur. N^o 256. at 17 mi a Stone M^d at 17
 22 mi 36 1/2 a branch. at 17 mi 438 1/2 the N. line of said Sur. N^o 255. 42
 23 1/2 N. of its N. E. Cor. and 955 1/2 E. of its N. N. Cor. at 17. mi 563. 1/2
 24 a branch. at 17 mi 1435. 1/2 the N. line of the John Alseng Sur N^o
 25 258. 49 1/2 N. of the N. E. Cor. and 936 1/2 E. of the N. N. Cor. and
 26 936. 1/2 E. of the N. N. Cor. of the same and 1009. 1/2 N. of the S. E. Cor.
 27 of the P. & N. O. R. R. Co. Sur. N^o 29. at 18 mi a China Stake br
 28 S. 18 yards from which Stake a P. O. 14 in dia brs N 1 1/2 E. 91 1/2 1/2
 29 Do 14 in dia brs S. 75 N. 1 1/2 1/2. at 18 mi 1523. 1/2 the N. line of said
 30 Sur. N^o 29. 1042. 1/2 N. of the N. E. Cor. and 950 1/2 E. of the N. N. Cor. of
 31 the same. at 19 mi a P. O. 14 in dia brs N. 14 E. 16 1/2 1/2 a P. O. 14
 32 in dia. brs N. 5 1/2 N. 22 1/2 1/2. at 19 mi 617 1/2 the N. line of the
 33 Stephen Dahl Sur. N^o 259. 1064 1/2 N. of the N. E. Cor. and 927
 34 1/2 E. of N. N. Cor. of the same at 19 mi 666 1/2 the S. bank and 684

1/2 the N. bank of Elm. Creek, at 19 Mi. 900 1/2 the foot of a rocky
 2 hill; at 19 Mi 1633 1/2 the N. line of the Stephen Dahl Sur. No 260.
 3 1086 1/2 N. of the N. E. Cor. and 904 1/2 E. of the N. W. Cor. of the same,
 4 at 20 Mi a Clump of P. J. bro. N. 37 1/2 N. 16 1/10 1/2 a ledge of rocks
 5 bro N. 2 1/2 E. 49 1/2 1/2 At 20 Mi. 1664 1/2 the N. line of J. V. O. R.
 6 R. Co. Sur. No 25. 1083. 1/2 N. 8 3/4 N. of the N. E. Cor. and 909
 7 1/2 S. 8 3/4 E. of the N. W. Cor. of the same, at 21 Mi. 1658 1/2 the N. line
 8 of the Theodore Stolke a P. O. 14 in dia. bro S. 6 1/2 E. of the
 9 N. W. 16 1/10 1/2 Do. 8 in dia bro S. 55 N. 9 1/2 1/2. at 21 Mi 828 1/2
 10 the top of a Ridge at 21 Mi 1618. the N. line of the Theodore Stolke
 11 Sur. No 261. 1078 1/2 N. 8 7/8 N. of the N. E. Cor. and 914 1/2 S. 8 1/2
 12 E. of the N. W. Cor. of the same, at 21 Mi 1623 1/2 pass 19 1/2 N.
 13 of the S. E. Cor. of the J. M. Echols Sur No 19. at 22 Mi a P. O. 11
 14 in dia bro N. 3 1/4 E. 11 1/10 1/2 Do. 14 in dia bro S. 4 1/2 N. 17 1/2 1/2. at 22 Mi.
 15 214 1/2 the N. line of said Echols Sur, 16. 1/2 S. 88 N. of the N. E. Cor. and
 16 955. 1/2 N. 88 E of N. W. Cor. of the same, at 22 Mi 702 1/2 the N.
 17 line of the D. Fr. Owen Sur. No 11. 16. 1/2 S. 88 N. of the N.
 18 E. Cor. and 947 1/2 N. 88 E of the N. W. Cor. of the same, 268 1/2
 19 N. of the E. line of J. C. Ry. Co. Sur. No 1 and 1392 1/2 E. of the N.
 20 line of the same, at 23 Mi. a large Rock bro S. 40 N. 13 1/10 1/2 a
 21 large Boulder bro S. 83 1/2 E. 57 1/10 1/2. at 23 Mi. 734. 1/2 the N. line
 22 of said Sur. No 1. 272 1/2 N. of the N. E. Cor. and 1385. 1/2 E. of the
 23 N. W. Cor. of the same, 669 1/2 E. of the N. W. Cor. of the old St. Lichten
 24 Sur. No 2 now forfeited. and 709 1/2 E. of the S. W. Cor. of the J. W.
 25 Miller. E. half of section 18. at 23 Mi. 1896 1/2 top of Turkeyfoot
 26 Mountain, at 24. Mi a P. O. 15 in dia bro S. 70 1/2 N. 6 8/10 1/2
 27 Do bro N. 10 E. 24 1/2 1/2; at 24 Mi 560 1/2 the N. line of said J. W.
 28 Miller Sur 276. N. of the N. E. Cor. of the same and 669 1/2 E. of
 29 the S. W. Cor. of the Ulrich Maelsch Sur No 6. 25 Mi in Dead
 30 field at 25 Mi 694 1/2 the N. line of No 6. 299 1/2 to the N. E.
 31 Cor. and 722 1/2 E. of the N. W. Cor. of the same, 704 1/2 E. of the N. line
 32 of the Tho. Perry Sur. at 25 Mile 1440 1/2 the S. bank and
 33 1572 1/2 the N. bank of San Formands Creek; At 25 Mile
 34 1664 1/2 the N. line of said Perry Sur. 299 1/2 N. of the N. E.

1 Cor, and 714 N. E. of the N. N. Cor. of the same, 26 Mi. on
 2 a large rock (natural mound) in Westerman's field, at 26
 3 Mi. by the N. line of the Jesse Hendrix Sur. No. 291 N. of
 4 of the N. E. Cor. and 729 N. E. of the N. N. Cor. of the same
 5 299 N. of the S. E. Cor. and 1749 N. E. of the S. N. Cor. of
 6 the G. C. & S. F. Ry Co. Sur. No. 1 27 Mi. Station Hedden's field
 7 at 27 Mi. 736 N. the N. line of said Sur. No. 1 342 N. of the
 8 N. E. Cor. and 1707 N. E. of the N. N. Cor. of the same 679 N.
 9 E. of a Cor. of the Charles Johnson Sur. at 27 Mi. 1794 N. the
 10 S. line of the Jesse Wallace Sur. No. 721. 393 N. of the S. E.
 11 Cor. and 625 N. E. of the S. N. Cor. of the same, at 28 Mi. a P. O.
 12 14 in dia. br. S. 72° E. 21 1/2 N. a P. O. 11 in dia. br. S. 66° N.
 13 20 7/10 N. at 28 Mi. 500 N. the Plaw and Brady Road. at 28 Mi.
 14 841 N. the N. line of said Wallace Sur. 400 N. of the N.
 15 E. Cor. and 791 N. E. of the N. N. Cor. of the same. 793. N. E. of
 16 the S. N. Cor. of the Kessel Meyer Sur. No. 15. 29 Mi.
 17 Station in Carauer's Orchard. at 29 Mi. 708 N. the N. E.
 18 Corner of Mason County and the N. N. Corner of Plaw County
 19 as fixed by Stith and Stapleton a large Stone M^d MK^d
 20 M. C. N. E. & L. C. N. W. from which a flat rock in bed of a
 21 ravine br. N. 4° E. 18 4/10 N. a D. J. Stump br. N. 29 1/2 N. a D. J.
 22 12 in dia br. N. 4 1/2 E. 19 N. MK^d M. L. the E. line of Sur. No. 15
 23 br. East 375. N. and the North line br. North 2000. Varao.

24 Bearing trees and same of the line trees on the E. Side of the
 25 line MK^d L. C. on the West side of the line MK^d M. C. Some
 26 of the Mile Mounds MK^d M. C. and L. C. with the figures
 27 denoting the number of miles from the beginning point line trees
 28 MK^d 0 Variation of C. line where there seemed to be no attrac-
 29 tion 9° 25' E.

30 J. D. Hurley } Chain Carriers.
 31 G. St. Livingston }

32 This 21st day of June A. D. 1894.

33 I hereby certify the foregoing to be true & correct
 34 J. D. Hurley, Co. Surveyor Mason Co. Texas

1 I hereby Certify that the foregoing report is correct. this
2 June 27. 1894

3 J. A. Chamberlain
4 Co. Surveyor Llanus Co. Texas,

5 Examined and Approved in open court this 6th day of July
6 A. D. 1894.

7 M. D. McKnight, Co. Judge
8 C. J. Prockmann Court Clerk No. 1.
9 E. P. Sewall " " " 2.
10 T. H. Westbrook " " " 3.
11 Frank Brandeburger " " " 4.

13 The State of Texas I, Wilson Stey Clerk of the County Court
14 County of Mason in and for said County and State do hereby
15 Certify the above and foregoing to be a true and correct copy
16 of the field-notes and map of a Survey of the East line of
17 Mason County, as the same appears of record in the Minutes
18 of the Commissioners Court of said County in Book No. 3
19 on page 69. East. East.

20 Given under my hand and seal of said Commissioners' Court
21 at Office in Mason Texas this 10th day of
22 July A. D. 1894.

23 Wilson Stey
24 County Clerk Mason County, Texas,

Mason Co Bdry Line 4

Mason and Glano Co
Boundary

Filed July 14th 1894

H. Depost
Chf Clerk

Examined and Approved

July 14th 1894

G. N. Beaumont



San Saba Co.

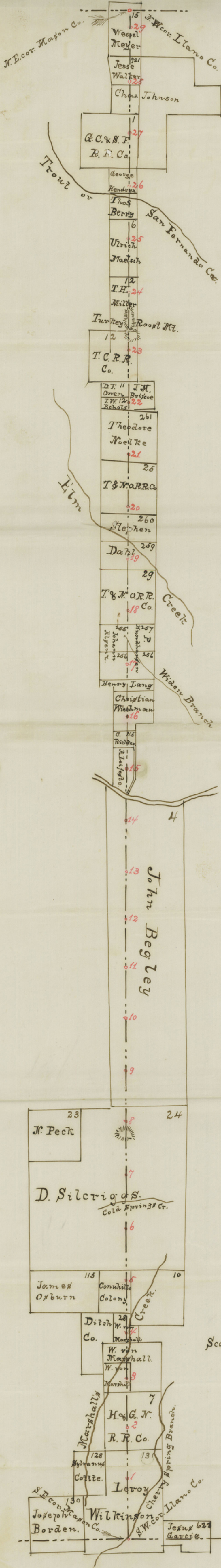

Handwritten note: ...

Scale: 2000 feet per inch.