

File No. 63

North Bdy. Line of
Moason Co.

Filed April 10th 1884

The State of Texas
County of Mason

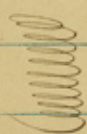

Field Notes of a
Survey of the North line of Mason
County made in accordance with an
order of the County Commissioners Court
of Mason County dated October the 2nd 1849

Beginning at the South East
Corner of McCulloch County a point 35
miles South of the N.E. cor of McCulloch
County in West line of San Saba Coun-
ty a Live Oak tree on the point of a
hill for corner tree from which a post
Oak marked \times brs $N 77^{\circ} W. 41 \frac{1}{5}$ var. an
other post Oak 12 in dia brs $S 82 \frac{1}{2}^{\circ} W. 49 \frac{2}{3}$
var. another 18 in dia brs $S 87^{\circ} W. 69$ var.
marked C. L. N. Co.

Thence West at 400 varas Mason and
Lost Creek road at one mile and 632
varas strike N. line of preemption Survey
of A. McWilliams at a point 240 varas
South of its North West corner at
one mile and 800 varas cross Lost
Creek at two miles and 128 varas San-
dy Creek at five miles and 660 varas
cross Burnett and Brady Road at six
miles and 1360 varas cross Mason and
Voca Road at 7 miles 1582 varas the
N.E. cor of A. Watts preemption Sur. N^o -
brs South 320 varas at 7 miles 1575
varas cross Katempsays Creek at nine
miles 1120 varas East line of a preemp-

Mason Co. Body Line 63-1

2

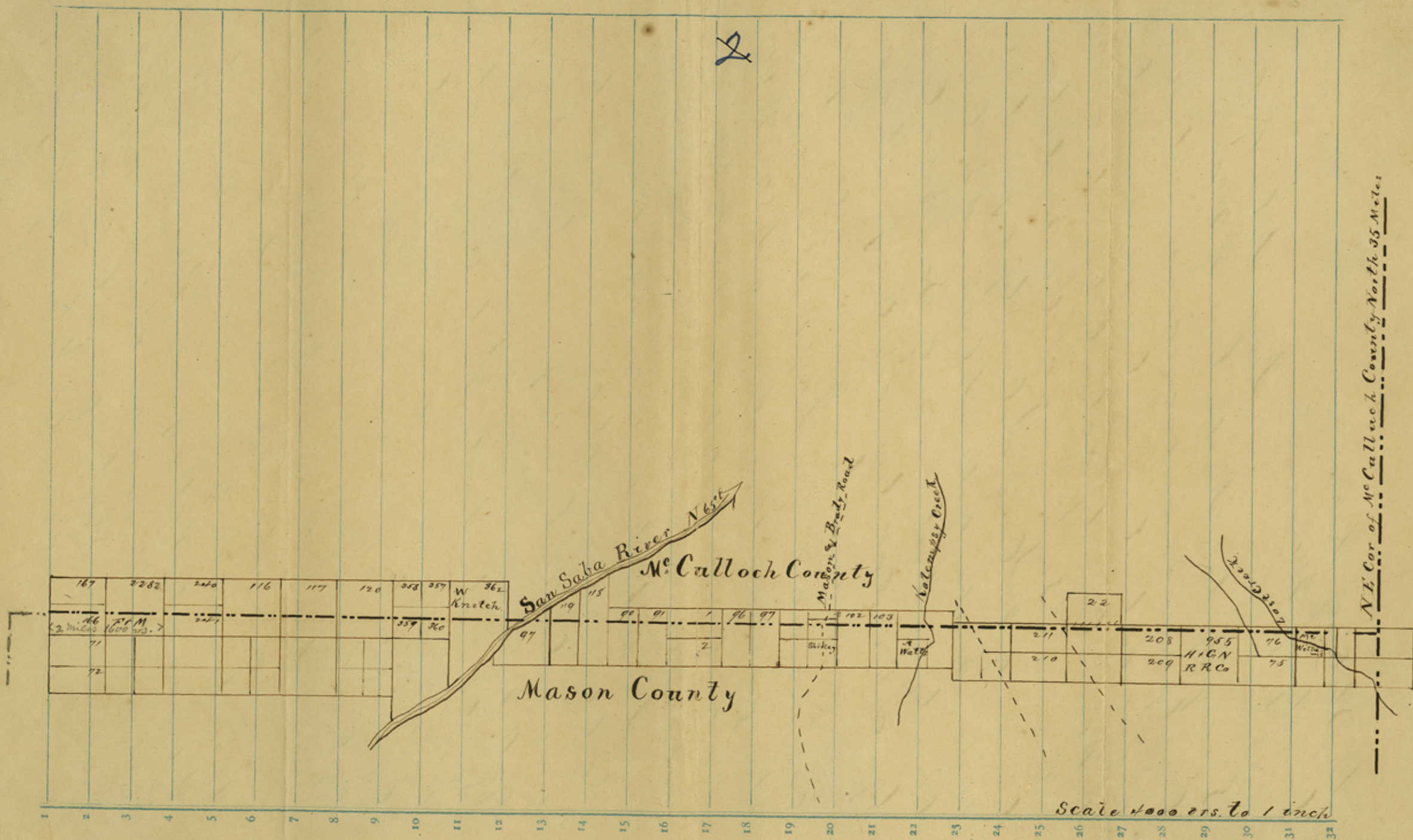

N.E. Cor. of McCall & Mason County North 35 Miles

Scale 4000 feet to 1 inch

571# Mason Co. Body Line 63-1
GEO. D. BARNARD & CO
ST. LOUIS

order 56881

1 tion Survey of 80 acres in name of -
2 Shirley the N.E. cor brs N 155 are at
3 nine miles 1340 varas ~~1340~~ varas Mason
4 and Brady City road at 13 miles 160
5 varas cross Cottonwood Creek at 15 miles
6 Bank of San Saba river at 15 miles ^{and}
7 125 varas middle of river running N65°
8 E at 15 miles and 700 varas cross
9 Camp Creek at 18 miles & 500 varas Hog
10 Creek at 21 miles and 1000 varas Calf
11 Creek at 21 and 1300 are strike West line
12 of Survey N° 241 C. Sprongler 223 1/2 varas
13 South of its N.W. corner at about 23
14 miles a mesquit tree 12 in dia mtd.
15 C.L. brs N 5 are at 24 miles and 1000
16 varas cross the Brady & Menardville
17 road at a point near where the N.W.
18 cor will stand.

19 W. H. Clark

20 County Sur. Mason Co.

21 I W. H. Clark County Surveyor of Ma-
22 son County hereby certify that the
23 foregoing Survey of the North line
24 of Mason County was made according
25 to law, that the marks natural and
26 artificial are truly described, ^{that} at each
27 mile stone mounds or stakes are
28 established as the Law directs, that
29 the work was actually done in the
30 field.

Oct 29. 1879.

31 W. H. Clark

32 Co Sur Mason Co

63/

Mason Co. Boundary Line
Field Notes and Maps

part of
of North line of Mason's

Certified Copy
filed May 20/84

The Surveyor should be notified of
the receipt of the field notes, but that
the line cannot be accepted as correct
- because the County of W. Bullard has
not agreed in running said line.
There is also no proof - that the
beginning point is correct.
also no. mile posts set.
May 21/84 B. W. Puffer



The State of Iowa
County of Mason the County Court of Ma-
son County do hereby certify that the fore-
going field notes and maps of the North
Line of Mason County as a true and cor-
rect copy of the original now on file
in my Office.

Given under my hand and Seal of Of-
fice at Mason this 9th day of June
A.D. 1884 William Hoy

Wm. Hoy
County Clerk
County of Mason
Iowa

Filed April 10th 84

32
31
30
29
28
27
26

col. 5683