

State of Texas
County of Medina

Field notes of the Eastern boundary

ry line of Medina and Western boundary line of Bexar County,
as surveyed by the undersigned and party, in accordance with the
law, passed April the 17th 1873, approved April. 2th 1873, for the enlarge-
ment of Medina County, and according to a decree passed by the
honor. the Police Court of Medina County April. 21th 1873.

Beginning at a Stake on South bank of Medina river, the
N. W. corner of Survey No. 25. made for W. C. Howd, assignee
of Maria Jesusa Hernandez, it being also the former N. E. corner
of Medina County, and starting point, designated in the afore-
said law, a Sycamore 7" diam. bears N. 46 $\frac{1}{2}$ W. 7 varas, a Forked
Elm 5" diam. bears S. 4 $\frac{1}{4}$ E. 3 $\frac{3}{4}$ varas. These bearings being de-
stroyed by the high water of the Medina river, new ones were es-
tablished, as follows: a Sycamore 11" diam. ~~bears~~ mark^d M. bears
S. 4 $\frac{1}{2}$ W. 7 varas, another Sycamore 10" diam. mark^d B bears S. 4 $\frac{1}{4}$
E. 8 varas. Thence North, crossing Medina river, 40 varas to its
east bank, at 90 varas, the S. W. corner of Survey No. 14. and the S. E.
corner of Survey No. 15. made for Sam. H. Maverick, assignee of
Jose Maria Ruiz bears East 170 varas; at 7190 varas, crossing the
North boundary line of said Survey No. 15., 170 West of its N. E. cor-
ner, at 7380 varas crossing Saus Creek 7450 varas to a Monu-
ment of rock, 11090 varas to a mound of rocks, 12360 varas to the
S. E. corner of Survey No. 37. for Juana Zembrano, assignee of Juana
Delgado, 14190 varas to Potranco creek 14860 varas to another corner
17940 varas to Medio creek 18915 varas to a Stake, from which
the N. E. corner of Survey No. 33. made for John Fitzgerald bears
West 40 varas, 20510^{varas} to a rock mound on S. side of upper San Anto-
nio & Quishi Road, 24345 to a mound of rocks, 27245 varas to
a Monument of rock at the foot of the Mountains, 34815 varas to the

Medina Co. Bdry
Line #2

the old Bandera & San Antonio road or Galagher road, 37135 varas
to main San Geronimo Crick, 38035. to a Mount of rocks, 38285.
varas to the West brong of San Geronimo, crick and a mount of rocks
on its S. bank 38765. varas to the public road from Bandera to
San Antonio, 39005. varas to middle brong of San Geronimo crick
from this point the N. W. corner of 320 Acre Survey No. 181.
made for A. Charis and now occupied by Manuel Hernandez,
bears East 333 varas, 47705. varas to a monument of rock on the
Bandera County line, from which a Mount of rocks on top of
a single round Mountain bears North at a mile distant.
Thence S. 45° W. with Bandera County line 22400 varas
to the N. W. corner of Survey No. 78. made for Dan. Arnold for
labor on E bank of Medina river.

lines mark'd on E. side B and on W. side M. and these 3 or three backs
Surveyed between May the 19th and May the 24th 1873.

John Vernett	} Chainbearers.	} Charles de Montel Co. Survey. Med. Co.
J. Parish		
Jos. Biery - marker		
G. E. Haags - guard.		
W. P. Huhner - Cook & teamster		

I Charles de Montel County Surveyor of Medina County do hereby
certify that the foregoing Survey is made according to law and that ^{the} dis-
tances, Corrections and boundaries with the marks natural and artific-
ial ~~are~~ are correctly established as described in the foregoing field
notes and that they are recorded in my office in Book A No. 1.
pages 55 & 56. at Castroville May 31st 1873. Charles de Montel
Co. Survey. Med. Co.

Presented in open Court and approved at a special
session this 30th day of June A.D. 1873.

Witness my hand and the seal of
the Police Court of Medina County
the date above written.

Joseph Kempf J. P. District No. 1.
Presiding Judge Medina Co.

M
3

Medina Co Bdry § Line 2

Field notes

Madg, Mexar & Banderat Co.
lines

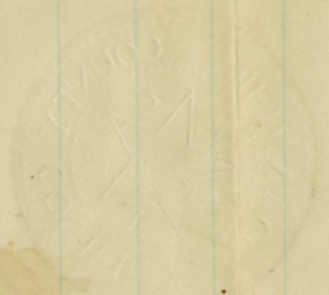

[Faint, illegible handwritten notes on the left page]

10

Given July 8, 1873
L. G. Kellum
(L. G. Kellum)

center 57029
4

Y

Bandera County.

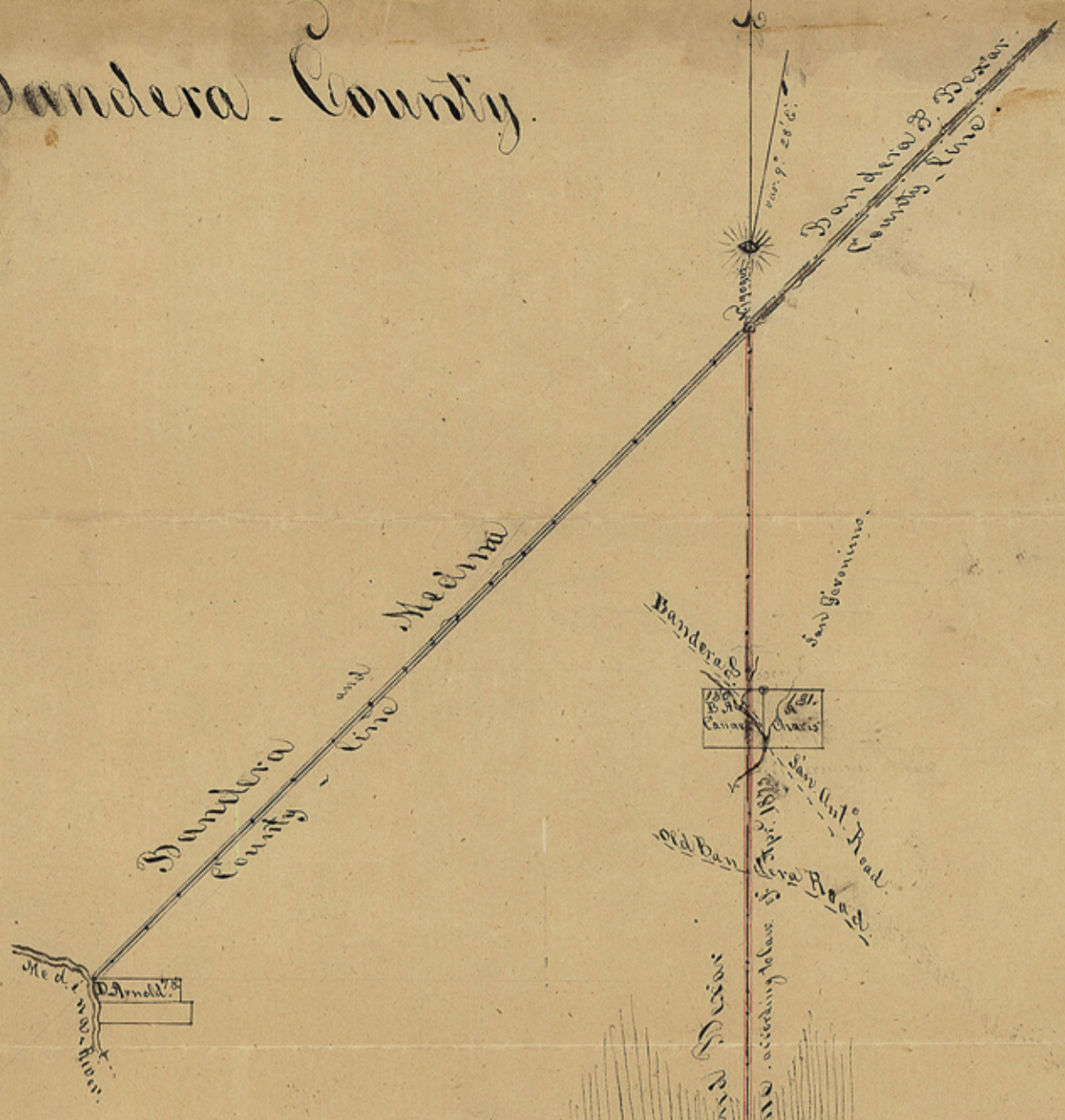

Medina County

Brewer County

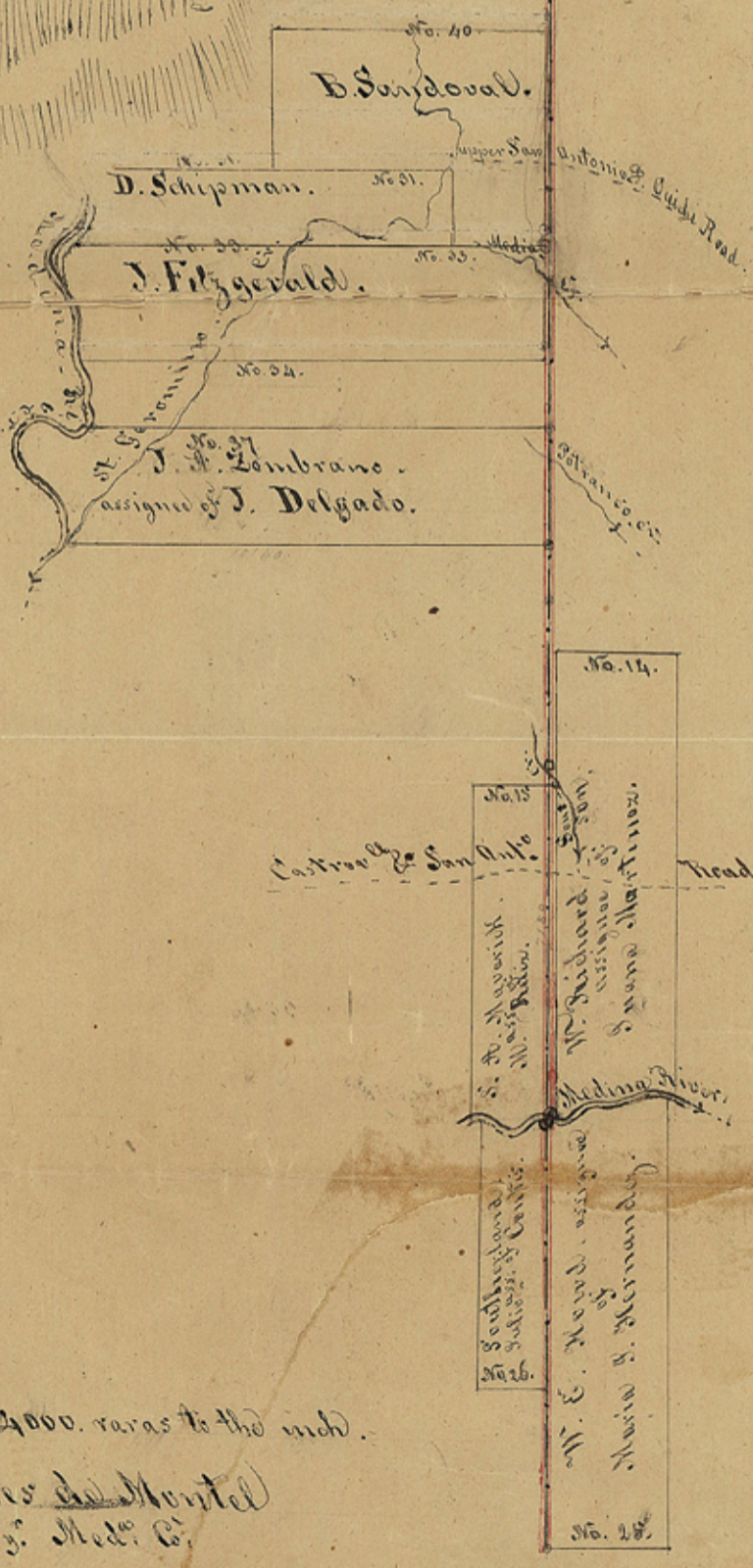

Scale 4000. varas to the inch.
 Charles A. Montel
 Co. Surg. Med. Co.

M 4