

Menard County.

Field notes of the South and
Eastline filed in the General
Land Office August 28th 1896.

Illegal, being established by
order of the County Commissioners
Court August 29/96

C. W. Peaslee

1 The State of Texas)
 2 County of Menard) To the Honorable Commissioner's Court
 3 of Menard County Texas.

4 In compliance with an order of
 5 your Court made at the February term 1896 to run, measure,
 6 mark and erect mile monuments on the west line of Menard
 7 County, and to run, measure, mark and define by mile
 8 monuments and survey connections the South line and as
 9 much of the East line of Menard County as borders on
 10 Mason County. On the 28th day of May 1896 I proceeded to
 11 perform said work. - Beginning at the Northwest corner of
 12 Menard County described as follows "to wit,"

13 A large stone and marked Corner of M.D., C.H.O.,
 14 S.C.H. & T.G. Counties June 8th 1891 from which a L.O. 10 in. marked S
 15 brs. S. 30° W. 37 1/2 vrs. Do. 12 in. marked. T brs. S. 81 1/2° W. 20 1/2 vrs. Do. 12 in. marked.
 16 T G brs. N 34 1/2° W 12 1/2 vrs. Do 6 in. marked C brs N 27 1/4° E 77 1/2 vrs a double
 17 L.O. 12 in. marked. M D brs S 59° E 148 1/2 vrs.

1st
 Mile

18 Thence South 1900 vrs a stuid marked 1 M.

2nd
 Mile

19 At 1 mile 10 vrs a stuid marked 1 mile M & S brs west
 20 5 vrs 1900 vrs a stuid 2 M from which a stuid marked 2 miles M & S brs
 21 S 16 1/2° W 27 vrs.

3rd
 Mile

22 At 1700 vrs a stuid marked 3 M.

4th
 Mile

23 At 3 miles 143 vrs a stuid marked 3 mile M & S brs west
 24 24 1/2 vrs 1900 vrs a stuid marked 4 M.

5th
 Mile

25 At 4 miles 150 vrs a stuid marked 4 mile M & S brs
 26 west 33 vrs 1900 vrs a stuid marked 5 M.

6th
 Mile

27 At 5 miles 165 vrs a stuid marked 5 mile M & S
 28 brs west 41 vrs 1900 vrs a stuid marked 6 M. a L.O. 6 in
 29 brs west 8 3/10 vrs.

7th
 Mile

30 At 6 miles 182 vrs a stuid marked 6 mile M & S
 31 brs west 47 vrs 720 vrs a L.O. 20 in marked C.L. 1900 vrs a
 32 stuid marked 7 M a L.O. 10 in brs N 77 1/2° W 42 1/2 vrs Do. 8 in brs N 35° E 33 1/2 vrs.

Menard Co. City Line 12

8th Mile
 9th Mile
 10th Mile
 11th Mile
 12th Mile
 13th Mile
 14th Mile
 15th Mile
 16th Mile
 17th Mile
 18th Mile

Memph. Co. Bdry line #12

1 At 7 miles 198^{vs} a stuid marked 7 mile MYS bro
 2 west 47^{vs} 1900^{vs} a stuid marked 8 M a large rock bro
 3 S 32° E 10^{vs} do bro N 64½° W 13¾^{vs}
 4 At 8 miles 215¾^{vs} a stuid marked 8 mile MYS bro west
 5 48¾^{vs} 1900^{vs} a stuid marked 9 M a L.O. 12 in bro South
 6 141¾^{vs} do 18 in bro N 59° E 68¾^{vs}.
 7 At 9 miles 233¾^{vs} a stuid marked 9 mile MYS bro
 8 west 52^{vs} 1200^{vs} cross a creek 1900^{vs} a stuid, marked 10 M,
 9 on north bank of a creek.
 10 At 10 miles 35^{vs} cross creek 252½^{vs} a stuid marked
 11 10 mile MYS bro west 57^{vs}. 1900^{vs} a stuid marked 11 M
 12 a large rock bro N 48½° E 4½^{vs}. do bro N 51½° W 13^{vs}.
 13 At 11 miles 265½^{vs} a stuid marked 11 miles MYS
 14 bro west 60½^{vs} 1900^{vs} a stuid marked 12 M a large rock bro S
 15 56° E 12½^{vs} do. bro N 80½° W 16¾^{vs}.
 16 At 12 miles 276½^{vs} a stuid marked 12 mile MYS
 17 bro west 63^{vs} 1900^{vs} a stuid marked 13 M a L.O. 8 in bro N 44½°
 18 W 17^{vs} do 8 in bro S 35¼° E 16½^{vs}.
 19 At 13 miles 278½^{vs} a stuid marked 13 mile MYS
 20 bro west 61¾^{vs} 420^{vs} cross a draw 1900^{vs} a stuid marked
 21 14 M a L.O. 6 in bro N 36° E 33^{vs} do 15 in bro N 9° W 85¾^{vs}.
 22 At 14 miles 301½^{vs} a stuid marked 14 mile MYS
 23 bro west 66¾^{vs} 1630^{vs} a wire fence 1900^{vs} a stuid marked
 24 15 M a L.O. 14 in bro N 3¼° E 40¾^{vs}.
 25 At 15 miles 314¾^{vs} a stuid marked 15 mile MYS bro
 26 west 67½^{vs} 1900^{vs} a stuid marked 16 M a large rock bro N
 27 62½° E 29¾^{vs} do bro S 55¼° W 9¾^{vs}.
 28 At 16 miles 335¾^{vs} a stuid marked 16 mile MYS
 29 bro west 65½^{vs} 1900^{vs} a stone set in the ground marked 17 M
 30 a pe can 24 in bro S 49° E 8¾^{vs} do 12 in bro S 43° W 15¾^{vs}.
 31 At 17 miles 356½^{vs} a stuid marked 17 mile MYS bro west
 32 66¾^{vs} 1240^{vs} the S.W. cor of survey N° 1496 bro west 258^{vs} at

T¹

1 1264 vs edge of water on north bank of San Saba river at the
2 junction of the north and south prongs at 1585 vs edge of water
3 on east side of south prong 1900 vs a stuid in edge of road
4 marked 18 M a Pecan 24 in brs S $24\frac{1}{2}^{\circ}$ E 14 vs a Spanish oak 4 in
5 brs N $68\frac{1}{4}^{\circ}$ W $23\frac{1}{2}$ vs.

19th
Mile

6 At 18 miles 300's vs a stuid marked 18 mile MYS
7 brs west 67 vs 820 vs cross a road 1900 vs a stuid marked
8 19 M a large rock brs N $67\frac{1}{2}^{\circ}$ E $1\frac{1}{2}$ vs do brs S 53° W 5 vs.

20th
Mile

9 At 19 miles 312's vs a stuid marked 19 mile MYS brs
10 west $64\frac{1}{2}$ vs 1900 vs a Cedar post marked 20 M a L.O. 14 in
11 brs N 55° E $249\frac{1}{2}$ vs a Mesquite 4 in brs S $8\frac{1}{2}^{\circ}$ W $9\frac{1}{2}$ vs.

21st
Mile

12 At 20 miles 340's vs a stuid marked 20 mile MYS
13 brs west 63 vs 1900 vs a stuid marked 21 M a L.O. 10 in brs
14 N $8\frac{1}{4}^{\circ}$ W $8\frac{1}{2}$ vs do 24 in brs N 60° E $29\frac{1}{2}$ vs.

22nd
Mile

15 At 21 miles 374's vs a stuid marked 21 mile MYS
16 brs west $67\frac{3}{8}$ vs 1098 vs cross a dry creek 1900 vs a stuid marked
17 22 M a L.O. 14 in brs N $4\frac{3}{4}^{\circ}$ E 100's vs a mesquite 6 in brs N $45\frac{1}{2}^{\circ}$ W
18 $5\frac{3}{10}$ vs.

23rd
Mile

19 At 22 miles 603's vs a stuid marked 22 mile MYS brs west
20 $75\frac{1}{10}$ vs 1900 vs a stuid marked 23 M a large rock brs N $31\frac{1}{2}^{\circ}$ E $23\frac{3}{10}$ W
21 do brs S $4\frac{1}{2}^{\circ}$ W $8\frac{1}{10}$ vs.

24th
Mile

22 At 23 miles 642's vs a stuid marked 23 mile MYS brs
23 west $78\frac{1}{2}$ vs 1900 vs a stuid marked 24 M a L.O. 12 in brs N 66° E 35 vs
24 do 6 in brs N 84° W $20\frac{1}{2}$ vs.

25th
Mile

25 At 24 miles 675's vs a stuid marked 24 mile MYS brs
26 west $79\frac{1}{5}$ vs 1512 vs cross a road 1684 vs a wire fence 1900 vs a stuid
27 marked 25 M a L.O. 15 in brs S 69° E $52\frac{3}{5}$ vs do N $86\frac{1}{4}^{\circ}$ W $40\frac{1}{5}$ vs.

26th
Mile

28 At 25 miles 708's vs a stuid marked 25 mile MYS brs
29 west $78\frac{3}{5}$ vs. 1900 vs to a large stone, 12 x 24 in $4\frac{1}{2}$ feet high set on
30 top of a high hill for the southwest corner of Merced County, marked
31 Corner of M., K., S. & S. Counties from which a large flat rock marked
32 S.S. brs due west 470 vs do marked M brs N 80° E 5 vs do marked K

T²

Menard Co. Bdry. line #12

1 bro S 80 1/4° E 16 1/2 vrs a strid wtd N.E.S. N.W.K. bro due
2 East 32 vrs a strid wtd. Corner M.S., S & K. Counties
3 bro South 854 vrs and west 81 1/2 vrs.

4 Bearings marked M. S. ⁱⁱⁱⁱ Line trees marked ⁱⁱⁱ
5 L. A. Maddux } Chain
6 R. D. Hurley } Carriers

7 Variation N 9° 17' E

8 I J. D. Hurley Special Surveyor for Menard County
9 do hereby certify that the foregoing survey was made in the
10 field and that the measurement and mile monuments are
11 correctly described in the foregoing Field Notes.

12 Given under my hand this 20th day of July
13 A.D. 1896 J. D. Hurley
14 Special Surveyor

73

SI and 185 X 03 1896

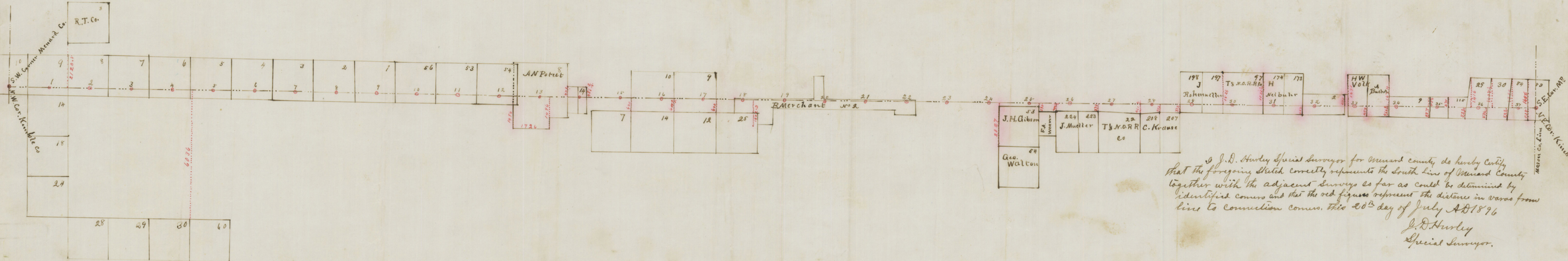

I, J. D. Hurley Special Surveyor for Menard County do hereby Certify that the foregoing sketch correctly represents the South Line of Menard County together with the adjacent surveys so far as could be determined by identified corners and that the red figures represent the distance in yards from line to Connection corners. This 20th day of July A.D. 1896

J. D. Hurley
Special Surveyor.

I concur in foregoing plat

W. T. Shope
Co. Surveyor Kimble Co.

1 Field Notes of the South line of Menard County

2 Beginning at a large Stone 12X24 inches 4 1/2 feet high set,
3 on top of a high hill, for the S.W. corner of Menard County
4 and marked Corner of M.K.S. & S Counties from which a large
5 rock marked S.S. bro west 4 7/8 ars Do marked M bro N 80° E 5' ars Do marked K bro
6 S 80 1/4° E 16 1/8' ars a stone end marked N.E.S. N.W.K bro due east 32 ars
7 A Stone end marked Corner M.S.S. & K Counties bro South 854 ars and west
8 81 1/2 ars.

9 From the aforesaid Corner S, in Company with W.D. Hope
10 appointed by the Commissioners Court of Kimble County to assist
11 in the work, did on the 4th day of June 1896 proceed to run measure
12 mark and define by survey connections and mile monuments the
13 South line of Menard County the same being the north line of
14 Kimble County.

15 Thence East at 1300 ars Cross a draw 1900 ars a stuid
16 marked 1M from which a L.O. 24 in bro N 30 3/4° E 12 1/2' ars Do 12 in bro S 42° E
17 21 1/2' ars -

18 At 1 mile 115' ars Cross a draw 124 ars Cross a road 800 ars a
19 Stone end bro N 20 20 1/2' ars and from it a stuid made by State Surveyor
20 G.M. Williams for the S.E. cor. of sur N° 3 bro east 15 1/2' ars 1900 ars
21 to a stuid marked 2M a rock bro S. 22 3/4° W. 5 1/2' ars. Do bro N 20° E
22 12 1/2' ars.

23 At 2 miles 560 ars Cross a draw 1900 ars a stuid
24 marked 3M fr. wh. a rock bro S 83° E 8 3/4' ars. Do bro N 64 3/4° E 21 1/2' ars.

25 At 3 miles 580 ars Cross a draw 1582 ars Cross a road 1630
26 ars a draw 1900 ars. A stuid marked 4M fr. wh. a L.O. 18 in
27 bro S 89 3/4° E 249 1/2' ars. Do 16 in bro N 89 3/4° E 249 1/2' ars.

28 At 4 miles ⁸⁷¹ 877 ars a wire fence, the N.E. cor N° 30
29 G.A. & S.A. Ry. Co. bro South 6036 ars. 1900 ars a stuid marked
30 5M fr. wh. a L.O. 8 in bro S 54 1/2° E 86 ars a mesquite 3 in bro
31 N 87 1/2° E 48 1/2' ars.

32 At 5 miles 1450 ars Top of divide between San Saba

1st
Mile
2nd
Mile
3rd
Mile
4 1/2
Mile
5 1/2
Mile
6 1/2
Mile

Heurich Co. Bdry. Co. #12

1 And Lane rivers 1900 vs a stuid mtd 6M fr. wh.
 2 a L.O. 6 in brs S 38 1/2° W 38 3/4 vs do 4 in brs N 87 1/4° W 40 3/4 vs.
 3 At 6 miles 490 and 705 vs cross draws of Bear creek
 4 1747 vs a wire fence 1900 vs a stuid mtd 7M a L.O. 8 in
 5 brs N 14 1/2° W 11 3/4 vs do 12 in brs S 68° W 70 vs.
 6 At 7 miles 552 vs a L.O. 20 in on east side of a draw
 7 mtd M on north and K on south side 770 vs cross a road 1420 vs
 8 cross a draw 1900 vs a stuid mtd 8M fr. wh. a L.O. 5 in brs
 9 S 56° W 9 7/8 vs do 5 in N 40 1/2° W 13 3/4 vs.
 10 At 8 miles 360 vs cross a draw 1900 vs a stuid
 11 mtd 9M fr. wh. a L.O. 5 in brs S 7 1/4° W 54 1/2 vs do 7 in brs N 32 3/4°
 12 W 58 vs.
 13 At 9 miles 1600 vs cross a draw 1900 vs a stuid mtd
 14 10M fr wh a L.O. 12 in brs S 31 1/2° E 15 1/2 vs a rock brs N 31 1/2° W 9 1/2 vs
 15 At 10 miles 140, 405 and 1745 vs cross draws 1900 vs
 16 a stuid mtd 11M fr. wh. a L.O. 20 in brs S 38 1/2° W 19 1/2 vs a
 17 rock brs N 80 1/2° E 17 vs.
 18 At 11 miles 554 vs a wire fence 1900 vs a stuid mtd
 19 12M a rock brs S 76 1/4° W 3 1/2 vs do brs N 80 1/2° W 4 3/4 vs.
 20 At 12 miles 387 vs cross a road at 636 vs the S.W. cor of
 21 Sur. No 8 A.N. Potet brs S 10° E 1476 vs and from said S.W. cor
 22 the S.E. cor of same brs east 1726 vs at 1150 vs cross a draw
 23 1900 vs a stuid mtd 13M fr. wh. a L.O. 6 in brs S 18 1/4° W 2 1/2 vs
 24 do 12 in brs N 35 3/4° E 55 1/2 vs -
 25 At 13 miles 1326 vs a wire fence, the N.W. cor of No 31 in
 26 name of Mary Tolliver brs N 478 vs at 1780 vs cross a draw 1900 vs to a
 27 stuid mtd 14M fr. wh. a L.O. 20 in brs N 8° E 60 vs do 20 in brs S
 28 7° E 59 1/2 vs.
 29 At 14 miles 282 vs the N.E. cor of No 32 brs N 48 1/2 vs
 30 1900 vs to a stuid mtd 15M fr. wh. a L.O. 18 in brs S 62 3/4°
 31 E 141 1/2 vs do 18 in brs N 56 1/2° E 80 vs.
 32 At 15 miles 355 vs cross Menardville and junction

7th Mile

8th Mile

9th Mile

10th Mile

11th Mile

12th Mile

13th Mile

14th Mile

15th Mile

16th Mile

T⁶

1. City road on east side of a draw at 523 vs the N.E. cor of sur N^o 7
 2 B & B bis S 620 vs. 1900 vs a stuid marked 16 M fr. wh. a L.O.
 3 15 in bis N 57 $\frac{1}{4}$ ^o E 48 $\frac{1}{2}$ vs DO 10 in bis S 38 $\frac{3}{4}$ ^o E 67 $\frac{1}{2}$ vs.
 4 At 16 miles 591 $\frac{1}{2}$ vs the N.E. cor of N^o 14 B & B bis S 608 $\frac{1}{2}$
 5 vs at 880 and 1284 vs cross draws 1900 vs a stuid marked 17 M
 6 a L.O. 7 in bis S 82 $\frac{1}{2}$ ^o E 12 $\frac{1}{2}$ vs DO 7 in bis N 60 $\frac{1}{2}$ ^o E 28 $\frac{1}{2}$ vs.
 7 At 17 miles 665 $\frac{1}{2}$ vs the N.E. cor of sur. N^o 12 bis S
 8 600 vs 1186 vs a draw 1600 vs the N.W. cor N^o 2 B Merchant bis
 9 N 71^o W 137 $\frac{1}{2}$ vs 1900 vs a stuid marked 18 M a L.O. 6 in marked M
 10 bis N 89^o E 83 $\frac{1}{2}$ vs DO 5 in marked K bis N 89^o E 84 vs.
 11 At 18 miles 700 vs a stuid bis S 1080 vs and S 59 $\frac{1}{2}$ ^o W 241
 12 vs and from said mid a L.O. 12 in bis S 47 $\frac{1}{2}$ ^o W 16 vs (old marks)
 13 1860 vs cross a draw of Saline creek 1900 vs a stuid marked 19 M
 14 a L.O. 7 in bis N 4^o E 28 vs DO 6 in bis S 79^o E 32 $\frac{1}{2}$ vs.
 15 At 19 miles 1320 vs cross Saline creek 1900 vs a stuid
 16 marked 20 M a L.O. 5 in marked K bis N 57 $\frac{3}{4}$ ^o W 29 $\frac{1}{2}$ vs DO 6 in marked M
 17 bis N 55 $\frac{1}{2}$ ^o W 29 vs.
 18 At 20 miles 1188 vs cross a dry creek 1900 vs a stuid
 19 marked 21 M a L.O. 6 in bis N 46 $\frac{1}{2}$ ^o W 19 $\frac{1}{2}$ vs DO 12 in bis S 61 $\frac{1}{2}$ ^o E 61 vs
 20 At 21 miles 400 vs cross draw 1900 vs a stuid
 21 marked 22 M a L.O. 5 in bis N 10 $\frac{1}{2}$ ^o E 66 vs DO 5 in bis S 30 $\frac{1}{2}$ ^o W 29 $\frac{1}{2}$ vs
 22 At 22 miles 1000 vs cross a draw 1900 vs a stuid
 23 marked 23 M a L.O. 18 in bis N 1^o E 17 $\frac{1}{2}$ vs DO 6 in bis S 62 $\frac{1}{2}$ ^o E 38 $\frac{1}{2}$ vs.
 24 At 23 miles 1562 vs a draw 1900 vs a stuid marked
 25 24 M a L.O. 10 in bis S 24 $\frac{1}{4}$ ^o E 25 $\frac{1}{2}$ vs DO 6 in marked M bis S 1 $\frac{1}{2}$ ^o E 50 vs
 26 At 24 miles 460 vs the N.W. cor of sur N^o 54 Geo. Wallon
 27 bis S 2027 vs 1254 vs cross Cummings Spring branch 1900 vs a
 28 stuid marked 25 M a L.O. 12 in bis N 21 $\frac{1}{2}$ ^o E 43 $\frac{1}{2}$ vs DO 12 in bis S 41 $\frac{1}{2}$ ^o
 29 W 50 vs.
 30 At 25 miles 485 vs the N.W. cor of F. A. Weaver preemption
 31 sur. bis S 395 vs at 1276 $\frac{1}{2}$ vs a wire fence at 1289 vs the N.E. cor of the
 32 Weaver preemption bis S 400 $\frac{1}{2}$ vs and from it a stuid bis N 50 vs 1900 vs

17th
Mile

18th
Mile

19th
Mile

20th
Mile

21st
Mile

22nd
Mile

23rd
Mile

24th
Mile

25th
Mile

26th
Mile

Menard Co. Bdry. line #12

1 a stuid noted 26 M a L.O. 8 in brs S 62 1/2° W 32 vs a rock brs N 8 1/4°
2 E 8 1/2 vs.

27th
Mile

3 At 26 miles 3400 vs ran S 360 vs to a wire fence N.E. cor
4 no 224 not found at 1348 vs the N.E. cor no 225 established by Vickroy
5 brs S 375 vs at 1860 vs cross Coon hollow 1900 vs a stuid noted
6 27 M a rock brs S 42 1/2° E 9 1/2 vs do N 73 1/2° E 6 1/2 vs R.A. Bannowsky's
7 house brs N 67 1/2° W.

28th
Mile

8 At 27 miles 1200 vs cross a draw 1372 1/2 vs a stuid brs
9 S 46 1/2 vs 1900 vs a stuid noted 28 M a L.O. 6 in brs N 48 1/4° W 15 3/4 vs
10 do 18 in brs S 68 1/2° E 25 1/4 vs.

29th
Mile

11 At 28 miles 379 vs the N.E. cor of no 208 C. Pizant
12 brs S 863 vs 700 vs a draw 1342 vs the N.E. cor no 207 & S.W. cor no
13 198 brs S 378 vs 1900 vs a stuid noted 29 M a L.O. 6 in brs N
14 76 1/4° E 18 1/2 vs do 6 in brs S 71 1/2° E 31 1/2 vs.

30th
Mile

15 At 29 miles 400 vs ran south 385 vs to wire fence
16 cor not found at 1451 vs the N.E. cor no 197 J. Rohmiller brs N 15 2/4
17 vs 1900 vs a stuid on east side of a draw noted 30 M a rock brs
18 N 5° E 7 3/4 vs do brs S 1 1/2° W 11 3/4 vs.

31st
Mile

19 At 30 miles 542 vs Bannowsky's wire fence brs S
20 485 vs cor. not found 625 vs cross Frog Spring branch 1504 vs
21 a wire fence the N.W. cor no 174 brs N 41° W 15 22 1/2 vs 1900 vs a stuid
22 noted 31 M a L.O. 5 in brs S 87° E 15 vs do 12 in brs N 20° E 35 1/4 vs

32nd
Mile

23 At 31 miles 1407 vs the S.E. cor of no 173 brs S 422 vs
24 1900 vs a stuid noted 32 M a Spanish oak 5 in brs N 35 1/2°
25 E 13 3/4 vs a L.O. 15 in brs S 33 1/2° W 51 vs.

33rd
Mile

26 At 32 miles 1100 vs W.B. Adams' house brs S 45 1/2 vs
27 1500 vs the London and Menardville road 1512 vs the N.E. cor sur. no
28 2 brs N 585 vs at 1580 vs the N.W. cor of H. Volk sur brs N 1491 vs
29 1900 vs a point in Mari Nelson's field for 33 miles fr. wh. a L.O. 16 in
30 noted C.L. brs N 89 3/4° E 589 vs.

34th
Mile

31 At 33 miles 569 vs the S.E. cor of the Volk sur. brs S 35° W
32 459 vs 1000 vs cross Little Latin Creek 1531 vs the S.E. cor of A. Buchel

+8

1 Sur bis S 2 1/2° W 46 3/4 vs at 1616 vs the N.E. cor of same bis N 14 7/4 vs
2 1900 vs a stuid in H.C. Jackson's field marked 34 M a P.O. 14 in
3 bis S 37 3/4° W 96 vs a P.O. 10 in Marked C.L. M on north and K on South
4 side bis East 560 vs.

35th
Mile

5 At 34 miles 620 vs Mason and Junction City
6 road 1552 vs the S.W. cor N° 118 bis N 486 vs at 1553 vs the S.W.
7 Cor N° 128 C.S. Co bis S 1/2° W 487 vs 1900 vs a Magnite post Marked
8 35 M a P.O. 12 in bis N 26 1/2° W 16 3/4 vs 808 in bis S 78 1/2° W 19 vs.

36th
Mile

9 At 35 miles 569 vs the S.W. cor N° 117 bis N 471 vs at
10 1359 vs the S.E. cor N° 115 bis S 528 vs at 1579 vs the N.E. cor N°
11 117 and N.W. cor N° 29 bis N 14 16 1/2 vs 1900 vs a Magnite post
12 Marked 36 M a P.O. 16 in bis S 60 1/2° E 13 1/2 vs 8016 in bis N 62 1/2° W 8 vs

37th
Mile

13 At 36 miles 415 1/2 vs the S.E. cor N° 29 bis S 586 vs at 633
14 vs the N.E. cor N° 29 bis N 1408 vs at 1374 vs the S.W. cor N° 84 bis S 542 vs
15 at 1579 vs the N.E. cor N° 30 & N.W. cor 84 bis N 1399 vs 1900 vs to a stuid
16 Marked 37 M a L.O. 14 in bis S 59° E 39 1/2 vs 8010 in bis N 54 1/2° W 53 1/2
17 vs.

18 At 37 miles 782 vs a large stone monument on west
19 line of Mason County made for the N.E. cor. of Kimble County
20 and S.E. corner of Menard County Marked N.E. of K & S.E. of M^o
21 from which a L.O. 14 in Marked M bis S 50° E 1 1/2 vs 8014 in Marked K
22 bis S 6 1/2° W 1 1/2 vs a P.O. 14 in Marked M bis N 27 1/2° W 112 3/4 vs. the S.E.
23 Cor of N° 84 & S.W. cor N° 88 bis S 538 vs and west 348 vs and the N.E. cor
24 N° 84 bis N 1406 vs and west 362 vs.

25 L.H. Maddux } Chain

26 Van. N. 9° 17' E. } Corners
R.D. Hurley

27 Bearings Marked M north & K South of line. Line trees marked

28 I J.D. Hurley Special Surveyor for Menard County do hereby
29 certify that the foregoing field notes are correct and that the South line
30 of Menard County is truly represented by the same and the accompanying

31 Plat this 20th day of July AD 1896.

J.D. Hurley
Special Surveyor

32 I concur in the foregoing report

W. T. Hoffe
County Surveyor Kimble Co. Texas

1 East Line of Menard County

2 Beginning at the Southeast Corner of Menard County
3 described in the report of the south line of same.

4 Thence North 710 vrs. to a stuid. mrtid. 15 M for Mason
5 County from which a p.o. 12 in. br. N. 39 3/4° E. 22 1/2 vrs. Do 12 in. br.
6 S. 75° W. 16 1/2 vrs.

7 At 15 miles 689 vrs. the N.E. cor. of Sec. No 83 in name
8 of Charles Dieffenbach br. East 595 vrs. at 696 vrs the N.W.
9 corner of same br W. 362 vrs. at 810 & 1100 vrs. Cross draws
10 1900 vrs. a mesquite post mrtid. 16 M a p.o. 12 in. br. S. 10° W. 31 vrs.
11 Do 24 in. br. S. 64° E. 36 vrs.

12 At 16 miles 702 1/2 vrs. the N.E. cor. of No 32 br. E.
13 673 3/4 vrs. at 703 3/4 vrs. the N.W. cor. of same br. W. 312 vrs. 1900 vrs.
14 a stuid mrtid. 17 M a Blackjacks 12 in. br. S. 7° W. 20 1/2 vrs. Do 12 in
15 br. N. 59° E. 19 1/2 vrs.

16 At 17 miles 726 1/2 vrs. a wire fence the S.E. cor. of No
17 262 br. S. 89 1/2° E. 523 3/4 vrs. the S.W. cor. of same br N 89 1/2° W 1235 vrs.
18 745 vrs. cross Mason and Junction City road 1472 vrs. Cross
19 Leon creek 1900 vrs. a stuid. mrtid. 18 M a L.O. 18 in. br N. 21° E.
20 26 1/2 vrs. Do 12 in. br. N. 39 1/4° W. 33 1/2 vrs.

21 At 18 miles 748 vrs. the N.E. cor. of No 262 and S.E.
22 cor. of No 90 br. E. 720 1/2 vrs. the N.W. cor. of No 262 br W 1234 1/2 vrs.
23 and the S.W. cor. of No 90 br. W. 234 1/2 vrs. 2100 vrs. a mesquite
24 post mrtid. 19 M a L.O. 18 in. br. S. 5 1/2° W. 55 1/2 vrs. Do 6 in. br. S.
25 13 1/2° E. 51 1/2 vrs.

26 (I subsequently found that one out of 200 vrs. had
27 been missed between the 18 & 19 mile posts, hence the call for 2100 vrs.)

28 At 19 Miles 583 3/4 vrs. the N.E. cor. of No 90 br. E. 812
29 vrs. and the N.W. cor. of same br. W. 156 vrs. 1900 vrs a mesquite
30 post mrtid 20 M a mesq. 12 in. br. N. 50° W. 12 vrs. Do 8 in. br.
31 S. 39 1/2° E 11 vrs.

32 At 20 miles 658 3/4 vrs. the S.W. cor. of No 71 br.

- 1 West 171 vrs. and the S.E. cor. of same brs. E 799 vrs 1900 vrs.
- 2 a stuid. miked. 21 M.
- 3 At 21 miles 470 vrs. cross a draw 688 vrs. a wire
- 4 fence the N.E. cor. of N° 91 (on east side of old, London & Brownwood,
- 5 road) brs. S 89½° E. 799½ vrs. 1760 vrs. top of divide between Llano and
- 6 San Saba rivers 1900 vrs. a stuid miked 22 M a rocke brs.
- 7 S. 9¾° E. 7½ vrs. Do. brs. N 83½° W 20½ vrs.
- 8 At 22 miles 632½ vrs the N.E. cor. of N° 31 brs. E. 751½-
- 9 vrs. 1900 vrs. a stuid miked 23 M a L.O. 6 in. brs. S. 82° E. 3½ vrs.
- 10 Do. 2 in. brs. N 80¼° W 18½ vrs.
- 11 At 23 miles 565 vrs the S.W. cor. of N° 70 brs. W. 1199½ vrs.
- 12 and the S.E. cor. of same brs. E. 2021 vrs. at 576½ vrs. the N.W. cor. of
- 13 N° 123 brs. W. 224 vrs. 1400 vrs the N.E. cor. of N° 70 brs. E. 2022 vrs.
- 14 1900 vrs. a stuid miked 24 M a rocke brs. S. 66° W. 18 vrs. a L.O. 6 in
- 15 brs. N. 11½° E. 51 vrs.
- 16 At 24 miles 1900 vrs a meag. post miked 25 M a p.o. 14 in
- 17 brs. S 89° E 135½ vrs Do. 15 in. brs. S 89° E 136½ vrs.
- 18 At 25 miles 140 vrs. cross Mason & Mearnsville road
- 19 540½ vrs. the S.E. cor. of N° 12 and S.W. cor. of N° 739 brs. W. 146 vrs.
- 20 1900 vrs a stuid. miked. 26 M a L.O. 15 in brs. N. 39½° W. 31 vrs.
- 21 Do. 12 in. brs. S 60½° W 36½ vrs.
- 22 At 26 miles 603 vrs. the N.E. cor. of N° 12 brs. W. 169 vrs
- 23 1900 vrs. a stuid. miked. 27 M a L.O. 8 in. brs. S. 58° E 29½ vrs.
- 24 Do 14 in. brs. N. 66½° W. 45½ vrs.
- 25 At 27 miles 736½ vrs. the N.W. cor. of N° 13 and S.W.
- 26 cor. of N° 72 brs W. 167½ vrs. 1900 vrs. a stuid. miked. 28 M a rock
- 27 brs N. 78¾° W 6½ vrs. Do. brs. S. 86° E. 9 vrs.
- 28 At 28 miles 24 vrs. Top of bluff on south side of San Saba river
- 29 114¾ vrs. To edge of water 139 vrs north bank of river 1900 vrs. a meag. post
- 30 miked. 29 M a meag. 6 in. brs. N 19° E 6 vrs. Do 5 in. brs. S 74½° W. 9 vrs.
- 31 At 29 miles 492 vrs. the S.W. cor. of N° 246 brs E 323½ vrs.
- 32 At 630 vrs cross a draw. 1451 vrs. the N.W. cor. of N° 246 and S.E. cor.

