

7
(19)
~~Jack Co~~
~~Sketch Atlas~~

Montague Co Bdry Line 3
Montague & Jack
Filed in Gen Land Office
10/6/02 L. C. Wise

12

FILED FOR RECORD
Aug 17'
11/30
S. F. Leman
Page - County Court, Jack County, Tex.

FILED
AUG 27 1902
S. O. Strong
S. O. Strong

5475

Exhibit "A".

May Term, 1902.

The State of Texas

County of Montague

Be it remembered that on this Monday, the 12th day of May, 1902, a regular term of the County Commissioners Court of Montague county was begun and holden at the Court House in the town of Montague, present and presiding the Honorable W. W. Cook, County Judge, J. F. McKee W. L. Snapp, C. C. Cooper and J. M. Singleton, County Commissioners, John W. Raines, Sheriff, and S. P. Strong, County Clerk and exofficio Clerk of said Court, when and where the following proceedings were had, to-wit:

x x x x x x x x

#600. County Boundary
Survey and Marking of

In the County Court of Montague County, Texas,
May 14th, 1902.

It appearing to the satisfaction of the County Court of Montague county, Texas, that the boundary between said Montague county and Jack County is not sufficiently definite and well defined: It is hereby ordered adjudged and decreed by the County Court of Montague county, Texas, that W. A. Morris be and is hereby appointed to ascertain by actual survey the entire boundary between the said counties of Jack and Montague: the same being described as follows, to-wit: Beginning at the northwest corner of Wise county, thence due west with the north line of Jack county and the south line of Montague county four miles (4) to the southwest corner of Montague county. Thence due north with the west line of Montague county to an intersection of the south line of Clay and the north line of Jack counties as said line between Jack and Clay is now established and to mark and establish the said line and corners in the manner prescribed by law.

The said W. A. Morris is further herein and hereby ordered to begin and commence said survey on Tuesday the 10th day of June, 1902, at the northwest corner of Wise county and to run, survey, mark and establish said line and corners as above described.

It is further herein and hereby ordered that the county clerk of Montague county, Texas, be and is instructed to make a true and correct

Montague Co. Boundary Line 3

certified copy hereof and cause the same to be properly addressed, stamped, posted and mailed to the County Judge of Jack County, at Jacksboro, Texas, on or before the 17th day of May, 1902, and the said Clerk shall note in the Minutes of this Court immediately following this order, the day and hour of his compliance herewith.

W. W. Cook, County Judge in and for
Montague county, Texas.

May Term, 1902. Commissioners Court.

The above and foregoing order is approved and adopted by the Commissioners Court of Montague county, Texas, and ordered to be observed in all things and to be placed upon the minutes of this Court.

A certified copy of the foregoing order was inclosed in an envelope properly addressed, stamped, posted and mailed to the County Judge of Jack county, Jacksboro, Texas, on the 16t day of May, 1902, at 8 o'clock A. M.

S. P. Strong, Clerk of the County
Court of Montague Co. by R.D.Rugeley Jr,
Deputy.

Exhibit "B".

Wednesday, June 11th. 1902.

It is ordered by the Court that George Spiller an experienced and competent practical surveyor proceed on the 16th day of June, 1902, to assist W. A. Morris, appointed by the County Court of Montague county in running and establishing the boundary line between the counties of Jack and Montague.

To the Hon. County and Commissioners Courts of the Counties of
Montague and Jack, State of Texas:

Whereas there was a certain order promulgated by the County and Commissioners Courts of the county of Montague, Texas, authorizing and directing W. A. Morris to run and establish the boundary line between Montague and Jack, which order is duly recorded in Minute Book "F" on page 256 of the Minutes of the Commissioners Court for Montague County, Texas, a copy of which order is hereto attached and marked Exhibit "A".

And Whereas, a copy of said order was duly and legally served on the County and Commissioners Courts of Jack County, Texas, as required by Article 802 of the Revised Civil Statutes of the State of Texas, and the said County and Commissioners Courts of Jack county, Texas, acting upon said notice and order, passed and entered an order which is duly recorded in Minute Book 8 on page 73, of the Minutes of the Commissioners Court for Jack county, Texas, and a copy of which order is hereto attached and marked Exhibit "B" authorizing, appointing and directing George Spiller to proceed at the time and place specified in said order issued by the said Montague county to assist in running and establishing said line as required by law:

Therefore in obedience to the said above described orders, we W.A. Morris and George Spiller met at the appointed place to-wit: The northwest corner of Wise county and proceeded to run, survey, measure, mark and establish said boundary line between the said Counties of Montague

Montague Co. Bdry. Line #3

and Jack as required by law and specified and designated in said above named orders, and now beg leave to submit to said Courts the following report:

FIELD NOTES.

Beginning at the northwest corner of Wise county as now established 3 stones set in the ground, the center one marked N.W.cor. W. and a mound of rock piled around the three stones, from which corner a ten inch P. O. bears N 53° E 12, 1-2 varas, and a 8 inch P O bears S 5° E, 12½ varas. Thence west at 250 vrs. a dry branch, course north, and at 490 varas a rocky dry branch course north, and at 816 varas a drain course southeast, and at 1395 varas cross the lower Bowie and Jacksbor road, and at 1744 varas cross the west line of Section No. 50 E. T. R.R Co. 325 varas north from the S.W. Corner of said Section No. 50 E.T. R.R.Co. and the same distance north from the south east corner of Section No. 49, E. T. R.R.Co. and at 1900 varas a stone set for the first mile corner:the said stone marked on the east side ^I M, and on the north side M and on the south side J, and a mound of stone piled around this corner stone, from which corner an 8 inch P.O. bears S 78° 15' W 14, 1½ varas and an 8 inch B.J. bears N 72° 15' W 9 1/5 varas.

Thence West on the second mile at 1678 varas a small drain course north, and at 1744 varas cross the west line of Section No. 49, and the East line of Section No. 48 E. T. R. R. Co., 295 varas north from the S.W. Corner of Section No. 49 and the S.E corner of Section No. 48. E. T. R. R. Co. and at 1900 varas the second mile corner, a stone set for corner; the said stone is marked on the east side ^{II} M and on the north side M and on the south side J and a mound of rock piled around the said corner stone, from which corner stone an 8 inch P.O bears S 44° 45' W 12 varas, and a 12 inch P.O. bears S 58° 30' E 12 varas.

Thence West on the third mile, at 80 varas a deep dry rocky

(4)

Montague Co. Bdry. line #3

branch course northwest, and at 355 varas cross the head of a small rocky drain course northwest, and at 497 varas a dry rocky branch course north, and at 1234 varas a small drain course north and at 1324 varas a small drain, and at 1744 varas the west line of Section No. 48 and the east line of Section No. 47, E. T. R. R. Co., 170 varas north from the S.W. Corner of the said Section No. 48 and the S.E. corner of the said Section No. 47 E. T. R. R. Co. and at 1900 varas a stone set for the third mile corner; the said stone marked on the east side ^{III} M and on the north side M and on the south side J and a mound of stone piled around this corner stone, from which a 12 inch P.O. bears N 68° W 4, 1/2 varas, and a 15 inch P. O. bears N 5° W 13 varas.

Thence West on the Fourth mile at 180 varas pass the head of a short ravine course north and at 210 varas a ravine course north and at 763 varas cross the Newport and Crafton road, and this also being the east line of the John Lott survey 1357 varas south from the north east corner of the said John Lott survey and is also 130 varas north from the south line of Section No. 47, E. T. R. R. Co. as now established, and at 1000 varas the southwest corner of Montague county, a stone set for corner, and the said stone is marked S W Cor M, also marked J and a mound of stone piled around said corner stone, from which a 12 inch P. O. standing in a thicket of bushes bears S 23° W about 40 varas, another bears S 38° W about 40 varas.

Thence North at 112 varas a pile of stone heretofore made for the southwest corner of Montague county. thence north at 963 varas cross the Newport and Crafton road and at 1245 varas cross the north line of the John Lott survey and at 1724 varas cross the north line of Section No. 47 and the south line of Section No. 46, E. T. R. R. Co. 694 varas east from the northwest corner of said Section No. 47 and the southwest corner of the said Section No. 46 E. T. R. R. Co. and at 1850 varas cross a ravine course east, and at 1900 varas a corner heretofore made for the first mile north on the west line of Montague coun-

ty, a stone 3, 1/2 feet long and nine inches square set in ground.

Thence north at 1724 varas cross the north line of Section No. 46, and the south line of Section No. 41, E. T. R. R. Co. 620 varas east from the northwest corner of the said Section No. 46 and the southwest corner of the said Section No. 41 E. T. R. R. Co., and at 1900 varas a bois d'arc post heretofore set for the second mile north on the west line of Montague county.

Thence north 418 varas to the southeast corner of Clay county, and the most western northeast corner of Jack county as has been heretofore established between Jack and Clay counties.

We also attach hereto a plat of the said line marked Exhibit "C".

Surveyed June 17, 18, 19 and 20, 1902. Bearings marked and the line marked with five hacks.

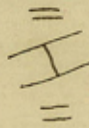

Variation of the needle 9 3' E.

W. L. Flynt *
 * Chainmen.
Walter Stewart *

S. A. Morris *
 * Flagmen.
W. M. Spiller *

We W. A. Morris, Surveyor of Montague county, Texas, and George Spiller County Surveyor for Jack County, Texas, do hereby certify that the foregoing survey of the line between Montague and Jack counties, was made by us in the field according to law and that the limits, boundaries and corners with the marks natural and artificial, are truly described in the foregoing plot and field notes.

W. A. Morris

Surveyor for Montague County, Texas.

Geo. Spiller

Surveyor for Jack county, Texas.

(6)
Montague Co. Bdry, Line #3

The State of Texas *

County of Jack *****

Be it remembered that we, the County Judge and County Commissioners holding the Commissioners Court of Jack county, do hereby certify that we have this day in open Court examined and approved of the foregoing and attached report of W. A. Morris Surveyor for Montague county, and George Spiller, Surveyor for Jack county, of the survey of the county line between Montague and Jack county.

Given under our hands and the seal of said Court, this the 12th day of August 1902.

Attest
S. L. Leaman Co Clerk
Jack County Texas
By A. M. Daniel Deputy

R. S. Blair
County Judge Jack county, Texas.

M. A. Gross
Commissioner precinct No. 1, Jack Co.

W. A. Johnson
Commissioner Precinct No. 2, Jack Co.

A. M. Christopher
Commissioner Precinct No. 3, Jack Co.

G. M. Vance
Commissioner Precinct No. 4, Jack Co.



The State of Texas

County of Jack

I, S. L. Leeman, Clerk County Court and ex-officio Clerk County Commissioners Court, in and for the county and State aforesaid, do hereby certify that the foregoing and attached report of the survey of the county line between Montague and Jack Counties, together with the plat and all the certificates, has been recorded at length in my office in Vol. 8 Pages 87 et seq, Record of the Commissioners Court of Jack County, Texas.

Intestimony whereof I hereunto set my official seal and signature
At Jacksboro, the 12th day of August 1902.

S. L. Leeman

Clerk County Court Jack County, Texas.

By A. A. McDaniel Deputy

The State of Texas

County of Montague

Be it remembered that we, the County Judge

and county commissioners holding the Commissioners Court of Montague

county, do hereby certify that we have this day in open Court examined

and approved of the foregoing and attached report of W. A. Morris, Sur-

veyor for Montague county, and George Spiller, Surveyor for Jack county

of the survey of the county line between Montague and Jack counties.

Given under our hands and the seal of the Commissioners Court,

this the 14th day of August 1902.

W. W. Cook

County Judge Montague County, Texas.

J. F. McKee

Commissioner Precinct No. 1, Montague Co.

W. L. Snapp

Commissioner Precinct No. 2, Montague Co.

L. C. Cooper

Commissioner Precinct No. 3, Montague Co.

J. M. Singleton

Commissioner Precinct No. 4, Montague Co.

Attest: *S. P. Stroug,*
Clerk County Court
and Ex-officio Clerk

Commissioners Court
Montague County, Texas.

By *R. D. Rugeley, Jr.* Deputy

The State of Texas

County of Montague

I, S. P. Strong, Clerk of the County Court

and exofficio Clerk of the Commissioners Court in and for Montague

county, Texas, do hereby certify that the foregoing and attached report

of the survey of the county line between Montague and Jack county togeth-

er with the plot and all of the certificates, has been recorded at length

in my office in Book **F** pages *293-456* records of the Commission-

ers Court of Montague county, Texas.

Witness my official seal and signature, this the *16th* day of

August 1902.

S. P. Strong

Clerk County Court Montague county, Texas.

By J. C. Strong Deputy

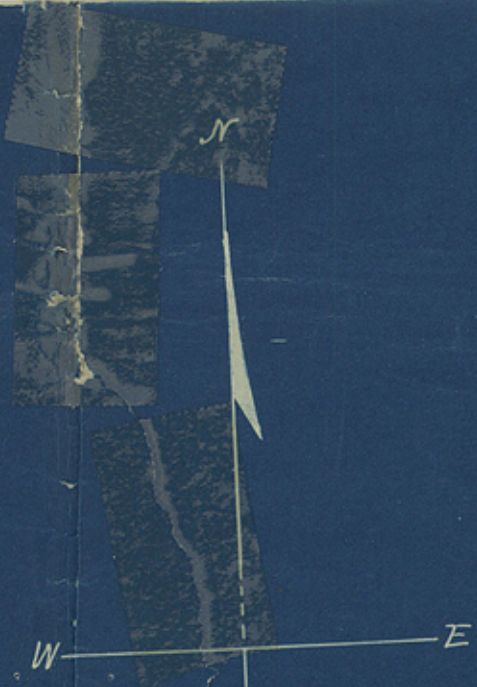

Clay Co

Montague Co

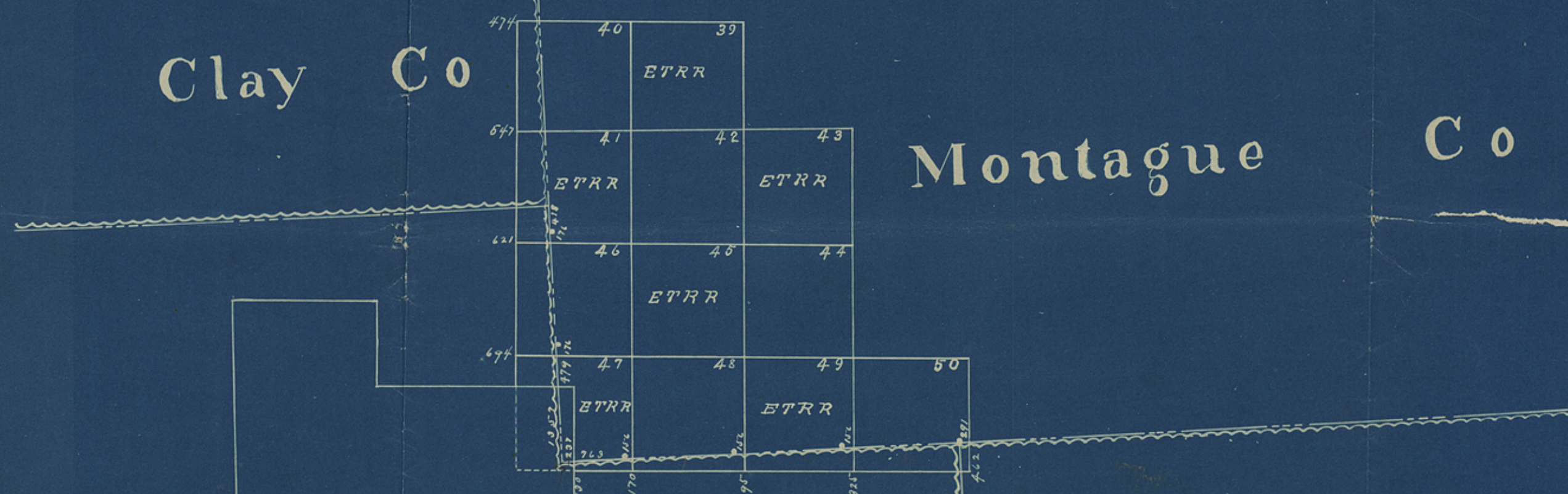

John Lott

Jack Co

Wise Co

W. A. Morris
Surveyor for Montague County

Geo. Spiller
Surveyor for Jack County