

7 REC 347

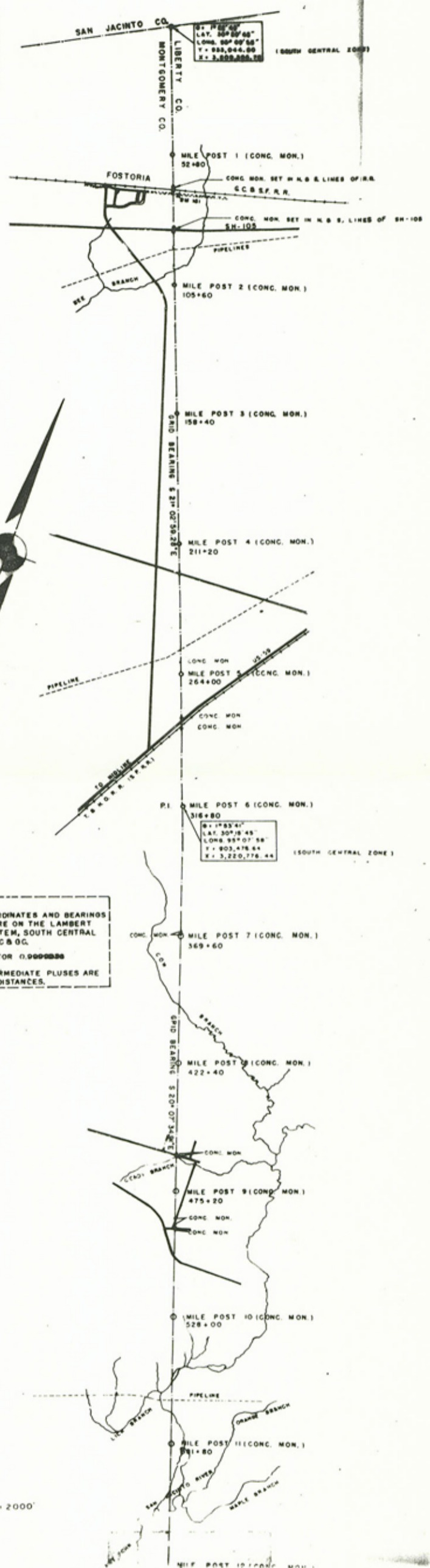
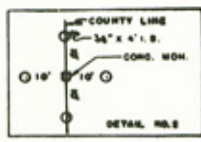

File No. County Boundary Line 3  
MONTGOMERY County  
 NW Corner Liberty Co. to Mile Post 12  
 Date Filed: Feb. 2001  
 By David Dewhurst, Commissioner  
Douglas Howard

See Liberty County Boundary Line 1 for written description.

NOTE:  
 (1) ALL COORDINATES AND BEARINGS SHOWN ARE ON THE LAMBERT GRID SYSTEM, SOUTH CENTRAL ZONE, USC & G.  
 (2) GRID FACTOR 0.9999988  
 (3) ALL INTERMEDIATE PLUSSES ARE GROUND DISTANCES.



SCALE 1" = 2000'

# A RESURVEY OF THE LIBERTY-MONTGOMERY, LIBERTY-HARRIS AND MONTGOMERY-HARRIS COUNTY LINES

Approved by  
MONTGOMERY COUNTY

*W. H. ...*  
COUNTY JUDGE

*J. S. ...*  
COMMISSIONER PRECINCT NO. 1

*H. D. ...*  
COMMISSIONER PRECINCT NO. 2

*G. ...*  
COMMISSIONER PRECINCT NO. 3

*L. ...*  
COMMISSIONER PRECINCT NO. 4

APPROVED Feb. 10, 1966

SURVEYED BY *J. D. ...*  
COUNTY SURVEYOR  
MONTGOMERY COUNTY

Approved by  
HARRIS COUNTY

*W. ...*  
COUNTY JUDGE

*W. ...*  
COMMISSIONER PRECINCT NO. 1

*W. Ramsey*  
COMMISSIONER PRECINCT NO. 2

*P. E. ...*  
COMMISSIONER PRECINCT NO. 3

*W. ...*  
COMMISSIONER PRECINCT NO. 4

APPROVED JANUARY 31, 1966

SURVEYED BY *Richard P. Doss*  
REGISTERED PUBLIC SURVEYOR NO. 1144

HARRIS COUNTY ENGINEERING DEPARTMENT

RICHARD P. DOSS - COUNTY ENGINEER

Approved by  
LIBERTY COUNTY

*John ...*  
COUNTY JUDGE

*R. ...*  
COMMISSIONER PRECINCT NO. 1

*L. ...*  
COMMISSIONER PRECINCT NO. 2

*E. ...*  
COMMISSIONER PRECINCT NO. 3

*A. ...*  
COMMISSIONER PRECINCT NO. 4

APPROVED Feb. 14, 1966

SURVEYED BY *J. ...*  
COUNTY SURVEYOR  
LIBERTY COUNTY

7-311-11