

Nov. 26, 1920.

Mr. Rupert C. Allen,
Perryton, Texas.

Dear Sir:

I have your letter of the 20th and note what you say with reference to the probability of Ochiltree County in the near future establishing its E and W boundaries, desiring to know if the N line of Ochiltree as established by W. D. Twichell is a matter of record in this office and officially recognized as the N line of Ochiltree County and also desiring any information this office can furnish regarding the proper corners from which to work in establishing the boundaries of Ochiltree Co. etc.

In reply beg to advise that the N line of Ochiltree County, as established by W. D. Twichell referred to, is the recognized boundary of said Ochiltree County. In other words, Twichell's field notes of same purport to follow the original John Clark N Boundary of the State of Texas, that being the N line of Ochiltree County. Field notes of Twichell's line were filed in this office July 18, 1898 and examined and approved July 21, 1898.

There are field notes on file in this office for the NW and S lines of Roberts County made by W. P. Hedgecope in May, 1899 and filed in this office June 18, 1899 and approved August 23, 1899 the N line of which should be the S line of Ochiltree County.

I am unable to find any field notes on file in this office for the S line of Ochiltree County made by Spiller as referred to by you.

#2. R. C. A.-----

The W line of Roberts and the E line of Hutchison Counties was run by W. D. Twichell in April, 1907, field notes of which were received in the General Land Office August 7, 1907. These field notes call to begin at the NW corner of Gray, SW corner of Roberts, SE corner of Hutchison and NE corner of Carson Counties. Thence they run N describing each mile for a distance of 30 miles marking the NE corner of Hutchison and NW corner of Roberts by a cement stone 8 by 9 by 60 inches set three feet in the ground marked H. R. 30 Mi. from whence a road bears N 6 varas; a jug set in the ground bears N 29 varas and E 19 varas a stone locally known as the SW corner of survey 55, bears S 231 varas and W 439 varas and a piece of wagon tire locally known as the NE corner of survey 181 bears S 557 varas and E 767 varas. This corner should be also the SW corner of Ochiltree and the SE corner of Hansford Counties. Whether or not it coincides with the corner fixed by Hedgecope is a matter that would have to be determined by an actual survey on the ground.

The Hedgecope survey of the S boundary of Ochiltree County is recognized by this office. However, as to the exact points for the SE and SW corners of this line, they may be subject to correction if same are found to be out of proper place.

The SE corner of Ochiltree County should be common with the SW corner of Lipscomb County. However, inasmuch as the S boundary has been marked by the Hedgecope survey that line should remain as marked whether the corners coincide with Lipscomb County or not.

#3. R. C. A.-----

See Stephens County vs. Palo Pinto
County, 155 S. W. Reporter, page 1006 and Hale
County vs. Lubbock County, 194 S. W. Reporter page
678.

Yours truly,

Clark-wb

Commissioner

Ochiltree Co Bdry Line 3

58

AG. B. O. A. -----

618
County, 188 S. W. Reporter, Page 1006 and Hale
County, 188 S. W. Reporter, Page 1006 and Hale
See Stephens County, vs. Palo Alto

Clark-nd

Yours truly,

Commissioner

477
1273.1
<hr/>
1750.1
1900.0
<hr/>
1699
403
<hr/>
1291.6

County 57680

cont 59681

103 Merula

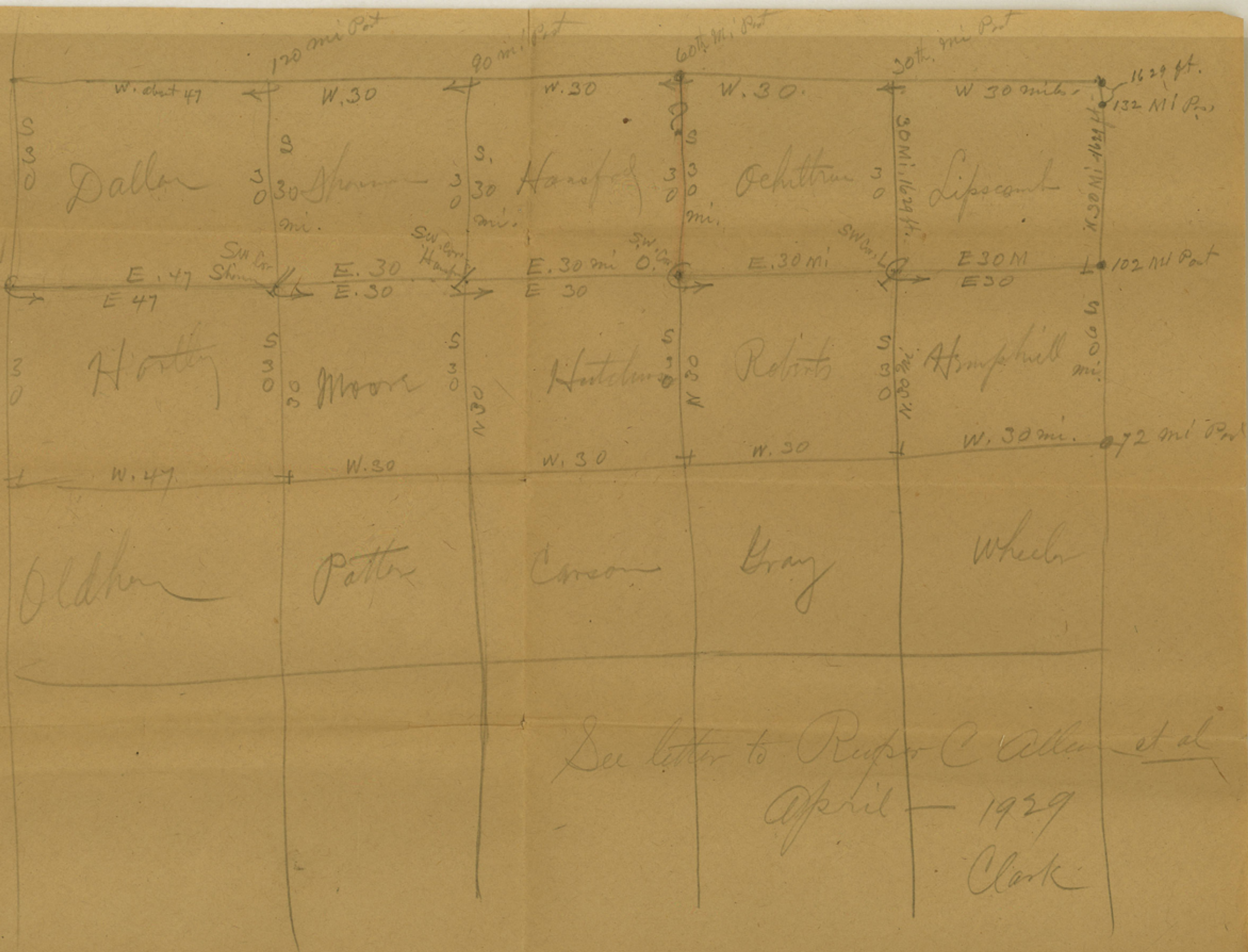

See letter to Rufus C. Allen et al
 April - 1929
 Clark