

Order 57901

Pecos Co Bdry Line 69a

County line between  
the Counties of  
Pecos

&  
Val Verde

Filed April 15/89  
Geo. H. Lewis  
Clerk

Filed May 27<sup>th</sup> 1889

The within line conforms  
so near to the one delin-  
eated on the maps of  
the above Counties nam-  
ed to justify its adop-  
tion and change of  
the Abstract.

May 27/89 Beermann

Valverde Co was not represen-  
ted in running this line  
E. D. Poyler



Field Notes of a Survey of the Boundary  
line between the Counties of Pecos and Val  
Verde, made by virtue of an order of the  
Honorable County Commissioners Court, of Pecos  
County, Pecos, dated November 19th 1888

Beginning at a stone mound, 3 ft  
high, on left bank of the Pecos river, marked  
"Pecos Co" on top, "N.W. Co" on the north side and  
"V. V. Co" on the west side; from which a large  
rock in the river bears south 20 vrs: said  
stone mound being south 1391 vrs and east  
38 vrs from the lower corner of Survey No 114  
— same being the upper corner of Survey  
No. 115 — International and Great Northern  
Ry Co.: east of which said corner of Nos 114  
and 115, at 349 vrs is a large stone mound  
— a "liner" — from which a rock marked  $\times$   
with stones piled around it, vrs S. 58 $\frac{1}{2}$  W. 123 vrs

### First Mile:

Thence South, at 20 vrs on top of a large rock  
in river at foot of right bank, at 25 vrs on  
right bank of Pecos river, at 100 vrs on bluff  
and, crossing several cañons, 1900 vrs to a  
large stone mound marked "Pecos Co line"  
on N. slope of a mountain, in the head of a  
cañon.

### Second Mile



### Second Mile:

Thence south, crossing three cañons, 1900 m to large stone mound nix'd #2 Pecos Co line" on mountain at head of a cañon

### Third Mile:

Thence south, crossing a broad valley with two dry water courses, 1900 m to large stone mound nix'd #3 Pecos Co line on N. slope of hill

### Fourth Mile

Thence south, at 2600 m on divide, and crossing a valley, 1900 m to large stone mound nix'd #4 Pecos Co line," on divide

### Fifth Mile:

Thence south, crossing three cañons, 1900 m to large stone mound nix'd #5 Pecos Co line", on table land

### Sixth mile:

Thence south, over rolling table land, 1900 m to large stone mound nix'd #6 Pecos Co line" on S. side of a drain.

### Seventh Mile:

Thence south, over rolling table land, 1900 m to large stone mound nix'd #7 Pecos Co. line", in broad flat.

### Eighth Mile

Thence south, over rolling table land, 1900 m to large stone mound nix'd #8 Pecos Co line", in a flat



Ninth Mile:

Thence south, over rolling table land, 1900 m to large stone mound nixá #9 Pecos Co line" on a slight knoll

Tenth Mile:

Thence south, over rolling table land, 1900 m to large stone mound nixá #10 Pecos Co line" on a slight rise.

Eleventh Mile:

Thence south, over rolling table land, 1900 m to large stone mound nixá #11 Pecos Co line".

Twelfth Mile:

Thence south, over rolling table land 1900 m. to large stone mound nixá #12 Pecos Co. line"

Thirteenth Mile

Thence south, over a flat, 1900 m to large stone mound ~~and~~ a 5' x 5' earth mound with flat stone on top nixá #13 Pecos Co line"

Fourteenth Mile

Thence south, over flat, at 950 m cross W. point of hill, 1900 m to large stone mound nixá #14 Pecos Co line" on W. side of a small swail

Fifteenth Mile

Thence south, at 1000 m on slight rise, 1900 m to large stone mound nixá #15 Pecos Co line" on a slaty, gravelly flat

Sixteenth Mile:

Thence south, at 1500 m over gravelly hill, 1900



17  
18  
19  
20  
21  
22  
23  
24  
25  
26  
27  
28  
29  
30  
31  
32  
33  
34  
35  
36  
37  
38  
39  
40  
41  
42  
43  
44  
45  
46  
47  
48  
49  
50  
51  
52  
53  
54  
55  
56  
57  
58  
59  
60  
61  
62  
63  
64  
65  
66  
67  
68  
69  
70  
71  
72  
73  
74  
75  
76  
77  
78  
79  
80  
81  
82  
83  
84  
85  
86  
87  
88  
89  
90  
91  
92  
93  
94  
95  
96  
97  
98  
99  
100  
101  
102  
103  
104  
105  
106  
107  
108  
109  
110  
111  
112  
113  
114  
115  
116  
117  
118  
119  
120  
121  
122  
123  
124  
125  
126  
127  
128  
129  
130  
131  
132  
133  
134  
135  
136  
137  
138  
139  
140  
141  
142  
143  
144  
145  
146  
147  
148  
149  
150  
151  
152  
153  
154  
155  
156  
157  
158  
159  
160  
161  
162  
163  
164  
165  
166  
167  
168  
169  
170  
171  
172  
173  
174  
175  
176  
177  
178  
179  
180  
181  
182  
183  
184  
185  
186  
187  
188  
189  
190  
191  
192  
193  
194  
195  
196  
197  
198  
199  
200  
201  
202  
203  
204  
205  
206  
207  
208  
209  
210  
211  
212  
213  
214  
215  
216  
217  
218  
219  
220  
221  
222  
223  
224  
225  
226  
227  
228  
229  
230  
231  
232  
233  
234  
235  
236  
237  
238  
239  
240  
241  
242  
243  
244  
245  
246  
247  
248  
249  
250  
251  
252  
253  
254  
255  
256  
257  
258  
259  
260  
261  
262  
263  
264  
265  
266  
267  
268  
269  
270  
271  
272  
273  
274  
275  
276  
277  
278  
279  
280  
281  
282  
283  
284  
285  
286  
287  
288  
289  
290  
291  
292  
293  
294  
295  
296  
297  
298  
299  
300  
301  
302  
303  
304  
305  
306  
307  
308  
309  
310  
311  
312  
313  
314  
315  
316  
317  
318  
319  
320  
321  
322  
323  
324  
325  
326  
327  
328  
329  
330  
331  
332  
333  
334  
335  
336  
337  
338  
339  
340  
341  
342  
343  
344  
345  
346  
347  
348  
349  
350  
351  
352  
353  
354  
355  
356  
357  
358  
359  
360  
361  
362  
363  
364  
365  
366  
367  
368  
369  
370  
371  
372  
373  
374  
375  
376  
377  
378  
379  
380  
381  
382  
383  
384  
385  
386  
387  
388  
389  
390  
391  
392  
393  
394  
395  
396  
397  
398  
399  
400  
401  
402  
403  
404  
405  
406  
407  
408  
409  
410  
411  
412  
413  
414  
415  
416  
417  
418  
419  
420  
421  
422  
423  
424  
425  
426  
427  
428  
429  
430  
431  
432  
433  
434  
435  
436  
437  
438  
439  
440  
441  
442  
443  
444  
445  
446  
447  
448  
449  
450  
451  
452  
453  
454  
455  
456  
457  
458  
459  
460  
461  
462  
463  
464  
465  
466  
467  
468  
469  
470  
471  
472  
473  
474  
475  
476  
477  
478  
479  
480  
481  
482  
483  
484  
485  
486  
487  
488  
489  
490  
491  
492  
493  
494  
495  
496  
497  
498  
499  
500  
501  
502  
503  
504  
505  
506  
507  
508  
509  
510  
511  
512  
513  
514  
515  
516  
517  
518  
519  
520  
521  
522  
523  
524  
525  
526  
527  
528  
529  
530  
531  
532  
533  
534  
535  
536  
537  
538  
539  
540  
541  
542  
543  
544  
545  
546  
547  
548  
549  
550  
551  
552  
553  
554  
555  
556  
557  
558  
559  
560  
561  
562  
563  
564  
565  
566  
567  
568  
569  
570  
571  
572  
573  
574  
575  
576  
577  
578  
579  
580  
581  
582  
583  
584  
585  
586  
587  
588  
589  
590  
591  
592  
593  
594  
595  
596  
597  
598  
599  
600  
601  
602  
603  
604  
605  
606  
607  
608  
609  
610  
611  
612  
613  
614  
615  
616  
617  
618  
619  
620  
621  
622  
623  
624  
625  
626  
627  
628  
629  
630  
631  
632  
633  
634  
635  
636  
637  
638  
639  
640  
641  
642  
643  
644  
645  
646  
647  
648  
649  
650  
651  
652  
653  
654  
655  
656  
657  
658  
659  
660  
661  
662  
663  
664  
665  
666  
667  
668  
669  
670  
671  
672  
673  
674  
675  
676  
677  
678  
679  
680  
681  
682  
683  
684  
685  
686  
687  
688  
689  
690  
691  
692  
693  
694  
695  
696  
697  
698  
699  
700  
701  
702  
703  
704  
705  
706  
707  
708  
709  
710  
711  
712  
713  
714  
715  
716  
717  
718  
719  
720  
721  
722  
723  
724  
725  
726  
727  
728  
729  
730  
731  
732  
733  
734  
735  
736  
737  
738  
739  
740  
741  
742  
743  
744  
745  
746  
747  
748  
749  
750  
751  
752  
753  
754  
755  
756  
757  
758  
759  
760  
761  
762  
763  
764  
765  
766  
767  
768  
769  
770  
771  
772  
773  
774  
775  
776  
777  
778  
779  
780  
781  
782  
783  
784  
785  
786  
787  
788  
789  
790  
791  
792  
793  
794  
795  
796  
797  
798  
799  
800  
801  
802  
803  
804  
805  
806  
807  
808  
809  
810  
811  
812  
813  
814  
815  
816  
817  
818  
819  
820  
821  
822  
823  
824  
825  
826  
827  
828  
829  
830  
831  
832  
833  
834  
835  
836  
837  
838  
839  
840  
841  
842  
843  
844  
845  
846  
847  
848  
849  
850  
851  
852  
853  
854  
855  
856  
857  
858  
859  
860  
861  
862  
863  
864  
865  
866  
867  
868  
869  
870  
871  
872  
873  
874  
875  
876  
877  
878  
879  
880  
881  
882  
883  
884  
885  
886  
887  
888  
889  
890  
891  
892  
893  
894  
895  
896  
897  
898  
899  
900  
901  
902  
903  
904  
905  
906  
907  
908  
909  
910  
911  
912  
913  
914  
915  
916  
917  
918  
919  
920  
921  
922  
923  
924  
925  
926  
927  
928  
929  
930  
931  
932  
933  
934  
935  
936  
937  
938  
939  
940  
941  
942  
943  
944  
945  
946  
947  
948  
949  
950  
951  
952  
953  
954  
955  
956  
957  
958  
959  
960  
961  
962  
963  
964  
965  
966  
967  
968  
969  
970  
971  
972  
973  
974  
975  
976  
977  
978  
979  
980  
981  
982  
983  
984  
985  
986  
987  
988  
989  
990  
991  
992  
993  
994  
995  
996  
997  
998  
999  
1000

was to large stone mound "Mika #16 Pecos Co line", in  
gravelly flat, at S. foot of hill

Seventeenth Mile:

Thence South, across a flat and over a gravelly  
hill, 1900 m to large stone mound "Mika #17 Pecos  
Co. line", in flat

Eighteenth Mile

Thence South, across a flat and over a gravelly  
hill, 1900 m to 5'x5' earth mound in flat

Nineteenth Mile:

Thence South, over flat, at 1080 m on point  
of a hill and over hill, 1900 m to large stone  
mound "Mika #19 Pecos Co. line" in flat

Twentieth Mile:

Thence South, over a hill, at 740 m cross an  
arroyo, at 1800 m over another hill, 1900 m to  
large stone mound "Mika #20 Pecos Co. line" at S.  
foot of slope

Twenty-first Mile:

Thence South, at 120 m cross an arroyo, at  
130 m on N. slope of hill, at 540 m in a ravine,  
at 1000 m an arroyo, 1900 m to large stone mound  
"Mika #21 Pecos Co line", on a hill

Twenty-second Mile:

Thence South, at 1020 m railroad fence, at 1048 m  
centre of track of the S.P.R.R., 20 m N. 58° W. from Culvert No. 223  
— course of R.R. from this point being S 58° W about 300 m down  
the road and for about 200 m up the road — at 1680 m

Trans. Co. 1814/line # 692



an arroyo, 1900 m to large stone mound mtd #21  
"Pecos Co line" on a small hill

Twenty-third Mile:

Thence South, at 300 m cross an arroyo and  
on E. point of a hill, at 580 m another arroyo, at  
1180 m top of hill at head of a drain, at 1420 m  
an arroyo, at 1600 m on top of hill, at 1740 m  
a drain, 1900 m to large stone mound mtd #23  
"Pecos Co. line" on small hill.

Twenty-fourth mile:

Thence South, at 340 m a drain, at 400 m.  
on hill, at 500 m head of a drain, at 550 m.  
on small hill, 1900 m to large stone mound  
mtd #24 "Pecos Co line" on W. slope of a hill

Twenty-fifth Mile:

Thence South, along hill, at 820 m small  
rocky drain, 1900 m to large stone mound mtd  
#25 "Pecos Co line", on small hill.

Twenty-sixth Mile:

Thence south, at 310 m centre of U.S. military  
road (Pulle's road) at 320 m set stone mound  
on W. side of road. At this point connected  
with Willow Spring — a well known natural  
object on Survey No 9, Block A', G28 S.A. Ry —  
along said U.S. road, as follows, viz:—

S47E. 240 m — S40½E. 340 m — S54E., at 1340 m cross  
Antonio cañon, 1980 m — S48½E. 990 m — S46¾E. 910 m  
S53½E. 1230 m — S73½E. 520 m — S66E. 1900 m — S85E



1720 m - S. 44 E. 1300 m. to Willow Spring cañon  
and up the cañon S 16 E 220 m - S 17 W 700 m to  
Willow Spring; said spring being south 6502 m  
and East 9083 m., or S. 54° 24' E 11167 m from the  
point on the road where it crossed the line.

Resuming the line at 320 m on the 26th  
mile:—

Thence south across small valley with  
two drains, at 1320 m on top of hill, 1900 m  
to large stone mound mtd # 26 Pecos Co line  
on S. slope of hill.

Twenty-seventh Mile:

Thence south, at 60 m a creek running S.W.  
into the Rio Grande, at 460 m across said creek,  
at 540 m on top of hill, and crossing three drains,  
1900 m to large stone mound mtd # 27 Pecos Co  
line" on S. slope of hill.

Twenty-eighth Mile:

Thence south, crossing a drain, at 240 m  
on top of small hill, at 640 m. cross a creek,  
at 760 m on hill, at 1200 m in valley, at 1780  
m creek, at 1400 across, 1900 m to large  
stone mound mtd # 28 Pecos Co line" on N. brow  
of hill N. of a drain.

Twenty-ninth Mile:

Thence south, crossing small valley, at 900 m on hill  
at 1400 m, crossing ravine and drain, on top of hill, 1900 m to large  
stone mound mtd # 29 Pecos Co line, on N. brow of hill



Peas Co. Bdry. Cont # 69a

Thirtieth Mile:

Thence south, at 420 m cañon, at 860 m across at 1400 m cross a cañon, at 1800 m on N. side of a hill, and over hill, 1900 m to large stone mound mka # 30 Peas Co line, between two drains.

Thirty-first Mile:

Thence south, crossing small valley, at 900 m on hill, at 1400 m, crossing a ravine and drain on top of hill, 1900 m to large stone mound mka # 31 Peas Co line" on N. brow of hill

Thirty-second Mile:

Thence south crossing a valley running E. with several small drains, at 1100 m on top of hill, at 1200 m drain, at 1500 m drain, at 1800 m top of hill, 1900 m to large stone mound mka # 32 Peas Co line", on S. point of hill E. of a drain.

Thirty-third Mile

Thence south, at 400 m cross drain, at 600 m another drain, at 670 m on top of hill, and crossing several drains, 1900 m to large stone mound mka # 33 Peas Co line on N. side of a hill and on S. side of a drain

Thirty-fourth Mile:

Thence south, at 20 m on top of hill, and crossing five drains and six hills, 1400 m to top of a hill, at 1580 m on top of a high mountain overlooking the valley of the Rio Grande



at 1800 m down mountain and on top of high  
foot-hill, 1900 m to large stone mound marked  
"# 34 Pecos Co line" on S. W. point of said foot-hill.

S. E. Corner of Pecos County.

Thence South, at 20 m a gulch, at 40 m  
across, at 120 m another gulch, at 200 m  
across and on a ridge, 460 m to a large  
mound, with a 60 inch hackberry for center,  
on edge of pebbly beach of the Rio Grande,  
from which a hackberry 6 in. dia. brs N. 72° E. 5 m  
another hackberry 12 in. dia. brs N. 49° W. 11 m, another  
hackberry 6 in. dia brs S. 67° E. 9 m.

Bearings marked  $\overset{\circ}{\underset{\circ}{\times}}$

Variation  $9^{\circ}40'E$  to  $9^{\circ}57'E$

Severiano Perez }  
Manuel Gomez } *Chainmen*  
Secundino Torres }

Surveyed between the 14th day of February  
and the 24th day of March 1889

Notes:

The N. W. Corner of Val Verde county, as above established  
by me, was located by surveying a true east-and-  
west line from the N. E. corner of Val Verde county and  
the Pecos river by means of back-sights and  
fore-sights

The variation of the needle at the N. E. corner was ob-  
served to be  $9^{\circ}40'E$ , while at the N. W. corner it was observed  
to be  $9^{\circ}57'E$

Archibald Bogle  
Surveyor.



The State of Texas }  
County of Val Verde }

I, Archibald Bogle, surveyor  
of the above described line, do solemnly  
swear that the foregoing survey was actually  
made in the field according to law, and  
that the line with marks natural and  
artificial are truly described in the foregoing  
field notes.

Archibald Bogle

Sworn to and subscribed before me

Witness my hand and official seal at  
New Rio, Texas, this 13th day of April A.D. 1889

G. W. Brown

CLK. C. C. V. V. C.





Pecos Co. Bdry. Line # 612

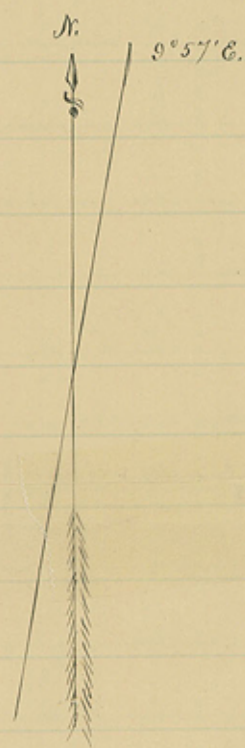
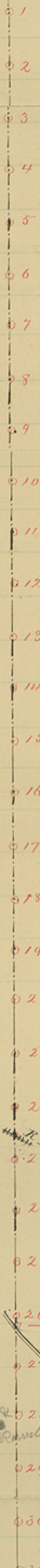
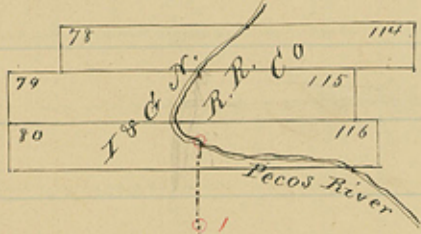

S.E. R.R.

26 East 9083 yrs

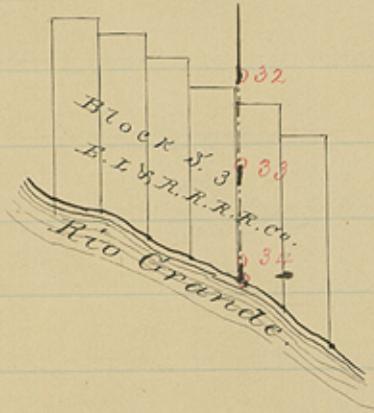
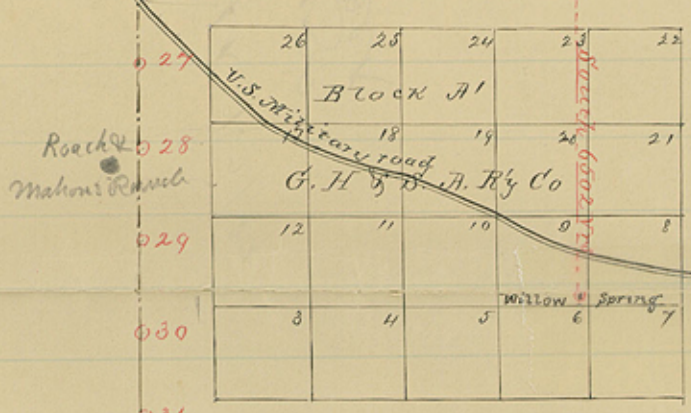

Scale 4000 Yrs. per Inch,  
Variation 9° 57' East.

The State of Texas }  
County of Val Verde }

I, Archibald Bogler, do solemnly swear that the above plat is a true representation of the boundary line between the counties of Pecos and Val Verde Texas, as surveyed by me.

Archibald Bogler  
Surveyor

Sworn to and subscribed before me this 15th day of April A.D. 1889.

G. W. Brown  
Clerk N. R. Co.

2