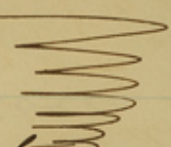
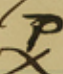
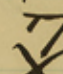
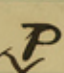
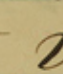
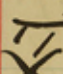

State of Texas
Counties of Polk & Trinity  Field notes
of the division line between
Polk and Trinity Counties -
Beginning at a live Mulberry
tree, which is situated on the
east margin of Trinity River at a
point of about N. 56. W. 10,000
varas distant from the mouth
of Kickapoo Creek, and S.
39° E. 730 vrs. from where the
division line between the two
A. M. de Sejora leagues touches
the east bank of Trinity
river, said Mulberry is marked
on its eastern side  and on
its western side  from which
an Ash 14 in. dia. N. 50. E.  brs
S. 64. E. 12 vrs. A Cotton Wood 30
in. dia. N. 50. E.  brs N. 50. E.
27 1/4 vrs. An ash 12 in. dia. N. 50. E.
 brs N. 31. E. 21 1/4 vrs. and a
Sycamore 8 in. dia. N. 50. E. Polk
brs. S. 4 W. 4 1/2 vrs. —

Thence N. 49° E. at 200 vrs a
bluff or bank, of apparently
and old river at 1300 vrs to the
edge of river swamp. at 1900 vrs

7016 00. Bd. 4. Line #1

varas an each mound in an
old field for 1st mile - Thence
("Thence" has refers to Course N.
49. E. to mouth of Bull Creek
from there on to mouth of
Alabama Creek to Course N. 40°
30' E.) at 1900 varas an each
mound for 2nd mile whence
two pines each marked two
locks, one of same marked P
Thence at 1300 Brushy Creek
Course South at 1900 var each
mound for 3rd mile whence
a forked Sweet gum and a
lym each marked three locks
Thence at 1900 var an each
mound. for 4th mile, whence
two pines each has five locks
Thence at 1900. each mound
for 5th mile, whence two pines
each marked five locks.
Thence at 1900 var each mound
for 6th mile whence two pines
each marked six locks - Thence
at 1900 var each mound for
7th mile whence two pines
each marked seven locks.

Thence at 1900 vrs each mound
for 8th eighth mile, whence
two pines each marked eight
locks. - Thence at 1800 vrs to
middle of Kickapoo Creek,
at 1900 vrs each mound for
9th mile, whence an ash tree
and a white oak each marked
nine locks. Thence at 1900
vrs, each mound for 10th mile
whence three pines each marked
ten locks. Thence at 1900 vrs each
mound for 11th mile, whence three
pines each marked eleven locks,
Thence at 1900 vrs, each mound
for 12th mile whence three pines
each marked twelve locks,
Thence at 1900 vrs, each mound
for 13th mile whence two pines
each marked thirteen locks,
Thence at 1900 vrs each mound
for 14th mile, whence two
pines each marked fourteen
locks, Thence at 500 vrs road
from Groveton to Colita, at 1900
vrs, each mound for 15th fifteenth
mile, whence three pines each
marked fifteen locks. Thence at

1900 vs each mound for 16th mile
whence two pines and a black
oak, each marked sixteen knots
Thence at 1900 vs rock mound
for 17th mile, whence a black
gum and a pine each marked
seventeen knots, Thence at 1150
vs cross I. & S. R.R., 320 vs east
of its 28th mile post. at 1690 vs
cross the road from Groveton to
Moscow. at 1900 vs each mound
for 18th mile, whence a pine
and red oak, each marked
eighteen knots - Thence at 1900
vs, each mound on west bank
of Bull Creek, for 19th mile a
Magnolia and a sweet gum each
marked nineteen knots. - Thence
at 100 vs Cross Bull Creek at 1900
vs each mound for 20th mile
whence a Black gum and
hickory each marked twenty
knots. - Thence - Crossing
saw Bull Creek several times
at 2045 vs the mouth of Bull
Creek, at Big Piney Creek, at
which point a hemlock Mulberry
post 8. in. dia. was set, marked

on eastern side \times . on western
side \times whence a sweet gum
stands on east bank. marked \times
a birch stands on west bank
marked \times - Beginning at said
post (and different course was run)
Thence N. $40\frac{1}{2}$ E. at 1900. vs south
mound for 1st mile - Thence at
800 vs Nugent Creek. at 1900 vs
south mound for 2nd mile.
whence a pine and Hickory each
marked three hocks - Thence at
1900 vs south mound for 3rd mile
whence two pines each marked
four hocks. - Thence at 200
vs Moscow and Centralia
road. at 1900 south mound for
4th mile. whence two pines
each marked five hocks.
Thence at 1900 vs south mound
for 5th mile whence a Sweet
gum and a post oak each
marked six hocks Thence at
1900. south mound for 6th mile
whence a pine and a post
oak. each marked seven hocks.
Thence at 1900 vs south mound
for 7th mile whence a post oak

Polk Co. Adm. List #1

marked Twenty eight hocks, Thence
at 1900 to post mound. for 8th mile
whence a tree marked Twenty nine
hocks, Thence at 1990 to the
mouth of Alabama Creek at
Neches River. at this point on the
east bank of said Creek. a Sigh-
-wood post 6 ft. long 8. in dia is
set in the ground about three
ft deep. marked T X P Thus
Completing the line, the total
distance or length of said line
being 30 miles 235 Varas. Survey
was finished August 7th 1886.
Four hocks on the trees marks this
County line.

The H. W. Pennington Surveyor of
Trinity County (2) & H. Matthews
Surveyor of Polk County, do hereby
Certify that we were on the ground
together and made the foregoing
Survey, according to law with
duly qualified Chain Carriers
and that all description of
initial points, and other state-
-ments and descriptions set forth
in the above and foregoing fields

notes are true and correct.
W. H. Matthews Jun of Post Co
H. W. Pennington " " Trinity "

The State of Texas, County of Trinity,
J. K. O. Stokes, Clerk of the County
Court within and for said County,
do hereby Certify, that the foregoing
Instrument was filed in my office
for record at 2 o'clock P.M. on the
12. day of November 1886, and
was correctly recorded on the 13.
day of November 1886, 1886, deed record
Book, H, on page 568, to 571

Given under my hand and
Seal of Office this 12 day of
Novr 1886.

J. K. O. Stokes
Clerk of County Court
Trinity County Texas
By W. F. Stokes
Deputy.

Polk Co. Bdry. line #1

N

N. 49° E

A. M. De Searza County League

Polk Co. Trinity County line

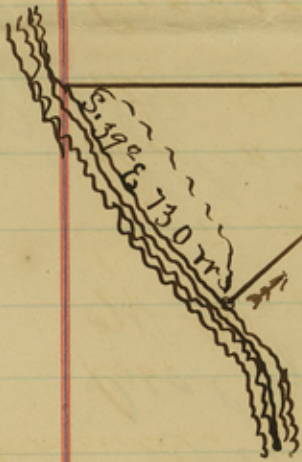

A. M. De Searza League

M. Purvis

320, a

680 ors

484 ft

335 ft

Co line N. 49° E

Trinity

Polk

Co line N. 49° E.

796 ft Trinity

Houston Co School Land 1. League

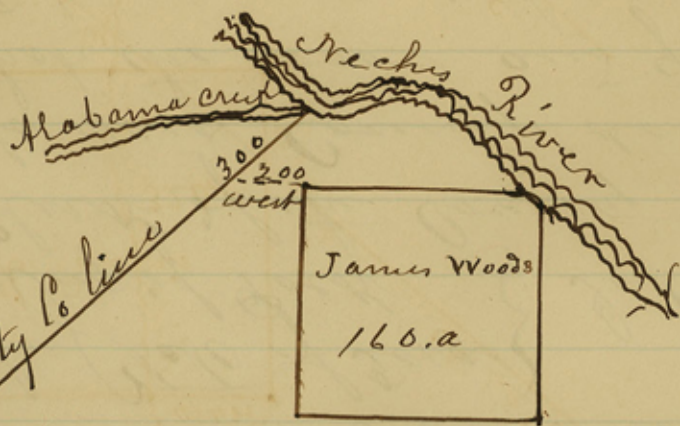

The State of Texas.
 Counties of Trinity & Poest, W. H. Matthews
 Co. Surveyor of Poest Co & W.
 W. Pennington Co. Surveyor of
 Trinity Co. hereby certify that
 the above sketches show where
 the Poest and Trinity Co line
 crosses each of the surveys
 represented by said sketches
 and that said line was located
 by us in accordance with
 law.

W. H. Pennington
 Co Surveyor Trinity Co
 W. H. Matthews
 Co. Sur for Poest. Co.

Filed for record in my Office
Nov 19th 1886. at 4.30 o'clock
P.M. A.B. Green.
Co Clerk Polk Co Tex

The State of Texas, } I A.B. Green Clerk
County of Polk } of the County Court
in and for Polk County Texas, do
hereby Certify that the above and
foregoing Field Notes of the Polk
and Trinity County line, and
sketch showing the Connecting
Survey, was this day duly and
correctly, Recorded in the Records
of Polk County in Book "H."
on pages 150, 151, 152, 153 + 154 of Reads
re, at 11 o'clock A.M.

Witness my hand and seal
of Office this 1st day of
December A.D. 1886.

A.B. A.B. Green Clk. Co Ct
Polk Co Tex.

The State of Texas }
County of Polk } I, A.B. Green
Clerk of the County Court in and
for said County, do hereby Certify
that the above and foregoing
9. pages and 17 lines contain a
true and correct copy of the
Field Notes, and sketches of the
Polk and Trinity County
Line, and Certificates thereto.

as shown by the Original
Instrument now on file in
my Office.

Witness my hand and Seal
of Office. at Office in Living-
-ton this 2nd day of December
A D 1886.

A. B. Green Clerk Co
Ct. Post Co. Tex.

Field Notes.
Polk & Trinity
Co. Line

~~3~~
1

Polk Co Bdry Line 1

Copy

Filed in Genl S^d Office
Dec 4th 1886

D. N. Robinson
Chf Clk.

