

The State of Texas } Before me B. R. Adams County Judge, in  
 County of Presidio } and for the County of Presidio, State of Texas  
 on this day personally appeared J. R. Marrison  
 known to me, to be the person, whose name is  
 subscribed to the foregoing instrument, and  
 acknowledged to me, that this is a true and  
 correct Map of the survey of the line between  
 Presidio County and Brewster County,



Given under my hand and Seal of Office,  
 this 12th day of December A.D. 1889,

B. R. Adams  
 County Judge of Presidio Co. Texas

T. W. N. & G. Ry Co.

Bl. 1.

T. C. Ry Co.

G. C. & S. F. Ry Co.

Bl. 314.

Texas  
 and St. Louis  
 Railway Co.

Bl. 206.

Bl. 208.

Bl. 212.

Bl. 211.

Bl. 209.

Bl. 210.

D. & W. Ry Co.

Block G. 5.

M. K. & T. E. R. T. Co.

PLAT of the county line between  
 Presidio & Brewster  
 Counties

J. R. Marrison  
 Surveyor

Filed for record Dec  
 12<sup>th</sup> 1889 at 5 o'clock P.M.  
 W. S. Sampson  
 666 P.O.

No. 1832 CERTIFICATE OF TRUE COPY. FOR SALE BY GEO. D. BARNARD & CO., PRIN. ST. LOUIS. CLASS 6

THE STATE OF TEXAS,  
 County of Muskegon }  
 Clerk of the Co Court of Presidio County, Texas, do hereby certify that  
 the foregoing is a true and correct copy of the original Map now on  
 file for record in my office

now on file in said Court, in Book \_\_\_\_\_ on page \_\_\_\_\_  
 Given under my hand and the seal of said Court, at office in Muskegon  
 this the 12 day of Dec, A. D. 1889  
 ATTEST: W. S. Sampson Clerk.  
 By \_\_\_\_\_ Deputy.

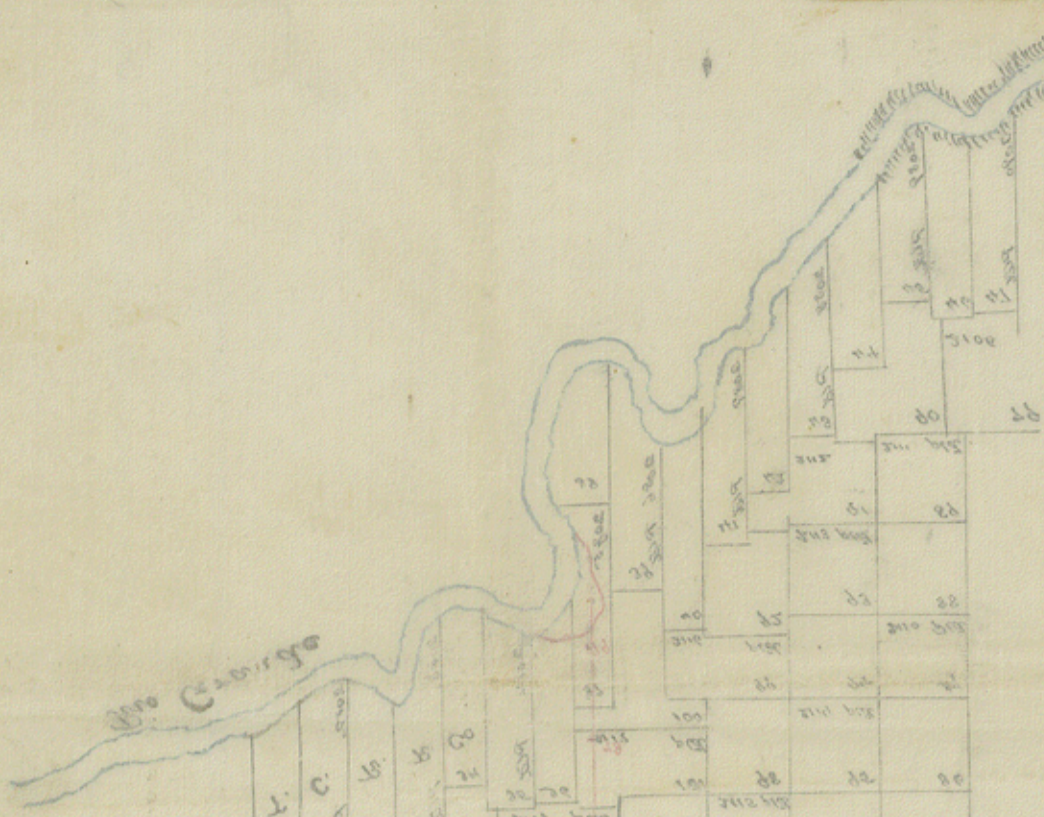
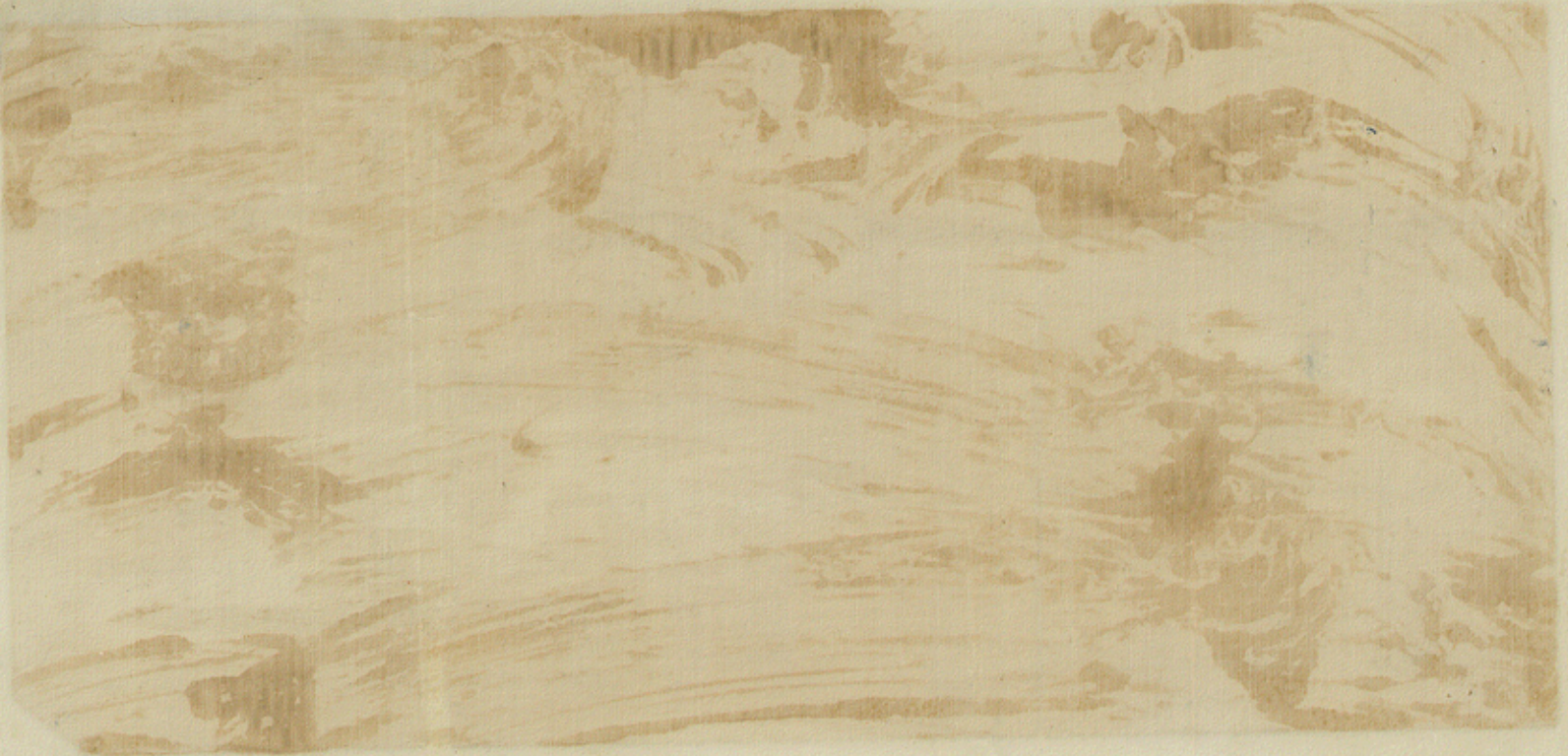

Handwritten notes in the upper right corner, including the name 'Wm. H. Murray' and other illegible text.

Grid section labeled 'Block C. 2' and 'D. & H. SA Co'. It contains a grid of small squares with numbers and some handwritten annotations.

Commissioner  
T. B. Watson  
Commissioner  
Francisco M. Blanes  
BY AT of the County Court of Brevard

Grid section labeled 'Block C. 2' and 'D. & H. SA Co'. It contains a grid of small squares with numbers and some handwritten annotations.

Grid section labeled 'Block C. 2' and 'D. & H. SA Co'. It contains a grid of small squares with numbers and some handwritten annotations.

Grid section labeled 'Block C. 2' and 'D. & H. SA Co'. It contains a grid of small squares with numbers and some handwritten annotations.

Grid section labeled 'Block C. 2' and 'D. & H. SA Co'. It contains a grid of small squares with numbers and some handwritten annotations.

Grid section labeled 'Block C. 2' and 'D. & H. SA Co'. It contains a grid of small squares with numbers and some handwritten annotations.

Grid section labeled 'Block C. 2' and 'D. & H. SA Co'. It contains a grid of small squares with numbers and some handwritten annotations.

Grid section labeled 'Block C. 2' and 'D. & H. SA Co'. It contains a grid of small squares with numbers and some handwritten annotations.

Grid section labeled 'Block C. 2' and 'D. & H. SA Co'. It contains a grid of small squares with numbers and some handwritten annotations.

Grid section labeled 'Block C. 2' and 'D. & H. SA Co'. It contains a grid of small squares with numbers and some handwritten annotations.

Grid section labeled 'Block C. 2' and 'D. & H. SA Co'. It contains a grid of small squares with numbers and some handwritten annotations.

Grid section labeled 'Block C. 2' and 'D. & H. SA Co'. It contains a grid of small squares with numbers and some handwritten annotations.

Grid section labeled 'Block C. 2' and 'D. & H. SA Co'. It contains a grid of small squares with numbers and some handwritten annotations.

County of Brevard  
Relating to  
and Brevard Cos.  
12-16-1889

Handwritten text at the bottom right, including the name 'Wm. H. Murray' and other illegible text, possibly a signature or official statement.