

Reagan Co Bdry ² Line Id

REAGAN COUNTY

CONTENTS

~~File~~ BOUNDRY LINE FILE

West Line of Reagan Co. ~~Class~~

(8 East line of Upton Co.) ~~County~~

(1) Field Notes

(2) Sketch

1904

.....Certificate No.....

No.

No.

No.

No.

No.

No.

No.

No.

No.

No.

No.

No.

No.

No.

No.

Order 58121

Mgl.

To the Hon Commissioner Court of Reagan County
 In Obedience to an order of your Honorable Court passed
 at the July Term A.D. 1904 I hereby submit the following
 report of a Survey made by me of the West line of Reagan
 County the same being the East line of Upton County

I began at a heavy stone 3 feet high and 12 inches
 square marked on top face N.C. S.E. corner on the East side
 G Co cor whence a mesquite $3\frac{1}{2}$ in dia brs S $24\frac{1}{2}$ 45' E 4000
 a do 3 in brs S 42 55' W. The S.E. cor of No 14 Bl 31 Tps 58 brs
 S 52 55' E 579000) said corner was made for the South East corner
 of Midland County and the South West corner of Glasscock County
 Thence South at 628 varas pass 63000 S 75 W from the S.E. corner
 of survey No 16 B 37 Tps 58. (an old stake and mound on the ground
 made for said cor.) at 740 varas cross Stiles and Midland road put
 up a rock on N side mkd "Co LINE"

1M at 1 mile set a rock in ground mkd on the East side R. Co L 1M
 on W side U. Co L 1M. 10000 S of a road. Continuing South through
 mesquit brush

2M at 2 miles set a rock in the ground marked on E side R Co L 2M
 on West U Co L 2M. at 74000 cross a fence Co East + W

3M at 3 miles set rock in ground marked on E side R Co L 3M on W
 side U Co L 3M at 3 miles and 91500 cross N line of Sur No 40
 T. P. R. R. Co Block No 37 Tps 58 295000 N 75 E from a rock
 mound the N.W. cor of said Sur No 40 at 3 Miles and 104000
 cross a fence course E + W.

4M at 4 miles mad an Earth md and stake and piled rock on top
 mkd Stak on E side R Co L 4M

5M at 5 miles set rock in ground marked on E side R Co L 5M on
 W side U Co L 5M at 5 miles and 40000 pass between two lakes
 about 50 from West one and 20000 from East one at 5 miles
 and 101900 cross the South line of survey No 44 Bl 37 T. P. R. R. Co
 73000 S 75 W from its S.E. corner found an old rock mound
 and 223000 N 75 E from an old rock mound on S line
 T P Reservation line whence a mesquit stump brst 82 W
 15M Continuing South over rolling prairie and scattering
 mesquit timber

- 6M at 6 miles made a circular Earth mid 3 feet at base and piled small rock on top make a stake of E side R Co L 6 m from which a mesquit 4 in dia brs N 49 $\frac{3}{4}$ E 14000 marked \equiv a do 4 in dia marked \equiv brs N 110 E 8000 at 6 miles and 182000
Enter N End of lake
- 7M At 7 mile Set rock in lake marked on E Side "R Co L 7 m" on W Side U Co L 7M Whence wind mill brs S 74 W (about 80000) Comb of Wilkensons house brs S 73 $\frac{1}{4}$ W at 150000 cross fence Co E + W at 7 miles and 1149 cross N 75 E 143000 from a stake and mound the S.W. corner of No 8 Bl C L + S V, R.R. Co.
- 8M at 8 miles Set a rock marked on E Side R Co L 8 M on W Side U. Co 8 M at 8 miles and 140000 to center of lake
- 9M at 9 miles Set a rock in ground mhd on E Side R Co L 9 M and on W side U Co L 9 M. at 9 miles and 346000 a point. Whence Wilkensons wind mill towers brs N 12 W
- 10M at 10 miles Set rock in ground marked on E Side R. Co L 10 M and on E side U Co L 10 M. Whence a wind mill brs S 37 W. Comb of house brs S 37 $\frac{1}{2}$ W at 10 miles and 1353000 cross S line of Survey No 30 N 75 E 230000 from its S.W. corner at 134000 of fence Co E + W
- 11M at 11 miles Set a Stone in ground marked on E Side R Co L 11 M and "U Co L 11 M" on W side Whence Moseley's mill brs S 80 $\frac{1}{4}$ W at 11 miles and 1240000 cross a fence Co S 750 W at 1480000 center of a draw Co N'E + S'W
- 12M At 12 miles set a rock in ground marked on E side R Co L 12 M on W side U Co L 12 M
- 13M At 13 miles set a rock in ground marked on E Side "R Co L 13 M" on W side U Co L 13 M Said rock is 60000 South of main Stiles and Midland road set a rock on North Side of Road mhd Co LINE at 13 miles and 1557000 pass 1011000 S 75 W from a Stone mound made for the NE cor of Swr No 9 D & W. R. R. Co. (as shown on sketch herewith filed and accompanying this report)
- 14M At 14 miles Set rock in prairie marked on E side "R Co L 14 M" on W side U. Co 14 M
- 15M At 15 miles Set rock mhd on E side R Co L 15 M on W U. Co L 15 M
- 16M At 16 miles Set rock in prairie marked on East Side R Co L 16 M on

W 2 Co L 16 M at 16 miles and 1741 vrs pass 438 vrs S 75 W
from the N. E. corner of Sur No 1. A. C. & S. F. R. R. Co a stake + Rock
mound

- 17 M At 17 miles set rock in prairie marked on E Side "R Co L 17 M"
on W. 2 Co L 17 M
- 18 M At 18 miles Set Rock in ground in prairie mkd on East R Co L 18 M
on W "2 Co L 18 M whence wind mill at a high tank hrs S 46 W
- 19 M At 19 miles Set rock in prairie Marked on E side R Co L 19 M on
W "2 Co L 19 M
- 20 M At 20 miles Set rock in prairie 40 vrs W from draw Co N + S
marked on E Side R Co L 20 M bunch bushes on hill N 45 E 200 vrs
at 1200 vrs cross a drain course S E. 200 vrs W from confluence
of two drains - Said line crosses the N line of Sur No 50 1/2 in
name of P. B. Scott at 45 vrs and is 255 S 75 E W from its N. E. corner
- 21 M At 21 miles rock in prairie in E Edge of Greewood brush
marked on E side R Co L 21 M on W 2 Co L 21 M, whence
Shamlin's Wind Mill hrs N 77 1/4 E and the door of house hrs N
78 E. at 21 miles and 133 vrs cross S line No 00 1/2 244 vrs S 75 E
from its S W cor
- 22 M At 22 M Set a rock in prairie marked on E side "R Co L 22 M"
on W "2 Co L 22 M" at 540 vrs cross trail + dirt road at 1300 vrs
cross Centralia and Stiles and Horselead crossing Road put rock
on N side mkd Co L I N E, at 1838 vrs cross the North line Sur
No 14 U 'V' land Block 68 = 347 vrs East from a rock mound
under fence made for N W cor No 14 State University land
Bl 68
- 23 M At 23 miles set rock on N Side of a hill on S Side of centralia
draw marked on E side "R Co L 23 M on W side "2 Co 23 M" at
23 miles and 1838 vrs cross the North line of Sur No 5 Block 3
State University land 347 vrs East from its N. W. corner
- 24 M At 24 miles Set a rock in greewood marked on E Side R Co L
24 M on W side 2 Co L 24 M at 1200 vrs cross a drain Co S E
- 25 M At 25 miles Set a rock in Greewood brush m R Co L 25 M on
W 2 Co L 25 M at 1838 vrs cross S line No 7 B 4 U V land
- 26 M At 26 miles Set a rock in Greewood mark on E side R Co L 26 M
on W Side 2 Co L 26 M.

- 27M At 27 miles Set a rock in Greewood brush marked on E side R Co L 27M on W "u Co L 27M at 1560 vrs cross a fence Co E + W
- 28 At 28 miles Set rock in mes draw (Co N 85 E) marked on East Side R Co L 28M on W. "u Co L 28M"
- 29M At 29 miles Set rock in Greewood brush marked E Side "R Co L 29M on W side u Co L 29M at 29 miles and 1898 varas cross the North line of Sur No 4 Block 4 University Survey 3 47 vrs West from its N. W. Corner
- 30M At 30 miles Set rock in Greewood marked on E Side R Co L 30M on the W Side u Co L 30M
- 31M At 31 miles set rock Greewood brush at north Slope of Brandy hill, marked on E side "R Co L 31M" on W "u Co L 31M" at 31 miles and 1000 vrs cross Greelson Spring and Potoon bridge road Set rock on N Side marked Co LINE about 400 vrs W from a gate at 1040 vrs cross a fence Co E + W
- 32M At 32 miles set a rock in mesquit flat in head of draw Co N + S marked on E side "R Co L 32M on W u Co L 32M"
- 33M At 33M Set rock in draw marked on E side R Co L 33M on W. u Co L 33M
- 34M At 34 miles Set rock in ground marked on E side R. Co L 34M on W u Co L 34M at 400 vrs cross drawer S + N
- 35M At 35 miles Set a rock in ground marked on E Side "R Co L 35M on W side u Co L 35M on the East Slope of hill on west Side of draw at 1600 vrs cross fence Co E + W at 1838 varas cross the N line of Survey No 5 State University land 347 vrs East from its N. W. Corner
- 36M At 36 miles Set rock on west Side of draw marked on E side R Co L 36M on W u Co L 36M at 1040 vrs cross fence near E pt of mountain 60 vrs West of its N E corner
- 37M At 37 miles set rock in Greewood brush marked on E side R Co L 37M on W u Co L 37M
- 38M At 38 miles Set rock in draw marked on the E side R Co L 38M on the W side u Co L 35M at 1400 vrs cross a draw Co N. W. + S. E. at 38 miles and 1838 varas cross the North line of Survey No 19 Block No 5 State University land 347 vrs East of its N. W. Corner

39M At 39 miles Set a rock in valley near the north end of a low hill marked on East Side R. Co L 39M on the West Side U. Co L 39M. At 39 miles and 588 varas Set a large Rock in the ground 3½ feet high above ground, on the North Side of Slope of Hill marked on the N'E side S.W. Cor R Co" on the West Side "S.E. Corner of Upton Co" for S.W Corner of Reagan County and S.E. Cor of Upton County, whence a bush on the center of a small round hill brs S 72° E, a wind Mill in draw brs N 19° E. The East point of high hill brs S 12° W a black point of ridge on N Side of a range of Mountains brs S. The South point of a high Mountain brs S 56° E Surveyed Sept 18th to 24th 1904

Elmer Mason }
 Charley Reynolds } Chainmen

Respectfully
 H. B. Farver

= No 102 49' E = Surveyor, appointed by Reagan County Com Ct to Survey Reagan County Lines.

w 4

J. B. Lucas
District and County Clerk
Reagan County

STILES, TEXAS.

1905.

State of Texas,)
County of Reagan.) I, J. B. Lucas, Clerk of the County
Court and Ex-Officio Clerk of the Commissioners Court, in
and for said County and State, hereby certify that the
foregoing is a true and correct copy of the original as
the same appears of record in the Minutes of Commissioners
Court, Reagan County, Texas, Vol. 1, Pages 90-91-92-93
Given under my hand and ~~signature~~ and seal of
said Court this 6th, day of May, 1905.

J. B. Lucas
Clerk Commissioners Court, Reagan Co.
Texas

W⁵

6

State of Texas,)
County of Reagan.) I, J. B. Lucas, Clerk of the County Court
and Ex-Officio Clerk of the Commissioners Court, in and for said
County and State, hereby certify that the foregoing is a true
and correct copy of the original as the same appears of
record in Vol. 1, page 89, Minutes of Commissioners Court,
Reagan County, Texas.

Witness my hand and the seal of the Commissioners Court of
said County, this 6th day of May, 1905.

J. B. Lucas
Clerk Commissioners Court, Reagan Co. Texas

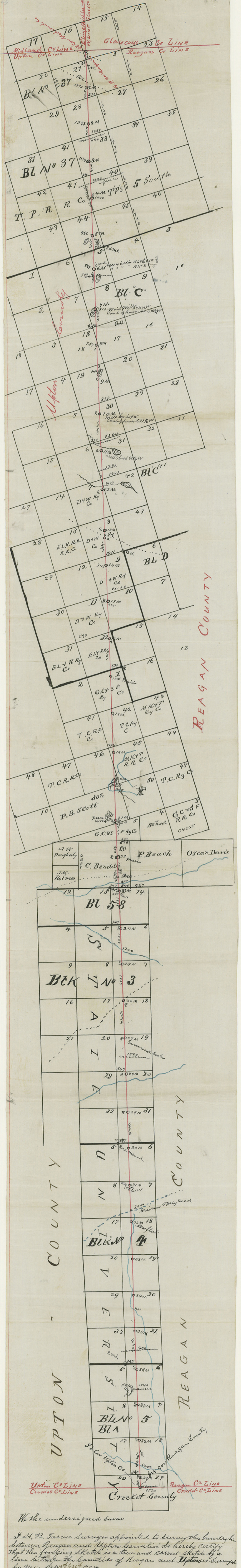

We the undersigned Surveyor

J. H. B. Tarver Surveyor appointed to survey the boundary line between Reagan and Upton counties do hereby certify that the foregoing sketch is a true and correct sketch of a line between the counties of Reagan and Upton as surveyed by me Sept 15th 1904

J. H. B. Tarver
Surveyor for Reagan County

West Line Reagan Co