

File N^o 73. 3

County Boundaries be-
tween the County of

Reeves

and the Counties of

Pecos and Presidia

Filed June 16th 1885 &
July 13th 1886

no connection given with
surveys through which the
lines pass Beaumont

var 11.300

State of Texas }
County of Reeves } Field notes of the South-
ern boundary line of Reeves ^{County} made by
virtue of an order issued by the Kan-
County Court of Reeves County.

Beginning at a large Earth Mound
40 feet high capped with a large rock
which is marked "P" on one side
and "R" on the other. Said mound is
situated on the Pecos River at a noted
place known as "Great Falls" about
35 miles below Pecos City. From which mound
the N.E. Cor of Sur to 6, and S. & E. Cor of
Sur to 5, Bl. 8, H. V. G. R. Co. survey
bears N 16° 45' W 6-9/1000.

Thence S 43 W 1 mile to a large Earth
mound, thence (1002 vrs to the ditch)

- 2 miles to large Earth Mound.
- Thence 3 miles to large earth mid
- Thence 4 miles to large earth mid
- Thence 5 miles to large earth mid
- Thence 6 miles to large earth mid
- Thence 7 miles to large earth mid
- Thence 8 miles to large earth mid
- Thence 9 miles to large earth mid
- Thence 10 miles to large earth mid
- Thence 11 miles to large earth mid
- Thence 12 miles to large earth mid
- Thence 13 miles to large earth mid
- Thence 14 miles to large earth mid
- Thence 15 miles to large earth mid
- Thence 16 miles to large earth mid

Reeves Co Bdry Line 73

- 1 Hence ~~243~~ 17 miles to large earth md
- 2 Hence 18 miles to large earth md
- 3 Hence 19 miles to large earth md
- 4 Hence 20 miles to large earth md
- 5 Hence 21 miles to large earth md
- 6 Hence 22 miles to large earth md
- 7 Hence 23 miles to large earth md
- 8 Hence 24 miles to large earth md
- 9 Hence 25 miles to large earth md
- 10 Hence 26 miles to large earth md
- 11 Hence 27 miles to large earth md
- 12 Hence 28 miles to large earth md
- 13 Hence 29 miles to large earth md
- 14 ~~29~~ Hence 30 miles to large earth md
- 15 Hence 31 miles to large earth md
- 16 Hence 32 miles to large earth md
- 17 Hence 33 miles to large earth md
- 18 Hence 34 miles to large earth md
- 19 Hence 35 miles to large earth md
- 20 Hence 36 miles to large earth md
- 21 Hence 37 miles to large earth md
- 22 Hence 38 miles across Stockton & Zayuk
Road. to a large earth md
- 23 Hence 39 miles to a large earth md
- 24 Hence 40 miles to a large earth md
- 25 Hence 41 miles to a large earth md
- 26 Hence 42 miles to a large earth md
- 27 Hence 43 miles to a large rock md
- 28 Hence 44 miles to a large earth md
- 29 Hence 45 miles to a large earth md
- 30 Hence 46 miles to a large earth md
- 31 Hence ~~852~~ 47 miles to large earth md
- 32

1 Thence 47 miles to large earth mound
2 Thence 48 miles to large rock mound on side
3 of the Mountain
4 Thence 49 miles to ~~a~~ large rock mound
5 Thence 50 miles to large rock mound in
6 Canon,
7 Thence 51 miles to large ~~earth~~ ^{rock} mound
8 Thence 52 miles to large rock mound
9 Thence 852 votes to large rock mound
10 Half a foot high marked "P" on one side & on
11 the other at the head of Barrilla Springs
12 on a high ~~the~~ Peak.

13
14 Surveyed between the 25 of May and 8th of June, 1885-

15 Henry Gates }
16 G. M. Wilder }
17

18 J. K. Harrington Surveyor appointed ^{by Pecos County}
19 to establish the County line between Pecos
20 and Deuel Counties. Do hereby certify that
21 the work was actually done in the field
22 and that the corners both natural and artifi-
23 cial have been truly and correctly described
24 in the foregoing Plat & field notes

25
26 J. K. Harrington
27 S. A. R. C. L.

28 I further certify that Pecos County failed
29 to send a surveyor at the appointed time
30 to assist in running said line

31 J. K. Harrington
32 S. A. R. C. L.

Approved this the 10th day of June
A.D. 1885-

R L Harrell County Judge
of Reeves County Texas.

1632 CERTIFICATE OF TRUE COPY—Geo. D. Barnard & Co., Printers, Stationers, Lithographers and Blank Book Makers, St. Louis. Class 6

The State of Texas, }

County of Reeves.

I, Frank Kynette

Clerk of the County Court of Reeves County, Texas, do hereby certify that

the foregoing is a true and correct copy of the original plat and fieldnotes
of the Pecos-Reeves County boundary line

now on file in said Court, in Book 2 on page 253 to 255.

Given under my hand and the seal of said Court, at office in Pecos
this the 13th day of June A. D. 1885.

ATTEST: Frank Kynette, Clerk.

By _____ Deputy.

20
21
22
23
24
25
26
27
28
29
30
31
32

4a

3 Reeves Co Bdry Line 73
Field-notes of the Co.
line between Pecos and Reeves

Counties

Filed for record on the
10th Day of June, A.D. 1885,

Recorded on the 13th
Day of June, A.D. 1885,

on pages 253 to 255, Book 2

Deed Records of Reeves
County, Texas.

Frank Kynette
County Clerk
Reeves Co. Tex.

Filed June 16th 1885.

D. N. Robinson
Chf. Clk.

These fieldnotes fail to make a complete
at Barolla Spring with adjoining
surveys -

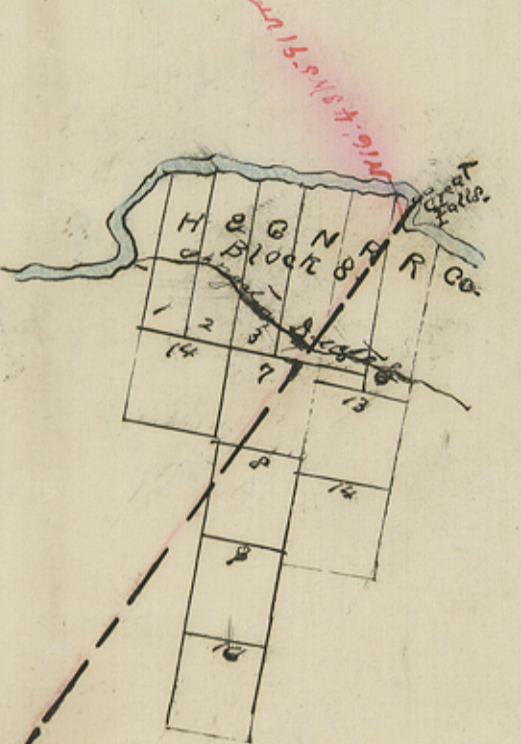

543.7 Miles 842.7 Miles

Pecos Co.

Roads from ... to ...

Handwritten notes in the bottom right corner, possibly including a date or reference number.

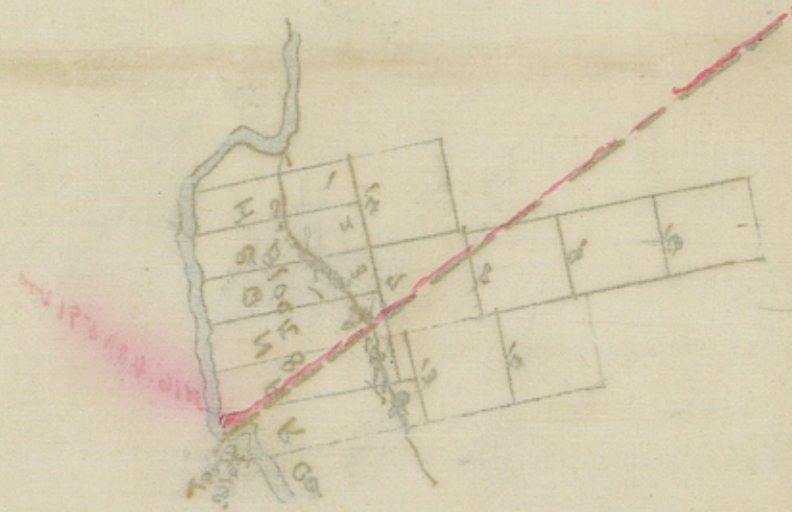

REEVES CO. Bdry line #73

Filed June 16th 85
 J. N. Robinson & Co. Register.
 1885

counter 61720

Reeves Co Bdry Line 73

Beacon
 Co.

SECTION 8 24th 1885
 24th 1885

Section 8
 24th 1885

