

File No. 70

Boundary between
San Patricio
Live Oak &
Peebles

See enclosed wrapper
for contents,

San Patricio Co Bary Line 76

To the Honorable Commissioners Court of San
Patricio County,

Sirs,

In Compliance with an order of your
Honorable Court, I met Mr. T. D. Gilmore Sur-
veyor for Linn Oak County, and with him defined
the boundary line between San Patricio^{Co} and Linn
Oak Counties, and as a result of the survey beg
leave to submit the following Field Notes and
Sketch -

Beginning at the corner of Linn Oak and
Bee Counties, which is a post MK^d B, thence
a Mesquite 10. in. dia. MK^d V thro. S. 60¹/₂ W. 7¹/₂ thro.
another Mo. MK^d X thro. S. 67 E. 20³/₄ thro.

Thence S. 51 W. at 420 thro. a branch, runs
S. 20 W. at 1319 thro. a post set for the corner of
Bee^{Co} and San Patricio Counties thence a Mes-
quite MK^d Y thro. S. 12 W. 71¹/₅ thro. at 1332 thro.
the boundary line between a 1280 acre
sur. in the name of John P. Borden and a
1920 acre sur. in the name of M. G. Frazier,
thence the North Corner of said Jno. P. Borden
sur. thro St. 08. Th. 278 thro. at 1908 thro. set a post
MK^d 1 and S. P. & L. O. at 2189 thro the boundary
line between said Jno. P. Borden sur. and sur.
St. 2, for Linn Oak County School Land at 3801³/₅
thro. set post MK^d 2, S. P. & L. O. at 3560 thro. a
Small, course S. 30 E. at 5695 thro. Miller's
Pasture Fence Course St. 30³/₄ W. & S. 30³/₄ E.

at 5702 $\frac{2}{5}$ vrs. set post MK^d 3. S. P. & L. O. at 7603 $\frac{1}{5}$
vrs. set post MK^d 4. S. P. & L. O. at 8200 vrs. Road
leading from Beville to Lagarto, set a small
post at 8363 vrs. the S. W. Bdy Line of Live
Oak County School Land N^o. 2. Whence to
S. W. Cor. bro. at 5821. 497 vrs. at 8535 vrs. —
road leading from San Patricio set a post
MK^d C, line at 9504 vrs. set post MK^d 5. S. P.
& L. O. at 9889 vrs. Cross line between Edj.
McGloin and Patrick Swan grants at 1144
vrs. Cross Beville & Lagarto road set a post
MK^d C, line at 11404 vrs. set post MK^d 6. S.
P. & L. O. at 12574 vrs. Miller's Wind Mill bro.
at 45 $\frac{1}{2}$ W. at 13034 vrs. said Mill bro. at 17 $\frac{1}{2}$ E.
at 13307 vrs. set post MK^d 7. S. P. & L. O. Whence a
Mesquite 30, in. in dia. MK^d V bro. at 85 E.
11 $\frac{5}{8}$ vrs. at 14267 vrs. set post on North Bank of
Arucas River, for the South Westm Cor. of San
Patricio County, Whence a Mes. 24, in. in dia.
MK^d 4 Chops. bro. at 88 $\frac{1}{2}$ W. 15 $\frac{2}{5}$ vrs. another
Mes. 10, in. in dia. MK^d X bro. at 25 $\frac{1}{2}$ E. 19 $\frac{2}{5}$ vrs.
another Mes. 10 in. MK^d A bro. at 36 E. 33 $\frac{2}{5}$ vrs. and
the lower edge of high hills on south side
of Arucas River bro. S 24 $\frac{1}{2}$ E.

The following are the summs crossed by
the County boundary line viz:
1st — Jns. P. Borden of which all is in San
Patricio County except 14 $\frac{1}{2}$ acres.
2nd — Live Oak County School Land

of which there are 886 acres in San Patrick's County,

3rd — Ed. J. McGloin of which all is in San Patrick's County except 64 acres.

4th — Patrick Stewan of which there are 686 acres in San Patrick's Co.

Survey completed 7th July 1888.

— Ballard }
— Gill } Chain man
O'Neal } and
Gilmon } Flag man
Allen }

I, R. W. Fenner, Surveyor for San Patrick's County, do hereby Certify that the foregoing described Survey was actually made on the ground, on the date and with the Chain Carriers aforesaid, duly qualified, and that all the corner lines, boundaries, and marks are truly and correctly described and set forth in the foregoing Plat and Field Notes.

R. W. Fenner,

Sur. for San Patrick's Co. Tex.

Witness my hand and subscribed before me, this the 20th day of July A. D. 1888.

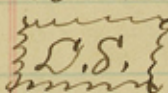
 D. S.

R. C. Esdo
clk. C. C. Bw et. Tex

The State of Texas ~~St. J. Lewis~~ Clerk of the County of San Patricio County Court in and for the County of said State do certify that the foregoing Report of R. M. Fennur Surveyor for San Patricio Co. Tex. with Field Notes and Plat of County Boundary between Live Oak and San Patricio Counties, was filed in my Office July 23rd A. D. 1888. was approved by the Hon. Commissioners Court of said San Patricio County and was Recorded March 14th A. D. 1889, in Vol. I Records of San Patricio Co. Tex. on pages 437 to 440, inclusive. Witness my hand and Seal of Office at San Patricio the day and year last above written.

L. S.
St. J. Lewis, Clerk
Co. of S. P. Co. Tex.

10/ Enclosed
 Report of
 R. M. Fennur
 Surv. for
 San Patricio County
 Survey of County Line
 between Live Oak and
 San Patricio Counties.

Filed July 23rd A. D. 1888
 St. J. Lewis
 Co. of S. P. Co.

The State of Texas
Lin Oak County Field Notes of a Survey
made to establish the Bdy. of Line between
the Counties of Law & Pecos & Lin Oak,
said Survey was made by virtue of an Order
of Commissioners' Court of Lin Oak County,
made at its May Term 1888.

Beginning at a post MK^a BL set for
the Common Corner between Lin Oak
and Bee Counties, thence a Mesq. MK^a
V 10 inches in dia. br. S. 60 1/2. W. 7 1/2 vrs. Also
a Mesq. MK^a X 10 inches in dia br. S. 67 E.
20 2/3 vrs.

Thence S. 51 W. at 420 vrs. a branch
runs S 20 W. - at 1319 vrs. a post MK^a on the
"S.E. thus "N.W. Cor. S.P. Co." and MK^a on
the S.E. Side thus "S.W. Cor. Bee, Co." and
MK^a on the S.W. side thus; "Cor. L. O. Co." -
at 1332. vrs. cross the S.W. Bdy of M. G. Fragier
Sur. his South Cor. br. S. 58 E. 1349 vrs. -
and the East cor. of a, 1280 acre Sur.
in the name of Jno. P. Borden br. S. 58 E.
vrs. - at 1900 7/10 vrs. set a post MK^a 1 and
S. P. & L. O. = at 2189 vrs. cross the Bdy. line
between the said Jno. P. Borden Sur. and
a Sur. for Lin Oak Co. School Land No. 2.
at 3801 3/5 vrs. set a post MK^a 2. S. P. & L. O. -
at 5060 vrs. a rail runs S. 58 E. at 5690
vrs. cross E. G. Miller's Pasture Fence, running

San Patricio Co. Edif. Int. # 76

at 38 1/4 W. at 0702 2/5 W. set post MK^d 3 & S. P. & I. O. at 7603 1/2 W. set a post MK^d 4 & S. P. & I. O.; at 8200 W. cross a road leading from Beeville to Lagarto, set a small post at 8363 W. cross the S. W. line of Live Oak Co. School Land at 2 1/2 S. W. cor. W. 58 N. 497 W. at 8535 W. cross road to San Patricio, and Catrillo - set a post MK^d "C. Line" road running at 47 1/2 W. at 9504 W. set post MK^d 5 & S. P. & I. O. at 9889 W. cross line between Grants to Ed. J. McGloin and Pat. Nevan, - at 11144 W. cross Beeville and Lagarto road running by Millers Ferry - set a post MK^d "Co. Line"; at 11404 W. set a post MK^d 6 & S. P. & I. O. at 12574 W. Miller Windmill W. 45 1/2 N. at 13034 W. the same mill W. at 17 1/2 E. - at 13307 W. set a post MK^d 7 and S. P. & I. O.; Whence Mesq. 30 inches in dia. MK^d V. W. at 85 E. 11 1/8 W. at 14267 W. set a post on the bank of Mueco River, for the S. W. cor. of San Patricio Co. and a S. E. Cor. of L. O. Co. said post MK^d thus "Cor. S. P. & I. O. Whence a Mesq. 24 inches in dia. MK^d III W. N. 88 1/2 W. 15 2/5 W.; Also Mesq. 10 inches in dia. MK^d A W. N. 36 E. 33 2/5 W.; from this said post the South East point of a brushy ridge of hills running from Miller Ferry down the said River on the

E6

West side, said south East Point to S 84 1/2 E.
Surveyed July 4th, 5th, 6th & 7th A. D. 1888

Jos. Allen } Chain
Geo. O'Neill }
Walter Gill } Carriers

I, T. D. Gilmon, County Surveyor of
Live Oak Co. Texas, do hereby certify that
the foregoing described survey was actually
made by me, on the ground according
to Law, on the date, and with the
Chain Carriers aforesaid, duly quali-
fied, and that all the Corners, Lines,
Boundaries, and marks, of the same
whether Natural or Artificial, are truly
and correctly described, and set forth
in the foregoing Plat, and Field Notes,
Given under my hand at Oakville
Texas, August 14th 1888.

T. D. Gilmon
Co. Sur. L. O. Co. Tex.
R. W. Turner,
Sur. for San Patricio Co. Tex.

I, T. D. Gilmon, County Surveyor of
Live Oak Co. Texas, do hereby certify
that the above and foregoing Field
Notes, are a true and correct copy
of the same, now on Record in my office,
and that the same were approved by

the Hon. Commissioners' Court of Linn Oak
Co. Texas, at its Regular Term held in
November 1888, and ordered to be re-
corded by me, in the Records of my
Office, which same is of Record in Book
P.S. Vol. I. pages 178 and 179.

Given under my hand at Oakville
Texas, January 4th 1889,

T. J. Gilmore
Co. Sur. L. O. Co. Tex.

The State of Texas
County of San Patricio, D. Stev. J. Lewis, Clerk
of the County Court in and for the County
and State aforesaid, do certify that the
foregoing Report of T. J. Gilmore County
surveyor of Linn Oak County Texas, on the
Field notes, of County Boundary Lines, between
San Patricio and Linn Oak Counties, was
filed in my Office, January 9th A. D. 1889,
was approved by the Hon. Com^{rs} Court of
said San Patricio County and was recorded
March 14th A. D. 1889, in Vol. "I" Records of
San Patricio County, Texas, on pages 440
and 441.

Witness my hand and Seal of
Office, at San Patricio the day and year
last above written,

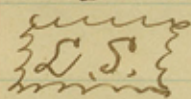
D. S. Lewis

Stev. J. Lewis, Clk. C. C.
S. P. Co. Texas

Endorsed

Report of T. D. Gilmore
County Surveyor of
Live Oak County
Survey of county
Boundary line
Between Live Oak Co.
San Patricio Counties

Filed Jan'y 9th 1889

Stev. J. Lewis,
Clerk Co. Ct.
S. P. Co. Tex.

The State of Texas,
County of San Patricio, J. Stev. J. Lewis
Clerk of the County Court in and for the
County and State aforesaid, do certify
that the foregoing contains a true
and correct copy of the Reports of
R. N. Funnur Sur. for San Patricio Co. and
T. D. Gilmore County Surveyor of Live
Oak Co. Tex., of sur. of es. Boundary line
between said Counties as the same
appears of Record in my office.

Witness my hand and Seal
of office, at San Patricio this
the 16th day of March, A.D. 1889.

Stev. J. Lewis, Clerk
Co. Ct. S. P. Co. Tex.

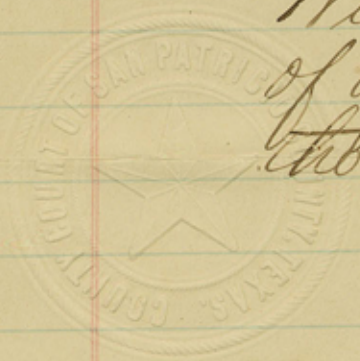

S.P. Sec Co #1

San Patricio Co Bdry Line 76

Copy of
Reports of
R. W. Fenner
and
T. J. Gilmore
Surveyors.

County Bdry Line
Between Linn Oak
and
San Patricio Counties

Abstract corrected
and certified correct
Dec 19/98 Beaumont



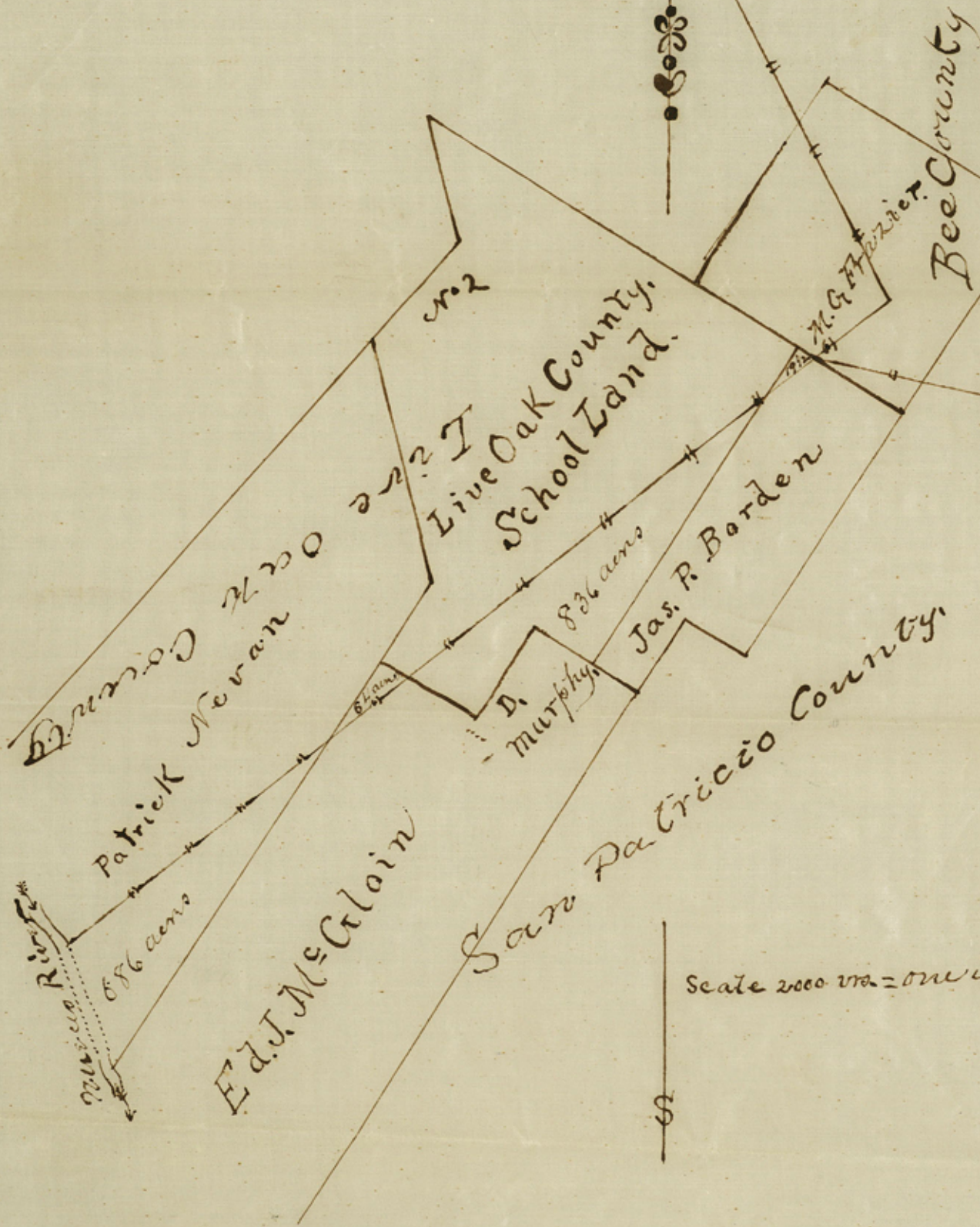

8

cont 52574