

J. C. DODSON,

COUNTY AND DISTRICT CLERK,

SHACKELFORD COUNTY.

328

Albany, Texas, June 21 1890

R M Hall Esq
Comr Genl Ld office
Austin Texas

Dear Sir,

Enclosed find Plat & field notes of south line of Shackelford Co. Please acknowledge receipt of same. I sent you some time ago Plat & field notes of the other three (3) lines, but got no acknowledgment from you of the receipt of them please let me know if you got them or not.

Yours &c

J C Dodson
Clk County
Shackelford Co Tex

Shackelford Co Bdry Ltr 3

West 6 mi

South line
Shackelford County

The State of Texas
Shackelford County

Field Notes of a survey

of the south line of Shackelford County made
by virtue of an order issued out of the
Commissioners Court of said County at
this May term 1889, May 15th 1889

Beginning at the S.W. Corner of Stephens County
an S.P.R.R. Co Survey No 464, 1135 00 varas South
and 136 00 varas East from its N.W. corner,
set Stone Mkd S.W. COR. S.C. JULY 31. 1889 on
East side and S.E. COR. S. Co. on West side
from which a forked L.O. 20" bears N 67 1/2

- N 110.6 varas, " 10" " N 59° 41'
- N 152.6 varas " 13" " N 44° 45'
- N 125.8 varas " 18" " S 57° 57'
- N 136.6 varas " 8" " S 88° 31'
- E 127 1/2 varas

Thence west at 1503.1 varas past 76.6 varas S
of the S.E. Corner of University Survey No 99
at 1900.8 varas 1st mile Stone Mkd. S.L.S.C.
from which a P.O. 17' dia. bears S. 35. W. 52.8
varas, a P.O. 14' N 89° 43' West 93.8 varas.

Thence West at 1140 varas right bank of
Battle Creek Course N. at 1147.4 varas water
edge, Crossing same to 1170.5 varas left
bank at 1790 varas, Ubank's Brauen Course
N. at 1891.8 varas left bank Battle Creek
1900.8 varas set 2^d mile Stone Mkd. 11 MSLBC
from which a L.O. 11' bears S.E. 17.3 varas.

Thence west at 40 varas bed of Battle Creek
Course S.W. Crossing at 70 varas left bank

Shackelford Co. Batry Line 3

1 some at 190 varas right bank of same
2 Creek. Crossing at 40 left bank at 400 varas
3 at 555⁴ varas cross the east line of University
4 survey No. 103. 36⁴ varas S from its N.E. Corner
5 (Variation 9° 40') at 1505 varas E line of University
6 survey No. 104. 34³ varas from N.E. Corner 1629⁸ varas
7 Road Stone on Albany & Cisco Road Mld Mld
8 Co. Line, 1655⁷ varas cross N & T.C.R. 1900⁸
9 varas at 3^d Mile Stone Mld 111 M S.L.S.C. from
10 which a mes. 6' dia. bears. S 18° 22' W. 19⁷ varas
11 Thence West. at 553² varas the East line of
12 University survey No. 107. 28² var. S of N.E. Corner
13 at 1517 varas. the East line of University survey
14 No. 108. 33 var. S. of its N.E. Corner. (Crossing a
15 branch at 1160, 1180, & 1210 var. and Past oak
16 Branch at 1240 varas) at 1556. varas. Branch
17 Q.N.E. 1900⁸ varas at 4th Mile Stone Mld.
18 S.L.S.C. V.M. from which a mes. 8' bears
19 S 77° 3' W 40⁹ varas Do. 8' S 41° 8' E 33⁶ varas
20 Thence west variation 9° 44' at 567⁵ varas
21 East line of University survey No. 111. 37⁶
22 varas South of its N.E. Corner at 1519 varas
23 the E line of University survey No 112. 27¹
24 varas, ^S of its N.E. Corner (variation 9° 50') 1900⁸
25 varas at 5th Mile Stone Mld S.L.S.C. V.M.
26 Mes. 18" N 47° 23' E 29 var. Mes 15" N 6° 53' W
27 16⁸ varas. L.O. 8' N 53° 10' W 16¹ varas. Thence
28 West. at 589² varas cross E line of University
29 survey No 115. 26⁶ var. South of its N.E. Corner
30 at 1536 var. cross E line of University survey
31 No 116. 26² var. S. of its N.E. Corner at 1700
32 varas right bank Dub Creek Crossing at

1740 varas down same Creek and crossing
 back to right bank at 1800 varas 1900⁸ varas
 set 6th mile Stone Mkd. S.L.S.C. VI M from
 which a Chittin 7" bears N 47° 58' E 4³ varas,
 Elm 12" brs. S 9° 2' W 14³ varas. Thence West
 at 80 varas Dup Creek right bank crossing
 at 125 varas, at 571⁹ varas East line of
 University Survey No 119, 35⁹ varas S of
 its N.E. Corner at 695 varas Branch C A E
 777 varas same C. S E at 836⁴ varas. same
 branch C. N. E. at 1523 varas the E line of
 University Survey No 120- 25² varas S of its
 N.E. Corner 1900⁸ varas set 7th mile Stone Mkd
 S.L.S.C. VII. M. from which a L.O. 6" bears
 S 77° 8' E 31⁴ varas (Variation 9° 55').
 Thence west at 603⁴ varas. The west line of
 University Survey No. 120. 14⁶ varas South
 of its N W Corner and 965 varas South
 of the N E Corner of L.A. Survey No 46. 1900⁸
 varas set 8th mile Stone Mkd S.L.S.C. VIII M
 from which a Mes. 15' bears N 73° 7' W 50 varas
 Mes 10' bears S 80° 44' W 65⁵ varas. Thence
 west 603⁴ varas. The East line of L.A. Survey
 47. 964 varas South of N.E. Corner 1900⁸
 varas. set 9th mile Stone Mkd. S.L.S.C. IX M.
 from which Mes. 5' bears S 76° 55' W 13 varas
 Thence west 620 varas a fence 660 varas The East
 line of L.A. Survey No 48. 963⁴ varas. South
 of its N.E. Corner 1900⁸ varas set 10th mile
 Stone Mkd. S.L.S.C. X. M. from which a Mes
 5' bears N 58° 39' E 3⁴ varas. Mes 10' bears N 45° 30'
 W 21⁸ varas. Variation 9° 37' Thence West

661 varas the East line of L. A. Survey No 49
 937 varas. South of its NE Corner 1900.8 varas Set
 11th mile Stone MKd S L S C XI. M. Variation
 $9^{\circ}45'$, Thence west at 660 varas. the E line of
 L. A. No 50. 920 varas South of its NE Corner
 850 varas Cross Cord Wood branch at 1577
 branch at 1721 varas west line No 50. L. A. 911
 varas. South from its NW Corner and 1635
 varas. S of the NE Corner of J + P R R Co. Survey
 No 66 Bk No. 11 at 1900.8 varas Set 12th mile
 Stone MKd S L S C XII. M. a mes. 12' bears
 $N58^{\circ}21'47.2$ varas a mes 20' bears $S84^{\circ}46'$
 $E29.4$ varas, Thence West at 1865.7 varas the
 E line of No 67. Bk 11. and west line of
 66 Bk 11. 1436 varas S 6 E from their ^{Common} Corner
 1900.8 varas Set 13th mile Stone MKd S L S C
 XIII. M. Thence west at 1877 varas the west
 line of No 67 + E line of No. 68. 1237 varas
 $S6^{\circ}E$ from their Common Corner 1900.8
 varas. Set 14th mile Stone MKd S L S C. XIV
 M a mes. 4' bears $42^{\circ}39'N. 19.7$ varas
 Variation $9^{\circ}26'$. Thence west at 1414 varas
 Hubbard Creek 1889 varas the west line of
 No 68 Bk 11 + E line of 96 Bk 12. 1039 varas
 S 6 E from their Common N Corner 1900.8 varas
 set 15th mile Stone a mes 10' bears $N25^{\circ}$
 $30'E 10.9$ varas mes. 20' bears $S21^{\circ}7'N44.3$
 varas, Thence west at 221 varas branch at
 1900.8 varas Set 16th mile Stone MKd
 S. L. S. C. XVI. M. Thence West 20.4 varas west
 line of 96 + E line of 95 Bk. 12. 90 varas N
 $6^{\circ}N$ their ^{middle or 1/2 mile} Common Corner 1230 varas Road

Stone on Albany + Burrud road mkd
C line, 1900.8 ors set 17th mile Stone
a mes 4' brs. S 46° 27' E 5' 9 oras mes 4'
N 63° 31' E 35' 3 oras. Thence west at
12 ors the west line of 95 + E line of
94. Berk 12, 662 oras S. 6. E. from This
Common N Corner at 380' 9 oras Top
of High Hill 1010 oras. Hubbard Creek
1900.8 oras set 18th mile Stone mkd. S. L. S. C.
XVIII M. Thence west at 35.8 ors the west
line of Sect 94 + E line of No 93. 480.4 ors
S. 6. E. from This N Corner. 1900.8 oras
set 19th mile Stone on Top of Hill.
Thence west at 52.7 oras west line of
Sect. No. 93 + E line of 92. Berk 12, 306
ors. from This Common N Corner
860 oras Branch 1230 ors. Same branch
1670 ors. Same branch and up some
to 1800 oras. 1900.8 ors set 20th mile
Stone mkd S. L. S. C. XX. M Thence west
at 73.6 oras the west line Sect. No 92 +
E line of No 91 Berk 12, 93 ors. S. 6. E from
This Common N Corner 488 ors Branch
1900.8 ors. set 21st mile Stone mkd S. L. S. C.
XXI. M. Thence west at 92.5 oras the
E line of 85. Berk 13 + West line of No 90
Berk 12, 52 ors. N. 6. W from This Common
S Corner at 200 ors Branch 1360 ors
Branch 1432 ors same branch 1900.8
ors set 22^d mile Stone mkd S. L. S. C.
XXII. M. Thence west at 113.5 oras west
line of 85 + E line of 86. Berk 13, 250 ors

1 N. 6. W from This Corner on S Corner 1900.8
2 varus, Set 23^d mile Stone MKd S. L. S. C. XXIII
3 M. Thence west at 134.6 west line of No. 86.
4 + E line of No 87, 450 varus. N. 6. W from This
5 Common S Corner 525 varus Branch 1433
6 varus branch 1900.8 varus, Set 24th mile
7 Stone MKd. S. L. S. C. XXIV. M. Mus 6' bears
8 N 40° 32' W 33.5 varus Mus 7" bears S 41° 41'
9 W 89.8 varus. Thence west at 126.5 varus west
10 line of No 87 + E line of 88 Bed 13. 340 varus
11 S 6 E from This middle or 1/2 mile Corner
12 (Variation 9° 32') at 260 varus drain
13 1900.8 varus Set 25th mile Stone MKd.
14 S. L. S. C. XXV. M. Mus 6' bears N 31° 37' W 36.2
15 varus. Thence West 145.7 varus west line
16 of Sect. 88 + E line of 89 Bed. 13. 187.4 varus
17 S. 6. E This middle or 1/2 mile Corner 1900.8
18 varus Set 26th mile Stone MKd S. L. S. C.
19 XXVI. M. Thence west at 157.6 varus
20 west line of 89 + E line of No. 90. Bed
21 No 13. 41.4 varus S 6 E from This middle
22 or 1/2 mile Corner 854 varus. Branch
23 1900.8 varus Set 27th mile Stone MKd S. L. S. C.
24 XXVII. M. a Mus. 7 bears N 31° 7' W 56.7 varus
25 a Mus. 7' bears S 14° 40' E 62.2. Thence
26 west 210.7 varus The west line of Sect
27 No. 90. Bed 13 + E line of No. 63 Bed 14
28 172.8 varus. N. 6. W. from This middle Corner
29 1900.8 varus Set 28th mile Stone MKd
30 S. L. S. C. XXVIII. M a Mus 8' bears S 56° 34'
31 E 57.7 varus. Thence west 221.7 varus
32 the west line of Sect No. 63 + E line

1 of No. 64. Bk 14-579 ors S 6 E from
2 this Common^N Corner 1700 varas brueck
3 1900.⁸ ors set 129th mile Stone MKd S. L. S. C
4 XXIX. M Thue west at 215.³ varas the
5 westline of sect No. 64. + E line of No. 69
6 Bk 14-415.⁴ ors S 6 E from this Common
7 N Corner at 1300.³ varas the East line
8 survey No. 17. B. A. 485.⁶ ors South of
9 its N.E. Corner at 7070. varas to the
10 S W Corner of Shackelford Co. set Stone
11 from which a mes. 7' bears N 68° 31' E
12 40.9 ors mes. 7 8 11° 9' E 36.⁶ ors.

13 Completed Oct 19th 1889

14 W. A. Williams

15 Wm Pacey

Chain Carriers

16 I W. A. Eakert Special Surveyor
17 for Shackelford County do Certify That
18 the foregoing survey was made by me
19 on the ground according to law, and
20 that all the Corners, lines Boundaries
21 + marks of the same are truly and
22 correctly described and set forth in
23 the foregoing plot + field notes.

24 W. A. Eakert

The State of Texas
County of Shackelford. } ss

J. J. Dodson
Clerk of the County Court of
Shackelford County, Texas, do
hereby certify that the foregoing
is a true copy of the field notes
and map of the south boundary
line of Shackelford County, which
line was surveyed and marked
as provided by law and the field
notes and map thereof has been
~~made~~ by H. A. Cahart Surveyor
duly returned to the Commissioner's
Court of aforesaid County and duly
recorded by me in the Minutes
of said Commissioner's Court in
Book 3.

Given under my hand
and seal of office this the 21st
day of June 1890.

J. C. Dodson
Clerk Co Court
Shackelford County

96

§

Field notes
of
Southline
of
Shackelford County

Filed June 23^d 1890.

P. C. Shelley
CHIEF CLERK.

Callahan Co was not represented in running said line as the law requires - also the S.W. corner devised does not agree with the N.E. corner of Taylor, S.D. corner of Jones County, but lies East & South of it.

Shackelford Co Bdry Line 3

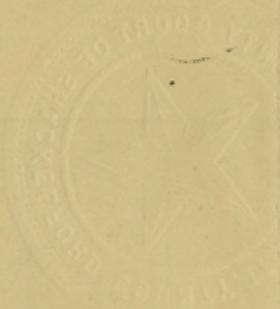

58658
Shackelford Co. Bdry. Line #3

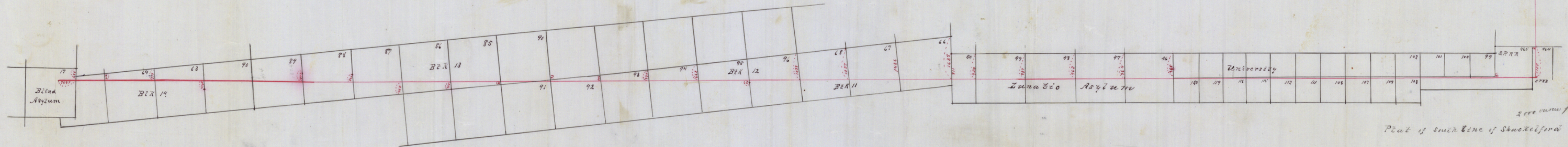

2000 acres per inch
 Part of Smith Line of Shackelford County

5865
 1865

61731

Worcester County

John G. ...

John G. ...

Received of the ...

of the ...

of the ...

of the ...

Worcester County

621-1890

REGISTERED

COCKLE AND DISTRICT CLERK

J. C. DODSON

358