

SHERMAN COUNTY.

W.D. TWICHELL

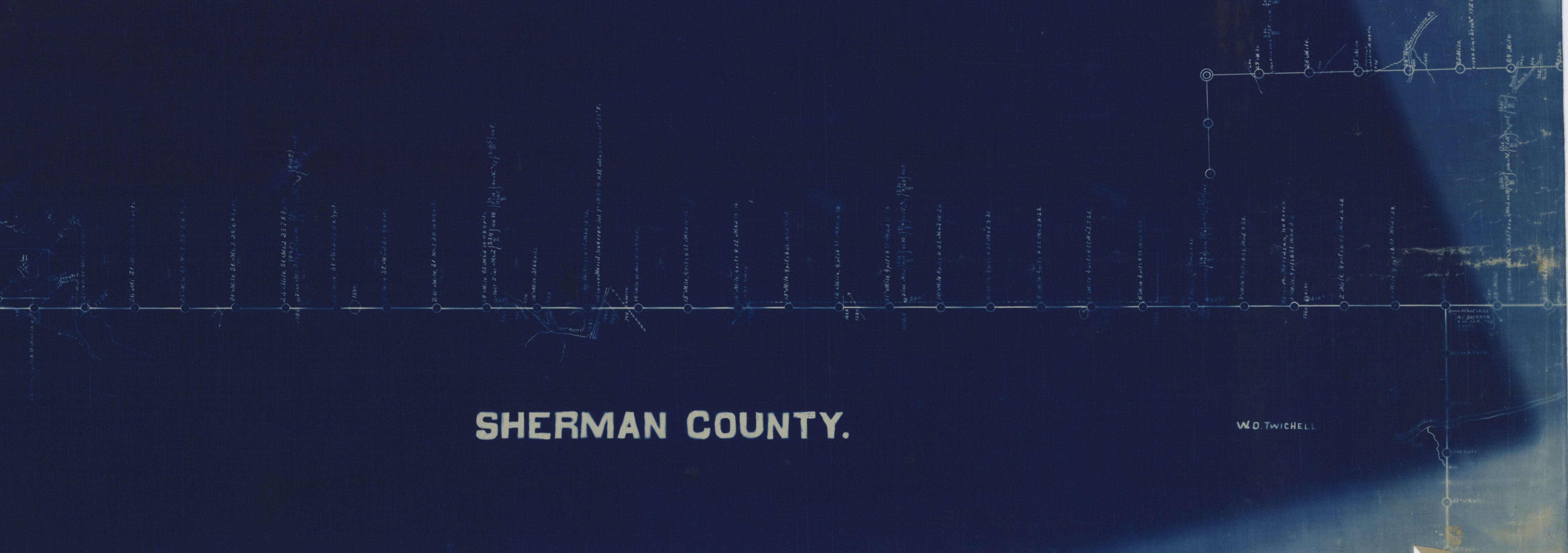

The State of Texas.

County of Sherman

Field notes of a survey of Sherman County's north boundary:

Beginning at a stone 30" X 42" set in ground marked N.E. SHERMAN N.W. HAN and 4 large pits, the same being 70 miles west from the N.E. corner of the Panhandle and located for Sherman County's N.E. corner the same being Hansford County's N.W. corner, thence west at 1900.8 vrs set stone marked 1-29 in ground, build earth mound 2 feet high and dig 4 large pits.

Thence west at 1900.8 vrs, 4 large pits, earth mound 2 feet high and stone marked 2-28

Thence west at 1360 vrs W. S. zinc corner bro N. 218.4 vrs, at 1900.8 vrs, 4 large pits, earth mound 2 feet high and stone mkd 3-27
Observe meridian and find true course.

Thence west 1900.8 vrs. 4 large pits, earth mound 2 feet high and stone mkd 4-26

Thence west at 1360 vrs zinc and S. corner bro N 229 $\frac{3}{10}$ vrs same is marked ($\overset{S36}{R12E}$) on W., ($\overset{S5}{T1N}$) on N., and ($\overset{S31}{R13E}$) on East side, set 1375 vrs cross wagon road at 1900.8 vrs 4 large pits, earth mound 2 feet high and stone marked 5-25.

Thence west, at 320 vrs pass small basin, at 1380 vrs corner of fence bears N. about 200 vrs, at 1900.8 vrs, 4 large pits, earth mound 2 feet high and stone marked 6-24

Thence west at 1320 vrs cross ravine, at 1900.8 vrs, 4 large pits, earth mound 2 feet high and stone marked 7-23.

Thence west. at 40 vrs pass small basin, at 1900.8 vrs 4 large pits, earth mound 2 feet high and stone marked 8-22.

Thruce west, at 1900.8 vrs. 4 large pits, earth mound 2 feet high and
stour marked 9-21

Thruce west, at 1900.8 vrs. 4 large pits, earth mound 2 feet high
and stour marked 10-20.

Thruce west, at 1376 $\frac{7}{10}$ vrs. u.s. zinc corner marked ($\begin{smallmatrix} S36 \\ R11E \end{smallmatrix}$) on W,
($\begin{smallmatrix} S \\ TIN \end{smallmatrix}$) on N. and ($\begin{smallmatrix} S31 \\ R12E \end{smallmatrix}$) on E, ^{bro N. 260.5 vrs.} at 1900.8 vrs. 4 large pits, earth mound
2 feet high, and stour marked 11-19.

Thruce west, at 1280² and 1828 vrs cross ravines at 1900.8¹⁰ vrs 4 large
pits, earth mound 2 feet high, and stour marked 12-18.

Thruce west, at 1900.8 vrs. 4 large pits, earth mound 2 feet high
and stour marked 13-17.

Thruce west at 1440 vrs cross road, at 1549 vrs cross 4 wire fence
at 1900.8 vrs 4 large pits, earth mound 2 feet high and stour marked 14-16

Thruce west, at 1900.8 vrs 4 large pits, earth mound 2 feet high and
stour marked 15-19.

Thruce west at 1900.8 vrs, 4 large pits, earth mound 2 feet high
and stour marked 14-16.

Thruce west. at 340 vrs cross 4 wire fence, at 945 cross ravine, at
1340 cross Beaver Creek, at 1685 cross road, at 1900.8 vrs 4 large
pits, earth mound 2 feet high and stour marked 17-13.

Compass meridians and find line correct. Magnetic variation on
July 7th 1897 at 6 A.M. is $11^{\circ} 55' E$.

Thruce west at 1420 vrs pass head of canon, at 1900.8 vrs. 4 large
pits, earth mound 2 feet high and stour marked 18-12.

Thruce west, at 470 vrs cross ravine at 480² and 1365 cross road,
at 1384⁶ u.s. zinc marked $\begin{smallmatrix} S34 \\ R11E \end{smallmatrix}$ on W, ($\begin{smallmatrix} S \\ TIN \end{smallmatrix}$) on N, and ($\begin{smallmatrix} S35 \\ R11E \end{smallmatrix}$) on E, bro
N 255 vrs. at 1900.8 vrs, 4 pits, earth mound 2 feet high, and stour mld 19-11.

Thruce, west at 1900.8 vrs, 4 large pits, earth mound 2 feet high and
stour marked 20-10.

Thruce west, at 1900.8 vrs, 4 large pits, stour marked 21-9. and earth
mound 2 feet high.

- Thruce west, at 1280 pass basin, at 1900.8 vrs 4 large pits, earth mound 2 feet high and stour marked 22-8
- Thruce west at 1384 vrs W & zinc corner marked $\begin{pmatrix} S36 \\ R9E \\ \equiv \\ \equiv \end{pmatrix}$ on W., $\begin{pmatrix} S \\ TIV \\ \equiv \\ \equiv \end{pmatrix}$ on N., and $\begin{pmatrix} R10E \\ S31 \\ \equiv \\ \equiv \end{pmatrix}$ on E., bro N. 258.7 vrs.; at 1900.8 vrs 4 large pits, stour marked 23-7, and earth mound 2 feet high.
- Thruce west, at 1900.8 vrs, 4 large pits, earth mound 2 feet high and stour marked 24-6.
- Thruce west, at 1900.8 vrs 4 large pits, earth mound 2 feet high and stour marked 25-5.
- Thruce west, at 1900.8 vrs 4 large pits, earth mound 2 feet high and stour marked 26-4.
- Thruce west, at 1705 vrs bluff, at 1900.8 vrs 4 large pits, earth mound 2 feet high and stour marked 27-3.
- Thruce west, at 130 vrs pass point of bluff, at 440 vrs cross ravine, at 1707.5 vrs large stour pile on bluff bro N $40^{\circ}36'E$ 150 4.7/10 vrs, at 1900.8 vrs 4 large pits, earth mound 2 feet high and stour marked 28-2, whence bridge of rock bro S. $68^{\circ}25'W$.
- Thruce west at 760 vrs cross Beaver Creek, at 1900.8 vrs, 4 large pits, earth mound 2 feet high and stour marked 29-1, whence stour pile on bluff bro N $69^{\circ}36'E$. Passed zinc corner at 1384.1/10 vrs same bearing N. 292.6/10 vrs and marked $\begin{pmatrix} S36 \\ R8E \\ \equiv \\ \equiv \end{pmatrix}$ on W., $\begin{pmatrix} S \\ TIV \\ \equiv \\ \equiv \end{pmatrix}$ on N., and $\begin{pmatrix} S31 \\ R9E \\ \equiv \\ \equiv \end{pmatrix}$ on E.
- Beginning at ^{stour} stour mkd 29-1. Thruce west, at 1060 vrs cross ravine, at 1900.8 vrs 4 large pits, earth mound 2 feet high and stour marked N.W. SHERMAN, and N.E. DALLAM.
- Whence. Points of bluffs bear N $85^{\circ}46'E$, N $76^{\circ}57'E$, N $71^{\circ}30'E$, N $62^{\circ}34'E$, N $56^{\circ}E$, N $32^{\circ}6'E$, and S $36^{\circ}45'E$. And the S.W. Corner of Survey 33 T1, R. 8 E bro N. 5186 vrs and N. 300 vrs. From said S.W. Corner of Survey 33 a connection now in the Land Office shows that the N.E. Corner of 17 Block 50 H+TC. bro S. 3803 vrs and N. 5129 vrs

Page 4.

I, W. D. Mitchell, Special Surveyor for Sherman County, Tex.
do hereby certify that the foregoing field notes are
true and correct and that the marks both natural and
artificial are truly described in the foregoing field
notes and that said survey was actually made on
the ground.

Witness my hand this 25th day of March, 1878
W. D. Mitchell, Special Surveyor
for Sherman County, Tex.

Sherman Co Bdry ~~H~~ Line 2

Field notes.

of the Northboundary of
Sherman County.

Filed in the General Land
Office April 4th 1898.

SEE SK. FL "D"

Examined and found correct
Suspended - Randolph Co. not
being represented in establishing
the N.W. corner of said Co.

E. W. Presley

W. D. TWICHELL,
CIVIL ENGINEER AND
COUNTY SURVEYOR

185-3

AMARILLO, TEXAS, Mch. 26 1898

Hon. A. J. Baker,
Austin, Tx.

Dear Sir:

By today's mail I send you a
copy of the field notes and sketch of
Sherman County's north line. Hoping
same will meet with your approval
I am

yours truly
W. D. Twichell.

