

The State of Texas Plot and field notes
 County of Stephens of a survey of the East
 line of Stephens and west line of Palo Verde
 County and the South line of Stephens County
 Texas made by virtue of an order issued
 out of Commissioners Court of Stephens County
 Texas on the 7th day of July A.D. 1888 and also
 of an order issued out of the county court
 of said County on the 9th day of July
 1888 Beginning at a Rock set in ground
 in the South line of Young County 30
 miles west and 3 miles and 533² vs South
 from the north west corner of Parker
 County and 979 vs N 88° 57' W from the 8th
 mill post at said Young County line
 and north East corner of a survey in name
 of James Finley said Rock marked on
 East side "N W COR PPC" and on West side "NE
 COR SCO April 16th 1889" from which a P.O. 14" vs
 S 38° 20' W 36 vs do 10" S 61° 10' E 24 vs do 12" N 89°
 7' E 47 vs vs 12" S 80° 12' E 5.2 vs variation taken
 June 24th 1889 - 9° 23' C Hence South 1191² vs
~~branch Co. B. tributary of Cave Creek~~
 Hence South 1191² vs branch Co. C. tributary of
 Cave Creek 412.4 " " " N.E. " "
 " " 418.2 " " " " " "
 " " 535.2 vs Branch Co. N.E. 1516 vs branch
 1900.8 vs P.O. N.S. P.O. 12" S 10° 5' E 8.9 vs P.O. 12"
 N 21° W 12.2 vs
 Hence South 131 vs S line said Finley sur.
 and north line Susan Latham survey 1109.8
 vs C of their common west corner 834 vs

Stephens Co Edry Line 2

1 South brow of hill 1900.8 vs sek 2nd M.S. P.O. 6"
 2 S 58 W 8 vs 20 7 1/2 19 37 E 11.2 vs
 3 Thence South 1868 vs S line said Latham and
 4 north line of a Preemption sur. 1086 vs E of their
 5 common ~~W~~ cor. 1900.8 vs sek 3rd M.S. wood imp
 6 ment L.O. 14" S 7-54 W 108.9 vs L.O. 12" S 1-20 E 106.2 vs
 7 Thence South 168 vs N line Jno P Gill sur
 8 1086 vs E its N.W. cor. 1674 vs S. line said Gill
 9 sur. 400 vs W of its S E cor. and 56 vs E of N.E. cor
 10 of J Rodriguez sur. (crossing branch at 239.9
 11 vs and 552.3 vs) 1900.8 vs sek 4th M.S. Mus. 18"
 12 N 89-50 E 56.6 vs L.O. 15" S 31-48 W 110.8 vs
 13 Thence South 1258 vs S brow of mt N of
 14 Cedar Creek 1344.7 vs N line of L. Browner sur.
 15 415.4 vs E of its N.W. cor 1454 vs weathering
 16 and Jch Griffin Road 1900.8 vs sek 5th M.S. mill
 17 Stone in cedar creek bottom Mus. 7" S 47-10 vs
 18 P.O. 5" N 32-52 E 21.1 vs
 19 Thence South 290 vs cross cedar creek
 20 into dense thicket and up side of
 21 Cedar oak bluff 444 vs S. line said
 22 Browner sur. 415.6 vs W of its S.W. cor
 23 cross branch several times 1900.8 vs sek
 24 6th M.S. on top shin oak mountain
 25 on W fork tripple Elm 4" S 31-8 E 11.9 vs ~~8~~ on
 26 top Sandstone 79.25 E 21 vs
 27 Thence South 535 vs Branch Co N.W. 782.4 vs
 28 E point mt 1098.6 vs Branch 1352 vs Branch
 29 Co N.W. 1900.8 vs sek 7th M.S. double L.O. NW fork
 30 15" N 33.16 E 59.6 vs L.O. 14" N 47-28 E. 52.8 vs
 31 Thence South 837 vs S brow sek canon
 32 1392 top of mountain S of said canon

11.2 vs

1752 Spring Branch Co W 1900.8 vs sek 8¹⁵

M.S. in Day cedar glade Cedar 4" N 19

10 W 7.2 vs Elm 6" N 11-47 E 19 vs

Thence South 220 vs top mk 13 52.8 vs Rock

Thence 1839.8 vs Branch Co E. 1900.8 vs sek 9⁵

M.S. on low Rocky hill large limestone on

ground for mill stone Cedar 12" N 72-38

W 9 1/2 vs L.O. 10" N 73.5 E 8.9 vs

Thence South 133 vs Branch Co E 532 vs

Branch N.E. and up canon and crossing

small creek Co N.E. 1900.8 vs sek 10¹⁵

M.S. N of E point mk in head of drain.

P.O. 15" S 9 1/2 W 29.4 vs L.O. 10" N 20-32 W 82 vs

Thence South 26.2 vs N line sec 2 Blk

4 T. & P. R. Co 153.4 vs S 84 W of its N.E. cor 222.2

vs E point high mk and then crossing up

Canon at 1746 vs Branch Co E 1900.8 vs

sek 11¹⁵ M.S. L.O. 5" N 15 E 14.9 L.O. 18" S 84 1/2 W

55.1 vs

Thence South 41 vs N line sec. 11 Blk 4

620.8 vs

7820 E side N 1/2 mile cor 750 vs South brow bluff

North of Caddo Cross Caddo at about 1000

vs 1900.8 vs 12th M.S. in inaccessible gorge sek

stone on top bluff 1925 vs South L.O. 5" N

87.40 E 5.4 vs double cedar 9.8 13-43 W 112 vs

Thence South from end of 12th mile 288 vs

top of canon North of Little Caddo 1039.5

vs top of canon S of Little Caddo 1900.8 vs

sek 13th M.S. Cedar 13" N 14-5 E 98.2 vs P.O. 11" S 40

40 W 104.6 vs

Thence South 68 vs N line sec. 23 Blk 4 670.8 vs

S W

1 N 84 E of its N.E. cor. crossing branch in road
 2 break at about 400 vs 1314 vs top of hill
 8 N of Little Caddo 1900.8 vs sek 14¹⁵ M.S. in
 4 valley L.O. 12" S 4 5/4 E 2/4 vs L.O. 8" N 5/4 W 3/2 vs
 5 thence South 103.4 vs N line Sec. 26 Blk W
 6 837.4 vs S 84 W of its N.E. cor. 163 vs Little
 7 Caddo course N 20 E and up channel of said
 8 stream to about 500 vs 1900.8 vs sek 15¹⁵ M.S.
 9 L.O. 10" N 22-33 E 2.6 vs L.O. 9" N 79 1/2 W 2.6 vs
 10 thence South 108 vs N line Sec. 35 Blk H 7 X P
 11 Ry Co 877.5 vs N 84 E of its N. ^W cor. 276 vs
 12 Branch Co. W. 460 vs Breckenridge and Palo
 18 Pinto road 1160 vs top of mk 1900.8 vs
 14 sek 16¹⁵ M.S. in hollow Co. W. P.O. 6 3 2 1/4 W 6 vs
 15 P.O. 12" N 65 1/2 E 5.3 vs
 16 thence South 94.2 vs N line Sec. 38 7 X P 226 vs
 17 S 84 W of its N 1/2 mill cor. 438 vs Branch in
 18 deep hollow Co. N.W. 9 2.7 vs small branch
 19 1415.6 vs spring branch 1472 vs spring branch
 20 course N.W. 1900.8 sek 17¹⁵ M.S. P.O. 12" N 3 1/4 E
 21 E 2.47 vs P.O. 12" S 5 1/2 W 2.4 vs
 22 thence South 90 vs high open prairie
 28 1042 vs N line Sec. 47 7 X P 423.5 vs S 84
 24 W of its N 1/2 mill cor. 840 vs top of bluff
 25 1260 vs Branch Co. E. 1900.8 vs sek 18¹⁵ M.S.
 26 L.O. 18" N 32 2/3 W 5.5 vs
 27 thence South 120.2 vs N line Sec. 50 7 X P 321
 28 vs S 84 W of its N 1/2 mill cor. 1900.8 vs sek
 29 19¹⁵ M.S. in large prairie no bearing
 30 thence South 100.6 vs N line Sec. 59 7 X P
 31 187 vs N 84 E of its N.W. cor. 56 1/2 vs spring
 38 branch 781 1/2 vs spring branch 1173 vs

1 + Spring in head of hollow 1900.8 ves set
2 20¹⁵ M.S. L.O. 20" S 5 W 26.8 vs L.O. 18" S 13.10 C 88

3 2 vs
4 Thence South 67 vs N line Sec. 63 4 x P 62.6
5 vs S 84 W of its N.C. cor. 480 vs Road cor. 20 C
6 884 vs N bank Spring Creek 1900.8 vs 21st M.S.
7 on South brow hill & on W side road Elm
8 8" S 30-25 C 1.6 vs P.O. 8" N 35 1/4 W 2' 80 vs

9 Thence South 105.4 vs N. line Sec. 70 7 x P 234
10 vs S 84 W of its N.C. cor. 999.6 vs W edge Camp
11 Rk rd on top high mt then along & narrow
12 back bone and across steep narrow pass

13 1500 vs 1868 vs N line Sec. 75 7 x P 542 vs N 84 C of
14 its N 1/2 mile cor. 1900.8 vs set 22nd M.S. near C
15 brow mt Elm 8" on edge bluff N 69-20 C 21.3
16 vs L.O. 8" on edge bluff S 39 1/2 C 27.9 vs

17 Thence South 100 vs C brow mt 1900.8 vs
18 set 23 M.S. crossing N line Sec. 82 at 1870 vs
19 370.2 vs N 84 C of its N 1/2 mile cor. milestone
20 in fork of road at head of canon L.O. 5"
21 S 18-40 W 3.6 vs L.O. 18" S 6 1/2 C 67.6 vs

22 Thence South 90 vs branch Co S.C. 919 vs
23 top of canon 1900.8 vs set 24th M.S. on bluff
24 said canon Cedar 6" N 9-27 W 20.7 vs Elm
25 4" N 30 1/2 C 6.9 vs

26 Thence South 12 vs N line Sec. 87 7 x P 167.3
27 vs N 84 C of its N 1/2 mile cor. crossing cedar
28 break in canon to 8820 vs top bluff mt N of
29 South Bills Creek 1785.3 vs crossing Buckenage
30 and Straun road and said creek and up
31 draw in side of mt 1900.8 vs set 25th M.S. on
32 South point large mass of shivert limestone

1 on W brow mt cedar 15" N 31 W 5.4 vs double
2 cedar 6" N 51-30 E 44 vs.

3
4 + Thence South 15' vs N line sec. 94 T & P 16⁶/₁₀ vs
5 S 3/4 W of its N 1/2 mile cor. then up steep rough
6 canon 1214.3 vs top of hill 1900.3 vs sec 26¹⁵
7 M.S. on S slope mt Elm 5' N 2-26 W 72 vs
8 Elm 6" N 80. 24 E 41 vs

9 Thence South 20 vs S line sec. 94 B L K H T P
10 RR Co. 1130 vs S 3/4 W of its S. E. cor. 861 vs
11 branch 1327 vs Branch 1768.6 vs N line A.
12 Fairbanks sec. 177.6 vs W of his N. E. cor.
13 1900.8 vs sec 27¹⁵ M.S. on E bank drain vs
14 10" N 59. 33 E 13 vs S. O. 8" S 47 W 40 vs

15 Thence South 13.4 vs drain 260 vs Branch
16 1900.8 vs sec 28¹⁵ M.S. (at 1716.3 vs N line of F.
17 Ford on Henry Brown sur. 108.6 vs E of NW
18 cor. and at 1882.5 vs pass 102 vs E of NE cor
19 sur No 7640 acres in name of B. B. B. & C. RR Co.)
20 E prong 13" double S. O. ^{old} bearing to land vs S
21 79-53 W 52.6 vs E prong 16" triple S. O. old
22 bearing to N. E. cor B. B. B. & C. sur N 68 1/4 W 70 vs.

23 Thence South passing through house
24 468.9 vs S line said Ford sur. 98 vs E of
25 its S. W. cor 877 vs drain 837.2 vs N line
26 W 26 Rickett sur. 74 vs E of its NW cor. 1487.3
27 vs center of T. & P. RR, 873 E 57.7 vs from
28 Biday No 115 at 1560 vs N bank Palapinto Creek
29 Co E 1700 vs large Rock at base of mt 1900.5
30 vs sec 29¹⁵ M.S. on N side steep cedar mt
31 thin 0.5" N 62. 40 W 3.8 vs cedar 24" N 65 1/2 E 42 vs

32 Thence South 241.4 vs top of mt 1030 vs
33 S brow of hill 1609.7 vs N bank Russell creek

on flat rock bottom 1703.8 vs to
 South bank 1900.8 vs sch S.W. cor Palo
 Pinto and S.E. cor Stephens County in pile
 Stone marked on E side S.W. cor P.P. Cox and
 on west side S.E. cor S.C. J. 17 11 1889 Elm 24
 W 8 W 179 vs Pecan 12' N 50 E 167 vs 3 Elm
 each 8" S 20 55 W S 20 58 W S 21 2' W 214 vs Cedar
 12" on E point mk (mk marked) N 10 27 W
 mill stones marked on E side W L.P.P.C. W and
 number of the mill on W side F.I.S.C.
 M and the number of the mill variation
 taken by agreement at this point.

7-28-C
 Thence west 353 vs Rock in E bank
 Russell Creek 393.7 vs W bank said creek
 405 vs drain 800 vs fork mk 958 vs top
 Rock ledge on mk said 1065 vs E low mk
 1100 vs old county line run by Wm Mc
 Cornell and McKee 264 vs N of cor. 1781 1/2 vs
 Rocky drain 1900.8 vs sch 1st M.S. in drain
 W. N Elm 10' N 77 50 E 2.8 vs Elm 10" S 11-2
 7.6 vs
 W.S. in drain

Thence west 951 vs Branch 998 vs Road 1111
 vs Branch 1128 1/2 vs Branch 1217 vs Branch
 1900.8 vs sch 2nd M.S. near top S.E. point high
 mk met. 6" in chest S 33-20 W 15-6 vs met 2" on
 old stump S 66 1/2 W 19 vs.

Thence west 63 vs pass 164 vs N of N.W. cor
 J.R. Anderson sur. 174 1/2 vs sep Branch Co
 N 1853 vs Ravine 1900.8 vs sch 3rd M.S. in thin
 Oak glade L.O. 12" S 10-50 W 81.8 vs L.O. 8857.37
 W 8 vs

777
 The Rock

1 Thence west 714 vs edge bluff and
 2 canon E of Palo Pinto Creek 1900.8 vs
 3 4¹⁵ mile in accessible point on side of
 4 bluff W of Palo Pinto creek set stone
 5 35.6 vs west. 310 vs W of edge of bluff
 6 Thence west from end of 4¹⁵ mile 1441.6
 7 vs W line of E Chambliss sur. 17196
 8 vs N of S.W. cor. 751.4 vs center of F.P.P.R.
 9 124.3 vs S 15¹/₂ W from the 5²⁵/₁₅ mile board
 10 from El Paso, 1900.8 vs set 5¹⁵ M.S. in S.C.
 11 flat Hooked Elm 12° N 79-18 W 62.8 vs Elm
 12 7° N 42-47 W 82.9 vs
 13 Thence west 68 vs drain & enter same
 14 ruff 1039 vs E line S. A. Boles sur. 112 vs N of his cor.
 15 1701 vs 1817.6 vs 1844.6 vs cross roads 1900.8 vs
 16 set 6¹⁵ M.S. in bushy flat P.O. 12° N 80-18 E 34.
 17 8 vs P.O. 5° N 46¹/₂ W 4.8 vs
 18 Thence west 89.6 vs W line paid Boles sur.
 19 and E line W. Noland sur. 110 vs N of their
 20 common S. cor. 766.6 vs W line paid Noland
 21 sur. 1147 vs N of his S.W. cor. 779 vs road 1175
 22 vs Buckenridge and Ranger Road 1900.8 vs
 23 set 7¹⁵ M.S. in P.O. Timber P.O. 8 S 26 W 5¹/₂ vs
 24 P.O. 12° N 74-40 E 106 vs
 25 Thence west (variation taken at this point 9°
 26 39' E) 717 vs old marked line (supposed to be W line
 27 F. W. Holmes Sur. but none of its corners could
 28 be found) and E line of J. Noland Sur. 899.6
 29 vs S of its N.E. cor. 1185 vs drain 1192.4 vs W
 30 line paid Noland sur. 899.6 vs S of its N.W. cor.
 31 and E line of C. Stone Sur. 1507 vs N of its S.E. cor.
 32 1197 vs drain 1214 vs drain 1900.8 vs set 8¹⁵

1 M.S. in Black Jack Sand ruff B.G. 10° N 16.4 E 7.8
 2 vs B.G. 11° N 81-35 E 15.2 vs
 3 Thence west 2.30 vs old road & W line said
 4 Stone & Elina F.P. Barnett Sur. 149.5 vs 2nd of them
 5 corner S. Cor 641.5 vs cross ditch into field 1134
 6 vs W line said Barnett Sur. 135.6 vs N of its
 7 S.W. cor 148 vs Elina Sur. 126 H. Y & B Ry Co. 717
 8 vs N of its S. E. Cor. 1381 vs Breckenridge &
 9 Ranger Road via Barnes 1900.8 vs sec 9¹⁵
 10 M.S. marked on N side S. C. L. 9 N and on S side
 11 E. C. L. P. O. 12° S 82-52 E 10.9 vs P. O. 12° N 70 1/4 W 8.9 vs
 12 Thence west 226 vs drain 11400 vs N point
 13 Rocky Hill 1148 vs Elina Sur. 126 H. Y & B
 14 Ry Co. 1180.5 vs S of its N. E. cor 1373 vs E bank
 15 Colony Hook Leon Co S. 20 W 1890 vs old
 16 road 1900.8 vs sec 10¹⁵ M.S. P. O. 11° S 27-6 E
 17 7.8 vs P. O. 20° N 13-50 W 17 vs
 18 Thence west (variation 9°-42° E) 406 vs
 19 Branch 445 vs road 1150 vs Elina Sec.
 20 127 H. Y & B Ry Co 1184.7 vs S. of its N. E. cor
 21 1282 vs drain 1401 vs mass of rocks on S. E.
 22 slope hill 1814 vs Road 1900.8 vs sec 11¹⁵
 23 M.S. P. O. 14° S 5' W 8 vs P. O. 7° N 55 3/4 W 3.6 vs
 24 Thence west 451 vs Rivin 1099 vs
 25 Road 1161.4 vs Elina Sec. 128 H. Y & B Ry Co.
 26 1190 vs S of its N. E. Cor. 1200 vs branch
 27 Co. S. 1900.8 vs sec 12¹⁵ M.S. P. O. 13° S 40-12 E
 28 5 vs P. O. 7° N 41-35 W 9.8 vs.
 29 Thence west 24 vs Road 455 vs Brecken-
 30 ridge and Eastland Road 1160 vs
 31 W line Sec. 128 H. Y & B 1172 vs S of its N. W.
 32 cor and Elina P. L. Leamon Sur. 1338.3 vs

1 S of its N.E. cor 1400, 1432 & 1452 vs cross
 2 tributary-Gunzulus cr 1490 Branch ca N
 3 1693 vs drain 1824 vs drain 1900.8 vs sek
 4 13th MS. P.O. 9 N 48-32 E. 9.8 vs do 11' S 44 W
 5 7.6 vs
 6 Thence West (variation 10°-7 E) 316 1/2 vs
 7 drain 907 vs Branch 1003 vs old Breckenridge
 8 & Eastland Road 1378 vs Branch 1673.8 vs
 9 W line said Canon Sur. 1545 vs S of its N.E.
 10 cor and E line Sturman Sur. 1868.8 vs E
 11 line Sur 460 S.P. Ry Co 3046 vs S of N.E. cor
 12 Sur 450 S.P. Ry Co 1900.8 vs sek 14th MS. P.O.
 13 30" S 88-27^{3/4} E vs do 8" N 10-50 W 26.3 vs
 14 Thence West 260 vs W brow hill 286 & 557 vs
 15 cross road leading S.W. 662 vs tributary
 16 Gunzulus cr 809 vs same road 842 vs
 17 Branch 119 vs top of high Knoll 1429
 18 vs Branch 180 vs E line Sur 459 S.P. Ry Co
 19 978 vs S of its N.E. cor 1900.8 vs sek 15th
 20 MS. mer. 10 S 64-42 E 41.4 vs mer. 12" N 21-15'
 21 W 217 vs
 22 Thence West 812 vs Road 1820 vs W brow mt
 23 1754.2 vs E line Sur 438 S.P. Ry Co 1007.2 vs S of
 24 its N.E. cor 1900.8 vs sek 16th MS. in valley
 25 W of P.O. page P.O. 12" N 15 W 1.2 vs P.O. 18" S 84 W
 26 21.5 vs
 27 Thence West 204 vs Gunzulus creek 741
 28 vs Gunzulus & Eastland Road 1318.4 vs E
 29 line Sur 457 S.P. Ry Co 1020.4 vs S of N.E. cor
 30 1398 vs top mt 1415.2 vs W brow mt 1900.8 vs
 31 sek 17th MS. at W base mt P.O. 12" N 22-20 W
 32 13 vs mer. 12" S 9-6 E 22 1/2 vs

1 Thence West 378 vs Branch 570 vs BX (Road

2 724 vs W. Simpson Cr 731.4 x 762 vs Same

8 Stream 804 vs E bank Lake 14 vs wide 1254 vs

4 BX (Road 1265.4 vs E line Sur 4563 P Ry Co 1044

6 vs S of Pitt NC cor 1900.8 vs set 18th M.D. in W

6 Landers field mes. 14th N 9th E 1072 vs

7 Thence West 1265 vs E line Sur 4563 S P Ry Co

8 1054 vs S of Pitt NC cor 1870 vs Drain 1900.8 vs

9 set 19th M.D. in valley S of CxW chain of

10 hills Round hill N 5 1/2 W about 175 vs mes

11 12th N 13 1/2 W 30 vs E fork tripple mes 10th N 8 1/2 W 15 vs

12 var 10th E.

18 Thence West 180 vs branch and along S

14 peak of hills 1250 vs E line Geo W Chick

15 Sur 838 vs N of Pitt S E cor also S. W. cor

16 Sur 455 S P Ry Co 1900.8 vs 20th M.D. in about

17 mes. flat mes. 20th N 43-12 E 19 vs mes 6th N

18 05th W 19.3 vs

19 Thence West 312 vs Branch 1187 vs Little

20 Sandy 1222 vs N. end Yellow Bluff 13th 86 vs

21 Branch 1641 vs large Rock on brow of ledge

22 1834 vs branch 1900.8 set 21st M.D. mes. 8th N 37 1/4

28 E 2nd vs mes 4th N 58th W 14.9 vs

24 Thence West 878 vs Branch 1900.8 vs set 22nd

25 M.D. in Sandy valley mes. 10th N 83-12 W 10 vs

26 P.O. 24th S 19 1/2 E 6.9 vs

27 Thence West 295 vs E bank Sandy creek

28 1555 vs W line H. M. Merrell Sur. & E line Sur.

29 385 S P Ry Co. 806 vs N of their corner S cor

30 1900.8 vs set 23rd M.D. P.O. 13th S 53 1/2 W 6.6 vs

31 P.O. N 23-50 W 13.4 vs

33 Thence West 298 vs Branch 336 vs Branch

1 1405^{ms} Road 15'3" ^{ms} E line Sur 384 S P Ry
 2 Co 8036 ^{ms} N of its S.E. cor 19008 ^{ms} seth 24"^{ms}
 3 M.S. in Rocky brake at E base mk double
 4 P.O. 10" N 30-18 E 74 ^{ms} P.O. 13 N 14 74 E 76.6 ^{ms}
 5 Thence west variation 7-38 E) 280 ^{ms} P.O. 18 top
 6 mk 780 ^{ms} W brow mk 1174 ^{ms} across hollow
 7 to E line Robt C Pace Sur 800 ^{ms} N of its S
 8 E cor also S.W. cor Sur 384 S P Ry Co 1389 ^{ms}
 9 W brow mk 1892 ^{ms} Branch 19008 seth 25'^{ms} M.S.
 10 on W bank Ravine mes 10" N 34 W 54 ^{ms} mes
 11 18'8 80-204 30 ^{ms}
 12 Thence west 73 ^{ms} E fork Pean creek
 13 1135 ^{ms} W line Robt C Pace Sur 821 ^{ms} N of
 14 its S.W. cor 19008 ^{ms} seth 26'^{ms} M.S. in prairie
 15 on top mk L.O. 6" N 73 W 45.6 ^{ms} S. 988 68-25'
 16 E 42 ^{ms}
 17 Thence west 1362.2^{ms} W line Sur 386 & E line
 18 461 S P Ry Co 765 ^{ms} N of their com^{ms} S cor 19008
 19 mes seth 27'^{ms} M.S. L.O. 118 46 35 E 28 ^{ms} S.O. 12" N 88 2
 20 W 17.6 ^{ms}
 21 Thence west 52 ^{ms} Cisco & Bear Branch
 22 Road 200 ^{ms} top variation 7-36 E- 993 ^{ms}
 23 Branch Co N 1344 ^{ms} E line Sur 462 S P Ry
 24 Co 760 ^{ms} N of its S.E. cor 1378 ^{ms} Branch Co
 25 N.W. 19008 ^{ms} seth 28'^{ms} M.S. in P.O. timber P.O.
 26 7" S 15 1/2 W 4.4 ^{ms} P.O. 8" N 65 E 9.4 ^{ms}
 27 Thence west 280 ^{ms} drain 370 ^{ms} into channel
 28 branch 737 ^{ms} cross same 1321.4 ^{ms} E line
 29 Sur 463 S P Ry Co 755 ^{ms} N of its S.E. cor 19008
 30 mes seth 29'^{ms} M.S. on L.O. flat L.O. 10" N 53 1/4 W 7.1
 31 mes S.O. 8" S 67-20 E 26.4 ^{ms}
 32 Thence west 127 ^{ms} W brow hill 430 ^{ms} branch

Co. N.W. 1309 and W line SW 463 and E line SW
 464
~~464~~ S.P. Ry Co 750 ver N. of S.W. cor 468 at 1947
 ver to west line of Stephens County X set
 S.W. cor of Stephens and S.E. cor of Shackelford
 on south side of Prairie hollow running
 N 25' W set line for our marked on side
 S.W. Cor SC July 31, 1889 and on W. side S.E. Cor SC
 from which a forked L.C. 20' as N 67 1/2 W 110.6
 ver L.C. 10 N 59-41 W 152.6 ver L.C. 13" N 44-48 W 125.8
 ver L.C. 18" S 8-15 W 186.6 ver S. O. 888 - 8 1/2 C 127.5 ver
 variation ^{an} cor 9-366. Bearings marked X mile
 stone marked "S L SC... M" and number of the
 on north side and N L E C on south side
 Survey completed July 31st 1889
 O. W. Brown, Chain
 J. H. Cole } Carriers

mile

I O. W. Brown Special Surveyor of Stephens
 County Texas do hereby certify that the
 foregoing survey was made by me on
 the ground according to law (completed)
 on the date and with the chain carriers
 of aforesaid duly qualified and that
 the initial corner lines milestones and
 survey connections together with
 marks both natural and artificial
 are truly described and set forth
 in the foregoing Plot and Field notes
 This July 15th 1889
 O. W. Brown
 Special Surveyor of Stephens Co. Texas

The State of Texas }
County of Stephens } J. C. P. Kiuchen
Clerk of the County Court
of Stephens County, Texas, do hereby
certify that the foregoing is a true
and correct copy of the original plats
and field notes of the East and South
Lines of Stephens County, Texas, as
the same appears of Record on the
Commissioners Court Minutes, Vol. C,
pages 103 to 110 inclusive, a Record
kept in and for Stephens County,
Texas.

Given under my hand and
Seal of office, in the town of
Groesbeundge, this the 9th day of
September, A.D. 1889

J. C. P. Kiuchen
Clerk of the County Court
and Ex officio Clerk
County Court
Stephens County, Texas.



Stephens Co Entry Line 2
Stephens County Line
Filed September 14/89

9/14/89

* South
E. B. D. Case of
Stephens Co
Vol. 4 58899

Abstract Completed
Aug. 20th 1891
Beaman

Also South Entry

See 155 S.W. Rep -
Page 1006 -

Stephens Co -
VS
Pale Pointe Co

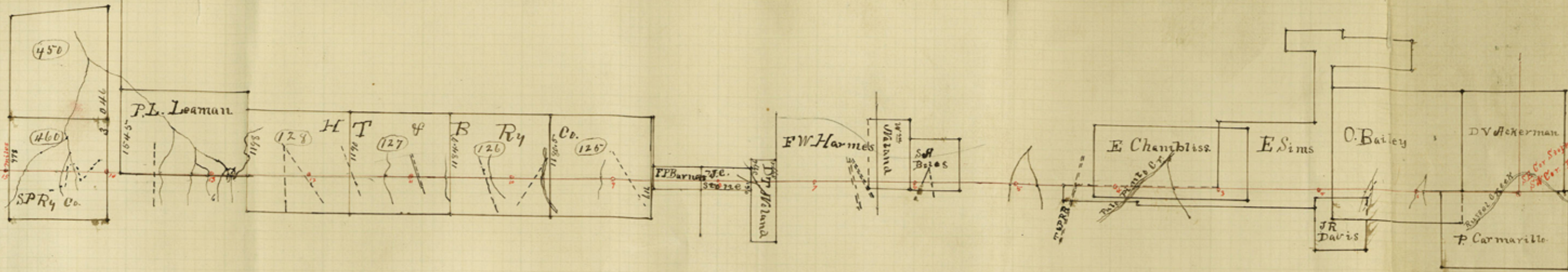

2000 vrs per inch
 Plat of the South line of Stephens Co. as run from the South West Corner
 of Palo Pinto County to a crossing of the West line of Stephens County.

6+