

Stonewall Co Bdry 8 Line 3

Stonewall County.

Rejected, both lines not being
run in accordance with in-
structions. The North line does
not connect to the N.E. corner
of Dickens Co. and the West line
does not connect with a Fisher
Co. milestone — the call for
Fisher Co. line ^{at 30 miles} is erroneous.

C. W. Prussia

2858

Raymer Tex July 18th 1895
New Andrew J. Baker
Austin Tex

Dear Sir

I forward you the plots and field notes to day of the N. & W. boundary of Stonewall County. The Surveyor of King County did not come I done the work alone the N. W. Corner of Haskell Co is about 6440rs North of the South East Corner of Dickens Co or it shows to be so by the survoys I find B.K.F. has been badly surveyed it was located by the needle and I find for 10 miles N and 10 miles West from the beginning of B.K.F. the needle will often vary as much as three degrees in running one mile I run out 1200rs south of South E. corner of Dickens Co but called for the corner in my field notes, but if that distance is too great I will go back and correct it & the Kent Co. surveyor got to South East Corner of Dickens on time but I was water bound and he did not wait for me he run south but as he made no sign cut no brush or anything else I could not accept his line I run the west line of our Co and marked it properly and I am confident you will find it correct. The Kent Co Surveyor run with an open sight Compass and Jacob Staff and of course varied sometimes I would be near his pile of Dirt and at the next one perhaps 300rs apart and his chainmen were careless their work was bad. They found an old fence post 945rs before they reached N. Line of Fisher and set their corner from that &

will you please examine my work and report to me as soon as you can. I cant get my pay until you pass on the work &

Yours very truly
J. J. Hale
Co Sur Stonewall Co

The State of Texas 33 Field Notes of North Boundary line
County of Stonewall 33 Stonewall and South Boundary
33 Line of King Counties

Beginning at N.W. Corner of Haskell and south
West corner of Knox Counties. Two Stones set together
one marked on East side N.W. H.C. Jones 4th 1894 the
other marked $\times \times \times$ on top from which Kiawa Peak bears
S 50° 55' a forked Mesquit bears N 11° E 144 $\frac{4}{10}$ rods

1st Thence west on 1st mile at 1280 rods the E bank of Brazos
River at 1520 rods the west bank of River at 1900 $\frac{8}{10}$ rods a cedar
post 18 inches high marked on South side N.W.S. set in cedar
thicket

2nd Thence W. on 2^d mile at 158 rods a deep branch at 870 rods top
of River bluff at 1900 $\frac{8}{10}$ rods a mesquit post set in open flat
marked on North side K. 11. on south side S. 11. from which
Kiawa Peak bears S. 26 $\frac{0}{2}$. a Mes marked K on south side bears
N. 4. W. 28 rods

3rd Thence west on third mile at 500 rods a branch course
south at 1400 rods a deep canyon at 1560 rods top of west
bank of canyon at 1900 $\frac{8}{10}$ rods a mes post 2 feet high
marked K on N side and S on south side from which
Kiawa Peak bears South 10° west

4th Thence west on 4th mile at 390 rods a branch at 1900 $\frac{8}{10}$
rods a stone 2 feet high marked S. 1111. on South side
and K. 4. on N side said stone is set on west
bank of a deep canyon from which Kiawa Peak
bears S. 10° 30' East

5th Thence west on 5th mile at 200 rods a branch at 1400 rods
a wagon road at 1900 $\frac{8}{10}$ rods a cedar post set on top of
hill marked on South side S. on N side K. from which
Kiawa Peak bears S 28° E a bunch of cedar on East
end of Mountain bears N. 11 $\frac{1}{2}$ E

6th Thence west on 6th mile at 100 rods bottom of canyon at
200 rods top of west bank of canyon at 700 rods a branch at
1900 $\frac{8}{10}$ rods a Mes post marked S. 6. on South side and
K. M. on North side from which a bunch of cedar on top
of Mountain bears N 55 $\frac{1}{2}$ W

Stonewall Co. Bdry Line #3
cont'd 58963

- 7th Thence west on 7th Mile at 300 vs Loston Creek at 460, vs East line of Section 4, Block F, and 725.6 vs North of the N.E. corner BLK. D, and the S.E. corner of BLK. F, H.V.T.C.R.R. at 1370 vs a large stone set on top of Mountain at 1900, $\frac{8}{10}$ vs a cedar post marked S. 7. on South side and K. M. on north side with mound of rock on east side of post
- 8th Thence west on 8th Mile at 400 vs a branch at 450 vs branch at 540 vs a creek at 1000 vs top of hill at 1900, $\frac{8}{10}$ a cedar post marked on S. side S. 8. M. and on N side K. 8. M. from which the East point of a Mountain brs S 19 $\frac{1}{2}$ E. a big rock on N. point of Mountain brs S. 70 E.
- 9th Thence South on 9th Mile at 430 vs a pile of rock on top of Mountain at 800 vs head of ^{deep} canyon course N. at 1000 vs a deep canyon at 1900, $\frac{8}{10}$ vs a cedar post in stone mound marked S. 9. M. on south side and K. 9. M. on North side
- 10th Thence west on 10th mile at 300 vs a deep canyon at 950 vs deep canyon at 1900, $\frac{8}{10}$ vs a stone mound on west side of branch with large flat stone marked S. 10. M. on South side
- 11th Thence west on 11th mile at 470 vs a deep canyon at 1900, $\frac{8}{10}$ vs a large flat rock in stone mound marked S. 11. M. on south side from which a bunch of Hackberry brs N. 13 $\frac{1}{2}$ E. the N point of a long Mountain brs N 53. W.
- 12th Thence west on 12th mile at 1220 vs crosses a creek at 1900, $\frac{8}{10}$ vs a stone 6 inches wide and 24 inches high marked S. 12. M. on south side and K. 12. M. on N side from which a hackberry brs S 19 $\frac{1}{2}$ E. 54 vs
- 13th Thence west on 13th mile at 150 vs top of hill at 1430 vs wagon road at 1500 vs branch at 1900, $\frac{8}{10}$ vs a set stone marked S. 13. M. on south side from which a Hackberry brs North 40 $\frac{1}{2}$ W. 2 vs ditto brs S 88. W. 8 $\frac{2}{3}$ vs
- 14th Thence W. on 14th mile at 1900, $\frac{8}{10}$ vs a Mes post marked S. 14. M. on South side and K. 14. M. on North side

- 15th Thence west on 15th mile at 2300^{rs} Rayner and Guthrie Road at 1400^{rs} was a large flat stone set in stone mound marked S. 15, M on south side and K. 15, M on north side
- 16 Thence W on 16th mile at 1400^{rs} was a Mes post 3 feet high marked S. 16, M on South side and K. 16, M on north side from which the East point of Double Mountain brs S. 21^o W
- 17 Thence W on 17th mile at 1400^{rs} was a Mes post marked S. 17, M on south side and K. 17, M on North side from which the East point of Double Mountain brs S. 18³/₄ W.
- 18th Thence W on 18th mile at 900^{rs} was a canyon at 1120^{rs} branch at 1400^{rs} was a Mes post marked S. 18, M on south side and K. 18, M on North side set on west side of a branch
- 19th Thence W on 19th mile at 1850^{rs} was a deep gip canyon at 1900^{rs} was a cedar post set on west bank of canyon marked S. 19, M on south side and K. 19, M on N side
- 20th Thence West on 20th mile at 475^{rs} was a deep canyon at 740^{rs} a creek at 1400^{rs} was a cedar post marked S. 20, M on South side and K. 20, M. on N. side set at the foot of a high bluff
- 21st Thence W on 21st mile at 1750^{rs} was a branch at 1900^{rs} was a Mes post set in head of small canyon course south post marked S. 21, M on South side and K. 21, M on N side
- 22 Thence West on 22nd mile at 875^{rs} was a branch at 1900^{rs} was a Mes post set in open prairie marked S. 22, M on south side and K. 22, M on N side
- 23rd Thence West on 23rd mile at 1060^{rs} crosses N. salt croton Creek at 1400^{rs} was a Mes post set on East bank of creek post marked S. 23, M. on South side from which a cedar 5 in dia marked S. C. L. brs S. 7. W. 14^{rs}
- 24th Thence W on 24th mile at 900^{rs} channel of creek at 1070^{rs} top of Bluff at 1400^{rs} was a Mes post set in Mound of Gip Rock on East side of high bluff post marked S. 24, M. on south side and K. 24, M on north side

- 25th Thence west on 25th mile at 400 ^{rs} cross Croton Creek again at 1900^{rs} ^{rs} a Mes post set on an Island in salt Croton creek from which a Mound in salt Marsh brs S 8¹/₂ E post marked S 25 N on south side
- 26th Thence west on 26th mile at 130 ^{rs} point of hill at 400 ^{rs} head of a canyon North of salt Marsh at 1900^{rs} ^{rs} a Mes post on N slope of hill marked S 26 N on South side and K 26 N on N side from which a gip rock on N side of a red Peak brs S 45 W
- 27th Thence west on 27th mile at 400 ^{rs} bed of creek at 1750 ^{rs} high bluff at 1900^{rs} ^{rs} a Mes post in prairie marked S 27 N on south side and K 27 N on North side from which a small red Peak brs N 34¹/₂ W a bunch of cedar on point of mountain brs N 51¹/₂ W
- 28th Thence west on 28th mile at 1900^{rs} ^{rs} a Mes post marked S 28 N on south side from which the W point of Double Mountain brs S 4 E
- 29th Thence west on 29th mile at 1900^{rs} ^{rs} a mes post set in prairie marked S 29 N on South side and K 29 N on North side
- 30 Thence west on 30th mile at 1900 ^{rs} the south East corner of Dickers and the N. E corner of Kent Counties

State of Texas
 County of Stonewall } J. J. Hale County surveyor
 in and for said county do hereby
 certify that the above and foregoing field notes are correct
 and true as made by actual survey on the ground beginning
 on the 24 day of June 1895 and closing on the 1st day of
 July 1895 with W. G. Motter and Oland Carr as chain carriers
 and I further certify that I had taken the oath and
 had given Bond. and that said Bond had been
 accepted and approved as required by Law and that
 the Court had given legal notice to all the Commissioners
 Courts of the Counties interested and that all the mile
 posts are truly described and all marks both natural

Stonewall Co. Bdsy. Vol. #3

and artificial are truly and correctly described &
Given under my hand this the 9. day of July 1895-

J. J. Hall
Co Surveyor Stonewall Co Texas

Stonewall Co 3 Bdry Line 3

Fieldnotes

of the

Northline of Stonewall Co.

filed in the Land and Office
July 15th 1895.

H. J. [Signature]

See memorandum for objections

July 27/91 E. W. Prusher

#400

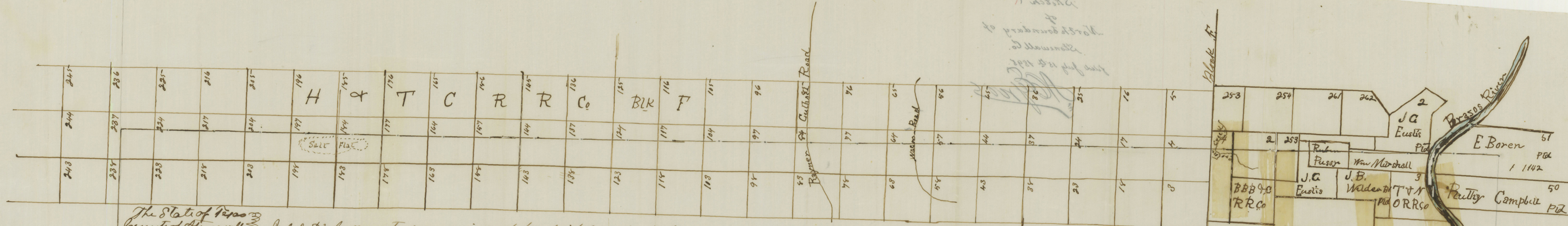

The State of Texas
 County of Stonewall
 J. J. Hale County surveyor in and for said County do hereby certify that the above plot is a true and correct sketch of the A. B. L. of Stonewall County as established by me by a survey on the ground beginning at the N.W. corner of Haskell County on the 24th day of June 1895 and closing on S.E. corner of Dickens County on the 1st day of July 1895 with W. G. Weston and Bland Carr as chainmen
 Given under my hand and official signature on this the
 9th day of July 1895
 J. J. Hale
 Co Surveyor Stonewall
 Co Tex

Stonewall Co Bdry 4 Line 3
Sketch

of
North boundary of
Stonewall Co.
Filed July 13th 1895



121	122	123	124	125	126	127	128	129	130	131	132	133	134	135	136	137	138	139	140	141	142	143	144	145	146	147	148	149	150	151	152	153	154	155	156	157	158	159	160	161	162	163	164	165	166	167	168	169	170	171	172	173	174	175	176	177	178	179	180	181	182	183	184	185	186	187	188	189	190	191	192	193	194	195	196	197	198	199	200	201	202	203	204	205	206	207	208	209	210	211	212	213	214	215	216	217	218	219	220	221	222	223	224	225	226	227	228	229	230	231	232	233	234	235	236	237	238	239	240	241	242	243	244	245	246	247	248	249	250	251	252	253	254	255	256	257	258	259	260	261	262	263	264	265	266	267	268	269	270	271	272	273	274	275	276	277	278	279	280	281	282	283	284	285	286	287	288	289	290	291	292	293	294	295	296	297	298	299	300	301	302	303	304	305	306	307	308	309	310	311	312	313	314	315	316	317	318	319	320	321	322	323	324	325	326	327	328	329	330	331	332	333	334	335	336	337	338	339	340	341	342	343	344	345	346	347	348	349	350	351	352	353	354	355	356	357	358	359	360	361	362	363	364	365	366	367	368	369	370	371	372	373	374	375	376	377	378	379	380	381	382	383	384	385	386	387	388	389	390	391	392	393	394	395	396	397	398	399	400	401	402	403	404	405	406	407	408	409	410	411	412	413	414	415	416	417	418	419	420	421	422	423	424	425	426	427	428	429	430	431	432	433	434	435	436	437	438	439	440	441	442	443	444	445	446	447	448	449	450	451	452	453	454	455	456	457	458	459	460	461	462	463	464	465	466	467	468	469	470	471	472	473	474	475	476	477	478	479	480	481	482	483	484	485	486	487	488	489	490	491	492	493	494	495	496	497	498	499	500	501	502	503	504	505	506	507	508	509	510	511	512	513	514	515	516	517	518	519	520	521	522	523	524	525	526	527	528	529	530	531	532	533	534	535	536	537	538	539	540	541	542	543	544	545	546	547	548	549	550	551	552	553	554	555	556	557	558	559	560	561	562	563	564	565	566	567	568	569	570	571	572	573	574	575	576	577	578	579	580	581	582	583	584	585	586	587	588	589	590	591	592	593	594	595	596	597	598	599	600	601	602	603	604	605	606	607	608	609	610	611	612	613	614	615	616	617	618	619	620	621	622	623	624	625	626	627	628	629	630	631	632	633	634	635	636	637	638	639	640	641	642	643	644	645	646	647	648	649	650	651	652	653	654	655	656	657	658	659	660	661	662	663	664	665	666	667	668	669	670	671	672	673	674	675	676	677	678	679	680	681	682	683	684	685	686	687	688	689	690	691	692	693	694	695	696	697	698	699	700	701	702	703	704	705	706	707	708	709	710	711	712	713	714	715	716	717	718	719	720	721	722	723	724	725	726	727	728	729	730	731	732	733	734	735	736	737	738	739	740	741	742	743	744	745	746	747	748	749	750	751	752	753	754	755	756	757	758	759	760	761	762	763	764	765	766	767	768	769	770	771	772	773	774	775	776	777	778	779	780	781	782	783	784	785	786	787	788	789	790	791	792	793	794	795	796	797	798	799	800	801	802	803	804	805	806	807	808	809	810	811	812	813	814	815	816	817	818	819	820	821	822	823	824	825	826	827	828	829	830	831	832	833	834	835	836	837	838	839	840	841	842	843	844	845	846	847	848	849	850	851	852	853	854	855	856	857	858	859	860	861	862	863	864	865	866	867	868	869	870	871	872	873	874	875	876	877	878	879	880	881	882	883	884	885	886	887	888	889	890	891	892	893	894	895	896	897	898	899	900	901	902	903	904	905	906	907	908	909	910	911	912	913	914	915	916	917	918	919	920	921	922	923	924	925	926	927	928	929	930	931	932	933	934	935	936	937	938	939	940	941	942	943	944	945	946	947	948	949	950	951	952	953	954	955	956	957	958	959	960	961	962	963	964	965	966	967	968	969	970	971	972	973	974	975	976	977	978	979	980	981	982	983	984	985	986	987	988	989	990	991	992	993	994	995	996	997	998	999	1000	1001	1002	1003	1004	1005	1006	1007	1008	1009	1010	1011	1012	1013	1014	1015	1016	1017	1018	1019	1020	1021	1022	1023	1024	1025	1026	1027	1028	1029	1030	1031	1032	1033	1034	1035	1036	1037	1038	1039	1040	1041	1042	1043	1044	1045	1046	1047	1048	1049	1050	1051	1052	1053	1054	1055	1056	1057	1058	1059	1060	1061	1062	1063	1064	1065	1066	1067	1068	1069	1070	1071	1072	1073	1074	1075	1076	1077	1078	1079	1080	1081	1082	1083	1084	1085	1086	1087	1088	1089	1090	1091	1092	1093	1094	1095	1096	1097	1098	1099	1100	1101	1102	1103	1104	1105	1106	1107	1108	1109	1110	1111	1112	1113	1114	1115	1116	1117	1118	1119	1120	1121	1122	1123	1124	1125	1126	1127	1128	1129	1130	1131	1132	1133	1134	1135	1136	1137	1138	1139	1140	1141	1142	1143	1144	1145	1146	1147	1148	1149	1150	1151	1152	1153	1154	1155	1156	1157	1158	1159	1160	1161	1162	1163	1164	1165	1166	1167	1168	1169	1170	1171	1172	1173	1174	1175	1176	1177	1178	1179	1180	1181	1182	1183	1184	1185	1186	1187	1188	1189	1190	1191	1192	1193	1194	1195	1196	1197	1198	1199	1200
-----	-----	-----	-----	-----	-----	-----	-----	-----	-----	-----	-----	-----	-----	-----	-----	-----	-----	-----	-----	-----	-----	-----	-----	-----	-----	-----	-----	-----	-----	-----	-----	-----	-----	-----	-----	-----	-----	-----	-----	-----	-----	-----	-----	-----	-----	-----	-----	-----	-----	-----	-----	-----	-----	-----	-----	-----	-----	-----	-----	-----	-----	-----	-----	-----	-----	-----	-----	-----	-----	-----	-----	-----	-----	-----	-----	-----	-----	-----	-----	-----	-----	-----	-----	-----	-----	-----	-----	-----	-----	-----	-----	-----	-----	-----	-----	-----	-----	-----	-----	-----	-----	-----	-----	-----	-----	-----	-----	-----	-----	-----	-----	-----	-----	-----	-----	-----	-----	-----	-----	-----	-----	-----	-----	-----	-----	-----	-----	-----	-----	-----	-----	-----	-----	-----	-----	-----	-----	-----	-----	-----	-----	-----	-----	-----	-----	-----	-----	-----	-----	-----	-----	-----	-----	-----	-----	-----	-----	-----	-----	-----	-----	-----	-----	-----	-----	-----	-----	-----	-----	-----	-----	-----	-----	-----	-----	-----	-----	-----	-----	-----	-----	-----	-----	-----	-----	-----	-----	-----	-----	-----	-----	-----	-----	-----	-----	-----	-----	-----	-----	-----	-----	-----	-----	-----	-----	-----	-----	-----	-----	-----	-----	-----	-----	-----	-----	-----	-----	-----	-----	-----	-----	-----	-----	-----	-----	-----	-----	-----	-----	-----	-----	-----	-----	-----	-----	-----	-----	-----	-----	-----	-----	-----	-----	-----	-----	-----	-----	-----	-----	-----	-----	-----	-----	-----	-----	-----	-----	-----	-----	-----	-----	-----	-----	-----	-----	-----	-----	-----	-----	-----	-----	-----	-----	-----	-----	-----	-----	-----	-----	-----	-----	-----	-----	-----	-----	-----	-----	-----	-----	-----	-----	-----	-----	-----	-----	-----	-----	-----	-----	-----	-----	-----	-----	-----	-----	-----	-----	-----	-----	-----	-----	-----	-----	-----	-----	-----	-----	-----	-----	-----	-----	-----	-----	-----	-----	-----	-----	-----	-----	-----	-----	-----	-----	-----	-----	-----	-----	-----	-----	-----	-----	-----	-----	-----	-----	-----	-----	-----	-----	-----	-----	-----	-----	-----	-----	-----	-----	-----	-----	-----	-----	-----	-----	-----	-----	-----	-----	-----	-----	-----	-----	-----	-----	-----	-----	-----	-----	-----	-----	-----	-----	-----	-----	-----	-----	-----	-----	-----	-----	-----	-----	-----	-----	-----	-----	-----	-----	-----	-----	-----	-----	-----	-----	-----	-----	-----	-----	-----	-----	-----	-----	-----	-----	-----	-----	-----	-----	-----	-----	-----	-----	-----	-----	-----	-----	-----	-----	-----	-----	-----	-----	-----	-----	-----	-----	-----	-----	-----	-----	-----	-----	-----	-----	-----	-----	-----	-----	-----	-----	-----	-----	-----	-----	-----	-----	-----	-----	-----	-----	-----	-----	-----	-----	-----	-----	-----	-----	-----	-----	-----	-----	-----	-----	-----	-----	-----	-----	-----	-----	-----	-----	-----	-----	-----	-----	-----	-----	-----	-----	-----	-----	-----	-----	-----	-----	-----	-----	-----	-----	-----	-----	-----	-----	-----	-----	-----	-----	-----	-----	-----	-----	-----	-----	-----	-----	-----	-----	-----	-----	-----	-----	-----	-----	-----	-----	-----	-----	-----	-----	-----	-----	-----	-----	-----	-----	-----	-----	-----	-----	-----	-----	-----	-----	-----	-----	-----	-----	-----	-----	-----	-----	-----	-----	-----	-----	-----	-----	-----	-----	-----	-----	-----	-----	-----	-----	-----	-----	-----	-----	-----	-----	-----	-----	-----	-----	-----	-----	-----	-----	-----	-----	-----	-----	-----	-----	-----	-----	-----	-----	-----	-----	-----	-----	-----	-----	-----	-----	-----	-----	-----	-----	-----	-----	-----	-----	-----	-----	-----	-----	-----	-----	-----	-----	-----	-----	-----	-----	-----	-----	-----	-----	-----	-----	-----	-----	-----	-----	-----	-----	-----	-----	-----	-----	-----	-----	-----	-----	-----	-----	-----	-----	-----	-----	-----	-----	-----	-----	-----	-----	-----	-----	-----	-----	-----	-----	-----	-----	-----	-----	-----	-----	-----	-----	-----	-----	-----	-----	-----	-----	-----	-----	-----	-----	-----	-----	-----	-----	-----	-----	-----	-----	-----	-----	-----	-----	-----	-----	-----	-----	-----	-----	-----	-----	-----	-----	-----	-----	-----	-----	-----	-----	-----	-----	-----	-----	-----	-----	-----	-----	-----	-----	-----	-----	-----	-----	-----	-----	-----	-----	-----	-----	-----	-----	-----	-----	-----	-----	-----	-----	-----	-----	-----	-----	-----	-----	-----	-----	-----	-----	-----	-----	-----	-----	-----	-----	-----	-----	-----	-----	-----	-----	-----	-----	-----	-----	-----	-----	-----	-----	-----	-----	-----	-----	-----	-----	-----	-----	-----	-----	-----	-----	-----	-----	-----	-----	-----	-----	-----	-----	-----	-----	-----	-----	-----	-----	-----	-----	-----	-----	-----	-----	-----	-----	-----	-----	-----	-----	-----	-----	-----	-----	-----	-----	-----	-----	-----	-----	-----	-----	-----	-----	-----	-----	-----	-----	-----	-----	-----	-----	-----	-----	-----	-----	-----	-----	-----	-----	-----	-----	-----	-----	-----	-----	-----	-----	-----	-----	-----	-----	-----	-----	-----	-----	-----	-----	-----	-----	-----	-----	-----	-----	-----	-----	-----	-----	-----	-----	-----	-----	-----	-----	-----	-----	-----	-----	-----	-----	-----	-----	-----	-----	-----	-----	-----	-----	-----	-----	-----	------	------	------	------	------	------	------	------	------	------	------	------	------	------	------	------	------	------	------	------	------	------	------	------	------	------	------	------	------	------	------	------	------	------	------	------	------	------	------	------	------	------	------	------	------	------	------	------	------	------	------	------	------	------	------	------	------	------	------	------	------	------	------	------	------	------	------	------	------	------	------	------	------	------	------	------	------	------	------	------	------	------	------	------	------	------	------	------	------	------	------	------	------	------	------	------	------	------	------	------	------	------	------	------	------	------	------	------	------	------	------	------	------	------	------	------	------	------	------	------	------	------	------	------	------	------	------	------	------	------	------	------	------	------	------	------	------	------	------	------	------	------	------	------	------	------	------	------	------	------	------	------	------	------	------	------	------	------	------	------	------	------	------	------	------	------	------	------	------	------	------	------	------	------	------	------	------	------	------	------	------	------	------	------	------	------	------	------	------	------	------	------	------	------	------	------	------	------	------	------	------

of Genl 1895 and closing on S. E. corner of Section 36 on the N. E. corner of Section 35 of Town 15 N. Range 13 W. 1st P.M.
of Genl 1895 and closing on S. E. corner of Section 36 on the N. E. corner of Section 35 of Town 15 N. Range 13 W. 1st P.M.
The lot of 1200 sq ft of land in the N. E. corner of Section 36 of Town 15 N. Range 13 W. 1st P.M. was originally owned by J. J. Hobbins and was conveyed to the present owner by deed of J. J. Hobbins to J. J. Hobbins and J. J. Hobbins dated the 1st day of July 1895.

of Genl 1895 and closing on S. E. corner of Section 36 on the N. E. corner of Section 35 of Town 15 N. Range 13 W. 1st P.M.
of Genl 1895 and closing on S. E. corner of Section 36 on the N. E. corner of Section 35 of Town 15 N. Range 13 W. 1st P.M.