

Swisher-Geo

E & S. bdy Lines.

Filed Aug 20/92

G. N. Beaumont
Chief Clerk

Examined and approved.

Sept 6th 1892

G. N. Beaumont

Abstract corrected

May 16th 1893

G. N. Beaumont

Land District 15-

Sept 6th 1892

11/15/92 recognizes

as an separate

Land District

15-

The State of Texas
County of Swisher

Field notes

of The East and South Bound-
dary lines of Swisher County

Beginning at
an Earth Mid and circular
Trench 11 ft in diameter set for
N.W. Corner Bruscoe County
and N.E. corner of Swisher Co
in South B.L. of Armstrong Co
from which a stone marked (N.W.)
B.

(NE) (A) set in Earth mid an
~~exact~~ circular trench 15 ft diam,
4 ft High bears N. 53° W. 78 varas

1 Thence South at 1832 a point 526
var East from S.W. Cor Survey No.
57 Blk M. 10 B.S. + F. Swisher Co.

1853 varas Earth mound + 2 pits

2 Thence South at 1893 var point 526
var east of S.W. 72 Same Block
1900 varas stone marked S.B. II

3 Thence South 1900 to stone set in
Em'd and 2 pits marked B.S. III

4th mile Thence South at 1900 varas
Stone marked S.B. IV.

5th mile Thence South at 23^{varas} a point 526
var East of the S.W. Corner
of Section 96 Same Block

and 210 var East of N.W. Cor Sur
137 Same Blk at 1224 point

in its S.B.L. 210 var E of S.W. Cor.
at 1520 lake over

1900 var to a ^{stone} marked B. S. V.

6th Thence South at 75 var pass out of Basin
At 114 Cross N Line of League No 3
S. J. C. S. L. 1593 ^{varas} E of its N. W. Cor.
At 1320 varas point in E. Edge of Basin
1900 var to Stone marked B. S. VI.

7th mile Thence South 975 enter Basin 1571
pass out, 1900 var Stone set in and
earth mound.

8th mile Thence South at 1314 varas a point in
South line of Said League 1591 varas
East of its South West corner and
1791 varas East of the N. W. Corner
Survey No 29 Block B 3. B. S. + F.
Swisher Co. 1900 varas to Stone set
in Earth mound + 2 pits.

9th mile Thence South at 1315 varas Cross
N line of Sur. 30 same Block 1900 var
to a stone marked IX B. S. Earth mound 2 pits

10th mile Thence South 1900 var to an Earth
mound and 2 pits

11th mile Thence South 1900 varas to a
Stone marked XI B. S. set in Earth
mound + 2 pits

12th mile Thence South 1900 varas
to an Earth mound and 2 pits

13th mile Thence South at 1802 varas point
in a deep white gulch, 1900 varas
a stone in a stone mound one marked
XIII

14th mile Thence South 1640 varas point
in Canon 1900 varas stone in

gr

- 1 Stone mound marked XIV B.S.
 2 between the head of two gulches
 15th mile Thence South at 1380 varas
 4 point in The Tule Cañon 1900
 5 point.
- 16 mile Thence South at 190 varas a gulch
 7 at 480 varas an Earth mound + 2
 8 pits capped with small flat stone
 9 from which a Cedar in head of a
 10 break bears S 78° E 38 varas At
 11 1900 varas a gas pipe 1" x 2 1/2"
 12 marked XVI B.S.
- 17th mile Thence South at 1295 varas point
 14 in raw course N.E. at 1318 1/2 var
 15 a point 1784 var East of the S.W.
 16 Corner No 75 Block No A. Arnold
 17 & Barrett 1900 varas to an
 18 Earth mound and 2 pits
- 18th mile Thence South at 1319 1/2 varas at a
 20 point 1783 East of the S.W. corner
 21 of Survey No 64 Block same as above
 22 1900 varas to a pipe marked B.S.
 23 18 set in E. end + 2 pits
- 19th mile Thence South at 1900 varas
 25 to an Earth mound + 2 pits
- 20th mile Thence South at 1900 varas
 27 set Gas pipe in earth mound
 28 and 2 pits marked 20 B.S.
- 21st mile Thence South at 1321 varas
 30 to a point 1780 varas East of
 31 the Common ^{N.W.} Cor. of Survey No
 32 58 Block A A. + B. and the the

1 S.W. Corner of Survey No 217 in
 2 Block G.M. D^{ny} S.E. RR Co in
 3 Briscoe + Swisher Counties, 1900 varas
 4 to an Earth mound and 2 pits
 2 2nd mile Thence South at 1245 enter
 6 Basin at 1400 pass out of same
 7 1900 varas pipe marked 22 B.S.
 2 3rd mile Thence South 1900 varas to an
 9 Earth mound and 2 pits
 2 4th mile Thence South at 460 enter basin
 11 and at 680 varas pass out
 12 at 900 varas a point in Rock
 13 Draw. 1900 varas ^{pipe} marked
 14 B.S. 24 set in Earth mound 2 pits
 2 5th mile Thence South at 40 varas
 16 the North Edge of Basin at 1120
 17 varas pass out at 1400 varas
 18 set Earth mound and two
 19 pits
 2 6th mile Thence South at 1720 varas
 21 the North Edge of Basin at
 2 2100 varas set Pipe marked 26
 2 7th mile B.S. at 3800 varas set End and
 24 2 pits
 2 8th mile Thence South at 1900 varas
 26 set Gas pipe marked 28 S.B.
 27 in an Earth Pit + 2 pits
 2 9th mile Thence South at 1900 varas
 29 set Earth mound and 2 pits
 3 0th mile Thence South 2015 varas
 31 the South East cor
 32 of Swisher County and the

94

3

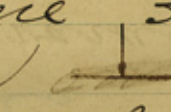
South West corner of Briscoe
County. Set in the North line
of Floyd County. A Stone 33"
x 9" x 4" marked thus 
on Top; Marke F on South Edge
(S.) on west face; (B.) on East face
(S.E.) in trench 12" diameter & mound
3" high.

1st
mill
Thence West ^{at 40 varas pass mound 12 ft dia. 3 ft high,} at 761 varas pass
an Earth mound and 2 pits. At 1771
varas a point 690 var South
from the N.W. Cor No. 33 Block B4
in Swisher County. At 1940 varas
an Earth mound and 2 pits.

2nd
mill
Thence West at 721 varas an Earth mound
and 2 pits at 1175 varas point 98 var
North of the S.W. Cor Survey No 2 S.P.R.R. Co.
At 1900 varas a Gas pipe marked
S. 2. N. F.

3rd
mile
Thence West at 721 varas an Earth mound
and 2 pits, At 1900 varas an
Earth mound and 3 pits

4th
mile
Thence West at 721 var an
Earth mound and 2 pits 1900
varas a pipe marked S.H.M.F.
and 3 pits

5th
mill
Thence West at 721 varas an
Earth mound and 2 pits at 1040
var enter Basin 1560 var pass out
1900 var gas pipe marked S. 5.
M.S.F. in Earth mound and 3 pits

6th
mill
Thence West at 721 ~~var~~
over

95

1 A stone $2\frac{1}{2} \times 1' \times \frac{1}{2}$ marked
 2 on the top S. on the North
 3 Edge ($\begin{matrix} N \\ F \end{matrix} \begin{matrix} W \\ E \end{matrix}$) East face and
 4 N. E. on the west face. set
 5 in ^H the South line of Swisher
 6 County for N.W. corner of
 7 Floyd and the N.E. corner of
 8 Hale County set in Earth
 9 mound & trench 10ft dia. 3ft
 10 High, at 1900 varas an
 11 Earth mound and 3 pits.

4th 12 Thence West at 721 var an Earth
 13 mound & 2 pits 1st mile Hale Co.
 14 1900 a pipe $1\frac{1}{2} \times 2\frac{1}{2}$ marked
 15 7. A. S. And 3 pits 4th mile Post

8th 16 Thence West at 721 varas a
 17 gas pipe marked N. 2 H. S
 18 Second mile post Hale Co.

19 At 1900 varas Earth mound
 20 an 3 pits the 8 mile Swisher Co

9th 21 Thence West at 721 varas an
 22 Earth mound and 2 pits 3rd
 23 Hale Co mile post. 1900
 24 varas an Iron gas pipe
 25 marked 9. S. M. H. the 9th
 26 Swisher Co mile.

10th 27 Thence West at 721 var an
 28 Earth mound and 2 pits
 29 the 4th mile Hale Co
 30 at 1740 var a point 605 varas
 31 South of the N.W. corner Sect 30
 32 Block T₆ 14 Swisher County

26

At 1900 varas marked ^{pipe} S 10
M. the 10th mile post for
Swisher County.

11th Thence west at 721 the E. end
mile and 2 pits 5th mile Post for
Hale County. 1900 varas
Earth mound and 3 pits
11th mile for Swisher County

12th Thence west at 721 varas E. end
mile and 2 pits ^{pipe marked S.H.G. for} 6th mile for
Hale Co 1900 var ^{set} gas pipe
in E. end & 3 pits marked 12
S.M. H. the 12 mile post
Swisher Co

13th Thence west at 721 varas
mile to Earth mound & 2 pits the 7th
mile post Hale Co. 1900 varas
on Earth mound & 3 pits the
13th mile Swisher Co.

14th Thence west at 721 varas an
mile Earth mound and two pits the
8th mile Hale County At
1740 ^{varas} a point 570 varas South
of the N.W. corner of Section 55
M 14 1900 varas pipe set in
Earth mound & 3 pits & marked
14 M H.S. the 14 mile post
Swisher County

15th Thence West at 721 var Earth end
mile & 2 pits the 9th mile for Hale Co.
which is 1659 var South from
the S.E. corner of Survey No 61

B&M 13 E.L. & R.R. R.R. Co Swisher
Co. 59082

1900 varas an End and 3 pits, the 15th mile for Swisher Co

16th mile Thence West at 721 varas Pipe set in Earth mound + 2 pits the 10th Hale Swisher mile post marked H. 10. N. S., 1900 varas a Black gas pipe marked 16. N. S. H. the 16th mile Swisher Co.

17th mile Thence West at 721 varas an Earth mound and 2 pits - the 11th Hale Co mile 1900 varas Earth mound and 3 pits the 17th Swisher mile post

18th mile Thence West at 721 varas E. end and 2 pits The 12th Hale Co mile 1900 varas gas pipe marked S. 18. N. H. in Earth mound + 2 pits

19th mile Thence West at 721 varas Earth mound and 2 pits The 13th Hale Co mile post, 1900 varas an Earth mound and 3 pits the 19th Hale Swisher mile

20th mile Thence West at 721 pipe set in E. end. + 2 pits marked 14 N. H. S. The 14 Hale Co mile at 871 varas a point 1615 varas South of NW cor Survey 66 Blk M. 13- Swisher Co. at 1465 varas Enter basin at 1900 varas set pipe # marked 20 S. N. H. the 20th mile post Swisher Co in Earth mound and 3 pits

28

21st Thence West at 160 varas ~~pass~~ out
Mill of Basin at 721 varas an Earth
mound and two pits the 15th
mile for Hall Co 1400 varas
an earth mound and 3 pits the
21st Swisher mile point

22nd Thence West at 721 varas an
mill Earth mound and 2 pits the
16th Hall mile 1325^{var} enter
and 1840 varas pass out of
Basin 1900 varas pipe marked
22 N.S. H the in End and
3 pits the 22nd Swisher mile
Post

23rd Thence West at 721 varas an
mill Earth mound and 2 pits the 17th
mile for Hall Co 1900 varas
an Earth mound and 3 pits the 23
mile for Swisher Co

24th Thence West at 721 varas an
Mill pipe in End & 2 pits marked
18. H. N.S. the 18 mile Hall Co.
at 890 varas a point 1623 varas
South of the N.W. cor Survey
No 7 Block C 4 L & S.V. RR Co Swisher
County also at 890 varas Badger draw (South)
at 1298 varas a point
206 varas South of the N.E. Corner of
Survey No 52 Block # K. 1900 varas
Black pipe in End & 3 pits
marked 24 N.S. H the 24 Swisher
mile Post.

25th Thence West at 721 varas
mile

- 25th mile Earth mound and 2 pits the 19th Hale mile post 1900 varas an Earth mound and 3 pits the 25th mile for Swisher Co.
- 26th mile Thence West at 721 varas an Earth mound and 2 pits the 20th mile for Hale co at 1900 var a black gas pipe marked S 26 M H in End & 3 pits. the 26th Swisher mile
- 27th mile Thence West at 721 Earth mound and 2 pits the 21st Hale co mile at 1900 var set Earth mound and three pits the 27th mile post for Swisher Co.
- 28th mile Thence West at 721 varas set pipe in Earth mound & 2 pits marked 22 H.M.S. The 22 Hale mile. At 1900 varas pipe set in Earth mound and 3 pits marked 28 M.S. H 28th mile post for Swisher Co
- 29th mile Thence west at 721 varas Earth mound and 2 pits the 23 mile for Hale co at 1900 varas an Earth mound and 3 pits the 29th Swisher mile post
- 30th mile Thence west at 721 varas Earth mound and 2 pits the 24th mile for Hale

30th County at 1299 varas a point
mile 230 varas 3d N.W. cor Survey
No 3 Block K.3. 2106 varas

A cedar post marked $\begin{matrix} S.E. \\ (C.C.) \end{matrix}$ $\begin{matrix} (H) \\ (L) \end{matrix}$ $\begin{matrix} (S.W.) \\ (S) \end{matrix}$
Set in an earth mound +
and trench 12ft diameter
mound 3ft high set for
the S.W. cor of Swisher County
and the S.E. Corner of Castro
County & in the North
boundary line of Hall Co.
from which a stone marked
(S.E.) on west face $\begin{matrix} (S.W.) \\ (S) \end{matrix}$ on the East
face $\begin{matrix} (H) \\ (L) \end{matrix}$ on South Edge bears West
114 varas.

Survey Beginning on the 6th
day of June and continuing
until the 25th day of July 25th
A. D. 1892.

Magnetic variation at different
points vary from $N 10^{\circ} 35' W.$ to
 $N 10^{\circ} 50' W$

Joe L. Cantrell Chain
M. G. Bryant E. Men.
O. D. Stallings

J. T. Crews Surveyor duly appointed
and qualified by the Commission-
ers courts of Briscoe Hall Floyd
and Swisher Counties to locate
mark + survey the boundaries
of the counties aforesaid do
hereby certify that the foregoing

Survey as shown by ^{field} notes attached
 hereto was actually made on the ground
 according to law on the dates & with
 the Chain carriers aforesaid duly
 sworn and that all the corner
 lines & Boundaries and marks of
 the same whether natural or artificial
 are truly set forth in the fore go-
 ing plat & ^{field} notes

In Testimony whereof
 witness my hand at Gulia
 Texas this the 25th day of July A.D.
 1892. J. L. Crews. Surveyor

I W. B. Hutchison Surveyor duly
 appointed to locate the Survey
 lines ~~and~~ and show their
 relative position to the County
 Boundary lines as above described
 for Swisher County do hereby
 certify that all calls for course
 and distance ^{from Survey} in ^{the} ^{above} notes
 for points in County boundary
 from section corners are
 true and correct and as shown
 on accompanying map.

In Testimony whereof witness
 my hand at Gulia Texas this
 25th day of July A. D. 1892
 W. B. Hutchison
 Surveyor Swisher County
 State of Texas

6
Order No

8 It appearing to the
9 Court that the map and
10 field notes of the South and
11 East Boundary lines of
12 Swisher County by T. L. Crews
13 and N. B. Stuchison surveyors
14 appointed to locate the said
15 lines being presented in
16 the Court were examined
17 and found correct and approve

18
Order No.

20 It is hereby ordered that
21 the Field notes and maps
22 of the South and East lines
23 of Swisher County be filed
24 in the records of the County
25 Clerks office and that a
26 copy forwarded to the Comr-
27 of the Gen. Land Office

The State of Texas
County of Swisher

I T. L. Crows
surveyor duly appointed and
qualified by the County Judges
of Briscoe Hall Floyd and Swisher
Counties to locate their County
Boundary lines, each County
Judge acting under instructions
from his Court; did
on the 8th day of June proceed
to locate the same in the following
manner

At the S.W. Corner
of Hall County I established a
true meridian line from this
meridian so established I laid
off an angle of 90° to the west for
a perpendicular to the meridian at
that point, from this point
I produced this perpendicular
line to the west ward making
necessary deflections for the
curvature of the Earth and by so
doing located a true parallel
of Latitude and marked same for the
Boundary lines between Floyd,
Briscoe, Hall, & Swisher, Counties
I also located a true meridian between
the Briscoe and Swisher Counties
between Floyd and Hall Counties
and between Hall & Lamb
Counties for their Common
Boundary lines Great
Care was given to measurements and
course and the lines were well

16

and permanently marked as will
be seen from accompanying notes
and plat

For more complete
and full description of means
and methods of Establishing
meridian lines and other lines
for measurements and deflections
on Parallels of Latitude
Reference is made to my report
now on file in the Gen. Land Office
on the work of locating the
Boundary lines of Childress county
which report is very elaborate
and which methods described therein have
been carefully used in making
the locations herein referred to

In testimony of which I
hereunto set my hand at Tulia,
Swisher County, Texas this the
25th day of July A.D. 1892
G. L. Crews Surveyor.

A 108-CERTIFICATE OF RECORD-Class 1*

Clarke & Courts, Stationers, Printers, Lithographers, Galveston.

THE STATE OF TEXAS,

County of Swisher

I, F. Faulkner Clerk of the

County Court in and for said County, do hereby certify that the foregoing instrument of writing

dated the 25th day of July 1892, with its certificates of authentication, was filed for Record in my office the

26th day of July 1892, at 11 o'clock A.M., and duly Recorded the 8th day of

August 1892, at 11 o'clock A.M., in Deed Record of said County, in Vol. 2

Pages 478 479

WITNESS my hand and the seal of the County Court of said County, at office in Tulia

Texas, the day and year last above written.

F. Faulkner Clerk

By J. H. Hart Deputy.

County Court Swisher County.

3-92-20

16-

Swisher Co. Balry Line
Filed July 2
F. Faulkner
Clerk, Swisher
Filed for
July 26, 1892
By J. H. Hart
Deputy
and sent up -
Aug 20/92
E. E. & S. Balry

(16)

route 5909

1
 1892
 1892
 1892

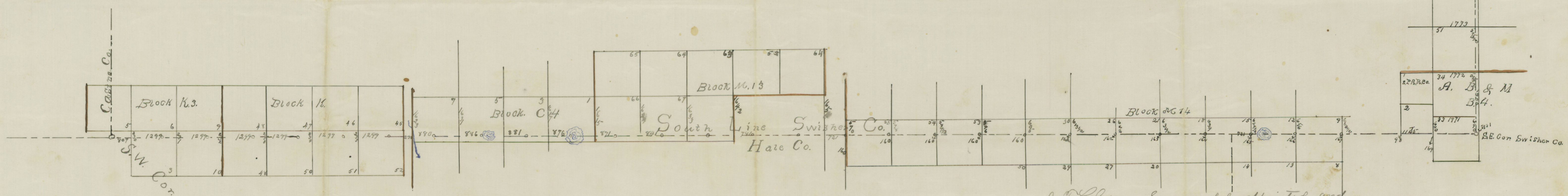
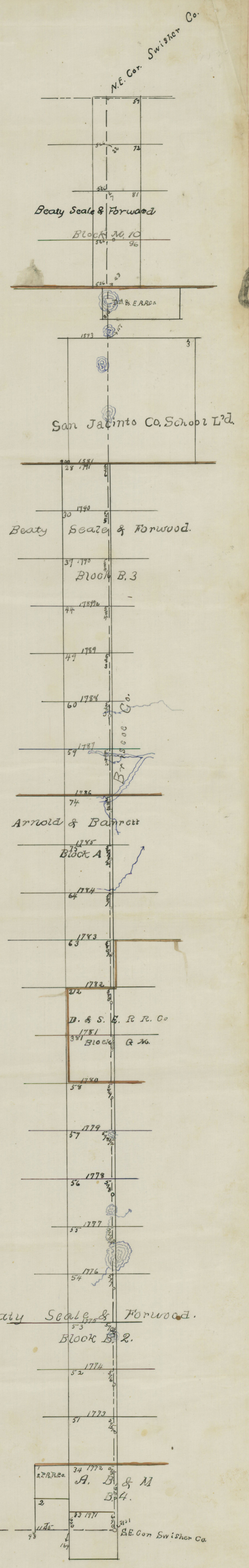

I J. H. Burns Surveyor, duly appointed and
 qualified by the Commissioners Courts of
 the Counties of Esmeralda, Nevada, and
 Swisher, to locate the boundary lines
 of the Counties aforesaid do hereby
 certify that the location of the said
 boundary lines is truly set forth
 by the above map and accompanying
 field notes as they are located on the
 ground. In testimony whereof
 I hereunto set my hand at Julia Texas
 this 25th day of July A.D. 1892.
 J. H. Burns Surveyor

Swisher Co Bldg Line
Swisher Co E & S
city lines.

Filed Aug. 20/92

By *[Signature]*
Chief Clerk

THE STATE OF TEXAS,
County of Swisher, Clerk
of the County Court of Swisher County, Texas, do hereby certify that
the foregoing is a true and correct copy of the original map of East and South
boundary lines of Swisher County

now on file in said Court.
GIVEN UNDER MY HAND and the seal of said Court, at office in Paula
this 16 day of Aug 1892

By *[Signature]* Clerk,
Swisher County

E 563 - CERTIFICATE OF TRUE COPY - Class 1 -
Check & Courts, Stationers, Printers, Lithographers, Galveston.

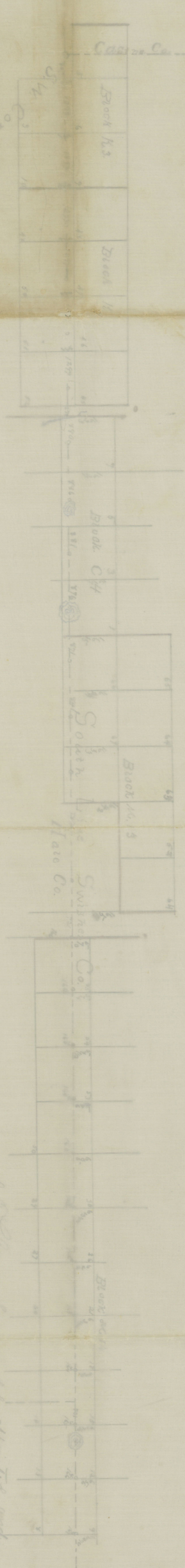

scale 5000

This is a true and correct copy of the original map of East and South boundary lines of Swisher County, Texas, as the same appears on file in said Court.

By *[Signature]* Chief Clerk

