

Dismissed Tex Apr 9<sup>th</sup> 1892.

To the Honorable Commissioners Court of  
Castro County Texas

In obedience to your order dated Feb 9<sup>th</sup> 1892  
to locate the boundaries of Castro County Texas  
I have the honor to report as follows.

From instructions furnished by the Commis-  
sioners of the General Land Office, I found  
the nearest possible beginning upon the  
ground to be NW corner of Hall County Texas.  
Which I proceeded to at the time set by  
your Hon Court to begin proceedings upon.  
The location of said boundaries <sup>as found and</sup>  
identified upon the ground the said North  
West corner of Hall County. Ran therefrom as  
follows. — Beginning at a white Standard  
Stone Mound composed of two stones one  
set in ground <sup>as is marked</sup> (211) (212) DC the  
mound being on the South bank of a cañon  
<sup>and</sup> thirty varas South from the same cañon  
which flows North West into Sandy Creek  
about one half mile from the Mound, from  
which mound a cluster of cedar brush bears  
N 42° E 116 varas <sup>and</sup> a cedar tree 7 inches in diameter  
bears N 9° 30' E 134 1/2 varas marked X A round  
topped butte on divide between Mulberry  
and Sand creeks bears N 25° W and a prominent  
point on the edge of the breaks of the plume  
bears N 74 3/4° W said mound being the  
NW corner of Hall County and the N.E. Cor  
of Briscoe County.

Thence West at 1300 varas pass over sand  
hill at 1580 varas East bank of sand creek at  
1723 varas West bank of sand creek at 4640 varas  
East bank of Mulberry creek at 5025 varas West  
bank of Mulberry creek at 8530 1/10 varas

2

Five acres June at 12029 was across fence at  
15798<sup>10</sup> was Constructed circular trench 8 ft in  
diameter by 4 ft deep 1 ft diameter and  
two ft high with white stone set in center  
marked (S<sup>W</sup>) (S<sup>E</sup>) (B<sup>C</sup>) (L) said Mound is on the  
N edge of a divide between Battle creek  
and a gulch branch, From Mound a cotton  
wood tree 15 inches in diameter bears N 79°  
43' E 297 was and an other cottonwood tree bears  
N 85° 2' E prominent point on the plains  
bears N 58° 58' W The above monument is 8 Miles  
and 592 was West from the N. W. cor of Talleo and is  
marked as above described for the S. E. cor Armstrong  
County Texas.

Thence West at 560 was cross Sulston road  
at 680 was cross Battle creek at 970 and 1110 was cross  
and across Battle creek at 1900<sup>10</sup> was a Mound  
of earth + Stone and two pits for 1<sup>st</sup> mile on  
Armstrong Co.

Thence West at 620 was cross Road at 1900<sup>10</sup> was  
Mound of earth + Stone and two pits where  
Cedar tree on point of rock on hill bears  
South 30° 25' W and prominent point on plains  
bears N 48° 55' W for 2<sup>nd</sup> mile on Armstrong Co.

Thence West at 1900<sup>10</sup> was Md + two pits on  
Stone in Md 8x14 inches for 3<sup>rd</sup> mile on  
Armstrong Co.

Thence West at 1020 was cross draw at 1900<sup>10</sup>  
was a Rock Mound and two pits on saddle between  
two hills for 4<sup>th</sup> mile on Armstrong Co.

Thence West at 240 was cross draw at 440 was  
cross draw at 1820 was an earth and stone 16x18.  
Md in grassy slope said mound being  
80 was East of 5<sup>th</sup> mile on Armstrong Co.

Thruer West at 400-720-1200 and 1780 vrs cross  
Gulch at 1900 8/10 a pile of rocks and two  
pits in ravine 80 vrs East of 6<sup>th</sup> mile on  
Armstrong Co.

Thruer West at 297 vrs cross deep draw at 461 vrs.  
cross head of Gulch at 1900 8/10 vrs. seven rocks on  
earth mound and two pits for 7<sup>th</sup> mile on Armstrong Co.

Thruer West at 1240 vrs cross creek at 1720 vrs.  
cross creek at 1900 8/10 vrs a Md of rocks on west  
side of a deep narrow Gulch for 8<sup>th</sup> mile  
on Armstrong Co.

Thruer West at 1900 8/10 vrs a pile of Gypsum  
rocks on N bank near the head of a deep  
draw and 320 vrs East of Campbell creek for  
9<sup>th</sup> mile on Armstrong Co.

Thruer West at 320 vrs cross Campbell creek  
at 1020 vrs point on divide. at 1900 8/10 vrs a  
Gyp rock 12x12 marked XCL + two pits on West  
side of Bull run creek for 10<sup>th</sup> mile on Armstrong Co.

Thruer West at 1100 vrs East bank Red River  
at 1900 8/10 vrs a point in bed of Red River  
for 11<sup>th</sup> mile on Armstrong Co.

Thruer West at 240 vrs foot of bluffs on W  
side of Red River at 571 vrs. Mound of earth  
and stone at 1820 vrs channel of cañon at  
1900 8/10 vrs a pile of rocks on W side of deep  
cañon 50 vrs from Red River for 12<sup>th</sup> mile  
on Armstrong Co.

Thruer West at 350 vrs east mouth of ravine  
500 vrs right bank of red River at 1750 vrs  
right bank of Red River at 1900 8/10 vrs Mounds  
of stone at root of Mosquite bush 10 vrs West  
of summit of gravelly ridge for 13<sup>th</sup> mile  
on Armstrong Co.

Thruer West at 320 vrs cross Gulch at 617 vrs.  
right bank of Red River at 1202 vrs Left bank  
Red River, at 1900  $\frac{8}{10}$  vrs a point on left bank  
of Red River for 14<sup>th</sup> Mile on Armstrong Co.

Thruer West at 875 vrs right banks of Red River  
at 1900  $\frac{8}{10}$  vrs pile of rocks on East slope of  
bluffs for 15<sup>th</sup> Mile on Armstrong Co.

Thruer West at 860 vrs cross Turkey creek at  
1228 vrs cross head of Gulch at 1500 vrs cross  
at 1900  $\frac{8}{10}$  vrs a stone Monument on top of  
bluffs marked  $\left(\frac{ACL}{76m}\right)$  and BCL. whenever rock  
monument 7' high & 4' in diameter bears  
E 26 vrs, stone monument for 16<sup>th</sup> Mile on  
Armstrong Co.

Thruer West at 220 vrs - at 450 vrs and 1375 vrs cross  
gulches at 1550 vrs running water in Buck  
creek at 1800 vrs cross gulch at 1900  $\frac{8}{10}$  vrs pile  
of rocks in cedar breaks near head of gulch  
for 17<sup>th</sup> Mile on Armstrong Co.

Thruer West at 60 vrs cross gulch at 760 vrs  
cross dry creek at 1900  $\frac{8}{10}$  vrs a point near top  
of bluffs whenever rock monument on edge  
of cap rock bears N 33 vrs for 18<sup>th</sup> Mile on  
Armstrong Co.

Thruer West at 1680 vrs cross road at 1900  $\frac{8}{10}$  vrs.  
earth Monument & two pits for 19<sup>th</sup> Mile  
on Armstrong Co.

Thruer West at 600 vrs shallow round lake  
basin bears S 40 vrs, 1900  $\frac{8}{10}$  vrs Md & Two pits  
for 20<sup>th</sup> Mile on Armstrong Co.

Thruer West at 280 vrs S. J. Hendersons dug out  
bears North 80 vrs at 1900  $\frac{8}{10}$  vrs earth Mound  
& two pits on divide for 21<sup>st</sup> Mile on Armstrong Co.

Thruer West at 1309 vrs a point 30 Miles West  
of the NW cor of Tall Co in low marshy ground  
earth Monument <sup>new</sup> circular trench 3 vrs in

N.E. cor. Swisher

5

Diameter for the N.E. cor. of Swisher Co. where house bears  $N 56^{\circ} 11' W$  another house bears South  $59^{\circ} 28' West$

Thru West at 592 vrs earth mound and two pits for 22<sup>nd</sup> Mile on Armstrong Co. at 1900  $\frac{8}{10}$  vrs earth Md + 2 pits for 1<sup>st</sup> Mile on Swisher Co. where lake basin bears  $N 50$  vrs.

Thru West at 220 vrs cross draw at 592 vrs a Md + 2 pits for 23 Mile on Armstrong Co. at 1900  $\frac{8}{10}$  vrs a Md + 3 pits for 2<sup>nd</sup> Mile on Swisher Co.

Thru West at 592 vrs an earth Md + 2 pits for 24<sup>th</sup> Mile on Armstrong Co. at 1900  $\frac{8}{10}$  vrs an earth Md + 3 pits for 3<sup>rd</sup> Mile on Swisher Co.

Thru West at 592 vrs an earth Md + 2 pits where Pleasant Wind Mill bears  $58^{\circ} N$  at 1900  $\frac{8}{10}$  vrs an earth Md + 3 pits for 4<sup>th</sup> Mile on Swisher Co.

Thru West at 592 vrs an earth Md + 2 pits for 26<sup>th</sup> Mile on Armstrong Co. at 1900  $\frac{8}{10}$  vrs an earth Mound + 3 pits for 5<sup>th</sup> Mile on Swisher Co.

Thru West at 592 vrs an earth Md + 2 pits for 27<sup>th</sup> Mile on Armstrong Co. at 1900  $\frac{8}{10}$  vrs an earth Md + 3 pits for 6<sup>th</sup> Mile on Swisher Co.

Thru West at 592 vrs an earth Md + 2 pits for 28<sup>th</sup> Mile on Armstrong Co. at 1900  $\frac{8}{10}$  vrs an earth Md + 3 pits for 7<sup>th</sup> Mile on Swisher Co.

Thru West at 440 vrs H.C. Evans house bears  $N 6$  vrs. at 486. vrs. Evans well bears  $S 3$  vrs. at 592 vrs an earth Md + 2 pits for 29<sup>th</sup> Mile on Armstrong Co. at 1900  $\frac{8}{10}$  vrs an earth Md + 3 pits for 8<sup>th</sup> Mile on Swisher Co.

Thru West at 592 vrs an earth Md + 2 pits for 30<sup>th</sup> Mile on Armstrong Co. at 1838 vrs. a Mound and semi circular trench 6 ft in diameter for J.W. Coomer of Armstrong Co. and S.E. cor. of Randall Co. where Jassar Dobb.

9  
10  
11  
12  
13  
14  
15  
16  
17  
18  
19  
20  
21  
22  
23  
24  
25  
26  
27  
28  
29  
30  
31  
32  
33  
34  
35  
36  
37  
38  
39  
40  
41  
42  
43  
44  
45  
46  
47  
48  
49  
50  
51  
52  
53  
54  
55  
56  
57  
58  
59  
60  
61  
62  
63  
64  
65  
66  
67  
68  
69  
70  
71  
72  
73  
74  
75  
76  
77  
78  
79  
80  
81  
82  
83  
84  
85  
86  
87  
88  
89  
90  
91  
92  
93  
94  
95  
96  
97  
98  
99  
100  
101  
102  
103  
104  
105  
106  
107  
108  
109  
110  
111  
112  
113  
114  
115  
116  
117  
118  
119  
120  
121  
122  
123  
124  
125  
126  
127  
128  
129  
130  
131  
132  
133  
134  
135  
136  
137  
138  
139  
140  
141  
142  
143  
144  
145  
146  
147  
148  
149  
150  
151  
152  
153  
154  
155  
156  
157  
158  
159  
160  
161  
162  
163  
164  
165  
166  
167  
168  
169  
170  
171  
172  
173  
174  
175  
176  
177  
178  
179  
180  
181  
182  
183  
184  
185  
186  
187  
188  
189  
190  
191  
192  
193  
194  
195  
196  
197  
198  
199  
200  
201  
202  
203  
204  
205  
206  
207  
208  
209  
210  
211  
212  
213  
214  
215  
216  
217  
218  
219  
220  
221  
222  
223  
224  
225  
226  
227  
228  
229  
230  
231  
232  
233  
234  
235  
236  
237  
238  
239  
240  
241  
242  
243  
244  
245  
246  
247  
248  
249  
250  
251  
252  
253  
254  
255  
256  
257  
258  
259  
260  
261  
262  
263  
264  
265  
266  
267  
268  
269  
270  
271  
272  
273  
274  
275  
276  
277  
278  
279  
280  
281  
282  
283  
284  
285  
286  
287  
288  
289  
290  
291  
292  
293  
294  
295  
296  
297  
298  
299  
300  
301  
302  
303  
304  
305  
306  
307  
308  
309  
310  
311  
312  
313  
314  
315  
316  
317  
318  
319  
320  
321  
322  
323  
324  
325  
326  
327  
328  
329  
330  
331  
332  
333  
334  
335  
336  
337  
338  
339  
340  
341  
342  
343  
344  
345  
346  
347  
348  
349  
350  
351  
352  
353  
354  
355  
356  
357  
358  
359  
360  
361  
362  
363  
364  
365  
366  
367  
368  
369  
370  
371  
372  
373  
374  
375  
376  
377  
378  
379  
380  
381  
382  
383  
384  
385  
386  
387  
388  
389  
390  
391  
392  
393  
394  
395  
396  
397  
398  
399  
400  
401  
402  
403  
404  
405  
406  
407  
408  
409  
410  
411  
412  
413  
414  
415  
416  
417  
418  
419  
420  
421  
422  
423  
424  
425  
426  
427  
428  
429  
430  
431  
432  
433  
434  
435  
436  
437  
438  
439  
440  
441  
442  
443  
444  
445  
446  
447  
448  
449  
450  
451  
452  
453  
454  
455  
456  
457  
458  
459  
460  
461  
462  
463  
464  
465  
466  
467  
468  
469  
470  
471  
472  
473  
474  
475  
476  
477  
478  
479  
480  
481  
482  
483  
484  
485  
486  
487  
488  
489  
490  
491  
492  
493  
494  
495  
496  
497  
498  
499  
500  
501  
502  
503  
504  
505  
506  
507  
508  
509  
510  
511  
512  
513  
514  
515  
516  
517  
518  
519  
520  
521  
522  
523  
524  
525  
526  
527  
528  
529  
530  
531  
532  
533  
534  
535  
536  
537  
538  
539  
540  
541  
542  
543  
544  
545  
546  
547  
548  
549  
550  
551  
552  
553  
554  
555  
556  
557  
558  
559  
560  
561  
562  
563  
564  
565  
566  
567  
568  
569  
570  
571  
572  
573  
574  
575  
576  
577  
578  
579  
580  
581  
582  
583  
584  
585  
586  
587  
588  
589  
590  
591  
592  
593  
594  
595  
596  
597  
598  
599  
600  
601  
602  
603  
604  
605  
606  
607  
608  
609  
610  
611  
612  
613  
614  
615  
616  
617  
618  
619  
620  
621  
622  
623  
624  
625  
626  
627  
628  
629  
630  
631  
632  
633  
634  
635  
636  
637  
638  
639  
640  
641  
642  
643  
644  
645  
646  
647  
648  
649  
650  
651  
652  
653  
654  
655  
656  
657  
658  
659  
660  
661  
662  
663  
664  
665  
666  
667  
668  
669  
670  
671  
672  
673  
674  
675  
676  
677  
678  
679  
680  
681  
682  
683  
684  
685  
686  
687  
688  
689  
690  
691  
692  
693  
694  
695  
696  
697  
698  
699  
700  
701  
702  
703  
704  
705  
706  
707  
708  
709  
710  
711  
712  
713  
714  
715  
716  
717  
718  
719  
720  
721  
722  
723  
724  
725  
726  
727  
728  
729  
730  
731  
732  
733  
734  
735  
736  
737  
738  
739  
740  
741  
742  
743  
744  
745  
746  
747  
748  
749  
750  
751  
752  
753  
754  
755  
756  
757  
758  
759  
760  
761  
762  
763  
764  
765  
766  
767  
768  
769  
770  
771  
772  
773  
774  
775  
776  
777  
778  
779  
780  
781  
782  
783  
784  
785  
786  
787  
788  
789  
790  
791  
792  
793  
794  
795  
796  
797  
798  
799  
800  
801  
802  
803  
804  
805  
806  
807  
808  
809  
810  
811  
812  
813  
814  
815  
816  
817  
818  
819  
820  
821  
822  
823  
824  
825  
826  
827  
828  
829  
830  
831  
832  
833  
834  
835  
836  
837  
838  
839  
840  
841  
842  
843  
844  
845  
846  
847  
848  
849  
850  
851  
852  
853  
854  
855  
856  
857  
858  
859  
860  
861  
862  
863  
864  
865  
866  
867  
868  
869  
870  
871  
872  
873  
874  
875  
876  
877  
878  
879  
880  
881  
882  
883  
884  
885  
886  
887  
888  
889  
890  
891  
892  
893  
894  
895  
896  
897  
898  
899  
900  
901  
902  
903  
904  
905  
906  
907  
908  
909  
910  
911  
912  
913  
914  
915  
916  
917  
918  
919  
920  
921  
922  
923  
924  
925  
926  
927  
928  
929  
930  
931  
932  
933  
934  
935  
936  
937  
938  
939  
940  
941  
942  
943  
944  
945  
946  
947  
948  
949  
950  
951  
952  
953  
954  
955  
956  
957  
958  
959  
960  
961  
962  
963  
964  
965  
966  
967  
968  
969  
970  
971  
972  
973  
974  
975  
976  
977  
978  
979  
980  
981  
982  
983  
984  
985  
986  
987  
988  
989  
990  
991  
992  
993  
994  
995  
996  
997  
998  
999  
1000

Four bears S  $14^{\circ} 30' N$  about 350 wrs and Wind  
Mill bears N  $60^{\circ} 02' E$  at 1900  $\frac{8}{10}$  wrs an earth  
Md + 3 pits for 9<sup>th</sup> Mile on Swisher Co.

Thruer West at 760 wrs cross drain at 960  
wrs small lake basin bears N 80 wrs at 1020 to  
1040 wrs Mc Kenzie trail at 1900  $\frac{8}{10}$  wrs an earth  
Md + 3 pits for 10<sup>th</sup> Mile on Swisher Co.

Thruer West at 1900  $\frac{8}{10}$  wrs a Md + 3 pits for 11<sup>th</sup>  
Mile on Swisher Co.

Thruer West at 586 wrs Iron Pipe marked  
Blk M 9, 153 on N.E. 133 on NW bears N 89 wrs at  
1900  $\frac{8}{10}$  wrs an earth Md + 3 pits for 12<sup>th</sup> Mile  
on Swisher Co.

Thruer West at 1900  $\frac{8}{10}$  wrs an earth Md + 3 pits  
for 13<sup>th</sup> Mile on Swisher Co small round lake  
basin bears South 150 wrs

Thruer West at 360 wrs cross wagon road.  
591 wrs Iron Pipe marked block M 9, 99 on  
S.W. 109 S.E. 100 NW and 117 on N.E. bears N 88 wrs.  
at 843 wrs cross road at 1760 wrs cross drain at  
1900  $\frac{8}{10}$  wrs an earth Md + 3 pits for 14<sup>th</sup> Mile  
on Swisher Co.

Thruer West at 957 wrs cross road 1277 wrs cross  
road 1676 wrs cross old road at 1900  $\frac{8}{10}$  wrs an  
earth Md + 3 pits for 15<sup>th</sup> Mile on Swisher Co.

Thruer West at 496 wrs cross road at 1450 wrs cross  
road at 1900  $\frac{8}{10}$  wrs an earth Md + 3 pits for 16<sup>th</sup>  
Mile on Swisher Co.

Thruer West at 10 wrs cross road at 119. wrs.  
Wallacks house bears N  $7^{\circ} E$  about 180 wrs and  
Wallacks Wind Mill bears N  $8^{\circ} 20' E$  at 1900  $\frac{8}{10}$  wrs.  
an earth Md + 3 pits for 17<sup>th</sup> Mile on Swisher Co.

Thruer West at 1900  $\frac{8}{10}$  wrs an earth Md + 3 pits  
for 18<sup>th</sup> Mile on Swisher Co.

Thruer West at 1900  $\frac{8}{10}$  wrs an earth Md + 3 pits  
for 19<sup>th</sup> Mile on Swisher Co.

Thruer West at 200 vrs Rappy S O Wind Mill  
bears N about 45 vrs at 658 1/2 vrs West line of Alk  
M 9 another pile of stone and Iron pipe marked.  
Alk M 9 bears N 45 vrs at 1900 8/10 vrs an earth  
Mound + 3 pits for 20<sup>th</sup> Mile on Swisher Co.

Thruer West at 60 vrs Rappy Follow Draw at  
520 to 560 vrs touch South side of Rappy Draw  
at 655 vrs cross wire fence at 930 vrs cross  
Rappy draw at 1360 vrs cross wagon road  
at 1900 8/10 vrs an earth Mound + 3 pits for 21<sup>st</sup> Mile  
on Swisher Co.

Thruer West at 1083 vrs cross wagon road  
at 1160 vrs cross wagon road at 1900 8/10 vrs an earth  
Mound + 3 pits for 22<sup>nd</sup> Mile on Swisher Co.

Thruer West at 1900 8/10 vrs an earth Mound + 3 pits  
for 23<sup>rd</sup> Mile on Swisher Co.

Thruer West at 961 1/2 vrs Iron pipe land corner  
Marked Alk M 8- 9 + 10 on West side and 4 + 42 on  
East side, bears N 123 3/4 vrs at 1185 vrs across  
draw at 1490-1526-1600-1665-1740 and 1830 vrs cross  
and across Rappy Follow Draw at 1900 8/10 vrs an  
earth Mound + 3 pits for 24<sup>th</sup> Mile on Swisher Co.

Thruer West at 1000-1040-1080 vrs cross and across  
Rappy Follow Draw at 1900 8/10 vrs an earth  
Mound + 3 pits for 25<sup>th</sup> Mile on Swisher Co.

Thruer West at 475 vrs cross wagon road at  
1035 vrs an Iron pipe for land corner bears  
N 132 1/2 vrs and as marked 4 + 5 on East and 37 + 38 on West  
side also Alk M 6 on N + S sides, at 1900 8/10 vrs.  
an earth mound + 3 pits for 26<sup>th</sup> Mile on  
Swisher Co. This mound is in a lake basin  
and is 100 vrs from the East edge of same.

Thruer West at 560 vrs West side of lake basin  
at 1440 vrs cross road at 1900 8/10 vrs an earth mound  
and 3 pits for 27<sup>th</sup> Mile on Swisher Co.

Thruer Wash at 440 vrs East side of lake basin  
at 1040 West side of lake at 1900<sup>8</sup>/<sub>10</sub> vrs an earth  
Md + 3 pits for 28<sup>th</sup> Mile on Swisher Co.

Thruer Wash at 1046 vrs cross fence on Sec  
line at 1900<sup>8</sup>/<sub>10</sub> vrs an earth Md + 3 pits for  
29<sup>th</sup> Mile on Swisher Co.

Thruer Wash at 1900<sup>8</sup>/<sub>10</sub> vrs an earth Md +  
circular trench 4 vrs in diameter an earth  
Mound with stone in center marked.  
(C.R.) - (S.E.) - (N.E.) for N.W. corner of Swisher County  
an N.E. corner Castro Co.



Thence South at 1773 varas cross fence  
at 1900 $\frac{8}{10}$  varas mound and 3 pits for  
1<sup>st</sup> mile on Swisher W boundary.

Thence South at 900 $\frac{8}{10}$  varas mound and  
3 pits for 2<sup>nd</sup> mile on Swisher W boundary.

Thence South at 1300 varas cross draw  
at 1900 $\frac{8}{10}$  varas mound and 3 pits for  
3<sup>rd</sup> mile on Swisher W boundary.

Thence South at 1900 $\frac{8}{10}$  varas mound and 3  
pits for 4<sup>th</sup> mile on Swisher W boundary.

Thence South at 533 varas cross ravine at  
312 varas cross North Tule. at 1900 $\frac{8}{10}$  varas  
mound and 3 pits for 5<sup>th</sup> mile on Swisher  
W boundary.

Thence South <sup>at</sup> 1900 $\frac{8}{10}$  varas mound and  
3 pits for 6<sup>th</sup> mile on Swisher W boundary.

Thence South <sup>at</sup> 1900 $\frac{8}{10}$  varas mound and 3  
pits for 7<sup>th</sup> mile on Swisher W boundary.

Thence South at 78 varas Cross Carters  
wood road at 1900 $\frac{8}{10}$  varas mound and  
3 pits for 8<sup>th</sup> mile on Swisher W boundary.

Thence South 1360 varas cross road at  
1770 varas cross draw at 1900 $\frac{8}{10}$  varas  
mound and 3 pits for 9<sup>th</sup> mile on Swisher W  
boundary.

Thence South at 1900 $\frac{8}{10}$  varas mound and 3  
pits for 10<sup>th</sup> mile on Swisher W boundary.

Thence South <sup>at</sup> 1900 $\frac{8}{10}$  varas to mound and 3  
pits for 11<sup>th</sup> mile on W boundary of Swisher.

Thence South <sup>at</sup> 1900 $\frac{8}{10}$  varas mound and 3  
pits for 12<sup>th</sup> mile on Swisher W boundary.

whence wind mill and draw bears  
S 34° 48' W and Circle dugout bears S 88°  
24' W

Thence at 759 varas Middle Tule draw  
at 794 varas cross road at 1900 $\frac{8}{10}$  varas

13 mound and 3 pits for 13<sup>th</sup> mile on Swisher  
W boundary.

14 Thence at 1470 varas cross deep draw at  
1900  $\frac{8}{10}$  varas mound and 3 pits for 14<sup>th</sup>  
mile on Swisher W boundary.

15 Thence South at 1900  $\frac{8}{10}$  varas mound and 3  
pits for 15<sup>th</sup> mile on Swisher W boundary.

16 Thence South at 80 varas cross road  
at 106 and 639 north edge of lake - at

1900  $\frac{4}{10}$  varas mound and 3 pits for 16  
mile on Swisher W boundary, thence iron  
pipe for land corner marked 100x101 Blk  
M6 and 10 Blk M11 and 1 Blk 9T bears  
S 181° 39' E 862 varas.

17 Thence South at 1900  $\frac{8}{10}$  varas mound  
and 3 pits for 17<sup>th</sup> mile on Swisher W  
boundary.

18 Thence South <sup>at</sup> 1900  $\frac{8}{10}$  varas mound and  
3 pits for 18<sup>th</sup> mile on Swisher W boundary.

19 Thence South at 585 varas cross deep  
draw at 1900  $\frac{8}{10}$  varas mound and 3  
pits for 19<sup>th</sup> mile on Swisher W boundary.

20 Thence South at 1900  $\frac{8}{10}$  varas mound and  
3 pits for 20<sup>th</sup> mile on Swisher W boundary.

21 Thence South at 1900  $\frac{8}{10}$  varas mound and  
3 pits for 21<sup>st</sup> mile on Swisher W boundary.

22 Thence South at 1900  $\frac{8}{10}$  varas mound and  
3 pits for 22<sup>nd</sup> mile on Swisher W boundary.

Thence South at 210 to 240 varas cross west  
spur of lake at 534 varas cross draw -  
at 1900  $\frac{8}{10}$  varas mound and 3 pits for

23 23<sup>rd</sup> mile on Swisher W boundary.

Thence South at 1679 varas lake bears  
East 1200 varas at 1900  $\frac{8}{10}$  varas mound  
and 3 pits for 24<sup>th</sup> mile on Swisher W  
boundary.

25 Thence South at 1900  $\frac{3}{10}$  varas mound and  
3 pits for 25<sup>th</sup> mile on Swisher W boundary.

26 Thence South at 1900  $\frac{3}{10}$  varas mound and  
3 pits for 26<sup>th</sup> mile on Swisher W boundary.

27 Thence South at 37 varas iron pin for land  
corner marked M. 11, 91<sup>on N.E</sup> and S 2, 20, 22,  
and 21 bears S 79° 19' E 876 $\frac{1}{2}$  varas at 100  
varas N.W. and at 370 varas S.W. edge  
of lake - at 1866 varas N edge of lake  
at 1900  $\frac{3}{10}$  varas mound and 3 pits for  
27<sup>th</sup> mile on Swisher W boundary.

28 Thence South at 579 varas south edge of  
lake at 1900  $\frac{3}{10}$  varas mound and 3 pits  
for 28<sup>th</sup> mile on Swisher W boundary.

29 Thence South at 1900  $\frac{3}{10}$  varas mound and  
3 pits for 29<sup>th</sup> mile on Swisher W boundary.

Thence South at 1900  $\frac{3}{10}$  varas a cedar post  
marked S. E. C. C., S. O. S and N. S and  
monument of earth and circular trench  
4 varas in diameter for S. E. Castro  
Co and S. O. corner Swisher Co.

S. J. Banks } Chain

Sam Jerrall } Carriers

Surveyed Mar 11<sup>th</sup> to April 9<sup>th</sup> 1892.

I, W. D. Twitchell special Deputy Surveyor on  
of Castro Co do hereby certify that the above and  
foregoing field Notes are true and correct and  
truly and correctly describe the Marks both  
Natural and Artificial as they appear upon the ground  
and that said Survey was actually made in  
the field according to law and truly describes  
the boundaries of Castro County Texas.

Witness my hand this the 9<sup>th</sup> day of April  
A. D. 1892.

W. D. Twitchell Deputy Surveyor on  
Castro County Texas.

THE STATE OF TEXAS,

County of Castro

I, L. L. Morrison Co Clerk

Survey of the Castro Court of \_\_\_\_\_ County, Texas, do hereby certify that

the foregoing is a true and correct copy of the original Field Notes & depositions etc  
as the same appears of record in my office in book \_\_\_\_\_ page \_\_\_\_\_  
beginning at NW Cor. Hall Co Texas to the SW of  
Swisher County Texas.

Given Under my Hand and the Seal of said Court, at office in \_\_\_\_\_

this 16<sup>th</sup> day of August 1892

L. L. Morrison Surveyor  
of Castro County Texas

E 503 - CERTIFICATE OF TRUE COPY - Class 1\*

Clarke & Courts, Stationers, Printers, Lithographers, Galveston.

THE STATE OF TEXAS,

County of Swisher  
of the County Court of Swisher

I, F. Faulkner, Clerk  
County, Texas, do hereby certify that

the foregoing is a true and correct copy of the original Field notes of the North  
and West boundary lines of Swisher Co,  
Texas  
now on file in said Court. Vol 2 Page 505-10-11-12

GIVEN UNDER MY HAND and the seal of said Court, at office in Tulia, Texas

this 31<sup>st</sup> day of October 1892

F. Faulkner Clerk,  
By T. W. Hart Deputy.

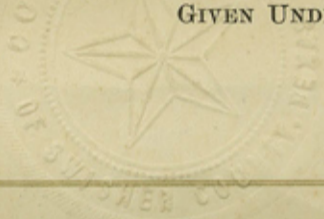

5-90-10

cover 59104

Report of North  
and West Boundary  
lines of Swisher Co the

Filed Oct 25<sup>th</sup> 1892  
F. Faulkner  
Clerk  
By T. W. Hart  
Deputy

with Report being  
examined and  
all things approved  
on 28<sup>th</sup> day of Oct 1892  
J. W. Lord Co Judge  
Swisher Co  
F. Faulkner  
Clerk  
T. W. Hart Deputy

Swisher Co 4<sup>th</sup> Barly Line 2

Swisher County  
Boundaries

North and West Lines

Filed Nov 15<sup>th</sup> 1892

Examined and approved  
Nov 15/92 G. N. Beaumont

Examined and approved  
Nov 15/92 G. N. Beaumont

cover 59105

Report of North  
and West Boundary  
Line of Swisher Co.       

X

Filed Oct 25<sup>th</sup> 1892

F Faulkner  
Clerk

By J. W. Hart  
Deput.

The within report being  
duly examined and  
is in all things approved  
Done in Open Court  
this 25<sup>th</sup> day of Oct 1892

C. J. Woods Co. Judge  
Swisher Co.

Attest

F. Faulkner

Clerk

By J. W. Hart Deput.

Swisher Co. 4 Bary Line 2

Swisher County  
Boundaries

North & West lines

Filed Nov 15<sup>th</sup> 1892

Wm Braullette  
Chief Clerk

Examined and ap-  
proved

11/15/92 G. N. Beaumont



N.W. Cor Swisher Co.

N.E. Cor Swisher Co.

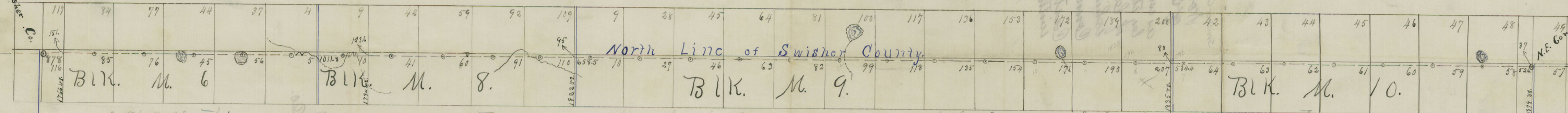

*[Faint, illegible handwritten notes, possibly bleed-through from the reverse side of the page.]*

I, W. B. Hutchinson, surveyor duly appointed and qualified by the Commissioners Court of the County of Swisher to locate the <sup>north</sup> boundary line of Swisher County do hereby certify that the location of the said boundary line is truly set forth by the above map and accompanying field notes, as they are located on the ground. In testimony whereof I hereunto set my hand at Tulia, Texas, this the 27th day of October A.D. 1892.

W. B. Hutchinson.

Beaty Seale & Forward

Block M 10

con. No 59106

Block No 10

Survey of 2nd 2nd 2nd 2nd 2nd

The following is a description of the land shown on the above map and plat, to-wit:

The land is situated in the County of ... State of ... and is bounded on the north by ... on the south by ... on the east by ... and on the west by ...

The land is divided into ... sections, each containing ... acres, more or less.

The land is owned by ... and is being offered for sale by ...

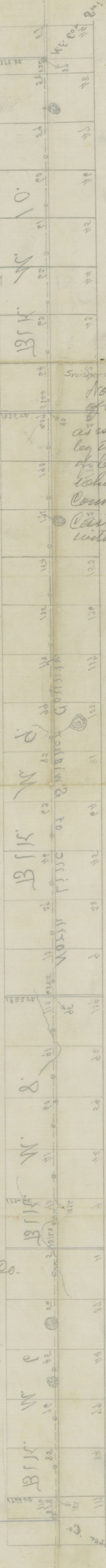

Swisher Co <sup>12</sup> Edge Line  
 North edge line  
 of Swisher Co  
 as established  
 by the Surveyors  
 of Castro Co  
 while making  
 connection for  
 Castro Co edges  
 with Hall Co.

10-27-1892

cont 59107

N. King Swisher Co.

M. E. Co. Swisher Co.

S.W. Cor. Swisher County

See sketch in SF 7287

Swisher County  
West Line  
of Swisher  
County

N.W. Cor. Swisher County

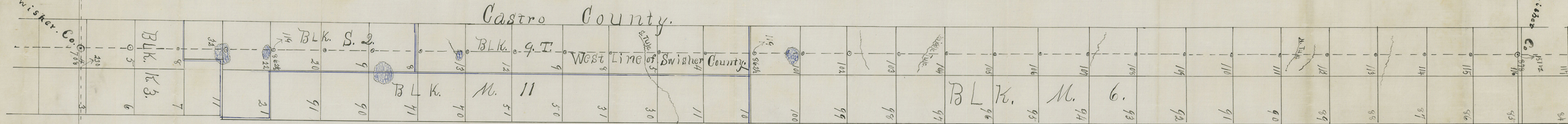

I, W. B. Hutchinson, surveyor duly appointed and qualified by the Com. Court of the County of Swisher to locate the west boundary line of Swisher County do hereby certify that the location of the said boundary line is truly set forth by the above map and accompanying field notes as they are located on the ground. In testimony whereof I hereunto set my hand at Terlingua Texas, this the 27th day of October A.D. 1892. W. B. Hutchinson, Surveyor



Swisher Co. Bdry Line 2  
 West body line  
 of Swisher Co  
 10-27-1892

See sketch in 277587

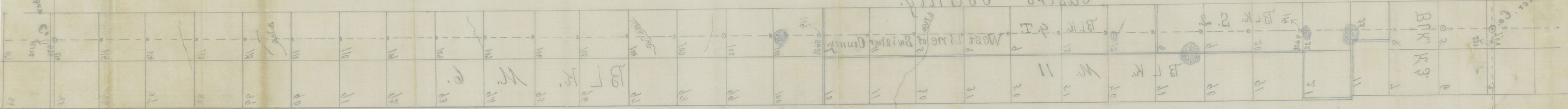

W. B. Beckwith Surveyor  
 1892

I hereby certify that the location of the said boundary line is true and correct as shown on the above map and as shown on the sketch of the same in 277587. This is the true and correct copy of the original of the same as shown on the sketch of the same in 277587.

W.M. Co. - Swisher Co.

Swisher Co. - W.M. Co.