

Boundary lines in
Sketch of
Taylor Co

E, W + S lines

Abstract Corrected
and Copy furnished
the Comp Pub Acct
Aug 22nd / 88
Barnum

ms. 59104

1.
Taylor Co Bdry Line 1

Taylor County.
County lines

Filed Novemb. 5th
/ 82.

only signed by Surveyors
of Taylor Co.

Buffalo Gap Tex
Oct 13th 1882

Hon W C Walsh
Counr G. L. D. office
Austin Tex

Dear Sir

Herewith I enclose to you certified
copy of an order of the Court Ct
appointing H. M. Henderson a Surveyor
to survey the County lines: also
Certificate to the effect that the
Courts of the adjoining Counties
were properly notified:

2nd Copy of the field notes of West
Smith & East boundary lines -

also Certificate to the effect that the
original Sketch (of which I send you
copy) is on file in my office. If this
work is found to be correct & all
satisfactory we would like to have a
certificate of Approval from your
office, which I will have properly
framed as a memento of my office.

Yours Truly

W C Lawrence
Co. Clerk Taylor
County

Jus Commiffioners Court } May Term 1882.

Taylor County } May 9th 1882.

Copy: Order No (1) One.

That whereas it appears to the Court, that the County Line between this County and Nolan County is not definitely located and established; And also that the lines between this County and the Counties of Rummels, Boone and Callahan are in an unsettled & unlocated Condition and not definitely established as the law requires. It is therefore Ordered by this Court that H. M. Henderson be and he is hereby appointed to survey, mark and establish said lines in accordance with law: and further, It is ordered by the Court, that the Clerk notify the Com^{rs} Court of Nolan County, that our Surveyor appointed as aforesaid to locate said County lines; will begin at the N.W. Cor. of Taylor & the S.W. Cor of Jones Counties on the 15th day of August 1882. to survey, locate, & establish the boundary line between the Counties of Taylor & Nolan; It is further Ordered that the Clerk of this Court notify the Com^{rs} Court of Rummels County, that H. M. Henderson the Surveyor appointed as aforesaid to locate the Co. lines &c, will begin at the S.W. Cor of Taylor Co on the 22nd day of August 1882 to survey mark and establish the Boundary line between the Counties of Taylor & Rummels; and further that the said Clerk notify the Com^{rs} Court of Boone County that our Surveyor, appointed as aforesaid, to locate the Co lines, will begin at the N.E. Cor of Rummels County on the South Boundary line of Taylor County on the 26th day of August 1882. to survey, mark & establish the Boundary line between the Counties of Taylor & Boone; Also it is ordered by the Court that the Clerk notify the Com^{rs} Court of Callahan County, that our Surveyor appointed as aforesaid is ordered to begin at the N.E. Cor of Taylor & the N.W. Cor. of Callahan Counties to survey mark and establish the County line between the Counties of Callahan and Taylor on the 4th day of September 1882.

The State of Texas

County of Taylor I, hereby Certify that the above and foregoing is a true and Correct Copy from the minutes of the Commissioners Court of Taylor County Texas; I further Certify that the Com^{rs} Court of Nolan County was notified in pursuance of said order, on the 18th day of May 1882, and that the Com^{rs} Court of Rannels County was notified on the 26th day of May 1882; and that the Com^{rs} Court of Coleman County was notified on the 2nd day of August 1882, and that the Com^{rs} Court of Callahan County was notified on the 2nd day of August 1882. by mailing to the County Clerk of each of said Counties a Certified Copy of the Above Order. Witness my official Seal and signature this 12th day of October A. D. 1882. at Buffalo Gap Taylor County Texas

M. C. Lammuth
Clerk of the County Court
of Taylor County Texas



Field Notes of a Survey of the West,
South and East Boundary Lines of Taylor
County made in accordance with an Order of
the Comrs Court of said County, dated 9th day of
May A. D. 1882.

WEST. LINE

Beginning at S. W. Cor. Jones County, a Stone 6" x 10" x 2ft
high m^kd S. L. J. C. W 30 - S. W. Co. Set 1060 vs S 75° W. + 55
vs N. 14 3/4° W. from the S. E. Cor. of Sur No 283, in the name
of Robert Speers as established by the T + P. Rwy Co.

Thence S - at 1712 vs - Cross N. line of Sec No 30 Blk
19, T + P. R. R. Co. 1407 vs - S. 77° W of its N. E. Cor. at 1820 vs - Cross
Center line road at one mile set Stone m^kd W. L. T. C. S. 1.

At 37 vs pass 211 vs E. of Stone set by Lyman Strickland
for N. W. Cor of Taylor Co. At 1882 vs Cross T + P. R. R. in a
Cut, 2 miles set Stone on Embankment S. of Cut. m^kd W. L. T. C. S. 2.

At 828 vs Cross Branch C. S. E. At 1237 cross another C. S. E.

At 1822 vs Cross N. line of Sec No 43 Blk 19, T + P. R. R. Co 439 vs,
S 77° W of its N. E. Cor. At 3 miles set Stone m^kd W. L. T. C. S. 3 - At 4 miles
set Stone m^kd W. L. T. C. S. 4. - At 40 vs Cross Buffalo Gap + Sweet Water
Road. At 5 miles set Stone m^kd W. L. T. C. S. 5 - At 6 miles set

Stone m^kd W. L. T. C. S. 6 - At 580 vs N foot of mts - at 1050 vs top
of same - angle of slope 12 1/2 - 1650 N. edge of a Canyon
C. W. At 7 miles set Stone in said Canyon m^kd W. L. T. C. S. 7.

Up to 1600 vs - is a crop rough mountain - At 8 miles set
Stone in N. side of Mulberry Canyon m^kd W. L. T. C. S. 8.

At 600 vs Cross Road, C. S. E. At 1670 vs. Cross Cow Branch C. S. E.

At 9 miles set Stone m^kd W. L. T. C. S. 9. At 192 vs Cross S line of Sec

No 69, Blk 19 T + P. R. R. Co. - 343 vs. S 77° W of Center Cor on same m^kd
T. 19. W. 5 1/2° S. E. - At 1700 vs Cross Mulberry or Evans Creek C. S. E. at

10 miles set Stone m^kd W. L. T. C. S. 10. At 560 vs. Cross N. line of

Sec 59, Blk 5 T + P. R. R. Co. 228 vs W of S. W. Cor of Sec 60, Blk 5 - At 11 miles

set Stone m^kd W. L. T. C. S. 11 - At 360 vs Cross Creek C. E. in N. edge

of Cedar Brake on Red Hills - 1465 vs Cross Branch C. N. E. - At

12 miles set Sto mk^d W.L.T.C.S. 12 - At 190 vs Cross Branch C.N.E.
 At 13 miles set Stone mk^d W.L.T.C.S. 13 - At 300 vs N. Foot of Mt of S. Side
 of Kentucky. Can^{on} - At 970 vs Top of Mt - At 14 miles in a Can^{on} C. E. set
 Cedar Stk 6" + 6" mk^d W.L.T.C.S. 14 106 vs E of Cor on hill side. At 15 miles set
 Sto in open prairie mk^d W.L.T.C.S. 15 - At 560 vs Cross S. line Sec 32 Blk 5 -
 + T.P.R.R. Co. 128 vs E of its S.W. Cor. At 16 miles set Sto mk^d W.L.T.C.S. 16 -
 + At 560 vs Cross S. line Sec 31 Blk 5 - 122 vs East of its S.W. Cor.
 At 1100 vs Crop Br. C.S.E. At 1883 vs Crop head of Clear Fork - At 17
 miles set Sto mk^d W.L.T.C.S. 17 - At 18 miles set Sto in Br. C.N.E. mk^d
 W.L.T.C.S. 18 - At 19 miles set Sto on S. Slope of Hills at the Head of
 Cottonwood mk^d W.L.T.C.S. 19 - At 400 vs Crop head of Cottonwood
 At 20 miles set Sto mk^d W.L.T.C.S. 20 - At 1000 vs Crop Cottonwood
 C.S.W. - At 1500 vs re-cross same C.S.E. At 21 miles set Sto mk^d
 W.L.T.C.S. 21. 250 vs West of Cottonwood - At 22 miles set Stone mk^d
 W.L.T.C.S. 22. At 750 vs Crop W. fork of Cottonwood C.E. At 23 miles set
 Stone mk^d W.L.T.C.S. 23. - At 1033 vs Crop S. line of Sec 168 Blk 64.
 + H.T.C. R.R. Co. 900 vs W. of its S.E. Cor. - At 24 miles set Stone mk^d W.L.T.C.S. 24
 - At 900 vs Crop Valley Creek. C.N. 80 E. - 15 vs wide - At 969 vs pass 50 vs
 E of the N.W. Cor of the W.S. Henry Sur - At 25 miles set Stone mk^d W.L.T.C.S. 25
 at N. foot of Chain of Hills. At 200 vs Top of same, C.E. - At
 1300 vs Crop another Hill. At 26 miles set Stone mk^d W.L.T.C.S. 26
 in N. edge of Post Oaks - At 700 vs Crop old Ft Phantom Hill +
 Ft Chadbourne Road - At 27 miles set Stone on side of Post
 Oaks - mk^d W.L.T.C.S. 27 - At 28 miles set Stone in head of
 ravine. C.S.E. mk^d W.L.T.C.S. 28. - At 29 miles set Stone mk^d
 W.L.T.C.S. 29. - At 1120 vs. Cross E. line of the Upper Edward
 Taylor Sur 166 vs, S 30 E of its N.E. Cor. At 1520 vs Cross Fish
 Creek. C.S.E. - At 1540 vs. recrop same C.S.W. At 30 miles
 set Stone 32" + 15" + 5" mk^d

E.W. Cor	S.E. Cor
Taylor Co	Nolan Co
South	30

 and on the South
 Side mk^d North Line R. Co.

South Line

Beginning at S. W. Cor of County.

Thence East at 1 mile set Stone m^kd S.L.T.C.E. 1

At 1675 vs Cross Br. C. S. - At 2 miles set Stone m^kd S.L.T.C.E. 2

At 1710 vs Crof Valley Cr. C. S. - about 25 vs wide - long, deep hole of water - At 3 miles set Stone m^kd S.L.T.C.E. 3 - At 1291 vs

+ Cross the E. line of the E. Isaacs sur - 315 vs S 30° W of its N.E. Cor + 2453 vs S 30° E. from the N.E. cor of Pablo Cassillas

sur - At 4 miles set Stone m^kd S.L.T.C.E. 4 - At 518 vs Cross

head of Coyote Cr. C. S. & At 5 miles set Stone m^kd S.L.T.C.E. 5 -

At 6 miles set Stone m^kd S.L.T.C.E. 6 - At 650 vs Main Fork of

Coyote, C. S. At 7 miles set Stone m^kd S.L.T.C.E. 7 At 800 vs b. C. S. W.

At 8 miles set Stone m^kd S.L.T.C.E. 8. - At 9 miles set Stone m^kd S.L.T.C.E. 9 -

+ At 990 vs Crof the E. line of Sec 109. 36 + S. G. R. R. Co. 727 vs North of its S. E. Cor. At 10 miles set Stone m^kd S.L.T.C.E. 10. At 170 vs Crof

Salt br. C. S. & - At 11 miles set Stone in Valley of Bluff Cr m^kd S.L.T.C.E. 11

At 345 vs Cross a Road - At 380 vs recrofs it 10 vs. N of Ford on Bluff Cr.

at 430 vs Cross Bluff Cr C. S. W. At 12 miles set Stone m^kd

S.L.T.C.E. 12. At 1425 vs Cross Spring Cr C. S. - At 1850 vs Crof br

Connecting a chain of Lakes together - At 13 miles set Stone

m^kd S.L.T.C.E. 13 in the old Ft Gates + Ft Chadbourne Road

At 14 miles set Stone m^kd S.L.T.C.E. 14. At 1000 vs Crof drain, C. S.

At 15 miles set Stone m^kd S.L.T.C.E. 15 - N. E. Pt more. S 69 1/2° E. N. W. pt S 33 1/4°

E. + W. and S 6° E. At 400 vs Crof Bulger Cr - At 800 vs Crof Abilene

+ St. Boucho Road - At 16 miles set Stone in a ravine C. N. E.

m^kd S.L.T.C.E. 16 from which the N.E. pt 7117 more vs S 54 1/2° E. 6.

N. W. pt vs S 4 W. 6 W. end, vs S 18 W. At 1850 vs Crof br C. N. E. At 17

miles set Stone m^kd S.L.T.C.E. 17. from which the N. E. pt of 7117

more, vs. S. 10 E + N. W. pt vs S 38 1/2° W. At 300 vs Crof Cr C. S. - At

+ 1504 vs Crof the E line of the G. W. Baldwin sur No. 460 - 250 vs

N of its S. E. Cor. At 18 miles set Stone m^kd S.L.T.C.E. 18 - At 400 vs Crof

Sheep Hollow C. S. At 1587 vs Crof the W. line of the E. H. Darst sur

+ 770 vs South of its old N. W. Cor. At 19 miles set Stone m^kd S.L.T.C.E. 19 -

At 20 miles set Stone m^kd S.L.T.C.E. 20 - At 10 vs Crof br. C. S.

Taylor Co. Edg. Line #1

2/10/18
5070
2/6/18
4270
2/18/18
1720
5

At 21 miles set stone m^kd S.L.T.C.E 21. At 2500 vs Crop by C.S.W.
 At 1500 vs Crop divide between waters of Red cr + Jim Ned.
 At 22 miles set Stone m^kd S.L.T.C.E 22. At 450 vs Crop head of br C.
 N.E. - At 800 vs Crop old Coleman City + Buffalo road. At 23 miles
 set Stone m^kd S.L.T.C.E 23. - At 650 vs br C N. - 760 vs another C.W.W.
 At 24 miles set Stone on N pt of Rocky hill m^kd S.L.T.C.E 24. At
 25 miles set Stone m^kd S.L.T.C.E. 25. At 372 vs Crop the E. line
 of the G.W. Denton Sur No 468. 1229 vs N. of its old S.E. Cor.
 identified by original bearing trees - At 1708 vs Crop Buck
 Cr C. N. - At 26 miles set Stone in Hill side m^kd S.L.T.C.E. 26
 At 477 vs Crop the W. line of the Hood Co. School Land 360 vs
 N. of its S.W. Cor. - At 1725 vs Crop Buffalo Gap and Coleman
 City Road. At 27 miles set Stone m^kd S.L.T.C.E 27 - At 28 miles
 set Stone m^kd S.L.T.C.E 28 - At 29 miles set Stone on E. side of
 a br C.N.E. m^kd S.L.T.C.E 29 - At 1000 vs touch the South
 bank of Jim Ned in the Horse Shoe Bend - At 30 miles
 made a large Stone m^kd on Rocky Hill Capped by a
 large Flat Rock m^kd

N. W. Cor	S. E. Cor
Callahan Co	Taylor Co

From the N. W. Cor of the E. H. Darst Sur. to the S. E. Cor.
 of the G. W. Denton Sur No. 468 is an included excess of 686
 vs in the width of the old surveys; and as I was unable
 to find any intermediate corners, it is impossible to properly
 distribute it and I have given it all to the last two Survs Nos 467 + 468

East Line -

Beg an at the S. E. Cor of Jones County which is also the S. W.
 Cor. of Shackelford County and N. E. Cor of this County + N. W. Cor of
 Callahan County. which said Corner was established in Jan. 1882
 By Martin Duval Surveyor of Jones County, Henry Jacobs Surveyor
 of Shackelford County and myself - By running 30 miles West from
 the N. W. Corner of Eastland County + S. W. Cor. of Stephens County and is
 marked by a very large rock firmly set in the ground on the
 West bank of Deadman Creek + is marked on East side S.W.C.S.C.
 - On West side S.E.C.J.C. + N.E.C.T.C. from which the S. E. Cor of Sur.

10

No 11 Blind Asylum bears S 70¹/₄ E. 870 vs. Thence South at 170 vs Crof
 top of a dug-out, at Dr. Coopers 100 vs E. of his residence up to 680 vs Deadman
 Cr runs nearly parallel to, & about 50 to 75 vs from the line at this point it
 brs S 30 E. up to 1500 vs Crof & recross a prairie drain. At 1 mile set
 Stone m^k EL.T.C.N. 29. At 2 miles set Stone m^k EL.T.C.N. 28. At 3 miles set
 Stone m^k EL.T.C.N. 27. At 765 vs Crof Buck Creek one large hole of water
 20 vs wide, C.S.W. At 4 miles set Stone m^k EL.T.C.N. 26. At 200 vs Crof the
 N. line of Sec 42 Blind Asylum land 850 vs West of its N.E. Cor. At 5 miles
 set Stone m^k EL.T.C.N. 25. 100 vs Crof br C.W. At 6 miles set Stone m^k
 EL.T.C.N. 24. At 369 vs cross the Texas & Pacific R.R. At 1180 vs Crof Rainey's
 Creek C.W. 10 vs wide. At 7 miles set Stone m^k EL.T.C.N. 23. At 8 miles
 set Stone m^k EL.T.C.N. 22. At 152 vs Crof S. line of Sec 57 B. A 879 vs. West
 of its S.E. Cor. At 448 vs cross br. C. N.W. At 1300 vs Crof Abilene & Belle
 Plain Road C.S. 692. At 9 miles set Stone m^k EL.T.C.N. 21. At 640 vs Crof
 branch. C.N.W. At 10 miles set Stone m^k EL.T.C.N. 20. At 11 miles set Stone m^k
 EL.T.C.N. 19. At 1600 vs Crof cr C.W. At 1800 vs Cr. C.N.W. At 12 miles set Stone m^k EL.T.C.N. 18.
 At 820 vs Crof Buffalo Gap & Belle Plain road. At 13 miles set Stone m^k EL.T.C.N. 17. At
 480 vs Crof Live Oak Cr C.W. At 14 miles set Stone m^k EL.T.C.N. 16. At 555 vs
 a br. C.W. at 845 vs br. C.N.W. At 975 vs Crof road. C.N.W. At 15 miles set
 Stone m^k EL.T.C.N. 15. At 66 vs cross the N. line of Surv 55 Lunatic
 Asylum 23 vs E of its N.W. Cor. At 960 vs N. foot of Mt. At 1200 vs top
 of same angle of slope 16¹/₂. At 1380 vs S. edge of Mt. At 1600 vs foot
 At 16 miles set Stone on S. side of a ravine in Cove m^k EL.T.
 C.N. 14. At 151 vs Crof S. line of said Surv 55 L. A. 14 vs E. of its S.W. Cor
 At 200 vs N. foot of Mt. At 400 vs top edge of same. At 950 vs S edge
 of Mt. 1275 vs S. foot of same. At 1375 vs Crof Br. C.S.W. At 17 miles
 set Stone m^k EL.T.C.N. 13. At 215 vs and 285 vs + 335 vs Crof & recrof
 Br. C.S.E. At 350 vs enter P.O. timber in N. side of Eagle Cove at 600 vs
 Crof road C.N.W. At 1429 vs, 1450 vs + 1500 vs Crof & recrof Cr. C.S.
 25-E. At 1781 vs Crof South line of Sec No 8. B2. 7. S.P.R.R. Co. 52 vs
 East of Center or 1/2 mile Corner. At 18 miles set Stone m^k EL.T.C.N. 12
 At 492 vs Crof old road. C.N.W. At 990 vs Crof head of Pecan Bayou
 C.S.E. At 1775 vs Crof South line of Sec 15 B. 7. S.P.R.R. Co. 63 vs E of
 its 1/2 mile Corner. At 19 miles set Stone m^k EL.T.C.N. 11. At 230 vs

Taylor Co. Bdry Line #1

Cross Jones br. C. E. at 710 vs Cross br. C. S. E. At 880 vs Cross road C. N. W.
 At 1460 vs br. C. E. At 1700 vs N. foot of Mt on S. W. side of Eagle Cove At 20
 miles set Stone on Mt ^{mk^d E. L. T. C. N. 10.} At 1824 vs Cross S. line of Sec 21
 Bl. 6. S. P. R. Co 72 vs E of 1/2 mile Cor. At 21 miles set Stone ^{mk^d E. L. T. C. N. 9.}
 At 1000 vs leave the Mt along the Eastern edge of which the line has
 run from the 10 mile post. At 1520 vs Cross Cr. 1585 vs another just
 above their junction C. S. S. E. 1859 vs Cross S. line of Sec 20 Bl. 6.
 87 vs E of 1/2 mile Cor. At 22 miles set Stone ^{mk^d E. L. T. C. N. 8.} At 115 vs
 Cross br. C. E. 944 vs Cross N. line of Dr Windhams pasture 86 vs E of its N.
 W. Cor. At 1800 vs Cross br. C. E. At 23 miles set Stone ^{mk^d E. L. T. C. N. 7.} At 6 vs
 Cross S. line of Dr Windhams pasture fence. At 600 vs N. edge of Mt. At 1000 vs S. edge
 of same. At 1500 vs Cross br. C. S. W. 1529 vs Cross road. At 1756 vs Cross Road C. S. W. At
 24 miles set Stone ^{mk^d E. L. T. C. N. 6.} At 17 vs Cross S. line of Sec 15 Bl. 6. 102 vs E
 of its 1/2 mile Cor. At 200 vs foot of Mt Pk. 450 vs top of same. At 1085 vs S foot
 of same. At 1221 vs Cross S. line of S. W. Berrys. Pre + N. line of Isaac Applewhite Sur.
 406 vs E of the S. E. Cor of the James Mc Ginnis Sur identified by original bearings.
 At 25 miles set Stone ^{mk^d E. L. T. C. N. 5.} At 26 miles (last mile through P. O. timber set Stone
 in S. O. glade ^{mk^d E. L. T. C. N. 4.} At 575 vs Cross Cr. C. S. W. At 1221 vs Cross S. line of
 Geo. Hancock Sur No 389. 867 vs W. of its S. E. Cor as established by Sam Chalk
 no old Cor to be found. At 27 miles set Stone ^{mk^d E. L. T. C. N. 3.} At 1547 vs Cross the S.
 line of G. W. Denton Sur No 390. 908 vs ^{W.} E of its S. E. Cor as identified by original bearings + old
 Stone md. At 28 miles set Stone ^{mk^d E. L. T. C. N. 2.} At 531 vs Cross Road C. N. E. At
 1488 vs Cross N. line of Sec 127. G. H. + H. R. R. Co 102 vs W. of its N. E. Cor. as identified by
 its original bearing trees. At 29 miles set Stone ^{mk^d E. L. T. C. N. 1.} At
 1129 vs. N bank of Jim Ned 24 vs wide. a pecan tree 1 vs W. of line
^{mk^d E. L. T. C.} four hacks above + below. 30 miles a large Stone
 md. on Rocky Hill capped by a large flat
 Rock. ^{N. W. L. T. C.}
 Callaham | Taylor Co

30
 J. H. Mc. Henderson Surveyor, Taylor County do
 hereby Certify that the above Survey was made
 strictly in Conformity to law and that the lines
 boundaries and Corners are as Called for and
 that the work was begun on each line, at the

time and place appointed by the County
Commissioners Court and no Representative
of either of the adjoining Counties appearing.
I ran the lines along Wm. Brown, Flagman
Henry Wristen and J. D. Miller Chain Carriers.
Ed. Hollings, Arman, A. J. Tucker, Corner. Baielden
Witness my hand this 29th day of Sept 1882
H. M. Henderson.

Surveyor of Taylor Co.

Approved and ordered recorded and Certified Copy
Sent to Genl. Land Office
Attest
M. C. Lambeth
Clerk County Court
Taylor Co. Tex.

John W. Murray Presiding
Officer Coms Court.

The State of Texas
County of Taylor. I, M. C. Lambeth Clerk of the County Court
of Taylor County Texas do hereby Certify that the preceding Three
and one half Pages contain a true and correct Copy of the
Field notes of a Survey of the West, South, and East Boundary
lines of Taylor County Texas, as the same appears in Book
F. Deed Record Taylor County pages 603 to 607 inclusive. I
further Certify that the original of the accompanying
Sketch is on file in my office. Given under my hand and
Seal of said Court at my office in the Town of Buffalo Gap
this 12th day of October A.D. 1882



M. C. Lambeth
Clerk of the County Court of
Taylor County Texas

Taylor Co. Bdry Line #1

48

James. County

Taylor County

Nolan Co.

Callahan Co.

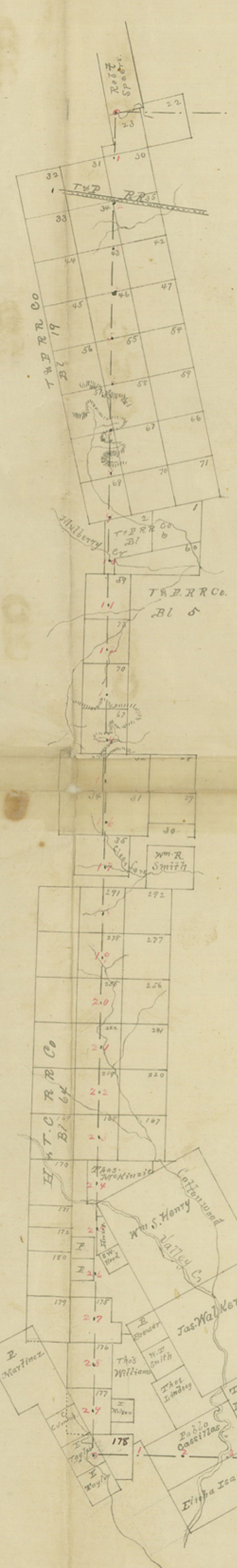

Handwritten note: Survey of road from [unclear] to [unclear]

I H.M. Henderson Surveyor of Taylor County Texas
 Do hereby Certify that this sketch represents correctly
 the West South and East Boundary lines of Taylor
 County together with the surveys through which
 they run as surveyed by me in accordance with
 an order of the Commissioners Court of Taylor
 County dated the 9th day of May 1882
 Scale of 4000 to 1 Inch H.M. Henderson
 Variation 9°50' E with Surveyor of Taylor County Texas
 my Compass which agrees
 with the Var. of N line as
 Run by Martin Duval

Runnels Co.

Coleman Co.



1.

Taylor Co Bdry Line 1

Taylor County.
County lines

Filed Novemb. 5th
182.

only signed by Surveyors
of Taylor Co.